

NOTICE OF LOCATION

NOTICE IS HEREBY GIVEN That the undersigned, having complied with the requirements of SECTION 2324 of the REVISED STATUTES of the United States, and the Local Laws, Customs and Regulations of this District, have located 1500 feet in length by 600 feet in width, on this the Copper Hill Lode, Vein or Deposit bearing Gold, Silver, Copper, Lead, and other valuable minerals, situated

in the Roberts Mining District
Eureka County, State of Nevada

the location being described and marked on the ground as follows, to-wit:

Beginning 27 feet East of this location (Discovery) Monument, at the East end center monument, and running thence South 300 feet to S E corner of monument No. 1; thence West 750. F. to South side center 1500 feet to SW corner of monument No. 2; thence North 300 feet to West end center monument; thence North 300 feet to N W corner of monument No. 3; thence East 750. F. to North side center 1500 feet to N E corner of monument No. 4; thence South 300 feet to place of beginning; including all Dips, Spurs, Angles and variations

This claim is located about 4 miles north easterly from Wallis Ranch and about 1 mile easterly from what is known as the old Ruston Mill

The above described Mining Claim shall be known as the

Copper Hill #1

Located this 27 day of May, 1964

NOTE

◆ **DIAGRAM OF CLAIM**—The location (discovery point) and corner monuments should be designated on the accompanying diagram to make the record of claim more perfect.

A mining claim must not exceed 1500 feet in length along the vein or lode, by 600 feet in width, 300 feet on each side of center of vein at surface.

No location of a mining claim can be made until the discovery of the vein or lode within the limits of the ground claimed.

The claim must be distinctly marked on the ground, so its boundaries can be readily traced.

A severe penalty is provided by law for removing or defacing the stakes or monuments of a mining claim.

Claims located on Sunday or holidays are legal.

All valuable mineral deposits in lands of the Government are locatable by citizens of the United States only, and those who have declared their intentions to become such.

This location notice must be filed for Record with the County Recorder of the County in which claim is located.

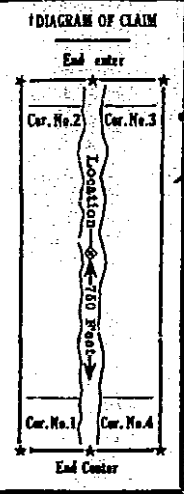

NAMES OF LOCATORS

Dale James
Wayne Mallott

39820

File No.

RECORDED AT THE REQUEST OF
Vernon Slaughter

May 26 A.D. 1964

At 08 minutes past 1 P. M.
in Liber 4 of Official Records

Page 161 Records of

EUREKA COUNTY, NEVADA

Walter A. [Signature] Recorder
By _____ Deputy

Fee \$ 1.00

NOTICE OF LOCATION

NOTICE IS HEREBY GIVEN That the undersigned, having complied with the requirements of SECTION 2324 of the REVISED STATUTES of the United States, and the Local Laws, Customs and Regulations of this District, has located 1500 feet in length by 600 feet in width, on this the Copper Hill Lode, Vein or Deposit bearing Gold, Silver, Copper, Lead, and other valuable minerals, situated

in the Roberts Mining District
Eureka County, State of Nevada

the location being described and marked on the ground as follows, to-wit:

Beginning 20 feet East of this location (Discovery) Monument, at the East end center monument, and running
thence South 300 feet to SE corner of monument No. 1;
thence West 150 ft 1500 feet to South Side Center corner of monument No. 2;
thence North 300 feet to West end center monument;
thence North 300 feet to N. E. Corner corner of monument No. 3;
thence East 750 ft 1500 feet to South Side Center South West corner of monument No. 4;
thence South 300 feet to place of beginning; including all Dips, Spurs, Angles and variations.

This claim adjoins
Copper Hill #1 on the South Side
Boundary

The above described Mining Claim shall be known as the

Copper Hill #2

Located this 21 day of May, 1904

NOTE

◇ **DIAGRAM OF CLAIM**—The location (discovery point) and corner monuments should be designated on the accompanying diagram to make the record of claim more perfect.

A mining claim must not exceed 1500 feet in length along the vein or lode, by 600 feet in width, 300 feet on each side of center of vein at surface.

No location of a mining claim can be made until the discovery of the vein or lode within the limits of the ground claimed.

The claim must be distinctly marked on the ground, so its boundaries can be readily traced.

A severe penalty is provided by law for removing or defacing the stakes or monuments of a mining claim.

Claims located on Sunday or holidays are legal.

All valuable mineral deposits in lands of the Government are locatable by citizens of the United States only, and those who have declared their intentions to become such.

This location notice must be filed for Record with the County Recorder of the County in which claim is located.

DIAGRAM OF CLAIM

NAMES OF LOCATORS

Dale James
Wagner Mallett
Vernon Slaughter

File No. 39821

RECORDED AT THE REQUEST OF
Vernon Slaughter

May 26 A.D. 19 04

At 09 minutes past 1 P. M.

in Liber 4 of Official Records

Page 162 Records of

EUREKA COUNTY, NEVADA

By Helen G. Gullett Recorder
Dutifully

Fee \$1.00

NOTICE OF LOCATION

NOTICE IS HEREBY GIVEN That the undersigned, having complied with the requirements of SECTION 2324 of the REVISED STATUTES of the United States, and the Local Laws, Customs and Regulations of this District, has located 1500 feet in length by 600 feet in width, on this the Copper Hill Lode, Vein or Deposit bearing Gold, Silver, Copper, Lead, and other valuable minerals, situated

in the Roberts Mining District
Eureka County, State of Nevada

the location being described and marked on the ground as follows, to-wit:

Beginning 20 feet East of this location (Discovery) Monument, at the East end center monument, and running thence South 300 feet to SE corner of monument No. 1; thence West 750 ft to South side center 1500 feet to SW corner of monument No. 2; thence North 300 feet to West end center monument; thence North 300 feet to NW corner of monument No. 3; thence East 750 feet to North side center 1500 feet to NE corner of monument No. 4; thence South 300 feet to place of beginning; including all Lips, Spurs, Angles and variations. This claim adjoins Copper Hill # on the North Side Boundary

The above described Mining Claim shall be known as the

Copper Hill #3

Located this 21 day of May, 1904

<p>NOTE</p> <p>◆ DIAGRAM of CLAIM—The location (discovery point) and corner monuments should be designated on the accompanying diagram to make the record of claim more perfect.</p> <p>A mining claim must not exceed 1500 feet in length along the vein or lode, by 600 feet in width, 300 feet on each side of center of vein at surface.</p> <p>No location of a mining claim can be made until the discovery of the vein or lode within the limits of the ground claimed.</p> <p>The claim must be distinctly marked on the ground, so its boundaries can be readily traced.</p> <p>A severe penalty is provided by law for removing or defacing the stakes or monuments of a mining claim.</p> <p>Claims located on Sunday or holidays are legal.</p> <p>All valuable mineral deposits in lands of the Government are locatable by citizens of the United States only, and those who have declared their intentions to become such.</p> <p>This location notice must be filed for Record with the County Recorder of the County in which claim is located.</p>	<p>DIAGRAM OF CLAIM</p>	<p>NAMES OF LOCATORS</p> <p><u>Bob James</u></p> <p><u>Wayne McAllister</u></p> <p><u>Vernon Slaughter</u></p> <p>File No. <u>39822</u></p> <p>RECORDED AT THE REQUEST OF <u>Vernon Slaughter</u></p> <p><u>May 26</u> A.D. 19<u>04</u> At <u>10</u> minutes past <u>1</u> P. M. in Liber <u>4</u> of Official Records Page <u>163</u> Records of</p> <p><u>EUREKA COUNTY NEVADA</u> <u>Vernon Slaughter</u> Recorder By _____ Deputy Fee \$<u>1.00</u></p>
--	--------------------------------	---

NOTICE OF LOCATION

NOTICE IS HEREBY GIVEN That the undersigned, having complied with the requirements of SECTION 2324 of the REVISED STATUTES of the United States, and the Local Laws, Customs and Regulations of this District, has located 1500 feet in length by 600 feet in width, on this the Copper Hill Lode, Vein or Deposit bearing Gold, Silver, Copper, Lead, and other valuable minerals, situated

in the Roberts Mining District
Eureka County, State of Nevada

the location being described and marked on the ground as follows, to-wit:

Beginning 20 feet West of this location (Discovery) Monument, at the West end center monument, and running
 thence South 300 feet to NE corner of monument No. 1;
 thence East 150 ft to south side center 1500 feet to NE corner of monument No. 2;
 thence South 300 feet to East end center monument;
 thence South 300 feet to SE corner of monument No. 3;
 thence West 150 ft to south side center 1500 feet to SE corner of monument No. 4;
 thence North 300 feet to place of beginning; including all Dips, Spars, Angles and variations This claim adjoins copper Hill #3 on the East end Boundary

The above described Mining Claim shall be known as the

Copper Hill #4

Located this 21 day of May, 1964

NOTE

DIAGRAM OF CLAIM—The location (discovery point) and corner monuments should be designated on the accompanying diagram to make the record of claim more perfect.

A mining claim must not exceed 1500 feet in length along the vein or lode, by 600 feet in width, 300 feet on each side of center of vein at surface.

No location of a mining claim can be made until the discovery of the vein or lode within the limits of the ground claimed.

The claim must be distinctly marked on the ground, so its boundaries can be readily traced.

A severe penalty is provided by law for removing or defacing the stakes or monuments of a mining claim.

Claims located on Sunday or holidays are legal.

All valuable mineral deposits in lands of the Government are locatable by citizens of the United States only, and those who have declared their intentions to become such.

This location notice must be filed for Record with the County Recorder of the County in which claim is located.

DIAGRAM OF CLAIM

NAMES OF LOCATORS

Dak James

Wayne Mallett

Vein Slaughter

File No. 3385

RECORDED AT THE REQUEST OF

Vernon Slaughter

May 26 A.D. 19 64

At 11 minutes past 1 P.M.

In Liber 4 of Official Records

Page 164 Records of

EUREKA COUNTY, NEVADA

Willis A. Miller Recorder

By _____ Deputy

Fee \$1.00

NOTICE OF LOCATION

NOTICE IS HEREBY GIVEN That the undersigned, having complied with the requirements of SECTION 2324 of the REVISED STATUTES of the United States, and the Local Laws, Customs and Regulations of this District, ha located 1500 feet in length by 600 feet in width, on this the Copper Hill Lode, Vein or Deposit bearing Gold, Silver, Copper, Lead, and other valuable minerals, situated

in the P. Merle Mining District
Eureka County, State of Nevada

the location being described and marked on the ground as follows, to-wit:

Beginning 20 feet West of this location (Discovery) Monument, at the West end center monument, and running thence North 300 feet to NE corner of monument No. 1; thence East 150 ft. to South Side center 300 feet to NE corner of monument No. 2; thence South 300 feet to East end center monument; thence South 300 feet to SE corner of monument No. 3; thence West 750 ft. to South Side center 300 feet to SW corner of monument No. 4; thence North 300 feet to place of beginning; including all Dips, Spurs, Angles and variations.

This claim adjoins
Copper Hill #4 Lode
South Side Boundary

The above described Mining Claim shall be known as the

Copper Hill #4

Located this 21 day of May, 1964

NOTE
 ◆ **DIAGRAM OF CLAIM**—The location (discovery point) and corner monuments should be designated on the accompanying diagram to make the record of claim more perfect.
 A mining claim must not exceed 1500 feet in length along the vein or lode, by 600 feet in width, 300 feet on each side of center of vein at surface.
 No location of a mining claim can be made until the discovery of the vein or lode within the limits of the ground claimed.
 The claim must be distinctly marked on the ground, so its boundaries can be readily traced.
 A severe penalty is provided by law for removing or defacing the stakes or monuments of a mining claim.
 Claims located on Sunday or holidays are legal.
 All valuable mineral deposits in lands of the Government are locatable by citizens of the United States only, and those who have declared their intentions to become such.
 This location notice must be filed for Record with the County Recorder of the County in which claim is located.

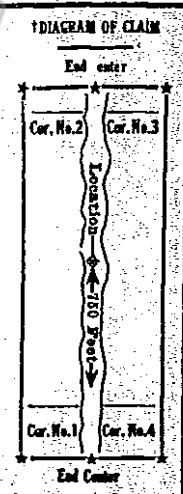

NAMES OF LOCATORS

Rale James
Wagner Mallott
Vernon Slaughter

File No. 39824

RECORDED AT THE REQUEST OF
Vernon Slaughter

May 26 A.D. 19 64

At 12 minutes past 1 P.M.

in Liber 4 of Official Records

Page 165 Records of

EUREKA COUNTY, NEVADA

Miller A. DeFord Recorder

By _____ Deputy

Fee \$ 1.00

NOTICE OF LOCATION

NOTICE IS HEREBY GIVEN That the undersigned, having complied with the requirements of SECTION 2324 of the REVISED STATUTES of the United States, and the Local Laws, Customs and Regulations of this District, ha located 1500 feet in length by 600 feet in width, on this the Copper Hill Lode, Vein or Deposit bearing Gold, Silver, Copper, Lead, and other valuable minerals, situated

in the Roberts Mining District
Eureka County, State of Nevada

the location being described and marked on the ground as follows, to-wit:

Beginning 20 feet West of this location (Discovery) Monument, at the West end center monument, and running thence North 300 feet to N.W. corner of monument No. 1; thence West 750 ft to north side center 1500 feet to N.E. corner of monument No. 2; thence South 300 feet to East end center monument; thence South 300 feet to S.E. corner of monument No. 3; thence West 750 ft to south side center 1500 feet to S.W. corner of monument No. 4; thence North 300 feet to place of beginning, including all Dips, Spurs, Angles and variations.

This claim adjoins Copper Hill #5 on the South side Boundary

The above described Mining Claim shall be known as the

Copper Hill #4

Located this 21 day of May, 1914

NOTE
 ♦ **DIAGRAM OF CLAIM**—The location (discovery point) and corner monuments should be designated on the accompanying diagram to make the record of claim more perfect.
 A mining claim must not exceed 1500 feet in length along the vein or lode, by 600 feet in width, 300 feet on each side of center of vein at surface.
 No location of a mining claim can be made until the discovery of the vein or lode within the limits of the ground claimed.
 The claim must be distinctly marked on the ground, so its boundaries can be readily traced.
 A severe penalty is provided by law for removing or defacing the stakes or monuments of a mining claim.
 Claims located on Sunday or holidays are legal.
 All valuable mineral deposits in lands of the Government are locatable by citizens of the United States only, and those who have declared their intentions to become such.
 This location notice must be filed for Record with the County Recorder of the County in which claim is located.

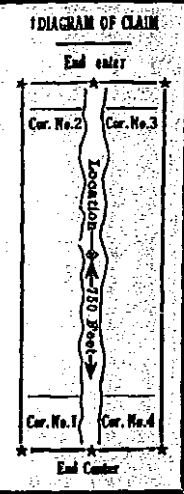

NAMES OF LOCATORS
Dale James
Wagner Mallott
Wainwright

File No. 39825
 RECORDED AT THE REQUEST OF
Vernon Slaughter
 MAY 26 A.D. 1914
 At 13 minutes past 1 P. M.
 in Lib. 4 of Official Records
 Page 166 Records of