

## LOCATION CERTIFICATE

THIS IS TO CERTIFY that the A0-27 lode mining claim was located by M. M. Roeber, Jr., whose present address is P.O. BOX 98 GRANTS, State of New Mexico, on the 13<sup>th</sup> day of NOVEMBER, 1966; that said claim was transferred by deed dated the 21 day of JANUARY, 1967, to Homestake Mining Company, a California corporation, whose address is 100 Bush Street, San Francisco, California, which deed is recorded in Book 15 of OFFICIAL RECORDS, at Page 586, in the office of the County Recorder of Eureka County, State of Nevada.

The general course of said vein or lode as near as it may be described is easterly and westerly. The claim is situated in an unknown mining district in Eureka County, State of Nevada, and the discovery monument is located approximately S55°W <sup>1.6 MP.</sup> from the NORTHEAST corner of Section 33, Township 24 North, Range 49 East, M.D.B. & M., as shown on the accompanying sketch attached hereto. The undersigned claims 1450 feet in a westerly direction, and 50 feet in an easterly direction from the discovery monument with a width of 300 feet on each side of the center of the lode or vein along the entire length of the claim.

This is one of a group of 6 contiguous claims, to-wit: A0-27, A0-28, AP27, AP28, AQ27, AQ28

The discovery work for the benefit of the entire group was done in the claim or claims as follows: AP28

and consisted of BULLDOZER CUT

and at the locations shown on the accompanying sketch attached hereto.

The corners and side centers of the claim are located and marked as follows:

Beginning at the northwest corner a 4-inch by 4-inch by 4½-foot wooden post set in a mound of earth or stones 2 feet in height by 4 feet in diameter and marked "NW Cor. AO-27"; then easterly 750 feet to the north side center post, a post of the same dimensions as that mentioned above surrounded by a mound of earth and stones as above described and marked "North Side Center AO-27"; then easterly 1500 feet from the point of beginning to the northeast corner, a post of the same dimensions surrounded by earth and stones as above set forth and marked "NE Cor. AO-27"; then southerly 600 feet to the southeast corner a post of the same dimensions surrounded by earth and stones as above set forth and marked "SE Cor. AO-27"; then westerly 750 feet to the south side center post, a post of the same dimensions surrounded by earth and stones as above set forth and marked "South Side Center AO-27"; then 750 feet westerly to the southwest corner of the claim a post of the same dimensions surrounded by earth and stones as above set forth and marked "SW Cor. AO-27"; then 600 feet northerly to the point of beginning.

All location work necessary to complete this location had been performed prior to JANUARY 15, 1967.

The discovery work on the group of claims hereinbefore referred to cost at least \$ 600.00.

Dated: Jan. 24, 1967.

HOMESTAKE MINING COMPANY

By Donald G. Hull  
Agent

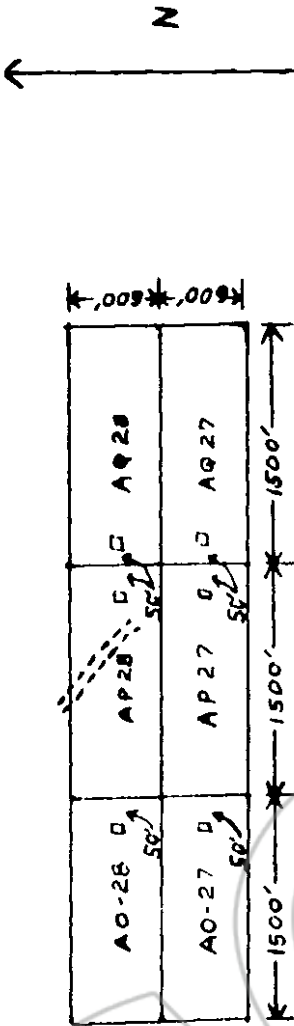

HOMESTAKE MINING COMPANY  
 6 LODE CLAIMS: AO-27, AO-28,  
 AP 27, AP28, AQ27 AND  
 AQ 28

EXPLANATION:  
 □ LOCATION POST  
 ⚡ BULL DOZER CUT

File No. 43780

RECORDED AT THE REQUEST OF  
 Homestake Mining Co.

January 24, A. D. 19 67

at 15 minutes past 2 P.M.

in Book 15 of OFFICIAL RECORDS

Page 596-598 Records of

EUREKA COUNTY, NEVADA

*Shelley A. DeLoach*

Recorder

Fee \$ 1.00

**LOCATION CERTIFICATE**

THIS IS TO CERTIFY that the AO-28 lode mining claim was located by M. M. Roeber, Jr., whose present address is P.O. BOX 98 GRANTS, State of New Mexico, on the 13<sup>th</sup> day of NOVEMBER, 1966; that said claim was transferred by deed dated the 21 day of JANUARY, 1967, to Homestake Mining Company, a California corporation, whose address is 100 Bush Street, San Francisco, California, which deed is recorded in Book 15 of OFFICIAL RECORDS, at Page 588, in the office of the County Recorder of Eureka County, State of Nevada.

The general course of said vein or lode as near as it may be described is easterly and westerly. The claim is situated in an unknown mining district in Eureka County, State of Nevada, and the discovery monument is located approximately 560<sup>0</sup>W <sup>1.5MP</sup> feet from the NORTHEAST corner of Section 33, Township 24 North, Range 49 East, M.D.B. & M., as shown on the accompanying sketch attached hereto. The undersigned claims 1450 feet in a westerly direction, and 50 feet in an easterly direction from the discovery monument with a width of 300 feet on each side of the center of the lode or vein along the entire length of the claim.

This is one of a group of 6 contiguous claims, to-wit: AO-27, AO-28, AP27, AP28, AQ27, AQ28

The discovery work for the benefit of the entire group was done in the claim or claims as follows: AP28

and consisted of BULLDOZER CUT

and at the locations shown on the accompanying sketch attached hereto.

The corners and side centers of the claim are located and marked as follows:

Beginning at the northwest corner a 4-inch by 4-inch by 4½-foot wooden post set in a mound of earth or stones 2 feet in height by 4 feet in diameter and marked "NW Cor. AO-28"; (name of claim)"; thence easterly 750 feet to the north side center post, a post of the same dimensions as that mentioned above surrounded by a mound of earth and stones as above described and marked "North Side Center AO-28"; (name of claim)"; thence easterly 1500 feet from the point of beginning to the northeast corner, a post of the same dimensions surrounded by earth and stones as as above set forth and marked "NE Cor. AO-28"; (name of claim)"; thence southerly 600 feet to the southeast corner a post of the same dimensions surrounded by earth and stones as above set forth and marked "SE Cor. AO-28"; (name of claim)"; thence westerly 750 feet to the south side center post, a post of the same dimensions surrounded by earth and stones as above set forth and marked "South Side Center AO-28"; (name of claim)"; thence 750 feet westerly to the southwest corner of the claim a post of the same dimensions surrounded by earth and stones as above set forth and marked "SW Cor. AO-28"; (name of claim)"; thence 600 feet northerly to the point of beginning.

All location work necessary to complete this location had been performed prior to JANUARY 15, 1967.

The discovery work on the group of claims hereinbefore referred to cost at least \$ 600.00.

Dated: Jan 24, 1967.

HOMESTAKE MINING COMPANY

By Donald G. Hull  
Agent

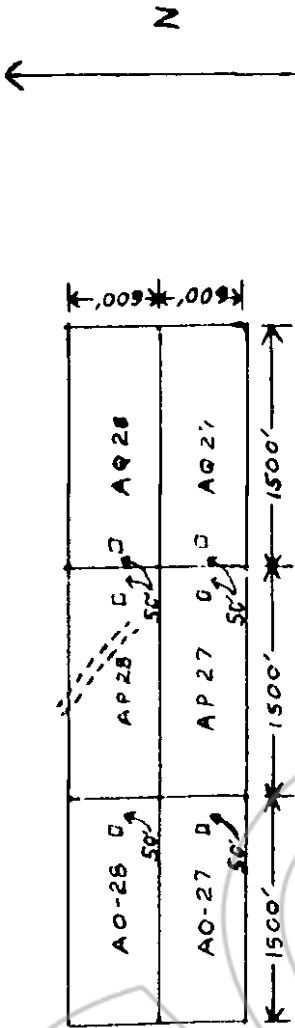

HOMESTAKE MINING COMPANY  
 6 LODE CLAIMS: AO-27, AO-28,  
 AP27, AP28, AQ27 AND  
 AQ28

EXPLANATION:  
 □ LOCATION POST  
 ▤ BULLDOZER CUT

43781

FILED  
 RECORDED AT THE REQUEST OF  
 Homestake Mining Co.  
 January 24, A. D. 1967  
 at 15 minutes past 2 P. M.  
 in Book 15 of OFFICIAL RECORDS  
 Page 599-601 Records of  
 FUREKA COUNTY, NEVADA  
*Shelley A. McLaughlin*  
 Recorder  
 Fee \$1.00