

CERTIFICATE OF MINING LOCATION

TO ALL WHOM IT MAY CONCERN

The undersigned hereby certifies that he has located the DEL NO. 49 Mining Claim in the unknown Mining District, in Eureka County, in the State of Nevada, on the 14th day of June 1967, at 9:15 A.M.

The length of the claim is 1500 feet, and 64 feet is claimed in a westerly direction, and 1436 feet in an easterly direction from the discovery monument, at which the notice of location is posted, lengthwise of the claim, together with 300 feet in width on each side of the center of the claim. The general course of the lode deposit and premises is from the east to the west.

The location of the claim is described with reference to the SW corner of Section 34, T23N, R49E, Mount Diablo Meridian, which bears about S 24°-30'W, about 8930 feet, from corner no. 1 of Del No. 49 Claim. Corner no. 2 of Del No. 49 Claim is identical with corner no. 2 of Del No. 52 Claim.

The surface boundaries of the claim are marked upon the ground as follows: Beginning at a point in a easterly direction 1436 feet from the discovery monument (at which the notice of location is posted), being in the center of the east end line of said claim; thence north 300 feet to a 7" dia. topped pinion 4½' hi being the NE No. 1 corner of said claim; thence west 750 feet to a 5½" dia. topped Juniper 5' high being at the center of the north side line; thence west 750 feet to a 6½" dia. topped pinion 6' high being the NW No. 2 corner of said claim; thence south 300 feet to the center of the west end line of said claim; thence south 300 feet to a 6" dia. juniper post 4½' high being the SW No. 3 corner of said claim; thence east 750 feet to a 4" dia. topped pinion 4' high being at the center of the south side line; thence east 750 feet to a 4" dia. topped juniper 3½' hi being the SE No. 4 corner of said claim; thence north 300 feet to the center of the east end line of said claim, at the place of beginning. Metal tags, marked with appropriate corner descriptions, as described above, are affixed to the monuments. The boundaries of the claim were completed July 3, 1967.

A description and the location of the work done upon the claim is as follows: An open cut and excavation has been dug along the ledge or lode, the size of which is at least 4 feet by 6 feet by 10 feet, located at the discovery monument, and excavation work done at various points on the Del No. 49 claim.

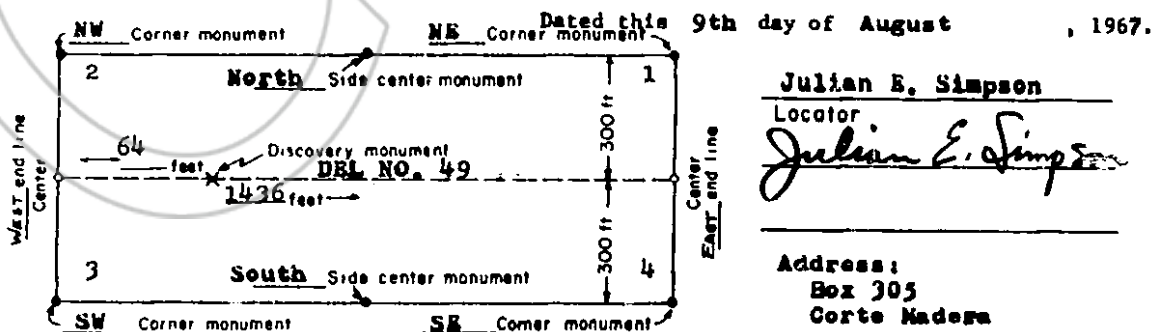

(This diagram is intended to give a general idea of the plan of location)

File No. 45046

RECORDED AT THE REQUEST OF
Julian Simpson

August 9, A. D. 1967

at 45 minutes past 4 P. M.

in Book 20 of OFFICIAL RECORDS

Page 89. Records of

EUREKA COUNTY, NEVADA

Julius A. McLaughlin

Recorder