

CERTIFICATE OF MINING LOCATION

TO ALL WHOM IT MAY CONCERN

The undersigned hereby certifies that he has located the **RAND NO. 4 Mining Claim** in the unknown Mining District, in Eureka County, in the State of Nevada, on the 24th day of June 1968, at 1:15 p.m.

The length of the claim is 1500 feet, and 1430 feet is claimed in a northwesterly direction, and 70 feet in an southeasterly direction from the discovery monument, at which the notice of location is posted, lengthwise of the claim, together with 300 feet in width on each side of the center of the claim. The general course of the lode deposit and premises is from the South 30° East to North 30° West.

The location of the claim is described with reference to the NE corner of Section 22, T22N, R49E, Mount Diablo Meridian, which bears about S 15° - 00' W, about 10,100 feet, from corner no. 1 of RAND NO. 4 Claim. Corner no. 4 of Rand No. 4 Claim is identical with corner no. 4 of Rand No. 8 Claim.

The surface boundaries of the claim are marked upon the ground as follows: Beginning at a point in a N 30° W direction 1430 feet from the discovery monument (at which the notice of location is posted), being in the center of the north end line of said claim; thence N 60° E, 300 feet to a 5" dia. 5' hi. pinon post being the NE No. 2 corner of said claim; thence S 30° E, 750 feet to a 4" dia. 5' hi topped juniper being at the center of the east side line; thence S 30° E, 750 feet to a 5" dia. 5' hi. juniper tree, topped, being the SE, no. 3 corner of said claim; thence S 60° W, 300 feet to the center of the south end line of said claim; thence S 60° W, 300 feet to a 4" dia. 4 1/2' juniper post being the SW No. 4 corner of said claim; thence N 30° W, 750 feet to a 4 1/2" dia. 5' hi. juniper post being at the center of the west side line; thence N 30° W, 750 feet to a 5" dia. 5' hi. topped juniper tree being the NW No. 1 corner of said claim; thence N 60° E, 300 feet to the center of the north end line of said claim, at the place of beginning. Metal tags, marked with appropriate corner descriptions, as described above, are affixed to the monuments. The boundaries of the claim were completed July 13, 1968.

A description and the location of the work done upon the claim is as follows: An open cut and excavation has been dug along the ledge or lode, the size of which is at least 4 feet by 6 feet by 10 feet, located at the discovery monument, and excavation work done at various points on the Rand No. 4 claim.

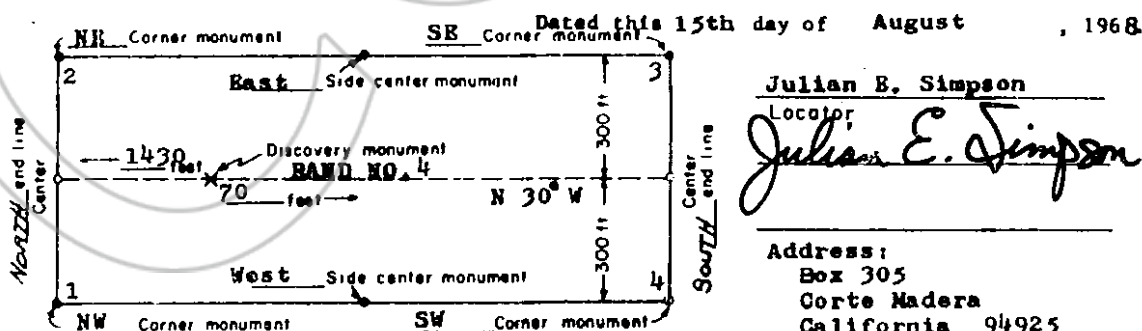

(This diagram is intended to give a general idea of the plan of location)

RECORDED AT THE REQUEST OF Julian E. Simpson
 on Aug. 16 1968 at 05 min. past 11 A. M. in
 Book 25 of OFFICIAL RECORDS, page 323 RECORDS OF
 EUREKA COUNTY, NEVADA: Julian E. Simpson Recorder.
 File # 47548 Fee \$ 1.00