

CERTIFICATE OF MINING LOCATION**TO ALL WHOM IT MAY CONCERN**

The undersigned hereby certifies that he has located the **BENCHMARK NO. 30 Mining Claim** in the unknown Mining District, in **Eureka County**, in the State of Nevada, on the 23rd of July 1968, at 10:20 a.m.

The length of the claim is 1500 feet, and 100 feet is claimed in northwesterly direction, and 1400 feet in an southeasterly direction from the discovery monument, at which the notice of location is posted, lengthwise of the claim, together with 300 feet in width on each side of the center of the claim. The general course of the lode deposit and premises is from the South 48° East to North 48° West.

The location of the claim is described with reference to the SE corner of Section 23, T22N, R30E, Mount Diablo Meridian, which bears about S 57° E, about 8,300 feet, from corner no. 1 of BENCHMARK NO. 30 Claim. Corner no. 1 of Benchmark No. 30 Claim is identical with corner no. 4 of Benchmark No. 26 Claim.

The surface boundaries of the claim are marked upon the ground as follows: Beginning at a point in a N 48° W direction 100 feet from the discovery monument (at which the notice of location is posted), being in the center of the west end line of said claim; thence N 42° E, 300 feet to a 4" x 4" 4½' hi. redwood post being the NW No. 1 corner of said claim; thence S 48° E, 750 feet to a 4" x 4" 4½' hi. redwood post being at the center of the north side line; thence S 48° E, 750 feet to a 4" x 4" 4½' redwood post being the NE No. 2 corner of said claim; thence S 42° W, 300 feet to the center of the east end line of said claim; thence S 42° W, 300 feet to a 4" x 4" 4½' hi. redwood post being the SE No. 3 corner of said claim; thence N 48° W, 750 feet to a 4" x 4" 4½' hi. redwood post being at the center of the south side line; thence N 48° W, 750 feet to a 4" x 4" 4½' hi. redwood post being the SW No. 4 corner of said claim; thence N 42° E, 300 feet to the center of the west end line of said claim, at the place of beginning. Metal tags, marked with appropriate corner descriptions, as described above, are affixed to the monuments. The boundaries of the claim were completed July 30, 1968.

A description and the location of the work done upon the claim, is as follows: An open cut and excavation has been dug along the ledge or lode, the size of which is at least 4 feet by 6 feet by 10 feet, located at the discovery monument, and excavation work done at various points on the Benchmark No. 30 claim.

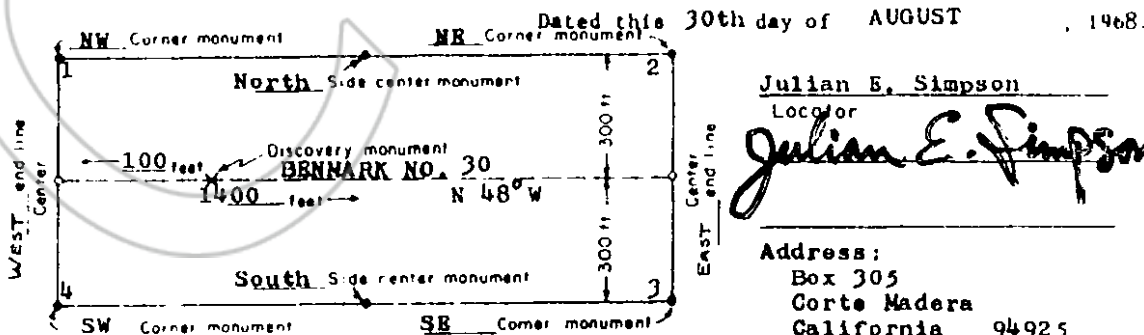

(This diagram is intended to give a general idea of the plan of location)

RECORDED AT THE REQUEST OF Julian E. Simpson
on Sep. 2 19 68 at 15 mins past 8 A. M. in
Book 25 of OFFICIAL RECORDS page 509 RECORDS OF
EUREKA COUNTY, NEVADA. William A. DePaulis Recorder.
File No. 47716 Fee \$ 1.00