

# CERTIFICATE OF MINING LOCATION

TO ALL WHOM IT MAY CONCERN

The undersigned hereby certifies that he has located the BENCHMARK NO. 32 Mining Claim in the unknown Mining District, in Eureka County, in the State of Nevada, on the 20th of July 1968, at 2:30 p.m.

The length of the claim is 1500 feet, and 94 feet is claimed in northwesterly direction, and 1406 feet in an southeasterly direction from the discovery monument, at which the notice of location is posted, lengthwise of the claim, together with 300 feet in width on each side of the center of the claim. The general course of the lode deposit and premises is from the South 48° East to North 48° West.

The location of the claim is described with reference to the SE corner of Section 23, T22N, R50E, Mount Diablo Meridian, which bears about S 58° E, about 11,300 feet, from corner no. 1 of BENCHMARK NO. 32 Claim. Corner no. 1 of Benchmark No. 32 Claim is identical with corner no. 4 of Benchmark No. 28 Claim.

The surface boundaries of the claim are marked upon the ground as follows: Beginning at a point in a N 48° W direction 94 feet from the discovery monument (at which the notice of location is posted), being in the center of the west end line of said claim; thence N 42° E, 300 feet to a 6" dia. 6' hi. juniper being the NW No. 1 corner of said claim; thence S 48° E, 750 feet to a 4½" dia. 5' hi. topped pinon tr. being at the center of the north side line; thence S 48° E, 750 feet to a 7" dia. 6' hi. topped pinon tree being the NE No. 2 corner of said claim; thence S 42° W, 300 feet to the center of the east end line of said claim; thence S 42° W, 300 feet to a 5" dia. 5½' hi. topped pinon tr. being the SE No. 3 corner of said claim; thence N 48° W, 750 feet to a 7" dia. 6' hi. pinon post being at the center of the south side line; thence N 48° W, 750 feet to a 5" dia. 6' hi. topped pinon tree being the SW No. 4 corner of said claim; thence N 42° E, 300 feet to the center of the west end line of said claim, at the place of beginning. Metal tags, marked with appropriate corner descriptions, as described above, are affixed to the monuments. The boundaries of the claim were completed July 30, 1968.

A description and the location of the work done upon the claim is as follows: An open cut and excavation has been dug along the ledge or lode, the size of which is at least 4 feet by 6 feet by 10 feet, located at the discovery monument, and excavation work done at various points on the Benchmark No. 32 claim.

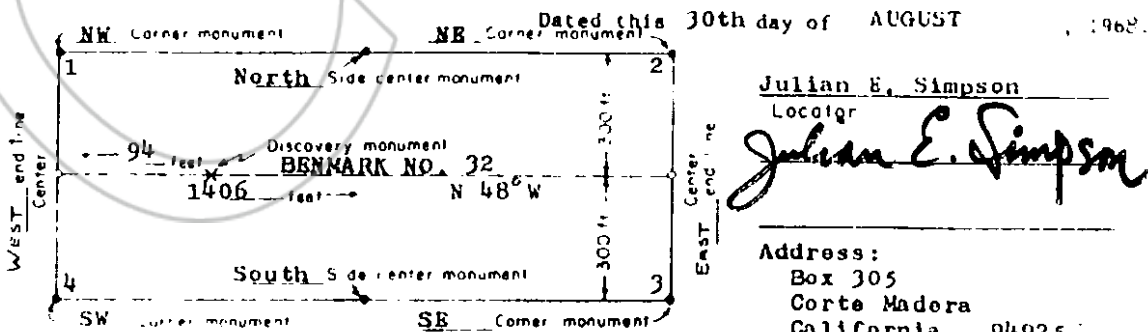

(This diagram is intended to give a general idea of the plan of location)

RECORDED AT THE REQUEST OF Julian E. Simpson  
on Sep. 2, 1968 at 15 mins. past 8 A. M. in  
Book 25 of OFFICIAL RECORDS, page 511  
EUREKA COUNTY, NEVADA *William A. DePasquale* Recorder  
File No. 47718 Fee 1.00