

26
4
30
12
360

NOTICE OF LOCATION

NOTICE IS HEREBY GIVEN, that the undersigned located and now claim Fifteen Hundred (1500) feet in length along this vein or lode containing valuable minerals, together with Three Hundred (300) feet in width on each side of the middle of said vein at the surface, and all veins, lodes, mineral and surface ground within the lines of this claim, the general course of said vein or lode running _____ feet _____ and _____ feet _____ from the discovery monument on which this claim is posted. This claim is in the _____ Mining District, _____ County, State of _____ situated _____

Eureka Mining District, *Eureka* County, State of *Nevada* situated *Discovery and monuments located on claim site, claim beginning 1/2 miles south of McCloud Springs mill site, Township #23 North 52* and is marked on the ground as follows:

Beginning *1500* feet *North* of the discovery monument, at the _____ end center monument, and running thence *East* *600* feet to *N.E.* corner monument No. 1; thence *South* *1500* feet to *S.E.* corner monument No. 2; thence *West* *600* feet and parallel to the _____ end line to the _____ end center monument; thence _____ *600* feet and parallel to said end line to _____ corner monument No. 3; thence _____ *1500* feet to _____ corner monument No. 4; thence _____ *300* feet to place of beginning; including all dips, spurs, angles and variations _____

The above described mining claim is named

Sugar Footed #6

Located this *21st* day of *May*, 19*69*.

Note
The small type on blank lines is merely a guide for the locator and is no part of this notice.
DIAGRAM OF CLAIM—The location (discovery point) and corner monuments should be designated on the accompanying diagram to make the Record of claim more perfect.
A mining claim must not exceed 1500 feet in length along the vein or lode, by 600 feet in width, 300 feet on each side of center of vein at surface.
No location of a mining claim can be made until the discovery of the vein or lode within the limits of the ground claimed.
The claim must be distinctly marked on the ground, so its boundaries can be readily traced.
A severe penalty is provided by law for removing or defacing the stakes or monuments of a mining claim.
Claims located on Sunday or holidays are legal.
All valuable mineral deposits in lands of the Government are locatable by citizens of the United States only, and those who have declared their intentions to become such.
This location notice must be posted on the discovery monument and a copy of this notice must be filed for record with the County Recorder of the county in which the claim is located within thirty days after the date of posting.

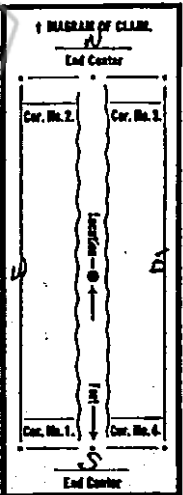

NAMES OF LOCATORS

Welf Roberts
Soren Roberts
Carrillo Roberts

RECORDED AT THE REQUEST OF

Stephen Case
on *May 23*, 19*69*
at *45* mins past *10* A. M.
in Book *29* of OFFICIAL
RECORDS, page *156* RECORDS
OF EUREKA COUNTY, NEVADA
Willis A. McLaughlin
Recorder
File No. *49272* Fee *1.00*

NOTICE OF LOCATION

NOTICE IS HEREBY GIVEN, that the undersigned located and now claim Fifteen Hundred (1500) feet in length along this vein or lode containing valuable minerals, together with Three Hundred (300) feet in width on each side of the middle of said vein at the surface, and all veins, lodes, mineral and surface ground within the lines of this claim, the general course of said vein or lode running _____ feet

_____ NORTHERLY and _____ SOUTHERLY feet from the discovery monument on which this claim is posted. This claim is in the _____ Mining District,

_____ County, State of _____ situated

Discovery and corner monuments located on claim site. Claims beginning 1 1/2 miles south of McCloud Springs mill site, Township #23 North 52

and is marked on the ground as follows:
Beginning _____ 1500 feet _____ north of the discovery monument, at the _____ south end center monument, and running thence _____ east _____ 600 feet to _____ N.E. corner monument No. 1; thence _____ south _____ 1500 feet to _____ S.E. corner monument No. 2; thence _____ west _____ 600 feet and parallel to the _____ south end line to the _____ north end center monument; thence _____ east _____ 600 feet and parallel to said end line to _____ N.E. corner monument No. 3; thence _____ south _____ 1500 feet to _____ S.E. corner monument No. 4; thence _____ west _____ 300 feet to place of beginning; including all dips, spurs, angles and variations _____

The above described mining claim is named

Sugar Foot # 6 - 7 - 8 - 9 - 10 - 11 - 12 - 13 - 14

Located this _____ day of _____, 19 _____.

Note

*The small type on blank lines is merely a guide for the locator and is no part of this notice.

DIAGRAM OF CLAIM—The location (discovery point) and corner monuments should be designated on the accompanying diagram to make the Record of claim more perfect.

A mining claim must not exceed 1500 feet in length along the vein or lode, by 500 feet in width, 200 feet on each side of center of vein at surface.

No location of a mining claim can be made until the discovery of the vein or lode within the limits of the ground claimed.

The claim must be distinctly marked on the ground, so its boundaries can be readily traced.

A severe penalty is provided by law for removing or defacing the stakes or monuments of a mining claim.

Claims located on Sunday or holidays are legal.

All valuable mineral deposits in lands of the Government are locatable by citizens of the United States only, and those who have declared their intentions to become such.

This location notice must be posted on the discovery monument and a copy of this notice must be filed for record with the County Recorder of the county in which the claim is located within thirty days after the date of posting.

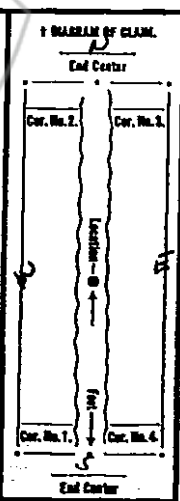

NAMES OF LOCATORS

Dell Roberts
Loren Roberts
Carroll Roberts

RECORDED AT THE REQUEST OF
Stephen Cass
on May 23, 1969
at 45 mins past 10 A. M.
in Book 29 of OFFICIAL
RECORDS, page 157, RECORDS
GREENBERG COUNTY, NEVADA
William G. DeLoach
Recorder
File No. 49273 Fee \$ 1.00

NOTICE OF LOCATION

NOTICE IS HEREBY GIVEN, that the undersigned located and now claim Fifteen Hundred (1500) feet in length along this vein or lode containing valuable minerals, together with Three Hundred (300) feet in width on each side of the middle of said vein at the surface, and all veins, lodes, mineral and surface ground within the lines of this claim, the general course of said vein or lode running _____ feet _____ and _____ feet _____ from

the discovery monument on which this claim is posted. This claim is in the _____ Cureba Mining District.

_____ Cureba County, State of Nevada situated

Discovery and monuments located on claim site. Claim beginning $\frac{1}{2}$ mile south of McCloud Springs mill site. Township 43 North 52

and is marked on the ground as follows:

Beginning 1500 feet North of the discovery monument, at the _____ SOUTH end center monument, and running thence East 600 feet to N.E. corner monument No. 1; thence South 1500 feet to S.E. corner monument No. 2; thence West 600 feet and parallel to the _____ SOUTH end line to the _____ NORTH end center monument; thence _____ EAST 600 feet and parallel to said end line to _____ N.E. corner monument No. 3; thence _____ SOUTH 1500 feet to _____ S.E. corner monument No. 4; thence _____ WEST 300 feet to place of beginning; including all dips, spurs, angles and variations _____

The above described mining claim is named

Sugar Foot # 8

Located this 16 day of May, 1969

Note

*The small type on blank lines is merely a guide for the locator and is no part of this notice.

DIAGRAM OF CLAIM—The location (discovery point) and corner monuments should be designated on the accompanying diagram to make the Record of claim more perfect.

A mining claim must not exceed 1500 feet in length along the vein or lode, by 600 feet in width, 300 feet on each side of center of vein at surface.

No location of a mining claim can be made until the discovery of the vein or lode within the limits of the ground claimed.

The claim must be distinctly marked on the ground, so its boundaries can be readily traced.

A severe penalty is provided by law for removing or defacing the stakes or monuments of a mining claim.

Claims located on Sunday or holidays are legal.

All valuable mineral deposits in lands of the Government are locatable by citizens of the United States only, and those who have declared their intentions to become such.

This location notice must be posted on the discovery monument and a copy of this notice must be filed for record with the County Recorder of the county in which the claim is located within thirty days after the date of posting.

DIAGRAM OF CLAIM

NAMES OF LOCATORS

Dell Roberts

John Roberts

Arnold Roberts

RECORDED AT THE REQUEST OF
Stephen Case

on May 23, 1969
at 45 mins. past 10 A. M.
in Book 29 of OFFICIAL
RECORDS, page 158, RECORDS
OF ELUREKA COUNTY, NEVADA
Miller A. DePaoli
Recorder
File No. 49274; 1.00

NOTICE OF LOCATION

NOTICE IS HEREBY GIVEN, that the undersigned located and now claim Fifteen Hundred (1500) feet in length along this vein or lode containing valuable minerals, together with Three Hundred (300) feet in width on each side of the middle of said vein at the surface, and all veins, lodes, mineral and surface ground within the lines of this claim, the general course of said vein or lode running _____ feet

_____ and _____ feet _____ from the discovery monument on which this claim is posted. This claim is in the

_____ Eureka Mining District, _____ County, State of Nevada situated

Discovery and monument located on claim site. Claim beginning 1 1/2 miles south of M Cloud Springs mill site. Township #23 North 52 and is marked on the ground as follows:

Beginning 1500 feet north of the discovery monument, at the _____ end center monument, and running thence East 600 feet to N. 6. corner monument No. 1; thence South 1500 feet to S. 6. corner monument No. 2; thence West 600 feet and parallel to the _____ end line to the _____ end center monument; thence East 600 feet and parallel to said end line to _____ corner monument No. 3; thence South 1500 feet to _____ corner monument No. 4; thence West 300 feet to place of beginning; including all dips, spurs, angles and variations _____

The above described mining claim is named

Sugar Foot #19

Located this _____ day of _____, 19 _____.

Note

*The small type on blank lines is merely a guide for the locator and is no part of this notice.

DIAGRAM OF CLAIM—The location (discovery point) and corner monuments should be designated on the accompanying diagram to make the Record of claim more perfect.

A mining claim must not exceed 1500 feet in length along the vein or lode, by 600 feet in width, 300 feet on each side of center of vein at surface.

No location of a mining claim can be made until the discovery of the vein or lode within the limits of the ground claimed.

The claim must be distinctly marked on the ground, so its boundaries can be readily traced.

A severe penalty is provided by law for removing or defacing the stakes or monuments of a mining claim.

Claims located on Sunday or holidays are legal.

All valuable mineral deposits in lands of the Government are locatable by citizens of the United States only, and those who have declared their intentions to become such.

This location notice must be posted on the discovery monument and a copy of this notice must be filed for record with the County Recorder of the county in which the claim is located within thirty days after the date of posting.

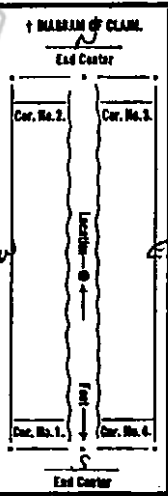

NAMES OF LOCATORS

Will Roberts

John Roberts

Arnold Roberts

RECORDED AT THE REQUEST OF Stephen Case

on May 23, 19 69

at 45 mins, past 10 A. M.

in Book 29 of OFFICIAL

RECORDS, page 159, RECORDS

OF EUREKA COUNTY, NEVADA

William A. Metcalf

Recorder 49275 Fee \$ 1.00

File No. _____

NOTICE OF LOCATION

NOTICE IS HEREBY GIVEN, that the undersigned located and now claim Fifteen Hundred (1500) feet in length along this vein or lode containing valuable minerals, together with Three Hundred (300) feet in width on each side of the middle of said vein at the surface, and all veins, lodes, mineral and surface ground within the lines of this claim, the general course of said vein or lode running _____ feet

NORTHERLY and _____ feet SOUTHERLY from

the discovery monument on which this claim is posted. This claim is in the Eureka Mining District,

Eureka County, State of Nevada situated

Discovery and corner monument located on Claim site. Claim beginning 1/2 mile south of McCloud Springs mill site. Townships # 23 North 52 and is marked on the ground as follows:

Beginning ¹⁵⁰⁰ feet ^{north} of the discovery monument, at the ^{S.} end center monument, and running thence East 600 feet to N.E. corner monument No. 1; thence South 1500 feet to S.E. corner monument No. 2; thence West 600 feet and parallel to the SOUTH end line to the NORTH end center monument; thence EAST 600 feet and parallel to said end line to N.E. corner monument No. 3; thence SOUTH 1500 feet to S.E. corner monument No. 4; thence WEST 300 feet to place of beginning; including all dips, spurs, angles and variations _____

The above described mining claim is named

Sugar Foot # 10

Located this _____ day of _____, 19____.

Note

*The small type on blank lines is merely a guide for the locator and is no part of this notice.

§ 2306A-1. LOCATION OF CLAIM—The location (discovery point) and corner monuments should be designated on the accompanying diagram to make the Record of claim more perfect.

A mining claim must not exceed 1600 feet in length along the vein or lode, by 600 feet in width, 300 feet on each side of center of vein at surface.

No location of a mining claim can be made until the discovery of the vein or lode within the limits of the ground claimed.

The claim must be distinctly marked on the ground, so its boundaries can be readily traced.

A severe penalty is provided by law for removing or defacing the stakes or monuments of a mining claim.

Claims located on Sunday or holidays are legal.

All valuable mineral deposits in lands of the Government are locatable by citizens of the United States only, and those who have declared their intentions to become such.

This location notice must be posted on the discovery monument and a copy of this notice must be filed for record with the County Recorder of the county in which the claim is located within thirty days after the date of posting.

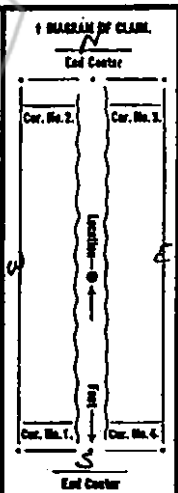

NAMES OF LOCATORS

Dell Roberts
Joren Roberts
Cirilla Roberts

RECORDED AT THE REQUEST OF Stephen Case

on May 23, 1969

at 45 mins. past 10 A. M.

in Book 29 of OFFICIAL

RECORDS, page 160 RECORDS

OF ESURKA COUNTY, NEVADA

Allen W. DePaoli

Recorder, 49276 Fee \$ 1.00

File No. _____

NOTICE OF LOCATION

NOTICE IS HEREBY GIVEN, that the undersigned located and now claim Fifteen Hundred (1500) feet in length along this vein or lode containing valuable minerals, together with Three Hundred (300) feet in width on each side of the middle of said vein at the surface, and all veins, lodes, mineral and surface ground within the lines of this claim, the general course of said vein or lode running _____ feet

NORTHERLY _____ and _____ feet _____ SOUTHERLY _____ from

the discovery monument on which this claim is posted. This claim is in the _____ Mining District,

_____ County, State of Nevada _____ situated

Discovery and corner monuments located on claim site. Claim beginning $1\frac{1}{2}$ miles south of McCloud Springs mill site, Township # 23 north 52 and is marked on the ground as follows:

Beginning _____ 1500 feet _____ North of the discovery monument, at the _____ SOUTH _____ end center monument, and running thence _____ East 600 feet to _____ N.E. _____ corner monument No. 1; thence _____ South 1500 feet to _____ S.E. _____ corner monument No. 2; thence _____ West 600 feet and parallel to the _____ SOUTH _____ end line to the _____ NORTH _____ end center monument; thence _____ EAST 600 feet and parallel to said end line to _____ N.E. _____ corner monument No. 3; thence _____ SOUTH _____ 1500 feet to _____ S.E. _____ corner monument No. 4; thence _____ WEST 300 feet to place of beginning; including all dips, spurs, angles and variations _____

The above described mining claim is named

Sugar Foot # 10

Located this _____ day of _____, 19____.

Note

*The small type on blank lines is merely a guide for the locator and is no part of this notice.

DIAGRAM OF CLAIM—The location (discovery point) and corner monuments should be designated on the accompanying diagram to make the Record of claim more perfect.

A mining claim must not exceed 1500 feet in length along the vein or lode, by 600 feet in width, 300 feet on each side of center of vein at surface.

No location of a mining claim can be made until the discovery of the vein or lode within the limits of the ground claimed.

The claim must be distinctly marked on the ground, so its boundaries can be readily traced. A severe penalty is provided by law for removing or defacing the stakes or monuments of a mining claim.

Claims located on Sunday or holidays are legal.

All valuable mineral deposits in lands of the Government are locatable by citizens of the United States only, and those who have declared their intentions to become such.

This location notice must be posted on the discovery monument and a copy of this notice must be filed for record with the County Recorder of the county in which the claim is located within thirty days after the date of posting.

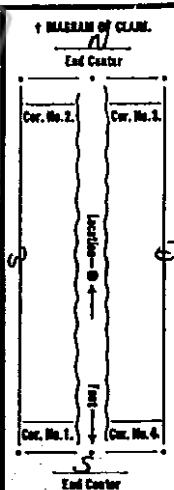

NAMES OF LOCATORS

Dell Roberts

Joren Roberts

Arvilla Robert

RECORDED AT THE REQUEST OF
Stephen Case

on MAY 23 1969

at 45 mins. past 10 A. M.

In Book 29 of OFFICIAL

RECORDS, page 161 RECORDS

OF EUREKA COUNTY, NEVADA

Julius G. DeTasoli

Recorder _____

File No. 49277 Fee \$ 1.00

NOTICE OF LOCATION

NOTICE IS HEREBY GIVEN, that the undersigned located and now claim Fifteen Hundred (1500) feet in length along this vein or lode containing valuable minerals, together with Three Hundred (300) feet in width on each side of the middle of said vein at the surface, and all veins, lodes, mineral and surface ground within the lines of this claim, the general course of said vein or lode running _____ feet

NORTHERLY _____ and _____ feet _____ SOUTHERLY _____ from the discovery monument on which this claim is posted. This claim is in the _____ Mining District.

Eureka County, State of Nevada situated Discovery and corner monuments located on claim site. Claim beginning 1 1/2 miles south of m. Cloud Springs mill site. Township # 23 North 52 and is marked on the ground as follows:

Beginning 1500 feet South of the discovery monument, at the _____ end center monument, and running thence East 600 feet to N. E. corner monument No. 1; thence South 1500 feet to S. E. corner monument No. 2; thence West 600 feet and parallel to the _____ end line to the _____ end center monument; thence East 600 feet and parallel to said end line to _____ corner monument No. 3; thence _____ 1500 feet to _____ corner monument No. 4; thence West 300 feet to place of beginning; including all dips, spurs, angles and variations _____

The above described mining claim is named

Sugar Foot # 12

Located this _____ day of _____, 19 _____.

Note

*The small type on blank lines is merely a guide for the locator and is no part of this notice.

DIAGRAM OF CLAIM—The location (discovery point) and corner monuments should be designated on the accompanying diagram to make the Record of claim more perfect.

A mining claim must not exceed 1500 feet in length along the vein or lode, by 600 feet in width, 300 feet on each side of center of vein at surface.

No location of a mining claim can be made until the discovery of the vein or lode within the limits of the ground claimed.

The claim must be distinctly marked on the ground, so its boundaries can be readily traced.

A severe penalty is provided by law for removing or defacing the stakes or monuments of a mining claim.

Claims located on Sunday or holidays are legal.

All valuable mineral deposits in lands of the Government are locatable by citizens of the United States only, and those who have declared their intentions to become such.

This location notice must be posted on the discovery monument and a copy of this notice must be filed for record with the County Recorder of the county in which the claim is located within thirty days after the date of posting.

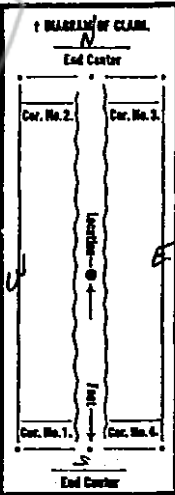

NAMES OF LOCATORS

Will Roberts

Soren Roberts

Arnold Roberts

RECORDED AT THE REQUEST OF
Stephen Case

on May 23 19 69
at 45 mins. past 10 A. M.
in Book 29 of OFFICIAL _____

RECORD, page 162 RECORDS
OF EUREKA COUNTY, NEVADA
William A. Metcalf
Recorder: 49278 Fee \$ 1.00
File No. _____

NOTICE OF LOCATION

NOTICE IS HEREBY GIVEN, that the undersigned located and now claim Fifteen Hundred (1500) feet in length along this vein or lode containing valuable minerals, together with Three Hundred (300) feet in width on each side of the middle of said vein at the surface, and all veins, lodes, mineral and surface ground within the lines of this claim, the general course of said vein or lode running _____ feet

_____ NORTHWESTLY and _____ SOUTHWESTLY from the discovery monument on which this claim is posted. This claim is in the

Eureka Mining District, Eureka County, State of Nevada situated

Discovery and monuments located on claim site. Claim beginning 1/2 mile south of old Cloud Springs mill site, Township #23 North 52 and is marked on the ground as follows:

Beginning 1500 feet North of the discovery monument, at the _____ end center monument, and running thence East 300 feet to N.E. corner monument No. 1; thence South 1500 feet to S.E. corner monument No. 2; thence West 600 feet and parallel to the _____ end line to the _____ end center monument; thence _____ 600 feet and parallel to said end line to _____ corner monument No. 3; thence _____ 1500 feet to _____ corner monument No. 4; thence _____ 300 feet to place of beginning; including all dips, spurs, angles and variations _____

The above described mining claim is named

Sugar Foot # 13

Located this 21 day of May, 1969

Note

*The small type on blank lines is merely a guide for the locator and is no part of this notice.

DIAGRAM OF CLAIM—The location (discovery point) and corner monuments should be designated on the accompanying diagram to make the Record of claim more perfect.

A mining claim must not exceed 1500 feet in length along the vein or lode, by 600 feet in width, 300 feet on each side of center of vein at surface.

No location of a mining claim can be made until the discovery of the vein or lode within the limits of the ground claimed.

The claim must be distinctly marked on the ground, so its boundaries can be readily traced.

A severe penalty is provided by law for removing or defacing the stakes or monuments of a mining claim.

Claims located on Sunday or holidays are legal.

All valuable mineral deposits in lands of the Government are locatable by citizens of the United States only, and those who have declared their intention to become such.

This location notice must be posted on the discovery monument and a copy of this notice must be filed for record with the County Recorder of the county in which the claim is located within thirty days after the date of posting.

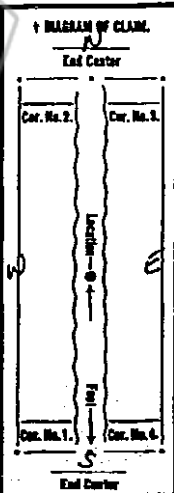

NAMES OF LOCATORS

Wells Roberts

Joren Roberts

Cirilla Roberts

Stephen Case

RECORDED AT THE REQUEST OF

Stephen Case

on May 23, 1969

at 45 mins. past 10 A. M.

in Book 29 of OFFICIAL

RECORDS, page 163, RECORDS

OF EUREKA COUNTY, NEVADA

William A. DeLoach

Recorder

File No. 49279 Fee \$ 1.00

NOTICE OF LOCATION

NOTICE IS HEREBY GIVEN, that the undersigned located and now claim Fifteen Hundred (1500) feet in length along this vein or lode containing valuable minerals, together with Three Hundred (300) feet in width on each side of the middle of said vein at the surface, and all veins, lodes, mineral and surface ground within the lines of this claim, the general course of said vein or lode running _____ feet

_____ NORTHERLY and _____ SOUTH ELY from the discovery monument on which this claim is posted. This claim is in the

_____ Cureka Mining District, _____ Cureka County, State of Nevada situated

Discovery and monuments located on claim site of claim beginning $\frac{1}{2}$ miles south of McCloud ~~beginning~~ mill site township ⁷²³ North #52 and is marked on the ground as follows:

Beginning 1500 feet North of the discovery monument, at the _____ SOUTH end center monument, and running thence East 600 feet to _____ NE corner monument No. 1; thence South 1500 feet to _____ SE corner monument No. 2; thence West 600 feet and parallel to the _____ SOUTH end line to the _____ NORTH end center monument; thence _____ EAST 600 feet and parallel to said end line to _____ corner monument No. 3; thence _____ SOUTH 1500 feet to _____ corner monument No. 4; thence _____ WEST 300 feet to place of beginning; including all dips, spurs, angles and variations _____

The above described mining claim is named

Sugar Foot # ~~12-6-7-8-9-10-11-12-13-14~~

Located this 21 day of May, 1969.

NAMES OF LOCATORS

Dell Roberts
Soren Roberts
Arnold Roberts
Stephen Case

RECORDED AT THE REQUEST OF
Stephen Case

on May 23, 1969
at 45 mins. past 10 A. M.
in Book _____ of OFFICIAL
RECORDS, page 164 RECORDS
OF EUREKA COUNTY, NEVADA
William A. DeLoach
Recorder 49280 Fee \$ 1.00
File No. _____

Note

*The small type on blank lines is merely a guide for the locator and is no part of this notice.

DIAGRAM OF CLAIM—The location (discovery point) and corner monuments should be designated on the accompanying diagram to make the Record of claim more perfect.

A mining claim must not exceed 1500 feet in length along the vein or lode, by 600 feet in width, 300 feet on each side of center of vein at surface.

No location of a mining claim can be made until the discovery of the vein or lode within the limits of the ground claimed.

The claim must be distinctly marked on the ground, so its boundaries can be readily traced.

A severe penalty is provided by law for removing or defacing the stakes or monuments of a mining claim.

Claims located on Sunday or holidays are legal.

All valuable mineral deposits in lands of the Government are locatable by citizens of the United States only, and those who have declared their intentions to become such.

This location notice must be posted on the discovery monument and a copy of this notice must be filed for record with the County Recorder of the county in which the claim is located within thirty days after the date of posting.

DIAGRAM OF CLAIM