

R 54 E

T
21
N

T
21
N

DRILLED
AREAS

C
L
A
I
M
S

R
I
D
G
E

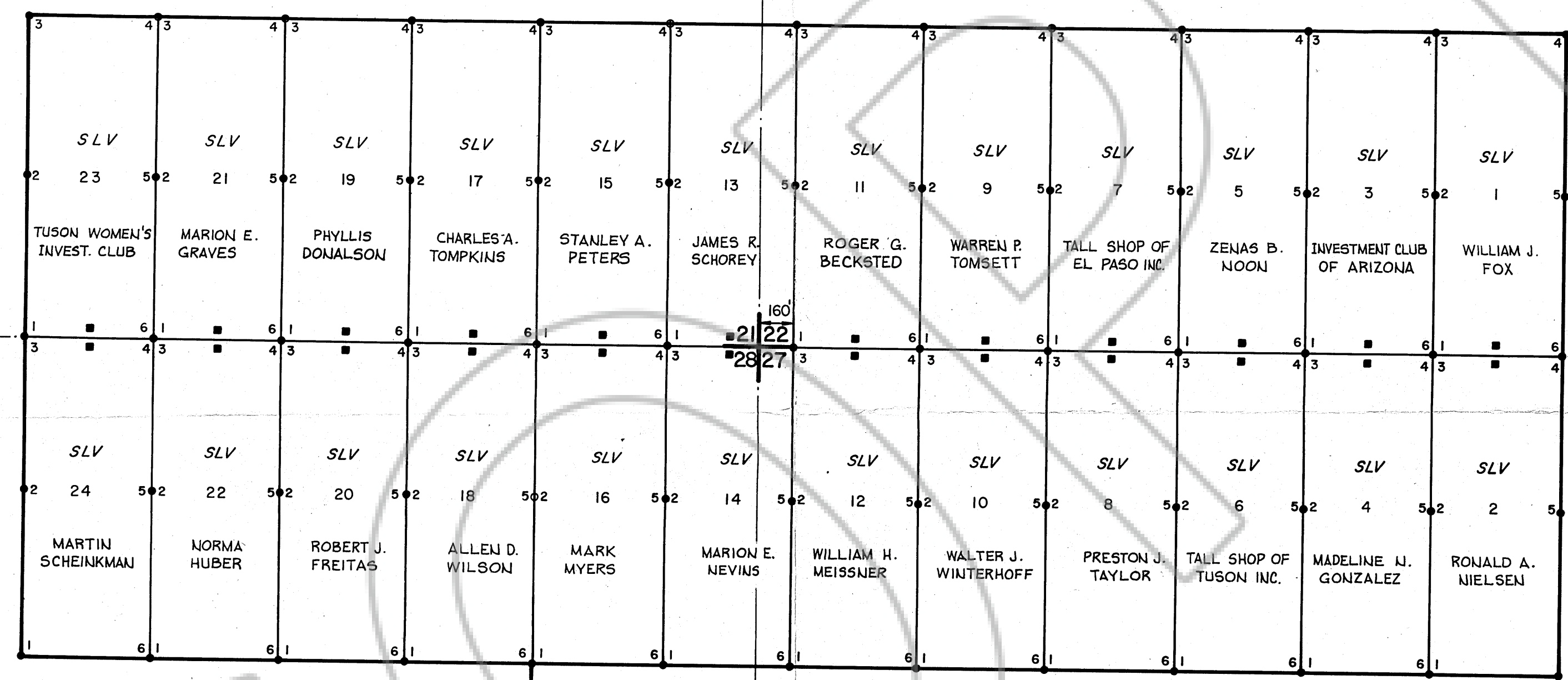

- Location Monument
- Corner and Side Monument

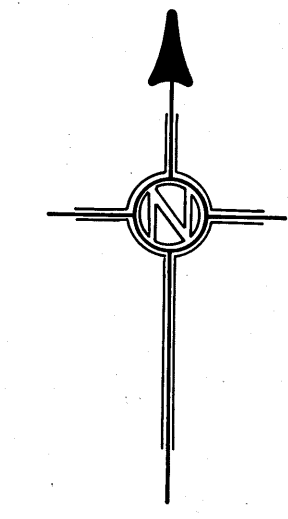

QUEVA

SILVER VENTURE GROUP

BLACK POINT VENTURE CLAIMS

LOCATED: Dec. 1971 BY: John Pearce
FOR

SILVER LEDGE VENTURE GROUP	
709 Cline	Las Vegas, Nevada
SILVER LEDGE VENTURE CLAIMS	
DIAMOND MINING DISTRICT	
Eureka County,	Nevada
Scale 1" = 500'	Date Dec. 24, 1971
Mapping John Pearce	SLV - 1
Drafting Jim Reza	
REVISED	JAN 8, 1972

FILED AT THE REQUEST OF William GERGEN
on Dec 30 1971 at 4:00 mins. past 4 P. M.
Book _____ of _____ RECORDS OF
EUREKA COUNTY, NEVADA. _____ Recorder.
File No. 55403 Fee \$ 3.00