

S.E. Cor. Sec. 36,
T. 23 N., R. 51 E., MDBL & M.
S.L.M. Brass Cap
Dated 1972

T. 16 N. R. 52 W.
10.3835

U.S.G.S. Benchmark
Labeled R 20
Dated 1931

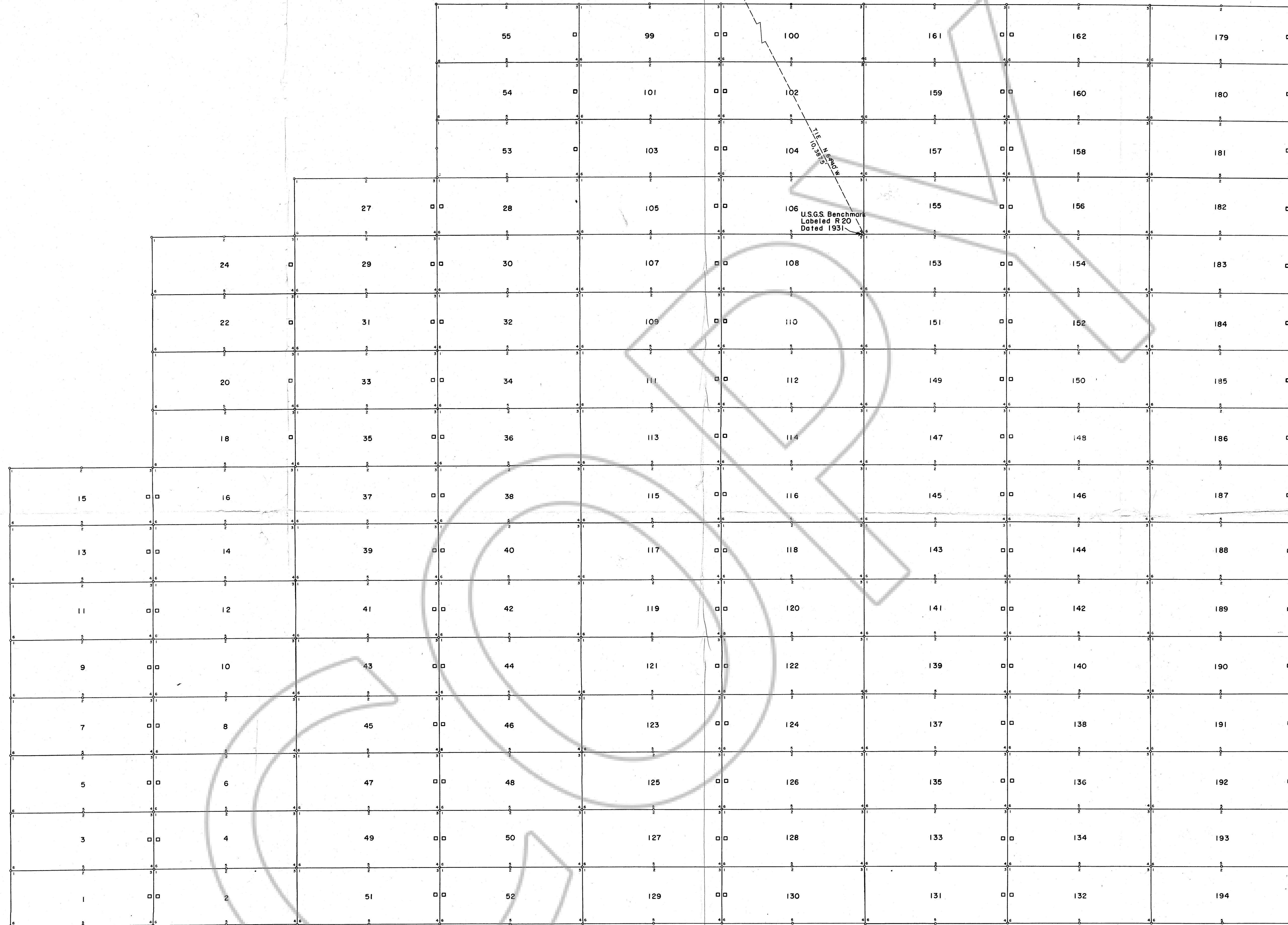

N 37°43' W

Filed
AT THE REQUEST OF
Minerals Service Company
on July 30 1974
at 10:00 mins. past 11 A.M.
in Book _____ of OFFICIAL RECORDS
OF EUREKA COUNTY, NEVADA
Walter G. McCord
Recorder
File No. 58970, Vol. 1935

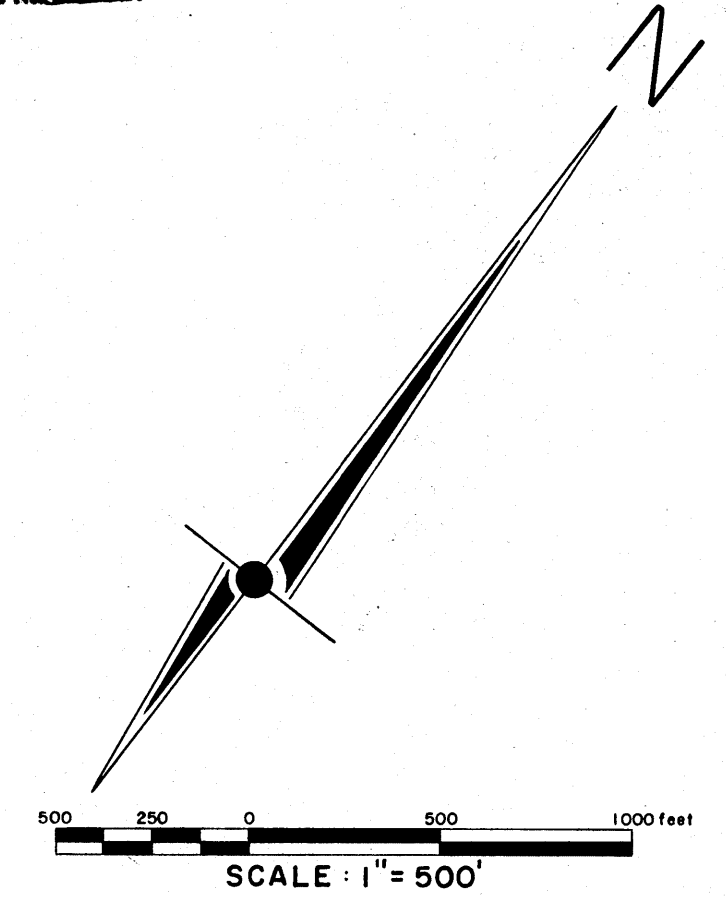

LEGEND

- Claim corner or side center
- Discovery monument

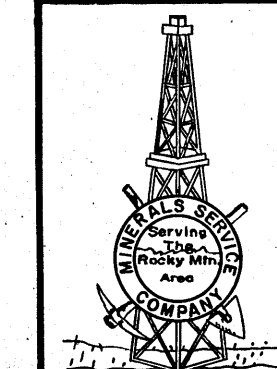

MAP OF THE
"SUE" CLAIMS
UNSURVEYED T. 22 N., R. 52 E., MDBL & M.
EUREKA COUNTY, NEVADA
STAKED FOR CARL L. BURLEY

MINERALS SERVICE COMPANY
GRAND JUNCTION, COLORADO

SURVEYED BY J. I. G.	SCALE 1" = 500'	DRAWN BY M. E. L.	JOB NUMBER M.S.C. 16-74
STAKED BY J. I. G.	DATE 7-19-1974	CHECKED BY J. I. G.	

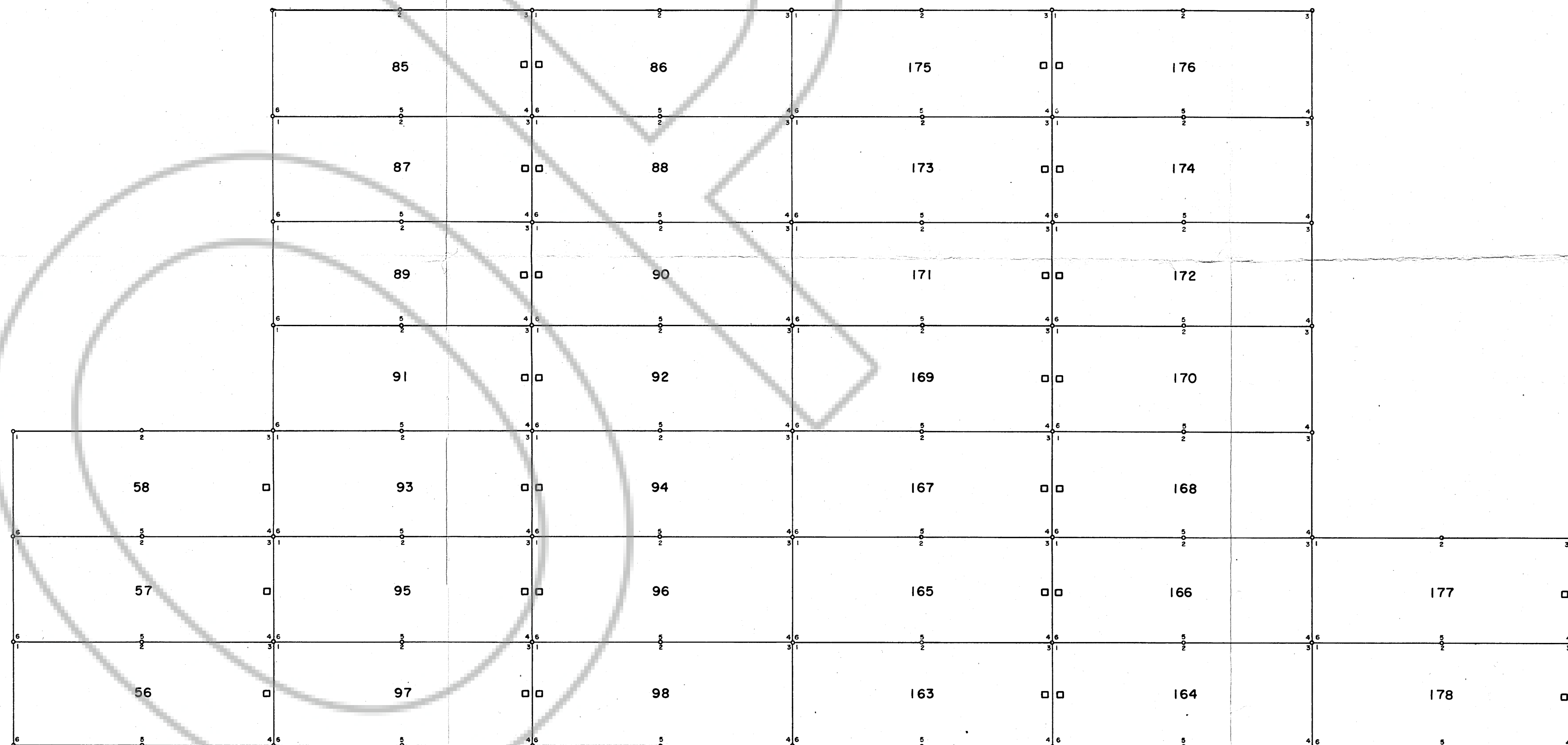

Filed
 RECORDED AT THE REQUEST OF
 Minerals Service Company
 on July 30 1974
 at 10:00 a.m. past 11 A.M.
 by _____ OFFICIAL
 RECORDS
 OF EUREKA COUNTY, NEVADA
 Eureka County, Nevada
 Record # 58970, Page 495

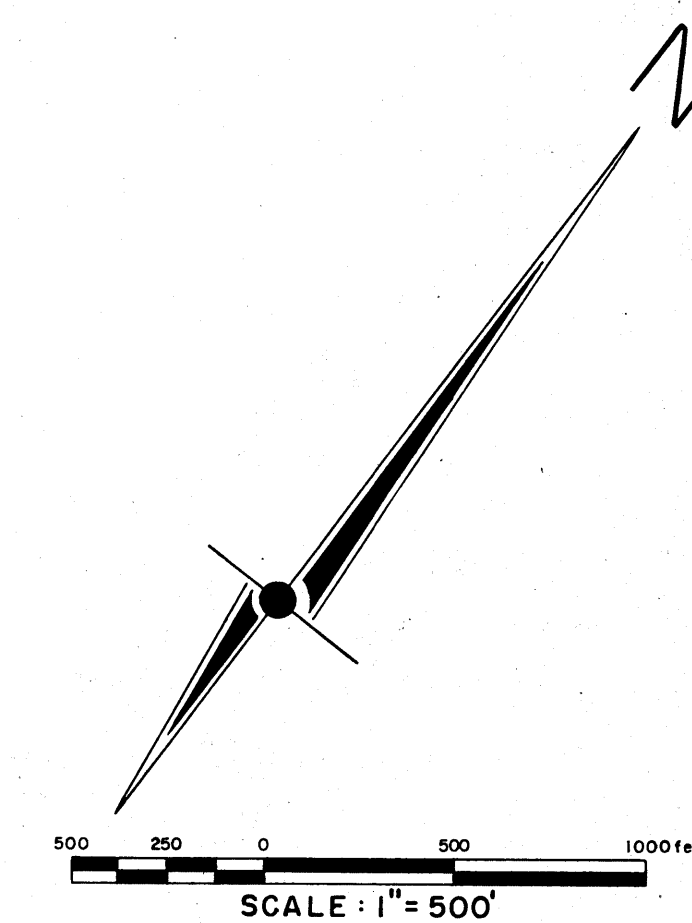

LEGEND
 • Claim corner or side center
 □ Discovery monument

MAP OF THE
"SUE" CLAIMS
 UNSURVEYED T. 22 N., R. 52 E., M.DBL. & M.
 EUREKA COUNTY, NEVADA
 STAKED FOR CARL L. BURLEY

MINERALS SERVICE COMPANY
 GRAND JUNCTION, COLORADO

SURVEYED BY J.I.G. SCALE 1" = 500' DRAWN BY M.E.L. JOB NUMBER
 STAKED BY J.I.G. DATE 7-19-1974 CHECKED BY J.I.G. M.S.C. 16-74