

# NOTICE OF LOCATION

## Notice is Hereby Given:

That the undersigned, having complied with the requirements of SECTION 2324 of the REVISED STATUTES of the United States, and the Local Laws, Customs and Regulations of this District, ha S located Fifteen hundred feet in length by 600 feet in width, on this the

Cindy Rose #3 Lode, Vein or Deposit, bearing Gold, Silver, Copper, Lead and other valuable minerals, situated Trwp 21 1/2 N. - Range

IN NORTH FORK OF DRY CANYON, ETC.

54E. Section 35 All shots are based on True N. Setting using 12 1/2° W of Magnetic N. as Base  
in the Diamond SUPERFINE Mining District,

Eureka COUNTY, State of Nevada

the location being described and marked on the ground as follows, to-wit:

Beginning 10 feet West of this location (Discovery) Monument, at the West end center monument, and running thence N. 12° WEST 22' E. 300 feet to N. 12° corner monument No. 1; thence S. 61° NORTH 22' E. 1500 feet to N. E. W corner monument No. 2; thence S. 12° EAST 22' W. 300 feet to E. NORTH end center monument; thence S. 12° EAST 22' W. 300 feet to S. E. N E corner monument No. 3; thence N. 61° SOUTH 22' W 1500 feet to S. W. S E corner monument No. 4; thence N. 12° WEST 22' E 300 feet to place of beginning, including all Dips, Spurs, Angle and Variations

The North End line of this Claim lies in Contiguously with the South End line of Cindy Rose #2 Claim

The above described Mining Claim shall be known as the

Cindy Rose #3

Located this 20th day of October 1974

### Note

\*The small type on blank lines is merely a guide for the locator and is no part of this notice.

\*Diagram of Claim—The location (discovery point) and corner monuments should be diagrammed on the accompanying diagram to make the record of claim more perfect.

A mining claim must not exceed 1500 feet in length along the vein or lode, by 600 feet in width, 300 feet on each side of center of vein at surface.

No location of a mining claim can be made until the discovery of the vein or lode within the limits of the ground claimed.

The claim must be distinctly marked on the ground, so its boundaries can be readily traced.

A severe penalty is provided by law for removing or defacing the stakes or monuments of a mining claim.

Claims located on Sunday or holidays are legal.

All valuable mineral deposits in lands of the Government are locatable by citizens of the United States only, and those who have declared their intentions to become such.

This location notice must be filed for record with the County Recorder of the county in which the claim is located.

### DIAGRAM OF CLAIM

END CENTER

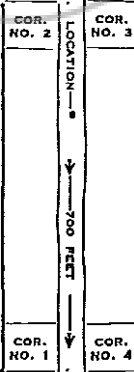

END CENTER

### NAMES OF LOCATORS:

Norman L. Cechini  
12890 W 16th Dr.  
Golden Colo. 80401

RECORDED AT THE REQUEST OF  
Norman L. Cechini

October 24, 1974

at 20 mins. past 11 A. M.

A Book 50 of OFFICIAL

RECORDS, page 152

OF EUREKA COUNTY, NEVADA

William A. DeLoach

Recorder 59404 Fee 1.00

Page 50