

Amended
Map

Township 27N.
Range 48E.
Sec. 26

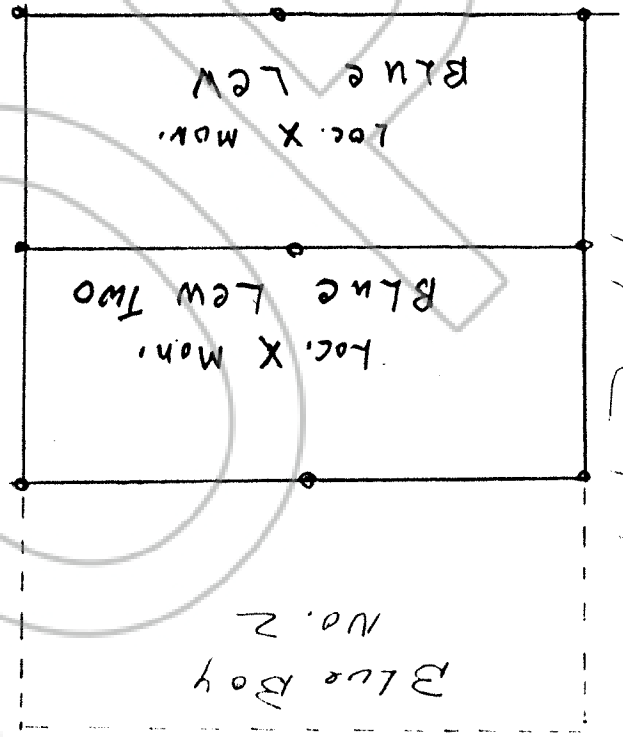

Scale 1" = 500'

Filed
 RECORDED AT THE REQUEST OF Charles Farnell Jr.
 on Sept 2, 1975, at 3:55 mins. past 07 M. PM
 Book of 1975 RECORDS OF
 EUREKA COUNTY, NEVADA
 Filed No. 100 298 Fee \$

MAP of Blue Lew Lode Claim Group
 Buckhorn Mining District, Eureka County,
 NEVADA
 Located 1975
 By Narry M. Polley and Charles Damele
T. N. Ranch, Carlin, Nevada

Tree - West

1/4 of Blue Lead & Blue Lead
Carter Quadrangle
ON SURVEYED LAND

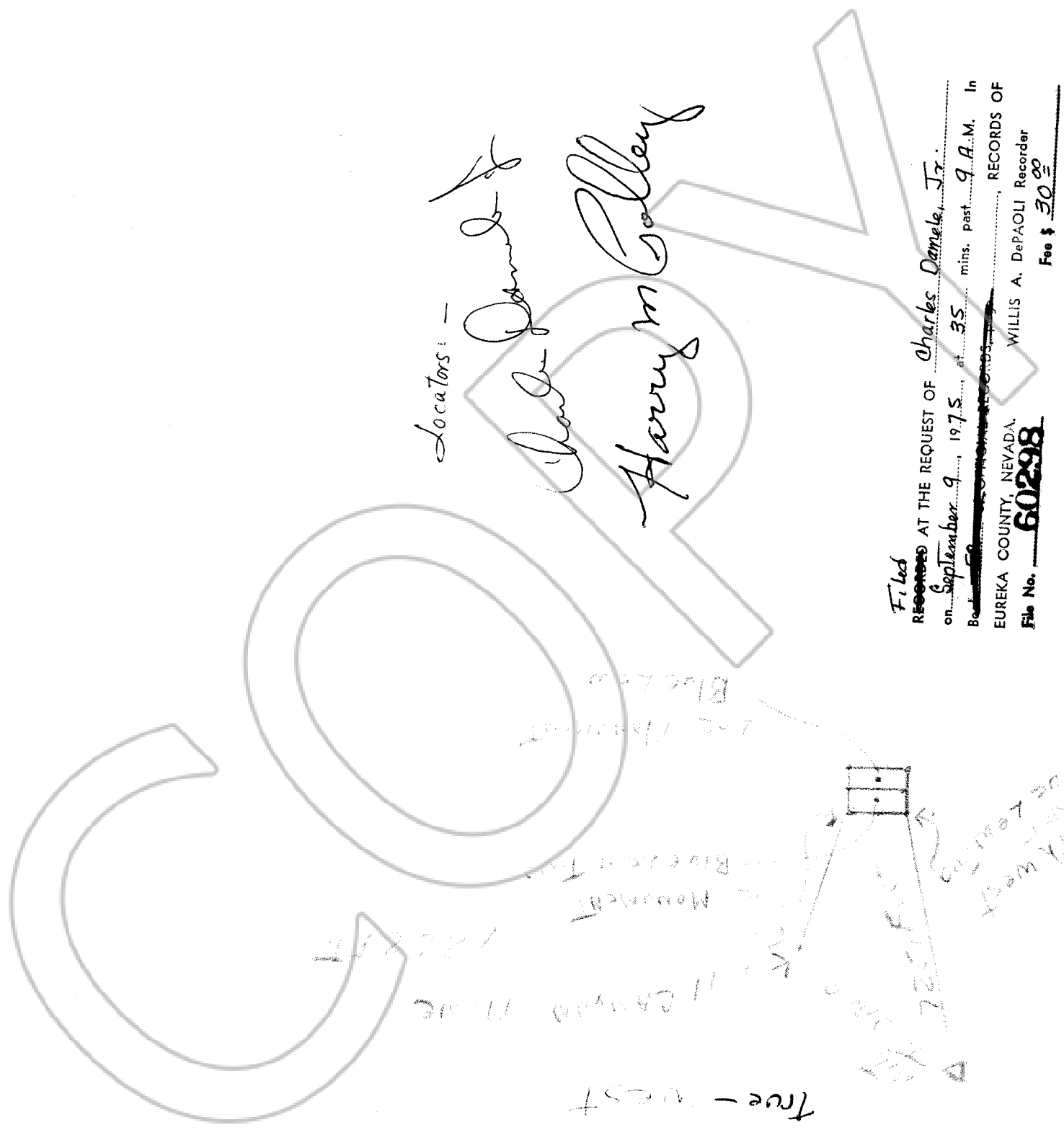

Locators: -
Charles Daniels
Harry M. Galley

Filed
 RECORDED AT THE REQUEST OF *Charles Daniels, Jr.*
 on *September 9, 1975* at *35* mins. past *9 A.M.* in
 EUREKA COUNTY, NEVADA. RECORDS OF
 WILLIS A. DePAOLI Recorder
 File No. **60298** Fee \$ **30.00**

Tree - South

1/4 inch = 1000 FT.

Tree - EAST

MAP OF Blue Lew & Blue Lew Two
Cortez Quadrangle
UNsurveyed LAND.

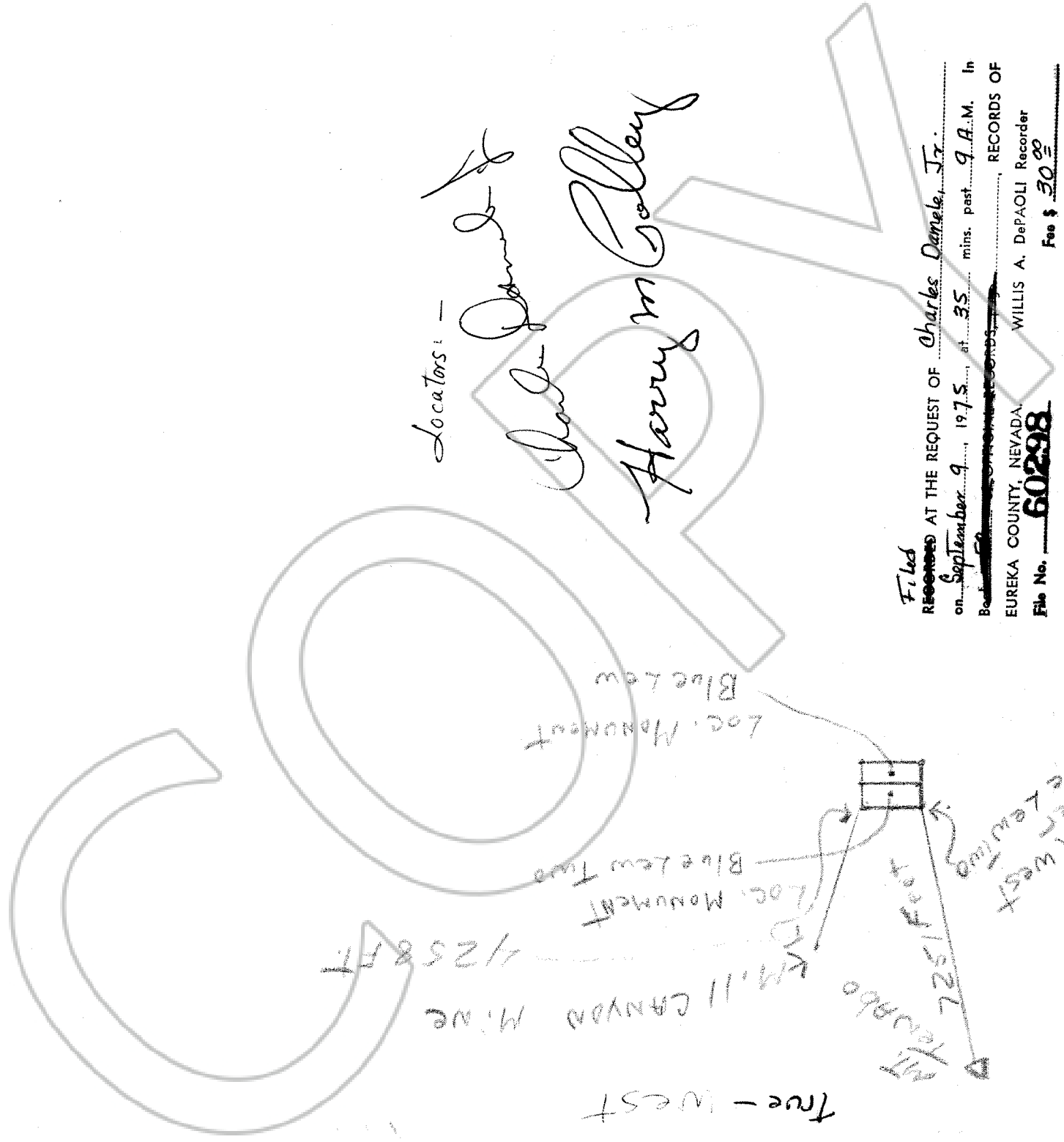

Locators: -
Robert Daniels
Harry M. Colley

Filed
 RECEIVED AT THE REQUEST OF Charles Daniels, Jr.
 on September 9, 1975, at 35 mins. past 9 A.M. In
 RECORDS OF
 EUREKA COUNTY, NEVADA. WILLIS A. DePAOLI Recorder
 File No. 60298 Fee \$ 30.00

1/4 inch = 1000 FT.

Tree - South

