

60584
STATE OF NEVADA
CERTIFICATE OF MINING LOCATION
Lode Claim on Public Domain

TO ALL WHOM IT MAY CONCERN:

This Mining Claim is named GAM 2 situated on land belonging to the United States of America located in Section 22, T 27N R 48E, MDM UNSUBDIV Mining District, EUREKA County, Nevada, and located for the purpose of exploration and purchase by JAMES J. OWENS a citizen of the United States, and agent for AMAX on this 11 day of OCT, 1975.

This claim is 1500 feet long and 600 feet wide with the discovery being in the center of the claim 10 feet E. of the E. End Center. The general course of this claim is E-W.

The DISCOVERY is tied to a natural or man made monument as follows: N. 295' + WEST 380 TO MM GAM WHICH IS A 2 1/2" x 5" PIPE AT EL. 7931' WHICH IS S 63 1/2 W. 6700' TO USMM No. 1

The location work consisted of making maps as provided in NRS 517.040.

All corners are marked by 4"x4"x5" POST with metal tags inscribed with the appropriate corner as shown on the following sketch.

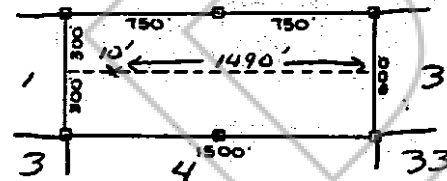

Dated and posted on the ground this 11 day of OCT, 1975.

Witness William J. Frakes

James J. Owens

Agent for AMAX

KEITH RHEA
12620 W CEDAR
P.O. BOX C
DENVER COLO
(303) 985-8701

STATE OF NEVADA SS
COUNTY OF Eureka

I hereby certify that the within instrument was filed and recorded at the request of James J. Owens

on November 17, 1975

at 11 A. M.,

Docket 53 of O/R Page 78

Witness my hand and official seal the day and year aforesaid.

William A. Metcalf
County Recorder

By _____
Deputy Recorder

60584

BOOK 53 PAGE 78