

CERTIFICATE OF MINING LOCATION  
Lode Claim on Public Domain

TO ALL WHOM IT MAY CONCERN:

This Mining Claim is named LAM 37 situated on land belonging to the United States of America located in Section 23, T27N, R42E, (MDC Survey) Mining District, EUREKA County, Nevada, and located for the purpose of exploration and purchase by JAMES J OWENS a citizen of the United States, and agent for AMAX on this 15 day of OCT, 1975.

This claim is 1500 feet long and 600 feet wide with the discovery being in the center of the claim 10 feet E of the W End Center. The general course of this claim is E+W

The DISCOVERY is tied to a natural or man made monument as follows: W 675' + N 205' TO MM/LAM WHICH IS A 2" x 1/2" S' PIPE AT EL. 7931' WHICH IS 513 1/2' W 6700' TO USMM N. #1

The location work consisted of making maps as provided in NRS 517.040.

All corners are marked by 4" x 4" x 5' POST with metal tags inscribed with the appropriate corner as shown on the following sketch.

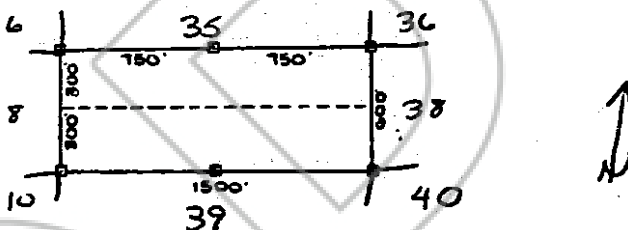

Dated and posted on the ground this 15 day of OCT, 1975.

Witness William J. Fraker

James J. Owens  
Agent for AMAX

KEITH RHEA  
12620 W. CEDAR  
P.O. Box C  
DENVER COLO  
(303) 985-8701

STATE OF NEVADA  
COUNTY OF EUREKA SS

I hereby certify that the within instrument was filed and recorded at the request of James J. Owens

Witness my hand and official seal the day and year aforesaid.  
William O. DePaolo  
County Recorder

on November 17, 1975  
at 11:00 A.M.

By \_\_\_\_\_  
Deputy Recorder

Docket 53 of OR Page 113