

STATE OF NEVADA
CERTIFICATE OF MINING LOCATION
LODE CLAIM ON PUBLIC DOMAIN

NOTICE IS HEREBY GIVEN that the SELRAT No. 26 lode mining claim has been located by AMSELCO MINERALS INC., a Delaware corporation, whose address is 1000 Bible Way, Suite 66, Reno, Nevada 89502. The general course of this claim is North 20° West. This claim is 1500 feet in length along the course of the claim, being 1490 feet from the point of discovery in a N20°W direction to the North end line of this claim, and 10 feet in a S20°E direction to the South end line of the claim. This claim is 600 feet in width, being 300 feet in width on each side of the center line of the claim.

This claim is located within the NE Quarter of Section 34, Township 18 North, Range 53 East, Mount Diablo Base and Meridian, Eureka Mining District, Eureka County, Nevada. The location ~~XXXXXXXX~~ of this claim is situated with reference to some natural object or permanent monument as follows: Corner No. 1 is located appx.: 1250 feet N82°W of claim location marker SRL.

The claim location marker SRL, a 3"x6" steel pipe, is located appx.: 1.93 mi N76°E from Gray's Peak; 2.50 mi NB°E from South Hill Peak; 0.55 mi S27°W from Surprise Peak.

The corners of this claim are marked by 4"x4" posts or 4" trees with metal tags inscribed with the appropriate corner number as shown on the following sketch and the accompanying claim map.

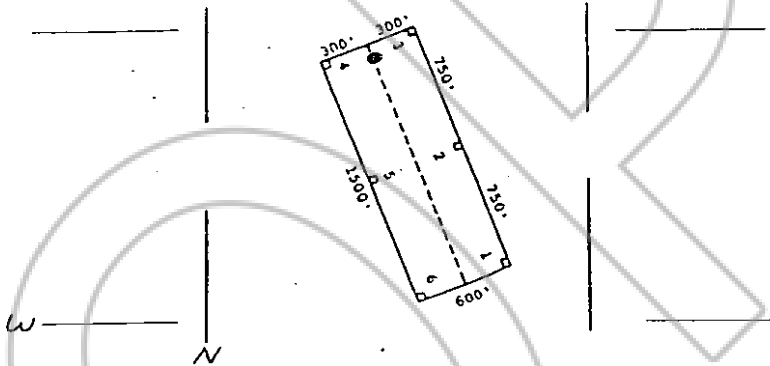

The location work consisted of making the maps as provided in NRS 517.040.

Dated and posted on the ground this 28 day of March, 1979.

Witnesses:

Locator:

AMSELCO MINERALS INC.

By [Signature]
Agent for
Amselco Minerals Inc.

STATE OF NEVADA)

COUNTY OF _____)

RECORDED AT THE REQUEST OF Amselco Minerals Inc.
on June 8, 1979 at 40 mins. past 2 P. M. In
Book 70 of OFFICIAL RECORDS, page 508 RECORDS OF
EUREKA COUNTY, NEVADA. WILLIS A. DePAOLI Recorder
File No. 68476 Fee \$ 3.00

I hereby certify that the within instrument was filed and recorded at the request of: _____

FILE NO. _____
on _____
at _____
Docket _____ Page _____

Witness my hand and official seal the day and year aforesaid.

County Recorder

By _____
Deputy Recorder

BOOK 70 PAGE 508