

68483

STATE OF NEVADA
 CERTIFICATE OF MINING LOCATION
 LOSE CLAIM ON PUBLIC DOMAIN

NOTICE IS HEREBY GIVEN that the SEL RAT No. 33 lode mining claim has been located by AMSELCO MINERALS INC., a Delaware corporation, whose address is 1000 Bible Way, Suite 66, Reno, Nevada 89502. The general course of this claim is North 3 West. This claim is 1500 feet in length along the course of the claim, being 10 feet from the point of discovery in a N3W direction to the North end line of this claim, and 1490 feet in a S3E direction to the South end line of the claim. This claim is 600 feet in width, being 300 feet in width on each side of the center line of the claim.

This claim is located within the SW Quarter of Section 27, Township 18 North, Range 53 East, Mount Diablo Base and Meridian, Eureka Mining District, Eureka County, Nevada. The location monument of this claim is situated with reference to some natural object or permanent monument as follows: Corner No. 1 is located appx.: 1050 feet N 63° W of claim location marker SR1

The claim location marker SR1, a 3"x6" steel pipe, is located appx.: 1.93 mi N76°E from Gray's Peak; 2.50 mi N8°E from South Hill Peak; 0.55 mi S27°W from Surprise Peak.

The corners of this claim are marked by 4"x4" posts or 4" trees with metal tags inscribed with the appropriate corner number as shown on the following sketch and the accompanying claim map.

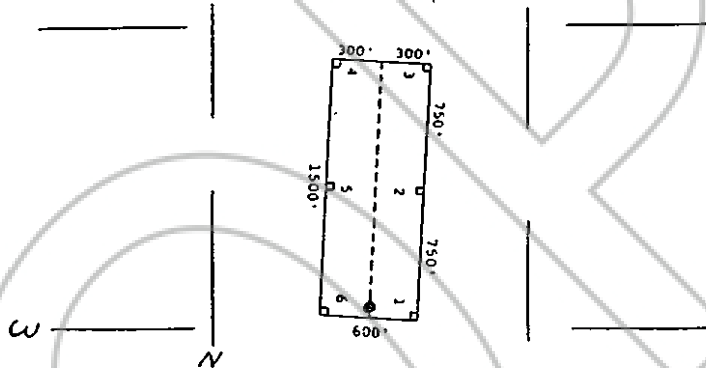

The location work consisted of making the maps as provided in NRS 517.040.

Dated and posted on the ground this 28 day of March, 1979.

Witnesses:

Locator:

AMSELCO MINERALS INC.

By [Signature]
 Agent for
 Amselco Minerals Inc.

STATE OF NEVADA)

COUNTY OF _____)

RECORDED AT THE REQUEST OF Amselco Minerals Inc.
 on June 8, 19 79 at 40 mins. past 2 P.M. in
 Book 70 of OFFICIAL RECORDS, page 515, RECORDS OF
 EUREKA COUNTY, NEVADA. WILLIS A. DePAOLI Recorder
 File No. 68483 Fee \$ 3.00

I hereby certify that the within instrument was filed and recorded at the request of: _____

FILE NO. _____

on _____

at _____

Docket _____ Page _____

Witness my hand and official seal the day and year aforesaid.

County Recorder

By _____

Deputy Recorder

BOOK 70 PAGE 515