

CERTIFICATE OF LOCATION

ALL PERSONS WILL TAKE NOTICE THAT:

1. The name of this claim is the Bear Lode # 5 Lode Mining Claim.
2. The date of this location is the 30th day of April, 1979, and is located by the undersigned adult citizen of the United States.
3. Said Claim is located in the SE quarter of section 19, Township 26 North, Range 53 East, Mount Diablo Meridian, Eureka County, Nevada, Mineral Hill Mining District. More particularly, the Discovery Monument, at the center of the North End Line of this claim is approximately 3500 feet South and 1900 feet West of the Northeast corner of sec. 19, T 26 N, R 53 E. The Center line bears South 1500 feet from this Discovery Monument, said claim including 300 feet on each side, including all dips, variations, spurs, angles and all veins, ledges or deposits of Barite, Silver, Gold and all other minerals, together with all water, timber and any other rights appurtenant allowed by the Laws of the State of Nevada and the United States of America.
4. A portion of the location work for this claim consisted of preparation of the maps required by NRS 517.040.

I hereby certify that in accordance with the provisions of the Mining Law, that there has been erected at the Discovery Point, at each corner, and at the Center of each End Line of said claim, a substantial, well marked monument, so that the boundaries thereof can be readily traced.

Dated this 19th day of July, 1979

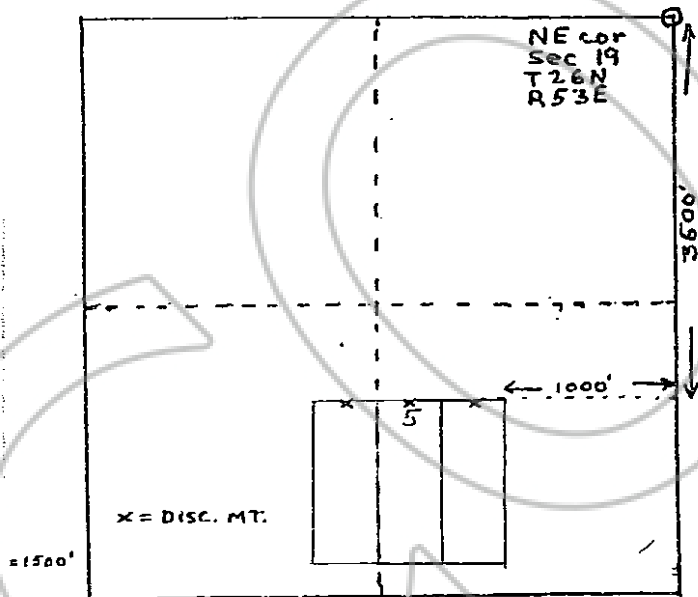

Locator: Paul S. Coupey  
68762 P.O. Box 2366  
 Denver, CO 80201

RECORDED AT THE REQUEST OF  
Paul S. Coupey  
 on July 25 1979  
 at 11 mins. past 8 A. M.  
 in Book 71 of OFFICIAL  
 RECORDS, page 319, RECORDS  
 OF EUREKA COUNTY, NEVADA  
 WILL A. DePAOLI  
 Recorder  
 File No. 68762 Fee \$ 3.00

BOOK 71 PAGE 319