

SOUTH CLAIM GROUP 1-32

ALL LOCATION POSTS ARE CENTERED AND 50' FROM CLAIM LINE, EXCEPT SOUTH NO. 58 WHICH IS CENTERED AND 600' FROM CLAIM LINE, AND SOUTH NO. 56 WHICH IS CENTERED AND 150' FROM CLAIM LINE. ALL CORNERS ARE 4" X 4" X 4 1/2" WOODEN POSTS MARKED WITH ALUMINUM DYMO TAPE. ALL CLAIMS ARE 1500' X 600', EXCEPT SOUTH NO. 34 AND NO. 35 WHICH ARE 1500' X 400', SOUTH NO. 33 AND NO. 58 WHICH ARE 1200' X 600', SOUTH NO. 56 WHICH IS 1200' X 450' AND SOUTH NO. 57 WHICH IS 1300' X 600'.

LOCATION OF POSTS (SOUTH NOS. 52, 56, & 58)	ALL OTHERS:
NO. 1 NORTH EAST CORNER	NO. 1 NORTH EAST CORNER
NO. 2 EAST SIDE CENTER	NO. 2 SOUTH EAST CORNER
NO. 3 SOUTH EAST CORNER	NO. 3 SOUTH SIDE CENTER
NO. 4 SOUTH WEST CORNER	NO. 4 SOUTH WEST CORNER
NO. 5 WEST SIDE CENTER	NO. 5 NORTH WEST CORNER
NO. 6 NORTH WEST CORNER	NO. 6 NORTH SIDE CENTER

70656

Filed  
 AT THE REQUEST OF Carlin Gold Mining Co.  
 on October 15, 1979 at 16 min. past 1 P. M. in  
 RECORDS OF  
 EUREKA COUNTY, NEVADA. WILLIS A. DePAOLI, Recorder  
 File No. 70656 Fee \$ 3.00



AMMENDED MAP SOUTH NO. 51

# SOUTH GROUP CLAIMS

LOCATED BY: CARLIN GOLD MINING CO.  
 P.O. BOX 979  
 CARLIN NEVADA 89822

DATE: JUNE 6, 1979  
 LYNN MINING DISTRICT  
 T 34 N ; R 50E M.D.B. & M. (SEC. 28 & 3)  
 SOUTH NO. 33-NO. 58' LODE CLAIMS

SCALE: 1" = 500'

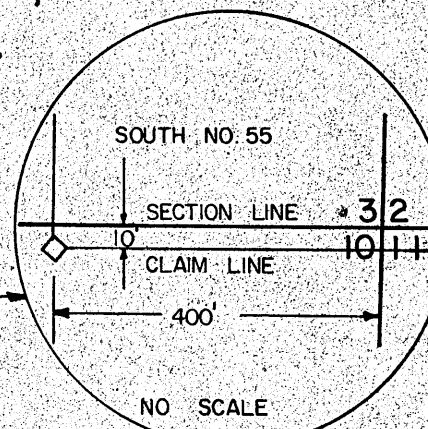

34 35  
4 3

35 36

3 2

36  
2

6  
7

7

4 3  
9 10

