

The SE cor. Sec 21 T24N R49E bears S60°W, 400 ft. from corner #1 of Claim U-42

Claims Located on Dec. 23 to 28, 1978  
 Located by J.R. Mangham agent for Earth Resources Co. 5920 McIntyre St. Golden, Co. 80401

All corners are 4' high 4" diameter cedar posts or trees.  
 • Location monuments

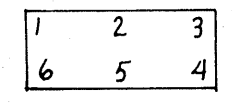

All claim posts numbered thus

JKG 11/19/79

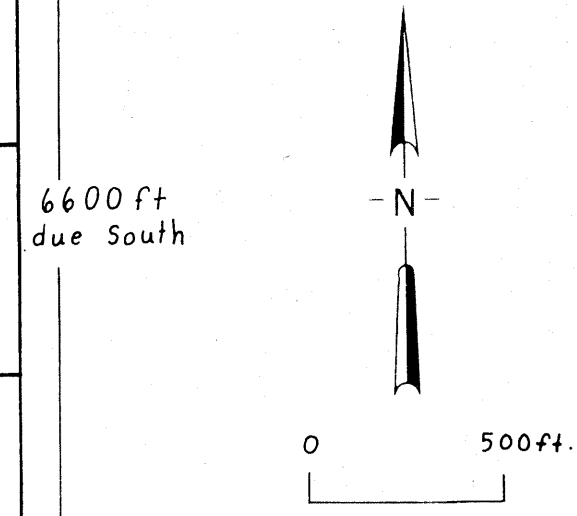

AMENDED MAP OF THE T-U-V-W LODE MINING CLAIMS  
 (Claims moved north and west with respect to SE corner Sec 21)

Located in Eureka Co. Nv. in an unknown mining district in

T24N R49E. Secs. 21, 22, and 27

Original claim map filed 2/20/79

File # 67832

Amended by W.B. Mackenzie  
*W. Bues*

Filed ~~November 30~~ AT THE REQUEST OF Earth Resources Company  
 on November 30, 1979, at 45 mins. past 10 A.M. In  
 \_\_\_\_\_, RECORDS OF  
 EUREKA COUNTY, NEVADA. WILLIS A. DePAOLI Recorder  
 File No. 71188 Fee \$ 570.00