

N.W. COR. SECTION #29 HUB IS IN

P.I. HUB, NOT IN

SEC #29 SEC #28  
SEC #32 SEC #33

SEC #33

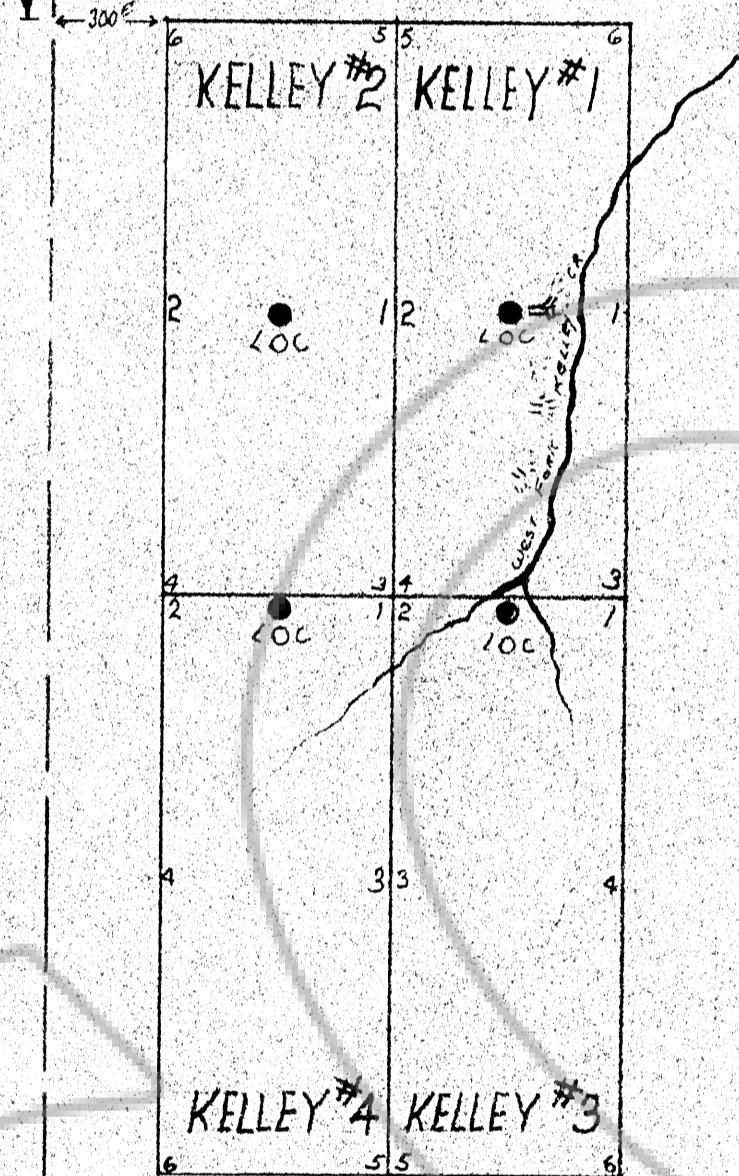

### KELLEY LEAD ZINC MINE

ANTELOPE MINING DISTRICT

T.24 N. R.50E SEC #33 M.D.B.M

EUREKA COUNTY, NEVADA

RICHARD L. GERISH NOV. 1979

OWNED BY R.GERISH & L.BRITTON

1" INCH = 500' FEET

SEC # 32 SEC #33

T.24N

R.50E

M.D.B.M

SEC # 33

RECORDED AT THE REQUEST OF R.L. Gerish  
 on Dec. 5, 1979, at 10 mins. past 1 P.M. &  
 of CHIEF CLERK, page 1 RECORDS OF  
 EUREKA COUNTY, NEVADA WILLIS A. DePAOLI Recorder  
 File No. 71235 Fee \$ 60