

STATE OF NEVADA
CERTIFICATE OF MINING LOCATION
LODE CLAIM ON PUBLIC DOMAIN

72597

NOTICE IS HEREBY GIVEN that the Selrat No. 139A lode mining claim has been located by AMERICAN SELCO INC. a New York corporation, whose address is 90 West Grove Street, Suite 100, Reno, Nevada 89509. The general course of this claim is N87°W. This claim is 1500 feet in length along the course of the claim, being 1490 feet from the point of discovery in a N87°W direction to the N^o 1^h end line of this claim, and 10 feet in a S87°E direction to the S^o 1^h end line of the claim. This claim is 600 feet in width, being 300 feet in width on each side of the center line of the claim.

This claim is located within the SE Quarter of Section 8, Township 18 North, Range 53 East, Mount Diablo Base and Meridian, unknown Mining District, Eureka County, Nevada. The location monument of this claim is situated with reference to some natural object or permanent monument as follows: Corner No. 1 of this claim is located appx. 18850 ft. N34°W from Claim Location Marker SRL. Claim Location

Marker SRL a 3' x 6' steel pipe, is located appx.: 1.93 mi. N76°E from Grays Peak; 2.50 mi. N8° E from South Hill Peak; 0.55 mi. S27° W from Surprise Peak.

The corners of this claim are marked by 4"x4" posts or 4" trees with metal tags inscribed with the appropriate corner number as shown on the following sketch and the accompanying claim map.

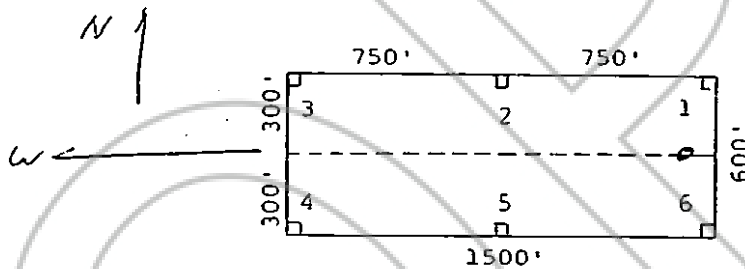

The location work consisted of making the maps as provided in NRS 517.040.

Dated and posted on the ground this 3 day of December, 1979.

Witnesses:

Locator:

AMERICAN SELCO INC.

By [Signature]
Agent for
American Selco Inc.

RECORDED AT THE REQUEST OF American Selco Inc.

STATE OF NEVADA)

on February 27, 19 80, at 45 mins. past 9 A. M. in

COUNTY OF _____)

) ss. Book 79 of OFFICIAL RECORDS, page 164, RECORDS OF

EUREKA COUNTY, NEVADA

WILLIS A. DePAOLI Recorder

File No. 72597

Fee \$ 3.00

I hereby certify that the within instrument was filed and recorded at the request of: _____

Witness my hand and official seal the day and year aforesaid.

FILE NO. _____

County Recorder

on _____

By _____
Deputy Recorder

at _____

Docket _____ Page _____

BOOK 79 PAGE 164

STATE OF NEVADA
CERTIFICATE OF MINING LOCATION
LODE CLAIM ON PUBLIC DOMAIN

72598

NOTICE IS HEREBY GIVEN that the Selrat No. 140 lode mining claim has been located by AMERICAN SELCO INC. a New York corporation, whose address is 90 West Grove Street, Suite 100, Reno, Nevada 89509. The general course of this claim is N67°W. This claim is 1500 feet in length along the course of the claim, being 10 feet from the point of discovery in a N67°W direction to the North end line of this claim, and 1490 feet in a S57°E direction to the South end line of the claim. This claim is 600 feet in width, being 300 feet in width on each side of the center line of the claim.

This claim is located within the SE Quarter of Section 8, Township 18 North, Range S3 East, Mount Diablo Base and Meridian, unknown Mining District, Eureka County, Nevada. The location monument of this claim is situated with reference to some natural object or permanent monument as follows: Corner No. 1 of this claim is located appx 1885 ft. N34°W from Claim Location Marker SRL. Claim Location

Marker SRL a 3' x 6' steel pipe, is located appx.: 1.93 mi. N76°E from Grays Peak; 2.50 mi. N8° E from South Hill Peak; 0.55 mi. S27° W from Surprise Peak.

The corners of this claim are marked by 4"x4" posts or 4" trees with metal tags inscribed with the appropriate corner number as shown on the following sketch and the accompanying claim map.

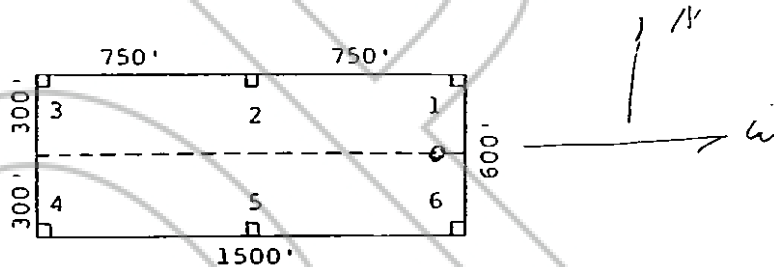

The location work consisted of making the maps as provided in NRS 517.040.

Dated and posted on the ground this 3 day of December, 1979.

Witnesses:

Locator:

AMERICAN SELCO INC.

By [Signature]
Agent for
American Selco Inc.

STATE OF NEVADA

COUNTY OF

RECORDED AT THE REQUEST OF American Selco Inc.
on February 27, 1980, at 45 mins. past 9 A.M. 1980
) S.S. Book 79 of OFFICIAL RECORDS, page 165 RECORDS OF
) EUREKA COUNTY, NEVADA WILLIS A. DePAOLI Recorder
File No. 72598 Fee 3.00

I hereby certify that the within instrument was filed and recorded at the request of:

FILE NO. _____
on _____
at _____
Docket _____ Page _____

Witness my hand and official seal the day and year aforesaid.

County Recorder

By _____
Deputy Recorder

BOOK 79 PAGE 165

STATE OF NEVADA
CERTIFICATE OF MINING LOCATION
LODE CLAIM ON PUBLIC DOMAIN

72599

NOTICE IS HEREBY GIVEN that the Selrat No. 141 lode mining claim has been located by AMERICAN SELCO INC. a New York corporation, whose address is 90 West Grove Street, Suite 100, Reno, Nevada 89509. The general course of this claim is N 87° W. This claim is 1500 feet in length along the course of the claim, being 1490 feet from the point of discovery in a N 87° W direction to the N 1/2 end line of this claim and 10 feet in a S 87° E direction to the S 1/4 end line of the claim. This claim is 600 feet in width, being 300 feet in width on each side of the center line of the claim.

This claim is located within the NE Quarter of Section 17, Township 18 North, Range 53 East, Mount Diablo Base and Meridian, unknown Mining District, Eureka County, Nevada. The location monument of this claim is situated with reference to some natural object or permanent monument as follows: Corner No. 1 of this claim is located appx. 7850 ft. N 36° W from Claim Location Marker SRI. Claim Location

Marker SRI a 3' x 6' steel pipe, is located appx.: 1.93 mi. N76°E from Grays Peak; 2.50 mi. N8° E from South Hill Peak; 0.55 mi. S27° W from Surprise Peak.

The corners of this claim are marked by 4"x4" posts or 4" trees with metal tags inscribed with the appropriate corner number as shown on the following sketch and the accompanying claim map.

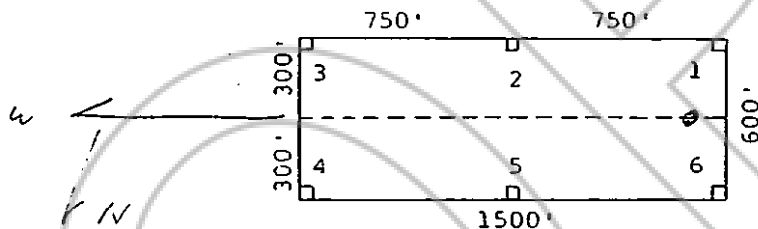

The location work consisted of making the maps as provided in NRS 517.040.

Dated and posted on the ground this 3 day of December 1979.

Witnesses:

Locator:

AMERICAN SELCO INC.

By [Signature]
Agent for
American Selco Inc.

STATE OF NEVADA

COUNTY OF _____

RECORDED AT THE REQUEST OF American Selco Inc.
on February 27, 19 80 at 45 mins. past 9 A.M. 19
) SS. Book 79 of OFFICIAL RECORDS, page 166 RECORDS OF
) EUREKA COUNTY, NEVADA WILLIS A. DePAOLI Recorder
Est. No. 72599 Fee \$ 3.00

I hereby certify that the within instrument was filed and recorded at the request of: _____

FILE NO. _____
on _____
at _____
Docket _____ Page _____

Witness my hand and official seal the day and year aforesaid

County Recorder

By _____
Deputy Recorder

BOOK 79 PAGE 166

72600

STATE OF NEVADA
CERTIFICATE OF MINING LOCATION
LODE CLAIM ON PUBLIC DOMAIN

NOTICE IS HEREBY GIVEN that the Selrat No. 142 lode mining claim has been located by AMERICAN SELCO INC. a New York corporation, whose address is 90 West Grove Street, Suite 100, Reno, Nevada 89509. The general course of this claim is N87°E. This claim is 1500 feet in length along the course of the claim, being 10 feet from the point of discovery in a N87°W direction to the Northern end line of this claim, and 1490 feet in a S87°E direction to the Southern end line of the claim. This claim is 600 feet in width, being 300 feet in width on each side of the center line of the claim.

This claim is located within the N/E Quarter of Section 17, Township 18 North, Range S3 East, Mount Diablo Base and Meridian, unknown Mining District, Eureka County, Nevada. The location monument of this claim is situated with reference to some natural object or permanent monument as follows: Corner No. 1 of this claim is located appx. 17650 ft. N36°W from Claim Location Marker SRI. Claim Location

Marker SRI a 3' x 6' steel pipe, is located appx.: 1.93 mi. N76°E from Grays Peak; 2.50 mi. N8° E from South Hill Peak; 0.55 mi. S27° W from Surprise Peak.

The corners of this claim are marked by 4"x4" posts or 4" trees with metal tags inscribed with the appropriate corner number as shown on the following sketch and the accompanying claim map.

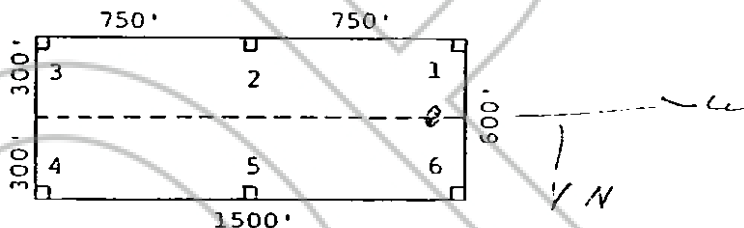

The location work consisted of making the maps as provided in NRS 517.040.

Dated and posted on the ground this 3 day of December, 1979.

Witnesses:

Locator:

AMERICAN SELCO INC.

By [Signature]
Agent for

American Selco Inc.

RECORDED AT THE REQUEST OF American Selco Inc.
on February 27, 19 80 at 45 mins. past 9 A.M. Ir
) ss. Book 79 of OFFICIAL RECORDS, page 167 RECORDS OF
) EUREKA COUNTY, NEVADA. WILLIS A. DePAOLI Recorder
File No. 72600 Fee \$ 3.00

STATE OF NEVADA

COUNTY OF _____

I hereby certify that the within instrument was filed and recorded at the request of: _____

FILE NO. _____

on _____

at _____

Docket _____ Page _____

Witness my hand and official seal the day and year aforesaid.

County Recorder

By _____
Deputy Recorder

BOOK 79 PAGE 167

STATE OF NEVADA
 CERTIFICATE OF MINING LOCATION
 LODE CLAIM ON PUBLIC DOMAIN

72601

NOTICE IS HEREBY GIVEN that the Selrat No. 143 lode mining claim has been located by AMERICAN SELCO INC. a New York corporation, whose address is 90 West Grove Street, Suite 100, Reno, Nevada 89509. The general course of this claim is N87°W. This claim is 1500 feet in length along the course of the claim, being 1490 feet from the point of discovery in a N87°W direction to the N. H. end line of this claim, and 10 feet in a S87°E direction to the South end line of the claim. This claim is 600 feet in width, being 300 feet in width on each side of the center line of the claim.

This claim is located within the NE Quarter of Section 17, Township 18 North, Range 53 East, Mount Diablo Base and Meridian, unknown Mining District, Eureka County, Nevada. The location monument of this claim is situated with reference to some natural object or permanent monument as follows: Corner No. 1 of this claim is located appx. 17850 ft. N30°W from Claim Location Marker SRI. Claim Location

Marker SRI a 3' x 6' steel pipe, is located appx.: 1.93 mi. N76°E from Grays Peak; 2.50 mi. N8° E from South Hill Peak; 0.55 mi. S27° W from Surprise Peak.

The corners of this claim are marked by 4"x4" posts or 4" trees with metal tags inscribed with the appropriate corner number as shown on the following sketch and the accompanying claim map.

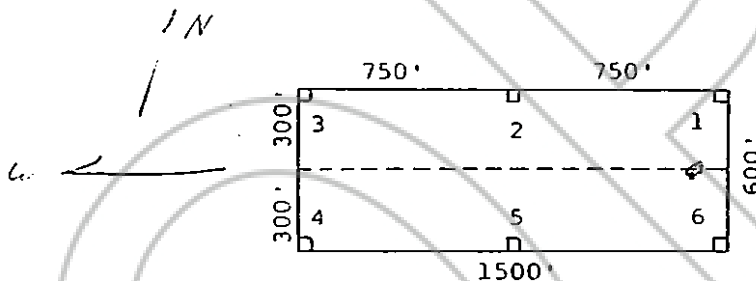

The location work consisted of making the maps as provided in NRS 517.040.

Dated and posted on the ground this 3 day of December, 1979.

Witnesses:

Locator:

AMERICAN SELCO INC.

By [Signature]
 Agent for
 American Selco Inc.

STATE OF NEVADA

COUNTY OF _____

RECORDED AT THE REQUEST OF American Selco Inc.
 on February 27, 19 80 at 45 mins. past 9 A. M. l.
) SS Book 79 of OFFICIAL RECORDS, page 168, RECORDS OF
) EUREKA COUNTY, NEVADA. WILLIS A. DePAOLI Recorder
 Ets No. 72601 Fee \$ 3.00

I hereby certify that the within instrument was filed and recorded at the request of: _____

FILE NO. _____
 on _____
 at _____
 Docket _____ Page _____

Witness my hand and official seal the day and year aforesaid

County Recorder _____

By _____
 Deputy Recorder

BOOK 79 PAGE 168

STATE OF NEVADA
 CERTIFICATE OF MINING LOCATION
 72602 : LODE CLAIM ON PUBLIC DOMAIN

NOTICE IS HEREBY GIVEN that the Selrat No. 144 lode mining claim has been located by AMERICAN SELCO INC. a New York corporation, whose address is 90 West Grove Street, Suite 100, Reno, Nevada 89509. The general course of this claim is N 87° W. This claim is 1500 feet in length along the course of the claim, being 10 feet from the point of discovery in a N 87° W direction to the North end line of this claim, and 1490 feet in a S 67° E direction to the South end line of the claim. This claim is 600 feet in width, being 300 feet in width on each side of the center line of the claim.

This claim is located within the N 1/4 Quarter of Section 17, Township 18 North, Range 53 East, Mount Diablo Base and Meridian, unknown Mining District, Eureka County, Nevada. The location monument of this claim is situated with reference to some natural object or permanent monument as follows: Corner No. 1 of this claim is located appx. 17850 ft. N 36° W from Claim Location Marker SRI. Claim Location

Marker SRI a 3' x 6' steel pipe, is located appx.: 1.93 mi. N76°E from Grays Peak; 2.50 mi. N8° E from South Hill Peak; 0.55 mi. S27° W from Surprise Peak.

The corners of this claim are marked by 4"x4" posts or 4" trees with metal tags inscribed with the appropriate corner number as shown on the following sketch and the accompanying claim map.

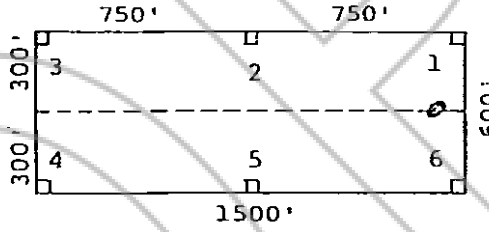

The location work consisted of making the maps as provided in NRS 517.040.

Dated and posted on the ground this 3 day of December, 1979.

Witnesses:

Locator:

AMERICAN SELCO INC.

By [Signature]
 Agent for
 American Selco Inc.

RECORDED AT THE REQUEST OF American Selco Inc.
 on February 27, 19 80 at 45 mins. past 9 A.M. L.
) ss. Book 79 of OFFICIAL RECORDS, page 169, RECORDS OF
 EUREKA COUNTY, NEVADA. WILLIS A. DePAOLI Recorder
 File No. 72602 Fee \$ 3.00

STATE OF NEVADA)

COUNTY OF _____)

I hereby certify that the within instrument was filed and recorded at the request of: _____

Witness my hand and official seal the day and year aforesaid.

FILE NO. _____
 on _____
 at _____

County Recorder

Docket _____ Page _____

By _____
 Deputy Recorder

BOOK 79 PAGE 169

72603

STATE OF NEVADA
CERTIFICATE OF MINING LOCATION
LODE CLAIM ON PUBLIC DOMAIN

NOTICE IS HEREBY GIVEN that the Selrat No. 145 lode mining claim has been located by AMERICAN SELCO INC. a New York corporation, whose address is 90 West Grove Street, Suite 100, Reno Nevada 89509. The general course of this claim is N87°W. This claim is 1500 feet in length along the course of the claim, being 1490 feet from the point of discovery in a N87°W direction to the North end line of this claim, and 10 feet in a S87°E direction to the South end line of the claim. This claim is 600 feet in width, being 300 feet in width on each side of the center line of the claim.

This claim is located within the NE 17 Quarter of Section 17, Township 18 North, Range 53 East, Mount Diablo Base and Meridian, unknown Mining District, Eureka County, Nevada. The location monument of this claim is situated with reference to some natural object or permanent monument as follows: Corner No. 1 of this claim is located appx. 16850 ft. N. 37° W. from Claim Location Marker SRI. Claim Location Marker SRI a 3' x 6' steel pipe, is located appx.: 1.93 mi. N76°E from Grays Peak; 2.50 mi. N8° E from South Hill Peak; 0.55 mi. S27° W from Surprise Peak.

The corners of this claim are marked by 4"x4" posts or 4" trees with metal tags inscribed with the appropriate corner number as shown on the following sketch and the accompanying claim map.

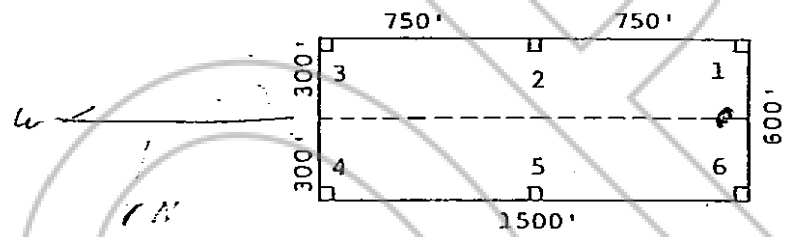

The location work consisted of making the maps as provided in NRS 517.040.

Dated and posted on the ground this 12 day of December 1979.

Witnesses:

Locator:

AMERICAN SELCO INC.

By [Signature]
Agent for
American Selco Inc.

STATE OF NEVADA
COUNTY OF _____

RECORDED AT THE REQUEST OF American Selco Inc.
on February 27, 1980, at 45 mins. past 9 A. M. In
) ss. Book 79 of OFFICIAL RECORDS, page 170, RECORDS OF
) EUREKA COUNTY, NEVADA. WILLIS A. DePAOLI Recorder
File No. 72603 Fee \$ 3.00

I hereby certify that the within instrument was filed and recorded at the request of: _____
FILE NO. _____
on _____
at _____
Docket _____ Page _____

Witness my hand and official seal the day and year aforesaid.

County Recorder

By _____
Deputy Recorder

BOOK 79 PAGE 170

STATE OF NEVADA
 CERTIFICATE OF MINING LOCATION
 LODE CLAIM ON PUBLIC DOMAIN

72604

NOTICE IS HEREBY GIVEN that the Selrat No. 146 lode mining claim has been located by AMERICAN SELCO INC. a New York corporation, whose address is 90 West Grove Street, Suite 100, Reno, Nevada 89509. The general course of this claim is N 87° W. This claim is 1500 feet in length along the course of the claim, being 10 feet from the point of discovery in a N 87° W direction to the North end line of this claim, and 1490 feet in a S 87° E direction to the South end line of the claim. This claim is 600 feet in width, being 300 feet in width on each side of the center line of the claim.

This claim is located within the NE Quarter of Section 17, Township 18 North, Range 53 East, Mount Diablo Base and Meridian, unknown Mining District, Eureka County, Nevada. The location monument of this claim is situated with reference to some natural object or permanent monument as follows: Corner No. 1 of this claim is located appx. 16850 ft. N 37° W from Claim Location Marker SR1. Claim Location

Marker SR1 a 3' x 6' steel pipe, is located appx.: 1.93 mi. N76°E from Grays Peak; 2.50 mi. N8° E from South Hill Peak; 0.55 mi. S27° W from Surprise Peak.

The corners of this claim are marked by 4"x4" posts or 4" trees with metal tags inscribed with the appropriate corner number as shown on the following sketch and the accompanying claim map.

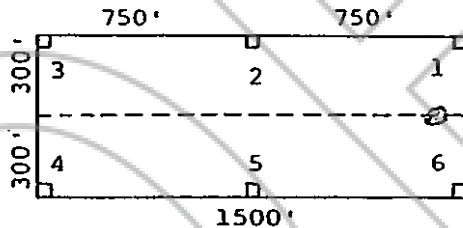

The location work consisted of making the maps as provided in NRS 517.040.

Dated and posted on the ground this 12 day of December, 1979.

Witnesses:

Locator:

AMERICAN SELCO INC.

By

[Signature]
 Agent for
 American Selco Inc.

STATE OF NEVADA

COUNTY OF _____

RECORDED AT THE REQUEST OF American Selco Inc.
 on February 27, 19 80, at 45 mins. past 9 A. M. in
) ss. Book 79 of OFFICIAL RECORDS, page 171, RECORDS OF
) EUREKA COUNTY, NEVADA. WILLIS A. DePAOLI Recorder
 File No. 72604 Fee 3.00

I hereby certify that the within instrument was filed and recorded at the request of:

FILE NO. _____
 on _____
 at _____
 Docket _____ Page _____

Witness my hand and official seal the day and year aforesaid.

County Recorder

By _____
 Deputy Recorder

BOOK 79 PAGE 171

STATE OF NEVADA
 CERTIFICATE OF MINING LOCATION
 LOSE CLAIM ON PUBLIC DOMAIN

72605

NOTICE IS HEREBY GIVEN that the Selrat No. 147 lode mining claim has been located by AMERICAN SELCO INC. a New York corporation, whose address is 90 West Grove Street, Suite 100, Reno, Nevada 89509. The general course of this claim is N87°W. This claim is 1500 feet in length along the course of the claim, being 1490 feet from the point of discovery in a N87°W direction to the Northern end line of this claim, and 10 feet in a S87°E direction to the South end line of the claim. This claim is 600 feet in width, being 300 feet in width on each side of the center line of the claim.

This claim is located within the NE Quarter of Section 17, Township 18 North, Range 53 East, Mount Diablo Base and Meridian, unknown Mining District, Eureka County, Nevada. The location monument of this claim is situated with reference to some natural object or permanent monument as follows: Corner No. 1 of this claim is located appx. 6850 ft. N37°W from Claim Location Marker SRI. Claim Location

Marker SRI a 3' x 6' steel pipe, is located appx.: 1.93 mi. N76°E from Grays Peak; 2.50 mi. N8° E from South Hill Peak; 0.55 mi. S27° W from Surprise Peak.

The corners of this claim are marked by 4"x4" posts or 4" trees with metal tags inscribed with the appropriate corner number as shown on the following sketch and the accompanying claim map.

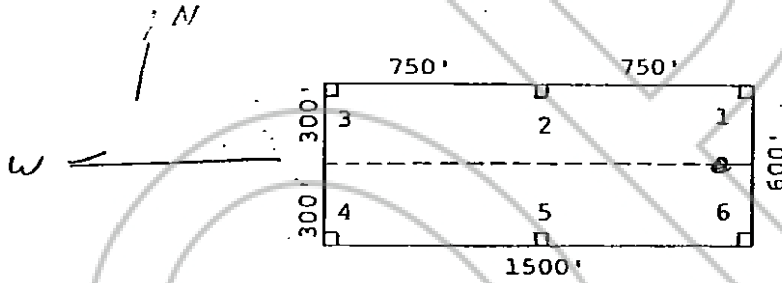

The location work consisted of making the maps as provided in NRS 517.040.

Dated and posted on the ground this 12 day of December 1979.

Witnesses:

Locator:

AMERICAN SELCO INC.

By [Signature]
 Agent for
 American Selco Inc.

RECORDED AT THE REQUEST OF American Selco Inc.
 on February 27, 1980, at 45 mins. past 9 A.M. In
) ss. Book 79 of OFFICIAL RECORDS, page 172, RECORDS OF
) EUREKA COUNTY, NEVADA. WILLIS A. DePAOLI Recorder
 File No. 72605 Fee \$ 3.00

STATE OF NEVADA

COUNTY OF _____

I hereby certify that the within instrument was filed and recorded at the request of: _____

FILE NO. _____

on _____

at _____

Docket _____ Page _____

Witness my hand and official seal the day and year aforesaid.

County Recorder

By _____
 Deputy Recorder

BOOK 79 PAGE 172

NOTICE IS HEREBY GIVEN that the Selrat No. 148 lode mining claim has been located by AMERICAN SELCO INC. a New York corporation, whose address is 90 West Grove Street, Suite 100, Reno, Nevada 89509. The general course of this claim is N87°W. This claim is 1500 feet in length along the course of the claim, being 10 feet from the point of discovery in a N87°W direction to the North end line of this claim, and 1490 feet in a S87°E direction to the South end line of the claim. This claim is 600 feet in width, being 300 feet in width on each side of the center line of the claim.

This claim is located within the NE Quarter of Section 17, Township 18 North, Range 53 East, Mount Diablo Base and Meridian, unknown Mining District, Eureka County, Nevada. The location monument of this claim is situated with reference to some natural object or permanent monument as follows: Corner No. 1 of this claim is located appx. 16850 ft. N37°W from Claim Location Marker SRL. Claim Location

Marker SRL a 3' x 6' steel pipe, is located appx.: 1.93 mi. N76°E from Grays Peak; 2.50 mi. N8° E from South Hill Peak; 0.55 mi. S27° W from Surprise Peak.

The corners of this claim are marked by 4"x4" posts or 4" trees with metal tags inscribed with the appropriate corner number as shown on the following sketch and the accompanying claim map.

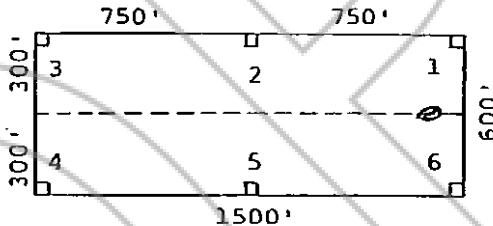

The location work consisted of making the maps as provided in NRS 517.040.

Dated and posted on the ground this 12 day of December, 1979.

Witnesses:

Locator:

AMERICAN SELCO INC.

By [Signature]
Agent for
American Selco Inc.

RECORDED AT THE REQUEST OF American Selco Inc.
on February 27, 19 80, at 45 mins. past 9 A.M. in
) ss. Book 79 of OFFICIAL RECORDS, page 173, RECORDS OF
) EUREKA COUNTY, NEVADA. WILLIS A. DePAOLI Recorder
File No. 72606 Fee \$ 3.00

STATE OF NEVADA)

COUNTY OF _____)

I hereby certify that the within instrument was filed and recorded at the request of: _____

FILE NO. _____
on _____
at _____
Docket _____ Page _____

Witness my hand and official seal the day and year aforesaid.

County Recorder

By _____
Deputy Recorder

BOOK 79 PAGE 173

CERTIFICATE OF MINING LOCATION
LODE CLAIM ON PUBLIC DOMAIN

72607

NOTICE IS HEREBY GIVEN that the Selrat No. 149 lode mining claim has been located by AMERICAN SELCO INC. a New York corporation, whose address is 90 West Grove Street, Suite 100, Reno, Nevada 89509. The general course of this claim is N 87° W. This claim is 1500 feet in length along the course of the claim, being 1490 feet from the point of discovery in a N 87° W direction to the North end line of this claim, and 10 feet in a S 87° E direction to the South end line of the claim. This claim is 600 feet in width, being 300 feet in width on each side of the center line of the claim.

This claim is located within the NE Quarter of Section 17, Township 18 North, Range S3 East, Mount Diablo Base and Meridian, unknown Mining District, Eureka County, Nevada. The location monument of this claim is situated with reference to some natural object or permanent monument as follows: Corner No. 1 of this claim is located appx. 15900ft. N 40° W from Claim Location Marker SRI. Claim Location

Marker SRI a 3' x 6' steel pipe, is located appx.: 1.93 mi. N76°E from Grays Peak; 2.50 mi. N8° E from South Hill Peak; 0.55 mi. S27° W from Surprise Peak.

The corners of this claim are marked by 4"x4" posts or 4" trees with metal tags inscribed with the appropriate corner number as shown on the following sketch and the accompanying claim map.

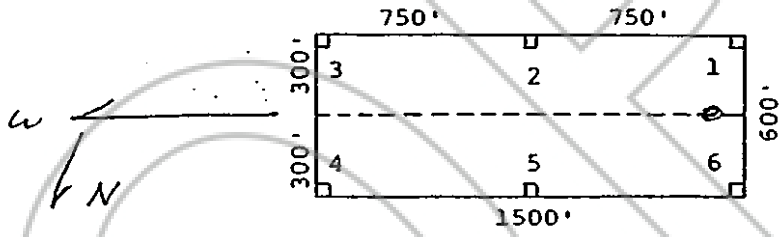

The location work consisted of making the maps as provided in NRS 517.040.

Dated and posted on the ground this 13 day of December, 1979.

Witnesses:

Locator:

AMERICAN SELCO INC.
By [Signature]
Agent for
American Selco Inc.

STATE OF NEVADA)
COUNTY OF _____)

RECORDED AT THE REQUEST OF American Selco Inc.
on February 27, 19 80 at 45 mins. past 9 A.M. P.
) SS Book 79 of OFFICIAL RECORDS, page 174, RECORDS OF
EUREKA COUNTY, NEVADA, WILLIS A. DePAOLI Recorder
File No. 72607 Fee \$ 3.00

I hereby certify that the within instrument was filed and recorded at the request of: _____
FILE NO. _____
on _____
at _____
Docket _____ Page _____

Witness my hand and official seal the day and year aforesaid.

County Recorder
By _____
Deputy Recorder

BOOK 79 PAGE 174

72608

NOTICE IS HEREBY GIVEN that the Selrat No. 150 lode mining claim has been located by AMERICAN SELCO INC. a New York corporation, whose address is 90 West Grove Street, Suite 100, Reno, Nevada 89509. The general course of this claim is N87°W. This claim is 1500 feet in length along the course of the claim, being 10 feet from the point of discovery in a N87°W direction to the Northern end line of this claim, and 1490 feet in a S87°E direction to the South end line of the claim. This claim is 600 feet in width, being 300 feet in width on each side of the center line of the claim.

This claim is located within the NE Quarter of Section 17, Township 18 North, Range 53 East, Mount Diablo Base and Meridian, unknown Mining District, Eureka County, Nevada. The location monument of this claim is situated with reference to some natural object or permanent monument as follows: Corner No.1 of this claim is located appx. 15900 ft. N40°W from Claim Location Marker SR1. Claim Location

Marker SR1 a 3' x 6' steel pipe, is located appx.: 1.93 mi. N76°E from Grays Peak; 2.50 mi. N8° E from South Hill Peak; 0.55 mi. S27° W from Surprise Peak.

The corners of this claim are marked by 4"x4" posts or 4" trees with metal tags inscribed with the appropriate corner number as shown on the following sketch and the accompanying claim map.

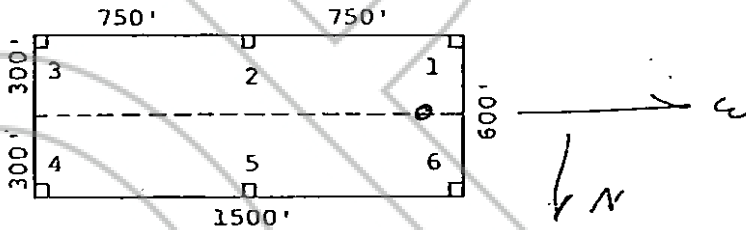

The location work consisted of making the maps as provided in NRS 517.040.

Dated and posted on the ground this 13 day of December, 1979.

Witnesses:

Locator:

AMERICAN SELCO INC.

By [Signature]
Agent for
American Selco Inc.

RECORDED AT THE REQUEST OF American Selco Inc.
on February 27, 19 80, at 45 mins. past 9 A. M. In
) SS Book 79 of OFFICIAL RECORDS, page 175, RECORDS OF
) EUREKA COUNTY, NEVADA. WILLIS A. DePAOLI Recorder
Ede No. 72608 Fee \$ 3.00

STATE OF NEVADA

COUNTY OF _____

I hereby certify that the within instrument was filed and recorded at the request of: _____
FILE NO. _____
on _____
at _____
Docket _____ Page _____

Witness my hand and official seal the day and year aforesaid.

County Recorder

By _____
Deputy Recorder
BOOK 79 PAGE 175

STATE OF NEVADA
 CERTIFICATE OF MINING LOCATION
 LODE CLAIM ON PUBLIC DOMAIN

72609

NOTICE IS HEREBY GIVEN that the Selrat No. 151 lode mining claim has been located by AMERICAN SELCO INC. a New York corporation, whose address is 90 West Grove Street, Suite 100, Reno, Nevada 89509. The general course of this claim is N 87° W. This claim is 1500 feet in length along the course of the claim, being 1490 feet from the point of discovery in a N 87° W direction to the N 60° E end line of this claim, and 10 feet in a S 87° E direction to the South end line of the claim. This claim is 600 feet in width, being 300 feet in width on each side of the center line of the claim.

This claim is located within the SE Quarter of Section 17, Township 18 North, Range 53 East, Mount Diablo Base and Meridian, unknown Mining District, Eureka County, Nevada. The location monument of this claim is situated with reference to some natural object or permanent monument as follows: Corner No. 1 of this claim is located appx. 1,590 ft. N 40° W from Claim Location Marker SRI. Claim Location

Marker SRI a 3' x 6' steel pipe, is located appx.: 1.93 mi. N76°E from Grays Peak; 2.50 mi. N8° E from South Hill Peak; 0.55 mi. S27° W from Surprise Peak.

The corners of this claim are marked by 4"x4" posts or 4" trees with metal tags inscribed with the appropriate corner number as shown on the following sketch and the accompanying claim map.

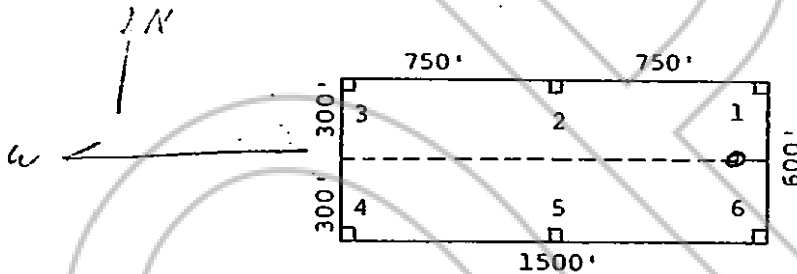

The location work consisted of making the maps as provided in NRS 517.040.

Dated and posted on the ground this 13 day of December, 1979.

Witnesses:

Locator:

AMERICAN SELCO INC.

By [Signature]
 Agent for
 American Selco Inc.

STATE OF NEVADA)

COUNTY OF _____)

RECORDED AT THE REQUEST OF American Selco Inc.
 on February 27, 19 80 at 45 mins. past 9 A. M. in
) ss. Book 79 of OFFICIAL RECORDS, page 176, RECORDS OF
 EUREKA COUNTY, NEVADA. WILLIS A. DePAOLI Recorder
 File No. 72609 Fee \$ 3.00

I hereby certify that the within instrument was filed and recorded at the request of: _____

FILE NO. _____
 on _____
 at _____
 Docket _____ Page _____

Witness my hand and official seal the day and year aforesaid.

County Recorder _____

By _____
 Deputy Recorder

BOOK 79 PAGE 176

72610

STATE OF NEVADA
CERTIFICATE OF MINING LOCATION
LODE CLAIM ON PUBLIC DOMAIN

NOTICE IS HEREBY GIVEN that the Selrat No. 152 lode mining claim has been located by AMERICAN SELCO INC. a New York corporation, whose address is 90 West Grove Street, Suite 100, Reno, Nevada 89509. The general course of this claim is N67°W. This claim is 1500 feet in length along the course of the claim, being 10 feet from the point of discovery in a N67°W direction to the North end line of this claim, and 1490 feet in a S87°E direction to the South end line of the claim. This claim is 600 feet in width, being 300 feet in width on each side of the center line of the claim.

This claim is located within the SE Quarter of Section 17, Township 18 North, Range S3 East, Mount Diablo Base and Meridian, unknown Mining District, Eureka County, Nevada. The location monument of this claim is situated with reference to some natural object or permanent monument as follows: Corner No. 1 of this claim is located appx. 1590 ft. N40°W from Claim Location Marker SRL. Claim Location

Marker SRL a 3' x 6' steel pipe, is located appx.: 1.93 mi. N76°E from Grays Peak; 2.50 mi. N8° E from South Hill Peak; 0.55 mi. S27° W from Surprise Peak.

The corners of this claim are marked by 4"x4" posts or 4" trees with metal tags inscribed with the appropriate corner number as shown on the following sketch and the accompanying claim map.

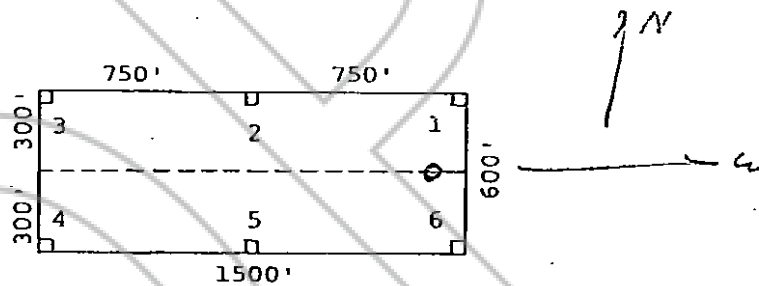

The location work consisted of making the maps as provided in NRS 517.040.

Dated and posted on the ground this 13 day of December, 1979.

Witnesses:

Locator:

AMERICAN SELCO INC.

By [Signature]
Agent for
American Selco Inc.

STATE OF NEVADA

COUNTY OF _____

RECORDED AT THE REQUEST OF American Selco Inc.
on February 27, 1980, at 45 mins. past 9 A. M. In
Book 79 of OFFICIAL RECORDS, page 177, RECORDS OF
EUREKA COUNTY, NEVADA. WILLIS A. DePAOLI Recorder
File No. 72610 Fee \$ 3.00

I hereby certify that the within instrument was filed and recorded at the request of: _____

Witness my hand and official seal the day and year aforesaid.

FILE NO. _____
on _____
at _____
Docket _____ Page _____

County Recorder

By _____
Deputy Recorder

BOOK 79 PAGE 177

72611

STATE OF NEVADA
CERTIFICATE OF MINING LOCATION
LODE CLAIM ON PUBLIC DOMAIN

NOTICE IS HEREBY GIVEN that the Selrat No. 153 lode mining claim has been located by AMERICAN SELCO INC., a New York corporation, whose address is 90 West Grove Street, Suite 100, Reno, Nevada 89509. The general course of this claim is N87°W. This claim is 1500 feet in length along the course of the claim, being 1490 feet from the point of discovery in a N87°W direction to the N^W 1/4 end line of this claim, and 10 feet in a S87°E direction to the South end line of the claim. This claim is 600 feet in width, being 300 feet in width on each side of the center line of the claim.

This claim is located within the SE Quarter of Section 17, Township 18 North, Range 53 East, Mount Diablo Base and Meridian, unknown Mining District, Eureka County, Nevada. The location monument of this claim is situated with reference to some natural object or permanent monument as follows: Corner No. 1 of this claim is located appx. 1490 ft. N43°W from Claim Location Marker SRI. Claim Location

Marker SRI a 3' x 6' steel pipe, is located appx.: 1.93 mi. N76°E from Grays Peak; 2.50 mi. N8° E from South Hill Peak; 0.55 mi. S27° W from Surprise Peak.

The corners of this claim are marked by 4"x4" posts or 4" trees with metal tags inscribed with the appropriate corner number as shown on the following sketch and the accompanying claim map.

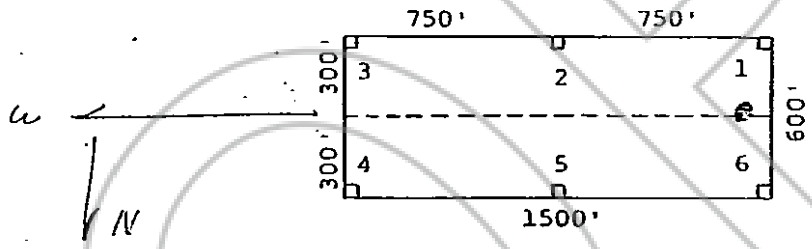

The location work consisted of making the maps as provided in NRS 517.040.

Dated and posted on the ground this 14 day of December 1979.

Witnesses:

Locator:

AMERICAN SELCO INC.

By [Signature]
Agent for
American Selco Inc.

STATE OF NEVADA)
COUNTY OF _____)

RECORDED AT THE REQUEST OF American Selco Inc.
on February 27, 1980 at 45 mins. past 9 A. M. Ir.
) ss Book 79 of OFFICIAL RECORDS, page 178, RECORDS OF
EUREKA COUNTY, NEVADA. WILLIS A. DePAOLI Recorder
File No. 72611 Fee \$ 3.00

I hereby certify that the within instrument was filed and recorded at the request of: _____
FILE NO. _____
on _____
at _____
Docket _____ Page _____

Witness my hand and official seal the day and year aforesaid.

County Recorder
By _____
Deputy Recorder

BOOK 79 PAGE 178

72612

CERTIFICATE OF MINING LOCATION
LODE CLAIM ON PUBLIC DOMAIN

NOTICE IS HEREBY GIVEN that the Selrat No. 154 lode mining claim has been located by AMERICAN SELCO INC. a New York corporation, whose address is 90 West Grove Street, Suite 100, Reno, Nevada 89509. The general course of this claim is N 87° W. This claim is 1500 feet in length along the course of the claim, being 10 feet from the point of discovery in a N 87° W direction to the North end line of this claim, and 1490 feet in a S 87° E direction to the South end line of the claim. This claim is 600 feet in width, being 300 feet in width on each side of the center line of the claim.

This claim is located within the SE Quarter of Section 17, Township 18 North, Range S 3 East, Mount Diablo Base and Meridian, unknown Mining District, Eureka County, Nevada. The location monument of this claim is situated with reference to some natural object or permanent monument as follows: Corner No. 1 of this claim is located appx. 1490 ft.

N 43° W from Claim Location Marker SRI. Claim Location Marker SRI a 3' x 6' steel pipe, is located appx.: 1.93 mi. N76°E from Grays Peak; 2.50 mi. N8° E from South Hill Peak; 0.55 mi. S27° W from Surprise Peak.

The corners of this claim are marked by 4"x4" posts or 4" trees with metal tags inscribed with the appropriate corner number as shown on the following sketch and the accompanying claim map.

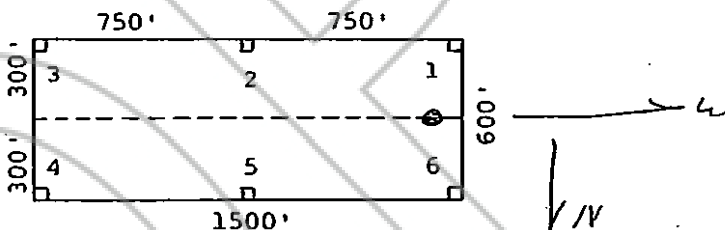

The location work consisted of making the maps as provided in NRS 517.040.

Dated and posted on the ground this 14 day of December, 1979.

Witnesses:

Locator:

AMERICAN SELCO INC.

By [Signature]
Agent for
American Selco Inc.

STATE OF NEVADA

COUNTY OF _____

RECORDED AT THE REQUEST OF American Selco Inc.
on February 27, 1980 at 45 mins. past 9 A. M. In
SS. Book 79 of OFFICIAL RECORDS, page 179, RECORDS OF
EUREKA COUNTY, NEVADA. WILLIS A. DePAOLI Recorder
File No. 72612 Fee \$ 3.00

I hereby certify that the within instrument was filed and recorded at the request of: _____
FILE NO. _____
on _____
at _____
Docket _____ Page _____

Witness my hand and official seal the day and year aforesaid

County Recorder

By _____
Deputy Recorder

BOOK 79 PAGE 179

72613

STATE OF NEVADA
CERTIFICATE OF MINING LOCATION
LODE CLAIM ON PUBLIC DOMAIN

NOTICE IS HEREBY GIVEN that the Selrat No. 155 lode mining claim has been located by AMERICAN SELCO INC. a New York corporation, whose address is 90 West Grove Street, Suite 100, Reno, Nevada 89509. The general course of this claim is N 87° W. This claim is 1500 feet in length along the course of the claim, being 1490 feet from the point of discovery in a N 87° W direction to the North end line of this claim, and 10 feet in a S 87° E direction to the South end line of the claim. This claim is 600 feet in width, being 300 feet in width on each side of the center line of the claim.

This claim is located within the SE Quarter of Section 17, Township 18 North, Range 53 East, Mount Diablo Base and Meridian, unknown Mining District, Eureka County, Nevada. The location monument of this claim is situated with reference to some natural object or permanent monument as follows: Corner No. 1 of this claim is located appx. 1490 ft.

N 43° W from Claim Location Marker SRI. Claim Location Marker SRI a 3' x 6' steel pipe, is located appx.: 1.93 mi. N76°E from Grays Peak; 2.50 mi. N8° E from South Hill Peak; 0.55 mi. S27° W from Surprise Peak.

The corners of this claim are marked by 4"x4" posts or 4" trees with metal tags inscribed with the appropriate corner number as shown on the following sketch and the accompanying claim map.

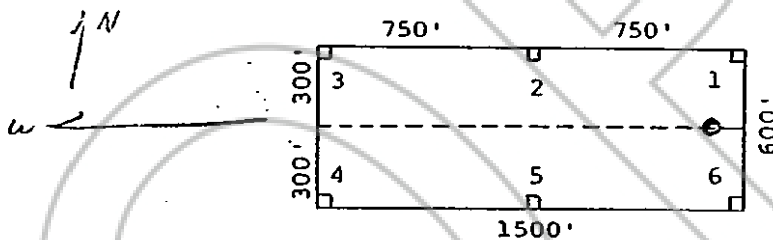

The location work consisted of making the maps as provided in NRS 517.040.

Dated and posted on the ground this 14 day of December, 1979.

Witnesses:

Locator:

AMERICAN SELCO INC.

By [Signature]
Agent for
American Selco Inc.

STATE OF NEVADA

COUNTY OF _____

RECORDED AT THE REQUEST OF American Selco Inc.
) on February 27, 19 80, at 45 P. Mins. past 9 A. M. In
) ss Book 79 of OFFICIAL RECORDS, page 180, RECORDS OF
EUREKA COUNTY, NEVADA. WILLIS A. DePAOLI Recorder
File No. 72613 Fee \$ 3.00

I hereby certify that the within instrument was filed and recorded at the request of: _____

FILE NO. _____
on _____
at _____
Docket _____ Page _____

Witness my hand and official seal the day and year aforesaid.

County Recorder

By _____
Deputy Recorder

BOOK 79 PAGE 180

CERTIFICATE OF MINING LOCATION
LODE CLAIM ON PUBLIC DOMAIN

72614

NOTICE IS HEREBY GIVEN that the Selrat No. 156 lode mining claim has been located by AMERICAN SELCO INC. a New York corporation, whose address is 90 West Grove Street, Suite 100, Reno, Nevada 89509. The general course of this claim is N87°W. This claim is 1500 feet in length along the course of the claim, being 10 feet from the point of discovery in a N87°W direction to the North end line of this claim, and 1490 feet in a SE70°E direction to the South end line of the claim. This claim is 600 feet in width, being 300 feet in width on each side of the center line of the claim.

This claim is located within the SE Quarter of Section 17, Township 18 North, Range 53 East, Mount Diablo Base and Meridian, unknown Mining District, Eureka County, Nevada. The location monument of this claim is situated with reference to some natural object or permanent monument as follows: Corner No. 1 of this claim is located appx. 1490 ft. N43°W from Claim Location Marker SRL. Claim Location Marker SRL a 3' x 6' steel pipe, is located appx.: 1.93 mi. N76°E from Grays Peak; 2.50 mi. N8° E from South Hill Peak; 0.55 mi. S27° W from Surprise Peak.

The corners of this claim are marked by 4"x4" posts or 4" trees with metal tags inscribed with the appropriate corner number as shown on the following sketch and the accompanying claim map.

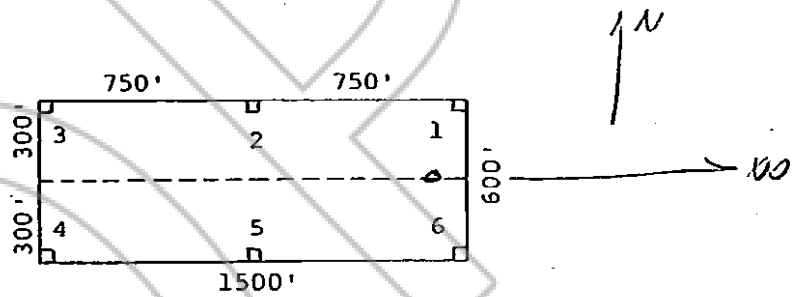

The location work consisted of making the maps as provided in NRS 517.040.

Dated and posted on the ground this 14 day of December 1979.

Witnesses:

Locator:

AMERICAN SELCO INC.
By [Signature]
Agent for
American Selco Inc.

STATE OF NEVADA)
COUNTY OF _____)

RECORDED AT THE REQUEST OF American Selco Inc.
on February 27, 19 80, at 05 mins. past 9 A. M. in
SS. Book 79 of OFFICIAL RECORDS, page 181 RECORDS OF
EUREKA COUNTY, NEVADA. WILLIS A. DePAOLI Recorder
File No. 72614 Fee \$ 3.00

I hereby certify that the within instrument was filed and recorded at the request of: _____
FILE NO. _____
on _____
at _____
Docket _____ Page _____

Witness my hand and official seal the day and year aforesaid.

County Recorder
By _____
Deputy Recorder
BOOK 79 PAGE 181

72615

NOTICE IS HEREBY GIVEN that the Selrat No. 157 lode mining claim has been located by AMERICAN SELCO INC. a New York corporation, whose address is 90 West Grove Street, Suite 100, Reno, Nevada 89509. The general course of this claim is N87°W. This claim is 1500 feet in length along the course of the claim, being 1990 feet from the point of discovery in a N87°W direction to the North end line of this claim, and 10 feet in a S87°E direction to the South end line of the claim. This claim is 600 feet in width, being 300 feet in width on each side of the center line of the claim.

This claim is located within the SE Quarter of Section 17, Township 18 North, Range 53 East, Mount Diablo Base and Meridian, unknown Mining District, Eureka County, Nevada. The location monument of this claim is situated with reference to some natural object or permanent monument as follows: Corner No. 1 of this claim is located appx. 1400 ft. N46°W from Claim Location Marker SRI. Claim Location

Marker SRI a 3' x 6' steel pipe, is located appx.: 1.93 mi. N76°E from Grays Peak; 2.50 mi. N8° E from South Hill Peak; 0.55 mi. S27° W from Surprise Peak.

The corners of this claim are marked by 4"x4" posts or 4" trees with metal tags inscribed with the appropriate corner number as shown on the following sketch and the accompanying claim map.

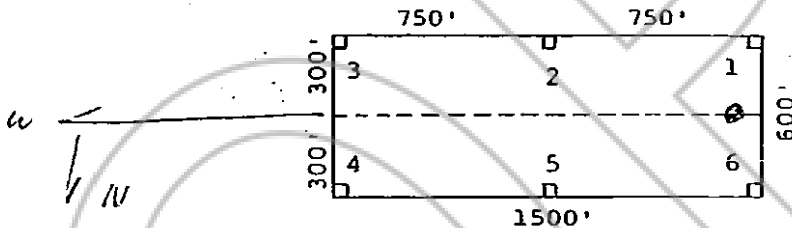

The location work consisted of making the maps as provided in NRS 517.040.

Dated and posted on the ground this 18 day of December, 1979.

Witnesses:

Locator:

AMERICAN SELCO INC.

By [Signature]
Agent for
American Selco Inc.

STATE OF NEVADA

COUNTY OF _____

RECORDED AT THE REQUEST OF American Selco Inc.
) on February 27, 1980 at 45 mins. past 9 A.M. in
) SS 79 of OFFICIAL RECORDS, page 182 RECORDS OF
EUREKA COUNTY, NEVADA. WILLIS A. DeFAOLI Recorder
File No. 72615 Fee \$ 3.00

I hereby certify that the within instrument was filed and recorded at the request of: _____

Witness my hand and official seal the day and year aforesaid.

FILE NO. _____
on _____
at _____
Docket _____ Page _____

County Recorder

By _____
Deputy Recorder

BOOK 79 PAGE 182

CERTIFICATE OF MINING LOCATION
LODE CLAIM ON PUBLIC DOMAIN

72616

NOTICE IS HEREBY GIVEN that the Selrat No. 158 lode mining claim has been located by AMERICAN SELCO INC. a New York corporation, whose address is 90 West Grove Street, Suite 100, Reno, Nevada 89509. The general course of this claim is N18°70'W. This claim is 1500 feet in length along the course of the claim, being 10 feet from the point of discovery in a N87°0'W direction to the North end line of this claim, and 1490 feet in a S87°0'E direction to the South end line of the claim. This claim is 600 feet in width, being 300 feet in width on each side of the center line of the claim.

This claim is located within the SE Quarter of Section 17, Township 18 North, Range 53 East, Mount Diablo Base and Meridian, unknown Mining District, Eureka County, Nevada. The location monument of this claim is situated with reference to some natural object or permanent monument as follows: Corner No. 1 of this claim is located appx. 14000 ft. N46°W from Claim Location Marker SRI. Claim Location Marker SRI a 3' x 6' steel pipe, is located appx.: 1.93 mi. N76°E from Grays Peak; 2.50 mi. N8° E from South Hill Peak; 0.55 mi. S27° W from Surprise Peak.

The corners of this claim are marked by 4"x4" posts or 4" trees with metal tags inscribed with the appropriate corner number as shown on the following sketch and the accompanying claim map.

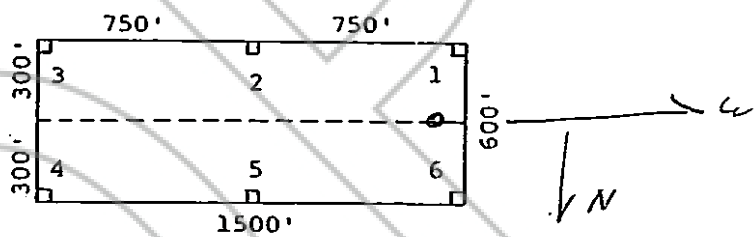

The location work consisted of making the maps as provided in NRS 517.040.

Dated and posted on the ground this 18 day of December, 1979.

Witnesses:

Locator:
AMERICAN SELCO INC.
By [Signature]
Agent for
American Selco Inc.

STATE OF NEVADA)
COUNTY OF _____)

RECORDED AT THE REQUEST OF American Selco Inc.
on February 27, 1980, at 45 min. past 9 A. M. In
) ss. Book 79 of OFFICIAL RECORDS, page 183, RECORDS OF
EUREKA COUNTY, NEVADA. WILLIS A. DePAOLI Recorder
File No. 72616 Fee \$ 3.00

I hereby certify that the within instrument was filed and recorded at the request of: _____
FILE NO. _____
on _____
at _____
Docket _____ Page _____

Witness my hand and official seal the day and year aforesaid.

County Recorder
By _____
Deputy Recorder

72617

NOTICE IS HEREBY GIVEN that the Selrat No. 159 lode mining claim has been located by AMERICAN SELCO INC. a New York corporation, whose address is 90 West Grove Street, Suite 100, Reno, Nevada 89509. The general course of this claim is N57°W. This claim is 1500 feet in length along the course of the claim, being 1490 feet from the point of discovery in a N57°W direction to the North end line of this claim, and 10 feet in a S57°E direction to the South end line of the claim. This claim is 600 feet in width, being 300 feet in width on each side of the center line of the claim.

This claim is located within the SE Quarter of Section 17, Township 18 North, Range 53 East, Mount Diablo Base and Meridian, unknown Mining District, Eureka County, Nevada. The location monument of this claim is situated with reference to some natural object or permanent monument as follows: Corner No. 1 of this claim is located appx. 1400 ft. N46°W from Claim Location Marker SR1. Claim Location

Marker SR1 a 3' x 6' steel pipe, is located appx.: 1.93 mi. N76°E from Grays Peak; 2.50 mi. N8° E from South Hill Peak; 0.55 mi. S27° W from Surprise Peak.

The corners of this claim are marked by 4"x4" posts or 4" trees with metal tags inscribed with the appropriate corner number as shown on the following sketch and the accompanying claim map.

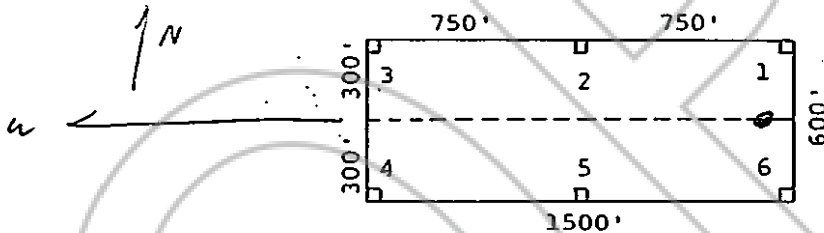

The location work consisted of making the maps as provided in NRS 517.040.

Dated and posted on the ground this 18 day of December, 1979.

Witnesses:

Locator:

AMERICAN SELCO INC.

By [Signature]
Agent for
American Selco Inc.

STATE OF NEVADA)

COUNTY OF _____)

RECORDED AT THE REQUEST OF American Selco Inc.
on February 27, 1980, at 45 mins. past 9 A. M. In
) ss. Book 79 of OFFICIAL RECORDS, page 184, RECORDS OF
EUREKA COUNTY, NEVADA. WILLIS A. DePAOLI Recorder
Ede No. 72617 Fee \$ 3.00

I hereby certify that the within instrument was filed and recorded at the request of: _____

Witness my hand and official seal the day and year aforesaid.

FILE NO. _____
on _____
at _____
Docket _____ Page _____

County Recorder

By _____
Deputy Recorder

BOOK 79 PAGE 184

CERTIFICATE OF MINING LOCATION
LODE CLAIM ON PUBLIC DOMAIN

72618

NOTICE IS HEREBY GIVEN that the Selrat No. 160 lode mining claim has been located by AMERICAN SELCO INC. a New York corporation, whose address is 90 West Grove Street, Suite 100, Reno, Nevada 89509. The general course of this claim is N 87° W. This claim is 1500 feet in length along the course of the claim, being 10 feet from the point of discovery in a N 87° W direction to the North end line of this claim, and 1490 feet in a S 87° E direction to the South end line of the claim. This claim is 600 feet in width, being 300 feet in width on each side of the center line of the claim.

This claim is located within the SE Quarter of Section 17, Township 18 North, Range 53 East, Mount Diablo Base and Meridian, unknown Mining District, Eureka County, Nevada. The location monument of this claim is situated with reference to some natural object or permanent monument as follows: Corner No. 1 of this claim is located appx. 1400 ft. N 46° W from Claim Location Marker SRI. Claim Location

Marker SRI a 3' x 6' steel pipe, is located appx.: 1.93 mi. N76°E from Grays Peak; 2.50 mi. N8° E from South Hill Peak; 0.55 mi. S27° W from Surprise Peak.

The corners of this claim are marked by 4"x4" posts or 4" trees with metal tags inscribed with the appropriate corner number as shown on the following sketch and the accompanying claim map.

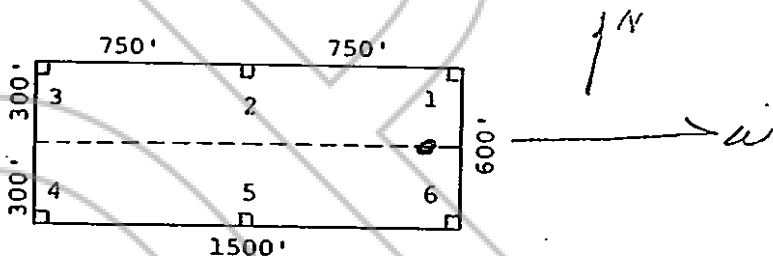

The location work consisted of making the maps as provided in NRS 517.040.

Dated and posted on the ground this 18 day of December, 1979.

Witnesses:

Locator:

AMERICAN SELCO INC.

By [Signature]
Agent for
American Selco Inc.

RECORDED AT THE REQUEST OF American Selco Inc.
on February 27, 1980, at 45 mins. past 9 A. M. In
Book 79 of OFFICIAL RECORDS, page 185, RECORDS OF
EUREKA COUNTY, NEVADA. WILLIS A. DePAOLI Recorder
File No. 72618 Fee \$ 3.00

STATE OF NEVADA)
COUNTY OF _____)

I hereby certify that the within instrument was filed and recorded at the request of: _____
FILE NO. _____
on _____
at _____
Docket _____ Page _____

Witness my hand and official seal the day and year aforesaid.

County Recorder

By _____
Deputy Recorder

BOOK 79 PAGE 185

72619

STATE OF NEVADA
CERTIFICATE OF MINING LOCATION
LODE CLAIM ON PUBLIC DOMAIN

NOTICE IS HEREBY GIVEN that the Selrat No. 161 lode mining claim has been located by AMERICAN SELCO INC. a New York corporation, whose address is 90 West Grove Street, Suite 100, Reno, Nevada 89509. The general course of this claim is N 87° 0' W. This claim is 1500 feet in length along the course of the claim, being 1490 feet from the point of discovery in a N 87° 0' W direction to the North end line of this claim, and 10 feet in a S 87° 0' E direction to the South end line of the claim. This claim is 600 feet in width, being 300 feet in width on each side of the center line of the claim.

This claim is located within the N/E Quarter of Section 20, Township 18 North, Range S 3 East, Mount Diablo Base and Meridian, unknown Mining District, Eureka County, Nevada. The location monument of this claim is situated with reference to some natural object or permanent monument as follows: Corner No. 1 of this claim is located appx. 13200 ft. N 50° 0' W from Claim Location Marker SRI. Claim Location

Marker SRI a 3' x 6' steel pipe, is located appx.: 1.93 mi. N76°E from Grays Peak; 2.50 mi. N8° E from South Hill Peak; 0.55 mi. S27° W from Surprise Peak.

The corners of this claim are marked by 4"x4" posts or 4" trees with metal tags inscribed with the appropriate corner number as shown on the following sketch and the accompanying claim map.

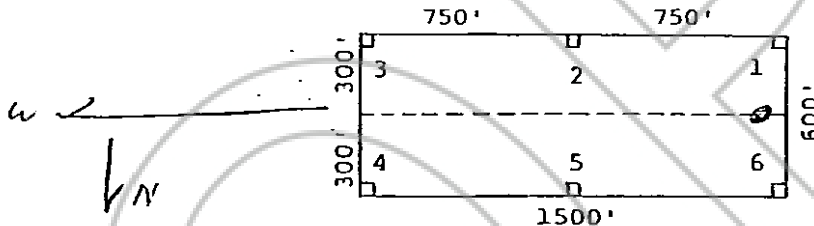

The location work consisted of making the maps as provided in NRS 517.040.

Dated and posted on the ground this 18 day of December 1979.

Witnesses:

Locator:

AMERICAN SELCO INC.

By [Signature]
Agent for
American Selco Inc.

STATE OF NEVADA

COUNTY OF _____

RECORDED AT THE REQUEST OF American Selco Inc.
on February 27, 1980, at 45 mins. past 9 A. M. In
) ss. Book 79 of OFFICIAL RECORDS, page 186, RECORDS OF
) EUREKA COUNTY, NEVADA. WILLIS A. DePAOLI Recorder.
File No. 72619 Fee \$ 3.00

I hereby certify that the within instrument was filed and recorded at the request of: _____

FILE NO: _____

on _____

at _____

Docket _____ Page _____

Witness my hand and official seal the day and year aforesaid.

County Recorder

By _____
Deputy Recorder

BOOK 79 PAGE 186

72620.

STATE OF NEVADA
CERTIFICATE OF MINING LOCATION
LODE CLAIM ON PUBLIC DOMAIN

NOTICE IS HEREBY GIVEN that the Selrat No. 162 lode mining claim has been located by AMERICAN SELCO INC. a New York corporation, whose address is 90 West Grove Street, Suite 100, Reno Nevada 89509. The general course of this claim is N 87° W. This claim is 1500 feet in length along the course of the claim, being 10 feet from the point of discovery in a N 87° W direction to the North end line of this claim, and 1490 feet in a S 87° E direction to the South end line of the claim. This claim is 600 feet in width, being 300 feet in width on each side of the center line of the claim.

This claim is located within the NE Quarter of Section 20, Township 18 North, Range 53 East, Mount Diablo Base and Meridian, unknown Mining District, Eureka County, Nevada. The location monument of this claim is situated with reference to some natural object or permanent monument as follows: Corner No. 1 of this claim is located appx. 13700 ft. N 50° W from Claim Location Marker SRI. Claim Location Marker SRI a 3' x 6' steel pipe, is located appx.: 1.93 mi. N76°E from Grays Peak; 2.50 mi. N8° E from South Hill Peak; 0.55 mi. S27° W from Surprise Peak.

The corners of this claim are marked by 4"x4" posts or 4" trees with metal tags inscribed with the appropriate corner number as shown on the following sketch and the accompanying claim map.

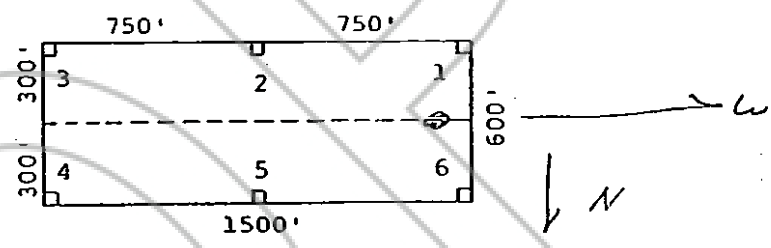

The location work consisted of making the maps as provided in NRS 517.040.

Dated and posted on the ground this 18 day of December, 1979.

Witnesses:

Locator:

AMERICAN SELCO INC.
By [Signature]
Agent for
American Selco Inc.

STATE OF NEVADA
COUNTY OF _____

RECORDED AT THE REQUEST OF American Selco Inc.
on February 27, 1980, at 45 mins. past 9 A.M. in
) SS Book 79 of OFFICIAL RECORDS, page 187, RECORDS OF
) EUREKA COUNTY, NEVADA. WILLIS A. DePAOLI Recorder
File No. 72620 Fee \$ 3.00

I hereby certify that the within instrument was filed and recorded at the request of: _____
FILE NO. _____
on _____
at _____
Docket _____ Page _____

Witness my hand and official seal the day and year aforesaid.

County Recorder
By _____
Deputy Recorder

CERTIFICATE OF MINING LOCATION
LODE CLAIM ON PUBLIC DOMAIN

72621

NOTICE IS HEREBY GIVEN that the Selrat No. 163 lode mining claim has been located by AMERICAN SELCO INC. a New York corporation, whose address is 90 West Grove Street, Suite 100, Reno, Nevada 89509. The general course of this claim is N87°W. This claim is 1500 feet in length along the course of the claim, being 1490 feet from the point of discovery in a N87°W direction to the North end line of this claim, and 10 feet in a S87°W direction to the South end line of the claim. This claim is 600 feet in width, being 300 feet in width on each side of the center line of the claim.

This claim is located within the N1E Quarter of Section 20, Township 18 North, Range 53 East, Mount Diablo Base and Meridian, unknown Mining District, Eureka County, Nevada. The location monument of this claim is situated with reference to some natural object or permanent monument as follows: Corner No. 1 of this claim is located appx. 13200 ft. N50°W from Claim Location Marker SR1. Claim Location Marker SR1 a 3' x 6' steel pipe, is located appx.: 1.93 mi. N76°E from Grays Peak; 2.50 mi. N8° E from South Hill Peak; 0.55 mi. S27° W from Surprise Peak.

The corners of this claim are marked by 4"x4" posts or 4" trees with metal tags inscribed with the appropriate corner number as shown on the following sketch and the accompanying claim map.

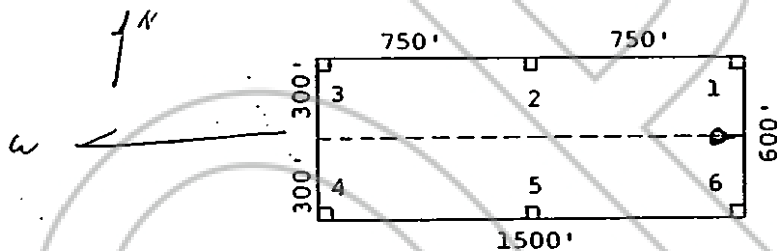

The location work consisted of making the maps as provided in NRS 517.040.

Dated and posted on the ground this 29 day of November, 1979.

Witnesses:

Locator:

AMERICAN SELCO INC.

By [Signature]
Agent for
American Selco Inc.

STATE OF NEVADA

COUNTY OF _____

RECORDED AT THE REQUEST OF American Selco Inc.
on February 27, 19 80, at 45 mins. past 9 A.M. in
) ss. Book 79 of OFFICIAL RECORDS, page 188, RECORDS OF
) EUREKA COUNTY, NEVADA. WILLIS A. DePAOLI Recorder
File No. 72621 Fee \$ 3.00

I hereby certify that the within instrument was filed and recorded at the request of: _____

FILE NO. _____

on _____

at _____

Docket _____ Page _____

Witness my hand and official seal the day and year aforesaid.

County Recorder

By _____
Deputy Recorder

BOOK 79 PAGE 188

NOTICE IS HEREBY GIVEN that the Selrat No. 164 lode mining claim has been located by AMERICAN SELCO INC. a New York corporation, whose address is 90 West Grove Street, Suite 100, Reno, Nevada 89509. The general course of this claim is N87°W. This claim is 1500 feet in length along the course of the claim, being 10 feet from the point of discovery in a N87°W direction to the Northern end line of this claim, and 1490 feet in a S87°E direction to the Southern end line of the claim. This claim is 600 feet in width, being 300 feet in width on each side of the center line of the claim.

This claim is located within the NE Quarter of Section 20, Township 18 North, Range 53 East, Mount Diablo Base and Meridian, unknown Mining District, Eureka County, Nevada. The location monument of this claim is situated with reference to some natural object or permanent monument as follows: Corner No. 1 of this claim is located appx. 13200 ft. N50°W from Claim Location Marker SRL. Claim Location

Marker SRL a 3' x 6' steel pipe, is located appx.: 1.93 mi. N76°E from Grays Peak; 2.50 mi. N8° E from South Hill Peak; 0.55 mi. S27° W from Surprise Peak.

The corners of this claim are marked by 4"x4" posts or 4" trees with metal tags inscribed with the appropriate corner number as shown on the following sketch and the accompanying claim map.

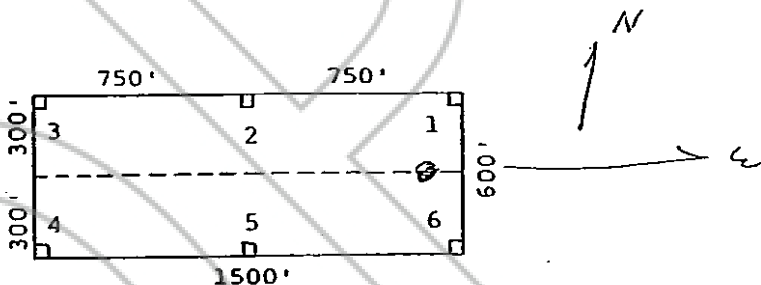

The location work consisted of making the maps as provided in NRS 517.040.

Dated and posted on the ground this 29 day of November, 1979.

Witnesses:

Locator:

AMERICAN SELCO INC.

By [Signature]
Agent for
American Selco Inc.

RECORDED AT THE REQUEST OF American Selco Inc.
on February 27, 1980, at 45 mins. past 9 A.M. in
) ss. Book 79 of OFFICIAL RECORDS, page 189, RECORDS OF
) EUREKA COUNTY, NEVADA. WILLIS A. DePAOLI Recorder
File No. 72622 Fee \$ 3.00

STATE OF NEVADA

COUNTY OF _____

I hereby certify that the within instrument was filed and recorded at the request of: _____

FILE NO. _____
on _____
at _____
Docket _____ Page _____

Witness my hand and official seal the day and year aforesaid.

County Recorder

By _____
Deputy Recorder

BOOK 79 PAGE 189

72623

STATE OF NEVADA
CERTIFICATE OF MINING LOCATION
LODE CLAIM ON PUBLIC DOMAIN

NOTICE IS HEREBY GIVEN that the Selrat No. 165 lode mining claim has been located by AMERICAN SELCO INC. a New York corporation, whose address is 90 West Grove Street, Suite 100, Reno, Nevada 89509. The general course of this claim is N 87° 0' W. This claim is 1500 feet in length along the course of the claim, being 1490 feet from the point of discovery in a N 87° 0' W direction to the North end line of this claim, and 10 feet in a S 87° 0' E direction to the South end line of the claim. This claim is 600 feet in width, being 300 feet in width on each side of the center line of the claim.

This claim is located within the NE Quarter of Section 20, Township 18 North, Range 53 East, Mount Diablo Base and Meridian, unknown Mining District, Eureka County, Nevada. The location monument of this claim is situated with reference to some natural object or permanent monument as follows: Corner No. 1 of this claim is located appx 12400 ft. N 53° 0' W from Claim Location Marker SRI. Claim Location Marker SRI a 3' x 6' steel pipe, is located appx.: 1.93 mi. N76°E from Grays Peak; 2.50 mi. N8° E from South Hill Peak; 0.55 mi. S27° W from Surprise Peak.

The corners of this claim are marked by 4"x4" posts or 4" trees with metal tags inscribed with the appropriate corner number as shown on the following sketch and the accompanying claim map.

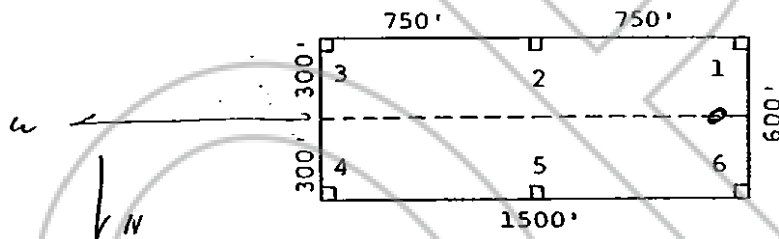

The location work consisted of making the maps as provided in NRS 517.040.

Dated and posted on the ground this 20 day of December, 1979.

Witnesses:

Locator:

AMERICAN SELCO INC.

By [Signature]
Agent for
American Selco Inc.

STATE OF NEVADA)
COUNTY OF _____)
RECORDED AT THE REQUEST OF American Selco Inc.
on February 27, 1980, at 45 mins. past 9 A.M. in
) ss. Book 79 of OFFICIAL RECORDS, page 190, RECORDS OF
) EUREKA COUNTY, NEVADA. WILLIS A. DePAOLI Recorder
File No. 72623 Fee \$ 3.00

I hereby certify that the within instrument was filed and recorded at the request of: _____
FILE NO. _____
on _____
at _____
Docket _____ Page _____

Witness my hand and official seal the day and year aforesaid.

County Recorder

By _____
Deputy Recorder

BOOK 79 PAGE 190

72624

NOTICE IS HEREBY GIVEN that the Selrat No. 166 lode mining claim has been located by AMERICAN SELCO INC. a New York corporation, whose address is 90 West Grove Street, Suite 100, Reno, Nevada 89509. The general course of this claim is N87°W. This claim is 1500 feet in length along the course of the claim, being 10 feet from the point of discovery in a N87°W direction to the North end line of this claim, and 1490 feet in a S87°E direction to the South end line of the claim. This claim is 600 feet in width, being 300 feet in width on each side of the center line of the claim.

This claim is located within the N1E Quarter of Section 20, Township 18 North, Range 53 East, Mount Diablo Base and Meridian, unknown Mining District, Eureka County, Nevada. The location monument of this claim is situated with reference to some natural object or permanent monument as follows: Corner No. 1 of this claim is located appx. 12400 ft. N53°W from Claim Location Marker SRI. Claim Location

Marker SRI a 3' x 6' steel pipe, is located appx.: 1.93 mi. N76°E from Grays Peak; 2.50 mi. N8° E from South Hill Peak; 0.55 mi. S27° W from Surprise Peak.

The corners of this claim are marked by 4"x4" posts or 4" trees with metal tags inscribed with the appropriate corner number as shown on the following sketch and the accompanying claim map.

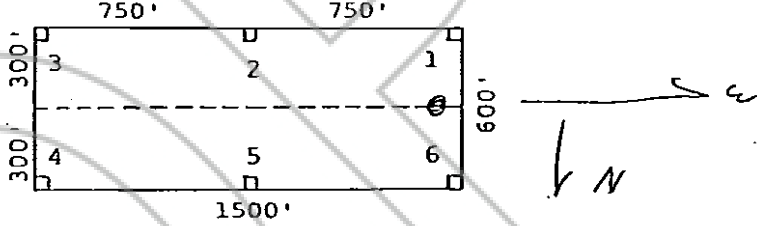

The location work consisted of making the maps as provided in NRS 517.040.

Dated and posted on the ground this 20 day of December, 1979.

Witnesses:

Locator:

AMERICAN SELCO INC.

By [Signature]
Agent for
American Selco Inc.

RECORDED AT THE REQUEST OF American Selco Inc.
on February 27, 19 80, at 45 mins. past 9 A. M. In
) ss. Book 79 of OFFICIAL RECORDS, page 191, RECORDS OF
) EUREKA COUNTY, NEVADA. WILLIS A. DePAOLI Recorder
File No. 72624 Fee \$ 3.00

STATE OF NEVADA

COUNTY OF _____

I hereby certify that the within instrument was filed and recorded at the request of: _____

FILE NO. _____
on _____
at _____
Docket _____ Page _____

Witness my hand and official seal the day and year aforesaid.

County Recorder

By _____
Deputy Recorder

BOOK 79 PAGE 191

CERTIFICATE OF MINING LOCATION
LODE CLAIM ON PUBLIC DOMAIN

72625

NOTICE IS HEREBY GIVEN that the Selrat No. 167 lode mining claim has been located by AMERICAN SELCO INC. a New York corporation, whose address is 90 West Grove Street, Suite 100, Reno, Nevada 89509. The general course of this claim is N87°W. This claim is 1500 feet in length along the course of the claim, being 1490 feet from the point of discovery in a N87°W direction to the North end line of this claim, and 1490 feet in a S87°E direction to the South end line of the claim. This claim is 600 feet in width, being 300 feet in width on each side of the center line of the claim.

This claim is located within the SE Quarter of Section 21, Township 18 North, Range 53 East, Mount Diablo Base and Meridian, unknown Mining District, Eureka County, Nevada. The location monument of this claim is situated with reference to some natural object or permanent monument as follows: Corner No.1 of this claim is located appx. 8400 ft. N34°W from Claim Location Marker SRI. Claim Location

Marker SRI a 3' x 6' steel pipe, is located appx.: 1.93 mi. N76°E from Grays Peak; 2.50 mi. N8° E from South Hill Peak; 0.55 mi. S27° W from Surprise Peak.

The corners of this claim are marked by 4"x4" posts or 4" trees with metal tags inscribed with the appropriate corner number as shown on the following sketch and the accompanying claim map.

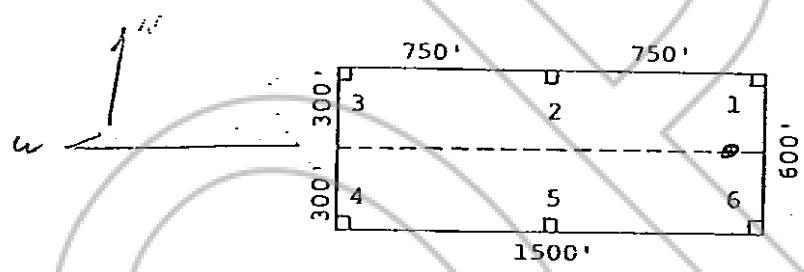

The location work consisted of making the maps as provided in NRS 517.040.

Dated and posted on the ground this 5 day of December, 1979.

Witnesses:

Locator:

AMERICAN SELCO INC.

By [Signature]
Agent for
American Selco Inc.

STATE OF NEVADA)
COUNTY OF _____)

RECORDED AT THE REQUEST OF American Selco Inc.
on February 27, 1980, at 45 mins. past 9 A. M. In
) SS. Book 79 of OFFICIAL RECORDS, page 192, RECORDS OF
EUREKA COUNTY, NEVADA. WILLIS A. DePAOLI Recorder
Els No. 72625 Fee 3.00

I hereby certify that the within instrument was filed and recorded at the request of: _____
FILE NO. _____
on _____
at _____
Docket _____ Page _____

Witness my hand and official seal the day and year aforesaid.

County Recorder

By _____
Deputy Recorder

BOOK 79 PAGE 192

STATE OF NEVADA
 CERTIFICATE OF MINING LOCATION
 LODE CLAIM ON PUBLIC DOMAIN

72626

NOTICE IS HEREBY GIVEN that the Selrat No. 168 lode mining claim has been located by AMERICAN SELCO INC. a New York corporation, whose address is 90 West Grove Street, Suite 100, Reno, Nevada 89509. The general course of this claim is N87°W. This claim is 1500 feet in length along the course of the claim, being 1490 feet from the point of discovery in a N87°W direction to the No 1 end line of this claim, and 10 feet in a S87°E direction to the South end line of the claim. This claim is 600 feet in width, being 300 feet in width on each side of the center line of the claim.

This claim is located within the NE Quarter of Section 21, Township 18 North, Range 53 East, Mount Diablo Base and Meridian, unknown Mining District, Eureka County, Nevada. The location monument of this claim is situated with reference to some natural object or permanent monument as follows: Corner No. 1 of this claim is located appx. 8400 ft. N34°W from Claim Location Marker SRI. Claim Location

Marker SRI a 3' x 6' steel pipe, is located appx.: 1.93 mi. N76°E from Grays Peak; 2.50 mi. N8° E from South Hill Peak; 0.55 mi. S27° W from Surprise Peak.

The corners of this claim are marked by 4"x4" posts or 4" trees with metal tags inscribed with the appropriate corner number as shown on the following sketch and the accompanying claim map.

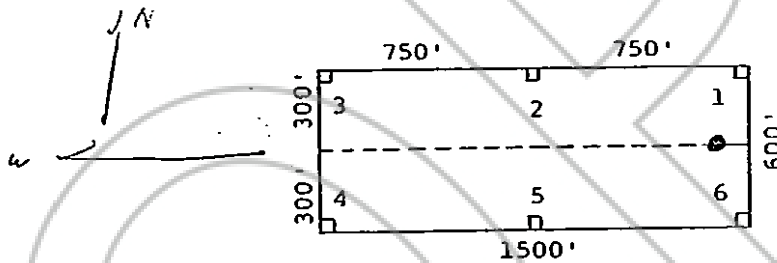

The location work consisted of making the maps as provided in NRS 517.040.

Dated and posted on the ground this 5 day of December, 1979.

Witnesses:

Locator:

AMERICAN SELCO INC.

By [Signature]
 Agent for
 American Selco Inc.

STATE OF NEVADA)

COUNTY OF _____)

RECORDED AT THE REQUEST OF American Selco Inc.
 on February 27, 1980, at 45 mins past 9 A.M. In
) ss. Book 79 of OFFICIAL RECORDS, page 193, RECORDS OF
 EUREKA COUNTY, NEVADA. WILLIS A. DePAOLI Recorder
 File No. 72626 Fee \$ 3.00

I hereby certify that the within instrument was filed and recorded at the request of: _____

Witness my hand and official seal the day and year aforesaid.

FILE NO. _____
 on _____
 at _____
 Docket _____ Page _____

County Recorder

By _____
 Deputy Recorder

BOOK 79 PAGE 193

CERTIFICATE OF MINING LOCATION
LODE CLAIM ON PUBLIC DOMAIN

72627

NOTICE IS HEREBY GIVEN that the Selrat No. 169 lode mining claim has been located by AMERICAN SELCO INC. a New York corporation, whose address is 90 West Grove Street, Suite 100, Reno, Nevada 89509. The general course of this claim is N 30° E. This claim is 1500 feet in length along the course of the claim, being 10 feet from the point of discovery in a N 30° E direction to the North end line of this claim, and 1490 feet in a S 30° W direction to the South end line of the claim. This claim is 600 feet in width, being 300 feet in width on each side of the center line of the claim.

This claim is located within the SE Quarter of Section 21, Township 18 North, Range 53 East, Mount Diablo Base and Meridian, unknown Mining District, Eureka County, Nevada. The location monument of this claim is situated with reference to some natural object or permanent monument as follows: Corner No. 1 of this claim is located appx. 700 ft. N 51° W from Claim Location Marker SRL. Claim Location

Marker SRL a 3' x 6' steel pipe, is located appx.: 1.93 mi. N76°E from Grays Peak; 2.50 mi. N8° E from South Hill Peak; 0.55 mi. S27° W from Surprise Peak.

The corners of this claim are marked by 4"x4" posts or 4" trees with metal tags inscribed with the appropriate corner number as shown on the following sketch and the accompanying claim map.

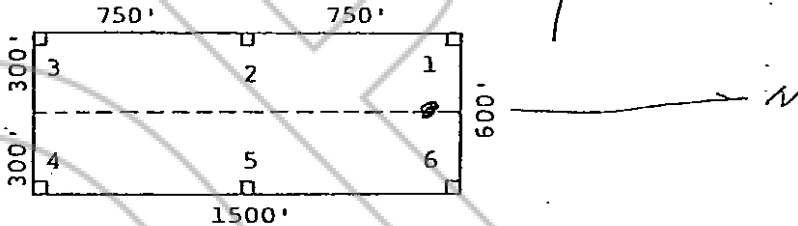

The location work consisted of making the maps as provided in NRS 517.040.

Dated and posted on the ground this 5 day of December, 1979.

Witnesses:

Locator:

AMERICAN SELCO INC.

By [Signature]
Agent for
American Selco Inc.

STATE OF NEVADA)

COUNTY OF _____)

RECORDED AT THE REQUEST OF American Selco Inc.
on February 27, 19 80, at 45 mins. past 9 A.M. in
Book 79 of OFFICIAL RECORDS, page 194, RECORDS OF
EUREKA COUNTY, NEVADA. WILLIS A. DePAOLI Recorder
File No. 72627 Fee \$ 3.00

I hereby certify that the within instrument was filed and recorded at the request of: _____

Witness my hand and official seal the day and year aforesaid.

FILE NO. _____
on _____
at _____
Docket _____ Page _____

County Recorder

By _____
Deputy Recorder

BOOK 79 PAGE 194

72628

NOTICE IS HEREBY GIVEN that the Selrat No. 170 lode mining claim has been located by AMERICAN SELCO INC. a New York corporation, whose address is 90 West Grove Street, Suite 100, Reno, Nevada 89509. The general course of this claim is N 30° E. This claim is 1500 feet in length along the course of the claim, being 1490 feet from the point of discovery in a N 30° E direction to the N 1/2 - 6 end line of this claim, and 10 feet in a S 30° W direction to the South end line of the claim. This claim is 600 feet in width, being 300 feet in width on each side of the center line of the claim.

This claim is located within the SE Quarter of Section 21, Township 18 North, Range 53 East, Mount Diablo Base and Meridian, unknown Mining District, Eureka County, Nevada. The location monument of this claim is situated with reference to some natural object or permanent monument as follows: Corner No. 1 of this claim is located appx. 7700 ft. N 51° W from Claim Location Marker SRI. Claim Location

Marker SRI a 3' x 6' steel pipe, is located appx.: 1.93 mi. N76°E from Grays Peak; 2.50 mi. N8° E from South Hill Peak; 0.55 mi. S27° W from Surprise Peak.

The corners of this claim are marked by 4"x4" posts or 4" trees with metal tags inscribed with the appropriate corner number as shown on the following sketch and the accompanying claim map.

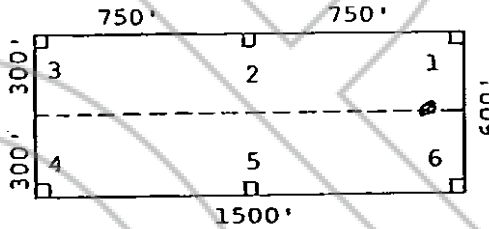

The location work consisted of making the maps as provided in NRS 517.040.

Dated and posted on the ground this 5 day of December, 1979.

Witnesses:

Locator:

AMERICAN SELCO INC.

By [Signature]
Agent for
American Selco Inc.

STATE OF NEVADA)

COUNTY OF _____)

RECORDED AT THE REQUEST OF American Selco Inc.
on February 27, 19 80 at 45 min. past 9 A.M. in
Book 79 of OFFICIAL RECORDS, page 195, RECORDS OF
EUREKA COUNTY, NEVADA. WILLIS A. DePAOLI Recorder
File No. 72628 Fee \$ 3.00

I hereby certify that the within instrument was filed and recorded at the request of: _____
FILE NO. _____
on _____
at _____
Docket _____ Page _____

Witness my hand and official seal the day and year aforesaid.

County Recorder

By _____
Deputy Recorder

BOOK 79 PAGE 195

72629

NOTICE IS HEREBY GIVEN that the Selrat No. 171 lode mining claim has been located by AMERICAN SELCO INC. a New York corporation, whose address is 90 West Grove Street, Suite 100, Reno Nevada 89509. The general course of this claim is N 30° E. This claim is 1500 feet in length along the course of the claim, being 1490 feet from the point of discovery in a N 30° E direction to the Northern end line of this claim, and 10 feet in a S 30° W direction to the Southern end line of the claim. This claim is 600 feet in width, being 300 feet in width on each side of the center line of the claim.

This claim is located within the NE Quarter of Section 28, Township 18 North, Range S 3 East, Mount Diablo Base and Meridian, unknown Mining District, Eureka County, Nevada. The location monument of this claim is situated with reference to some natural object or permanent monument as follows: Corner No. 1 of this claim is located appx 6100 ft. N 72° W from Claim Location Marker SRI. Claim Location

Marker SRI a 3' x 6' steel pipe, is located appx.: 1.93 mi. N76°E from Grays Peak; 2.50 mi. N8° E from South Hill Peak; 0.55 mi. S27° W from Surprise Peak.

The corners of this claim are marked by 4"x4" posts or 4" trees with metal tags inscribed with the appropriate corner number as shown on the following sketch and the accompanying claim map.

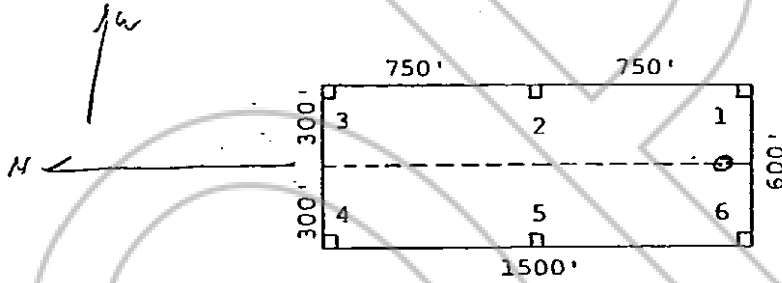

The location work consisted of making the maps as provided in NRS 517.040.

Dated and posted on the ground this 5 day of December, 1979.

Witnesses:

Locator:

AMERICAN SELCO INC.

By [Signature]
Agent for
American Selco Inc.

STATE OF NEVADA

COUNTY OF _____

RECORDED AT THE REQUEST OF American Selco Inc.
on February 27, 19 80 at 45 min. past 9 A. M. In
) ss. 79 of OFFICIAL RECORDS, page 196, RECORDS OF
) EUREKA COUNTY, NEVADA. WILLIS A. DePAOLI Recorder
File No. 72629 Fee \$ 3.00

I hereby certify that the within instrument was filed and recorded at the request of: _____
FILE NO. _____
on _____
at _____
Docket _____ Page _____

Witness my hand and official seal the day and year aforesaid.

County Recorder

By _____
Deputy Recorder

BOOK 79 PAGE 196

STATE OF NEVADA
 CERTIFICATE OF MINING LOCATION
 LODE CLAIM ON PUBLIC DOMAIN

72630

NOTICE IS HEREBY GIVEN that the Selrat No. 172 lode mining claim has been located by AMERICAN SELCO INC. a New York corporation, whose address is 90 West Grove Street, Suite 100, Reno, Nevada 89509. The general course of this claim is N 30° E. This claim is 1500 feet in length along the course of the claim, being 10 feet from the point of discovery in a N 30° E direction to the N 67° W end line of this claim, and 1490 feet in a S 30° W direction to the S 27° W end line of the claim. This claim is 600 feet in width, being 300 feet in width on each side of the center line of the claim.

This claim is located within the SE Quarter of Section 28, Township 18 North, Range 53 East, Mount Diablo Base and Meridian, unknown Mining District, Eureka County, Nevada. The location monument of this claim is situated with reference to some natural object or permanent monument as follows: Corner No. 1 of this claim is located appx. 5000 ft. N 67° W from Claim Location Marker SRL. Claim Location

Marker SRL a 3' x 6' steel pipe, is located appx.: 1.93 mi. N76°E from Grays Peak; 2.50 mi. N8° E from South Hill Peak; 0.55 mi. S27° W from Surprise Peak.

The corners of this claim are marked by 4"x4" posts or 4" trees with metal tags inscribed with the appropriate corner number as shown on the following sketch and the accompanying claim map.

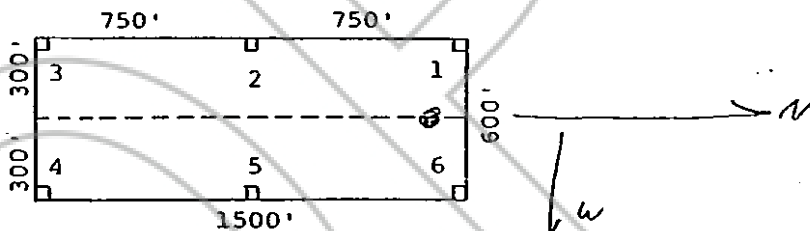

The location work consisted of making the maps as provided in NRS 517.040.

Dated and posted on the ground this 6 day of December, 1979.

Witnesses:

Locator:

_____ AMERICAN SELCO INC.

By [Signature]
 Agent for
 American Selco Inc.

STATE OF NEVADA

COUNTY OF _____

RECORDED AT THE REQUEST OF American Selco Inc.
 on February 27, 1980, at 45 mins. past 9 A. M. In
) ss. 79 of OFFICIAL RECORDS, page 197, RECORDS OF
) EUREKA COUNTY, NEVADA. WILLIS A. DePAOLI Recorder
 (No. 72630 Fee \$ 3.00

I hereby certify that the within instrument was filed and recorded at the request of: _____

Witness my hand and official seal the day and year aforesaid.

FILE NO. _____
 on _____
 at _____
 Docket _____ Page _____

County Recorder

By _____
 Deputy Recorder

BOOK 79 PAGE 197

CERTIFICATE OF MINING LOCATION
LODE CLAIM ON PUBLIC DOMAIN

72631

NOTICE IS HEREBY GIVEN that the Selrat No. 173 lode mining claim has been located by AMERICAN SELCO INC. a New York corporation, whose address is 90 West Grove Street, Suite 100, Reno, Nevada 89509. The general course of this claim is N30°E. This claim is 1500 feet in length along the course of the claim, being 1490 feet from the point of discovery in a N30°E direction to the North end line of this claim, and 10 feet in a S30°W direction to the South end line of the claim. This claim is 600 feet in width, being 300 feet in width on each side of the center line of the claim.

This claim is located within the SE Quarter of Section 28, Township 18 North, Range S3 East, Mount Diablo Base and Meridian, unknown Mining District, Eureka County, Nevada. The location monument of this claim is situated with reference to some natural object or permanent monument as follows: Corner No. 1 of this claim is located appx. 4000 ft. S76°W from Claim Location Marker SRL. Claim Location

Marker SRL a 3' x 6' steel pipe, is located appx.: 1.93 mi. N76°E from Grays Peak; 2.50 mi. N8° E from South Hill Peak; 0.55 mi. S27° W from Surprise Peak.

The corners of this claim are marked by 4"x4" posts or 4" trees with metal tags inscribed with the appropriate corner number as shown on the following sketch and the accompanying claim map.

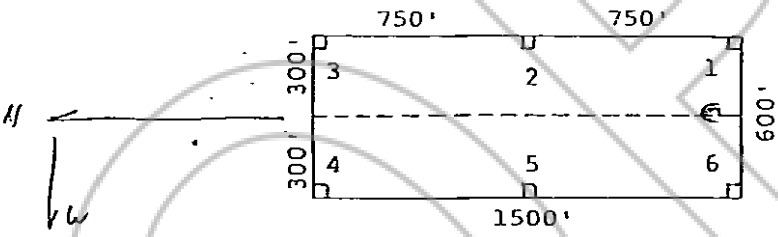

The location work consisted of making the maps as provided in NRS 517.040.

Dated and posted on the ground this 7 day of December, 1979.

Witnesses:

Locator:

AMERICAN SELCO INC.

By [Signature]
Agent for
American Selco Inc.

STATE OF NEVADA)
COUNTY OF _____)

RECORDED AT THE REQUEST OF American Selco Inc.
on February 27, 1980, at 45 mins. past 9 A. M. In
) ss. Book 79 of OFFICIAL RECORDS, page 198, RECORDS OF
) EUREKA COUNTY, NEVADA. WILLIS A. DePAOLI Recorder
File No. 72631 Fee \$ 3.00

I hereby certify that the within instrument was filed and recorded at the request of: _____
FILE NO. _____
on _____
at _____
Docket _____ Page _____

Witness my hand and official seal the day and year aforesaid.

County Recorder

By _____
Deputy Recorder

CERTIFICATE OF MINING LOCATION
LODE CLAIM ON PUBLIC DOMAIN

72632

NOTICE IS HEREBY GIVEN that the Selrat No. 174 lode mining claim has been located by AMERICAN SELCO INC. a New York corporation, whose address is 90 West Grove Street, Suite 100, Reno, Nevada 89509. The general course of this claim is N 30 E. This claim is 1500 feet in length along the course of the claim, being 10 feet from the point of discovery in a N 30 E direction to the March end line of this claim, and 1490 feet in a S 30 W direction to the South end line of the claim. This claim is 600 feet in width, being 300 feet in width on each side of the center line of the claim.

This claim is located within the SE Quarter of Section 28, Township 18 North, Range 53 East, Mount Diablo Base and Meridian, unknown Mining District, Eureka County, Nevada. The location monument of this claim is situated with reference to some natural object or permanent monument as follows: Corner No. 1 of this claim is located appx. 5000 ft. N 67 W from Claim Location Marker SRL. Claim Location

Marker SRL a 3' x 6' steel pipe, is located appx.: 1.93 mi. N76°E from Grays Peak; 2.50 mi. N8° E from South Hill Peak; 0.55 mi. S27° W from Surprise Peak.

The corners of this claim are marked by 4"x4" posts or 4" trees with metal tags inscribed with the appropriate corner number as shown on the following sketch and the accompanying claim map.

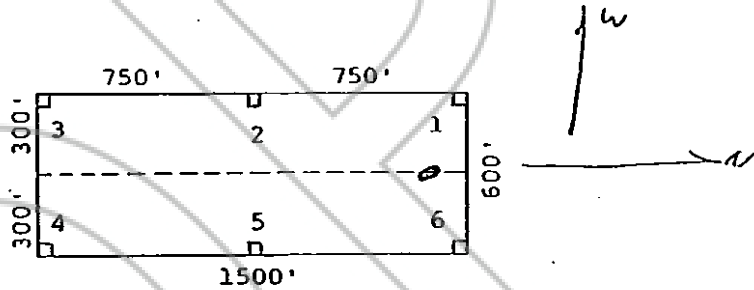

The location work consisted of making the maps as provided in NRS 517.040.

Dated and posted on the ground this 6 day of December, 1979.

Witnesses:

Locator:

AMERICAN SELCO INC.

By [Signature]
Agent for
American Selco Inc.

RECORDED AT THE REQUEST OF American Selco Inc.

STATE OF NEVADA)

on February 27, 1980, at 45 mins. past 9 A. M.)

COUNTY OF _____)

ss. Book 79 of OFFICIAL RECORDS, page 199, RECORDS OF

EUREKA COUNTY, NEVADA.

WILLIS A. DePAOLI Recorder

File No. 72632

Fee \$ 3.00

I hereby certify that the within instrument was filed and recorded at the request of: _____

Witness my hand and official seal the day and year aforesaid.

FILE NO. _____

County Recorder

on _____ at _____

By _____
Deputy Recorder

Docket _____ Page _____

BOOK 79 PAGE 199

72633

NOTICE IS HEREBY GIVEN that the Selrat No. 175 lode mining claim has been located by AMERICAN SELCO INC. a New York corporation, whose address is 90 West Grove Street, Suite 100, Reno, Nevada 89509. The general course of this claim is N 30° E. This claim is 1500 feet in length along the course of the claim, being 1490 feet from the point of discovery in a N 30° E direction to the North end line of this claim, and 10 feet in a S 30° W direction to the South end line of the claim. This claim is 600 feet in width, being 300 feet in width on each side of the center line of the claim.

This claim is located within the SE Quarter of Section 28, Township 18 North, Range S3 East, Mount Diablo Base and Meridian, unknown Mining District, Eureka County, Nevada. The location monument of this claim is situated with reference to some natural object or permanent monument as follows: Corner No. 1 of this claim is located appx. 4600 ft. S 76° W from Claim Location Marker SRI. Claim Location Marker SRI a 3' x 6' steel pipe, is located appx.: 1.93 mi. N76°E from Grays Peak; 2.50 mi. N8° E from South Hill Peak; 0.55 mi. S27° W from Surprise Peak.

The corners of this claim are marked by 4"x4" posts or 4" trees with metal tags inscribed with the appropriate corner number as shown on the following sketch and the accompanying claim map.

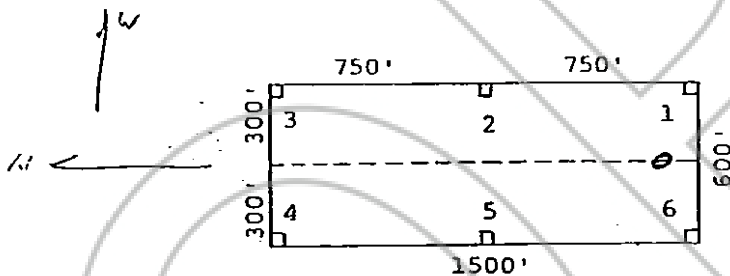

The location work consisted of making the maps as provided in NRS 517.040.

Dated and posted on the ground this 7 day of December, 1979.

Witnesses:

Locator:

AMERICAN SELCO INC.

By [Signature]
Agent for
American Selco Inc.

STATE OF NEVADA

COUNTY OF _____

RECORDED AT THE REQUEST OF American Selco Inc.
on February 27, 1980, at 45 min. past 9 A.M. in
) ss. Book 79 of OFFICIAL RECORDS, page 200, RECORDS OF
) EUREKA COUNTY, NEVADA. WILLIS A. DaPAOLI Recorder
Els No. 72633 Fee 3.00

I hereby certify that the within instrument was filed and recorded at the request of: _____

FILE NO. _____
on _____
at _____
Docket _____ Page _____

Witness my hand and official seal the day and year aforesaid.

County Recorder

By _____
Deputy Recorder

BOOK 79 PAGE 200

STATE OF NEVADA
CERTIFICATE OF MINING LOCATION
LODE CLAIM ON PUBLIC DOMAIN

72634

NOTICE IS HEREBY GIVEN that the Selrat No. 176 lode mining claim has been located by AMERICAN SELCO INC. a New York corporation, whose address is 90 West Grove Street, Suite 100, Reno, Nevada 89509. The general course of this claim is N 30° E. This claim is 1500 feet in length along the course of the claim, being 10 feet from the point of discovery in a N 30° E direction to the Northern end line of this claim, and 1490 feet in a S 30° W direction to the Southern end line of the claim. This claim is 600 feet in width, being 300 feet in width on each side of the center line of the claim.

This claim is located within the SW Quarter of Section 27, Township 18 North, Range 53 East, Mount Diablo Base and Meridian, unknown Mining District, Eureka County, Nevada. The location monument of this claim is situated with reference to some natural object or permanent monument as follows: Corner No. 1 of this claim is located appx. 3950 ft. N 60° W from Claim Location Marker SRL. Claim Location

Marker SRL a 3' x 6' steel pipe, is located appx.: 1.93 mi. N76°E from Grays Peak; 2.50 mi. N8° E from South Hill Peak; 0.55 mi. S27° W from Surprise Peak.

The corners of this claim are marked by 4"x4" posts or 4" trees with metal tags inscribed with the appropriate corner number as shown on the following sketch and the accompanying claim map.

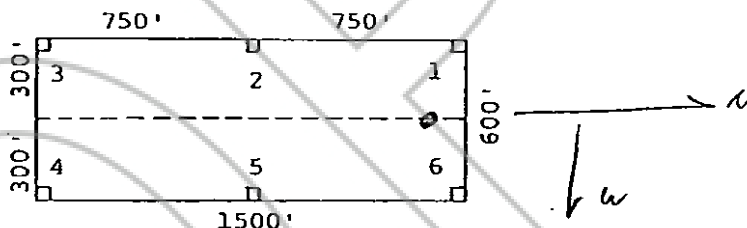

The location work consisted of making the maps as provided in NRS 517.040.

Dated and posted on the ground this 6 day of December, 1979.

Witnesses:

Locator:

AMERICAN SELCO INC.

By [Signature]
Agent for
American Selco Inc.

STATE OF NEVADA

COUNTY OF _____

RECORDED AT THE REQUEST OF American Selco Inc.
on February 27, 1980 at 45 mins. past 9 A. M. in
) ss. Book 79 of OFFICIAL RECORDS, page 201, RECORDS OF
) EUREKA COUNTY, NEVADA WILLIS A. DePAOLI Recorder
File No. 72634 Fee \$ 3.00

I hereby certify that the within instrument was filed and recorded at the request of: _____

Witness my hand and official seal the day and year aforesaid.

FILE NO. _____
on _____
at _____
Docket _____ Page _____

County Recorder

By _____
Deputy Recorder

72635

NOTICE IS HEREBY GIVEN that the Selrat No. 177 lode mining claim has been located by AMERICAN SELCO INC. a New York corporation, whose address is 90 West Grove Street, Suite 100, Reno Nevada 89509. The general course of this claim is N 30° E. This claim is 1500 feet in length along the course of the claim, being 1490 feet from the point of discovery in a N 30° E direction to the N 60° E end line of this claim, and 10 feet in a S 30° W direction to the S 60° W end line of the claim. This claim is 600 feet in width, being 300 feet in width on each side of the center line of the claim.

This claim is located within the SW Quarter of Section 27, Township 18 North, Range 53 East, Mount Diablo Base and Meridian, unknown Mining District, Eureka County, Nevada. The location monument of this claim is situated with reference to some natural object or permanent monument as follows: Corner No. 1 of this claim is located appx. 3450 ft. S 72° W from Claim Location Marker SRI. Claim Location

Marker SRI a 3' x 6' steel pipe, is located appx.: 1.93 mi. N76°E from Grays Peak; 2.50 mi. N8° E from South Hill Peak; 0.55 mi. S27° W from Surprise Peak.

The corners of this claim are marked by 4"x4" posts or 4" trees with metal tags inscribed with the appropriate corner number as shown on the following sketch and the accompanying claim map.

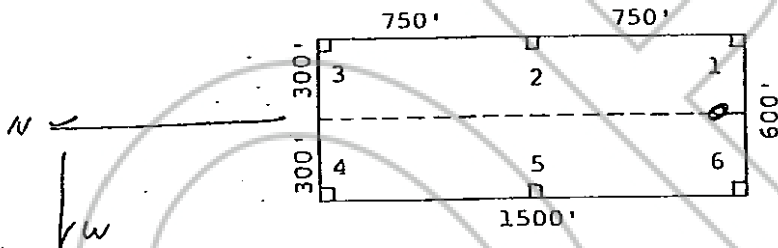

The location work consisted of making the maps as provided in NRS 517.040.

Dated and posted on the ground this 7 day of December, 1979.

Witnesses:

Locator:

AMERICAN SELCO INC.

By [Signature]
Agent for
American Selco Inc.

STATE OF NEVADA

COUNTY OF _____

RECORDED AT THE REQUEST OF American Selco Inc.
on February 27, 1980, at 45 mins. past 9 A. M. in
) ss. Book 79 of OFFICIAL RECORDS, page 202, RECORDS OF
) EUREKA COUNTY, NEVADA. WILLIS A. DePAOLI Recorder
File No. 72635 Fee 3.00

I hereby certify that the within instrument was filed and recorded at the request of: _____

FILE NO. _____
on _____
at _____
Docket _____ Page _____

Witness my hand and official seal the day and year aforesaid.

County Recorder

By _____
Deputy Recorder

BOOK 79 PAGE 202

72636

STATE OF NEVADA
CERTIFICATE OF MINING LOCATION
LODE CLAIM ON PUBLIC DOMAIN

NOTICE IS HEREBY GIVEN that the Selrat No. 178 lode mining claim has been located by AMERICAN SELCO INC. a New York corporation, whose address is 90 West Grove Street, Suite 100, Reno, Nevada 89509. The general course of this claim is N30°E. This claim is 1500 feet in length along the course of the claim, being 10 feet from the point of discovery in a N30°E direction to the North end line of this claim, and 1490 feet in a S30°W direction to the South end line of the claim. This claim is 600 feet in width, being 300 feet in width on each side of the center line of the claim.

This claim is located within the N40 Quarter of Section 34, Township 18 North, Range 53 East, Mount Diablo Base and Meridian, unknown Mining District, Eureka County, Nevada. The location monument of this claim is situated with reference to some natural object or permanent monument as follows: Corner No. 1 of this claim is located appx. 3450 ft. S72°W from Claim Location Marker SRI. Claim Location Marker SRI a 3' x 6' steel pipe, is located appx.: 1.93 mi. N76°E from Grays Peak; 2.50 mi. N8° E from South Hill Peak; 0.55 mi. S27° W from Surprise Peak.

The corners of this claim are marked by 4"x4" posts or 4" trees with metal tags inscribed with the appropriate corner number as shown on the following sketch and the accompanying claim map.

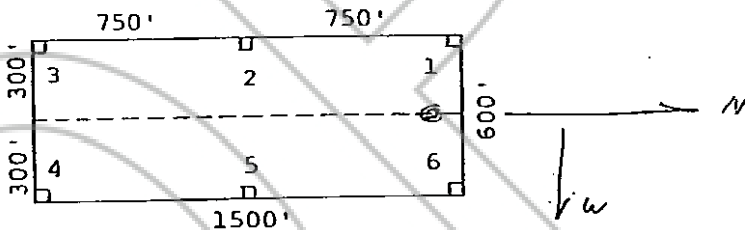

The location work consisted of making the maps as provided in NRS 517.040.

Dated and posted on the ground this 7 day of December, 1979.

Witnesses:

Locator:

AMERICAN SELCO INC.

By [Signature]
Agent for
American Selco Inc.

STATE OF NEVADA

COUNTY OF _____

RECORDED AT THE REQUEST OF American Selco Inc.
on February 27, 1980, at 45 mins. past 9 A. M. p.m.
) ss. Book 79 of OFFICIAL RECORDS, page 203, RECORDS OF
) EUREKA COUNTY, NEVADA
File No. 72636 WILLIS A. DePAOLI Recorder
Fee \$ 3.00

I hereby certify that the within instrument was filed and recorded at the request of: _____

FILE NO. _____
on _____
at _____
Docket _____ Page _____

Witness my hand and official seal the day and year aforesaid.

County Recorder

By _____
Deputy Recorder

BOOK 79 PAGE 203

72637

STATE OF NEVADA
CERTIFICATE OF MINING LOCATION
LODE CLAIM ON PUBLIC DOMAIN

NOTICE IS HEREBY GIVEN that the Selrat No. 179 lode mining claim has been located by AMERICAN SELCO INC. a New York corporation, whose address is 90 West Grove Street, Suite 100, Reno, Nevada 89509. The general course of this claim is N 30° E. This claim is 1500 feet in length along the course of the claim, being 10 feet from the point of discovery in a N 30° E direction to the North end line of this claim, and 1490 feet in a S 30° W direction to the South end line of the claim. This claim is 600 feet in width, being 300 feet in width on each side of the center line of the claim.

This claim is located within the NE Quarter of Section 33, Township 18 North, Range 53 East, Mount Diablo Base and Meridian, unknown Mining District, Eureka County, Nevada. The location monument of this claim is situated with reference to some natural object or permanent monument as follows: Corner No. 1 of this claim is located appx. 4000 ft. S 76° W from Claim Location Marker SRI. Claim Location

Marker SRI a 3' x 6' steel pipe, is located appx.: 1.93 mi. N76°E from Grays Peak; 2.50 mi. N8° E from South Hill Peak; 0.55 mi. S27° W from Surprise Peak.

The corners of this claim are marked by 4"x4" posts or 4" trees with metal tags inscribed with the appropriate corner number as shown on the following sketch and the accompanying claim map.

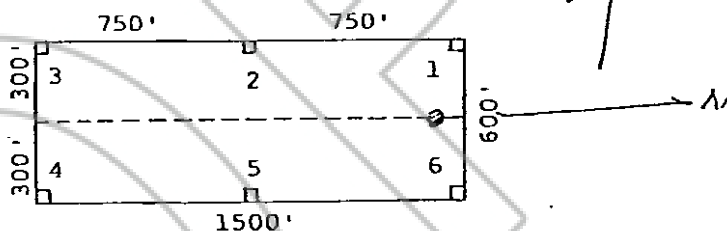

The location work consisted of making the maps as provided in NRS 517.040.

Dated and posted on the ground this 7 day of December, 1979.

Witnesses: _____ Locator: _____
AMERICAN SELCO INC.
By [Signature]
Agent for
American Selco Inc.

STATE OF NEVADA)
COUNTY OF _____)

RECORDED AT THE REQUEST OF American Selco Inc.
on February 27, 19 89, at 45 mins. past 9 A.M. in
) ss. Book 79 of OFFICIAL RECORDS, page 204, RECORDS OF
EUREKA COUNTY, NEVADA. WILLIS A. DePAOLI Recorder
File No. 72637 Fee \$ 3.00

I hereby certify that the within instrument was filed and recorded at the request of: _____
FILE NO. _____
on _____
at _____
Docket _____ Page _____

Witness my hand and official seal the day and year aforesaid.

County Recorder
By _____
Deputy Recorder

72638

STATE OF NEVADA
CERTIFICATE OF MINING LOCATION
LODE CLAIM ON PUBLIC DOMAIN

NOTICE IS HEREBY GIVEN that the Selrat No. 180 lode mining claim has been located by AMERICAN SELCO INC. a New York corporation, whose address is 90 West Grove Street, Suite 100, Reno, Nevada 89509. The general course of this claim is N 70° E. This claim is 1500 feet in length along the course of the claim, being 1490 feet from the point of discovery in a N 70° E direction to the North end line of this claim, and 10 feet in a S 70° W direction to the South end line of the claim. This claim is 600 feet in width, being 300 feet in width on each side of the center line of the claim.

This claim is located within the NE Quarter of Section 33, Township 18 North, Range S 3 East, Mount Diablo Base and Meridian, unknown Mining District, Eureka County, Nevada. The location monument of this claim is situated with reference to some natural object or permanent monument as follows: Corner No. 1 of this claim is located appx. S 350 ft. S 53° W from Claim Location Marker SRI. Claim Location Marker SRI a 3' x 6' steel pipe, is located appx.: 1.93 mi. N76°E from Grays Peak; 2.50 mi. N8° E from South Hill Peak; 0.55 mi. S27° W from Surprise Peak.

The corners of this claim are marked by 4"x4" posts or 4" trees with metal tags inscribed with the appropriate corner number as shown on the following sketch and the accompanying claim map.

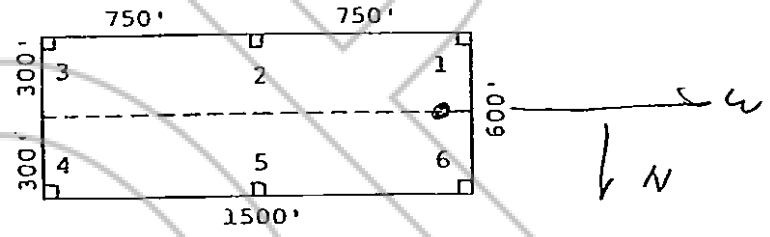

The location work consisted of making the maps as provided in NRS 517.040.

Dated and posted on the ground this 11 day of December, 1979.

Witnesses:

Locator:
AMERICAN SELCO INC.
By [Signature]
Agent for
American Selco Inc.

STATE OF NEVADA
COUNTY OF _____

RECORDED AT THE REQUEST OF American Selco Inc.
) on February 27, 1980, at 45 mins. past 9 A. M. In
) SS. Book 79 of OFFICIAL RECORDS, page 205, RECORDS OF
) EUREKA COUNTY, NEVADA. WILLIS A. DePAOLI Recorder
Ely No. 72638 Fee 3.00

I hereby certify that the within instrument was filed and recorded at the request of: _____
FILE NO. _____
on _____
at _____
Docket _____ Page _____

Witness my hand and official seal the day and year aforesaid.

County Recorder
By _____
Deputy Recorder

BOOK 79 PAGE 205

NOTICE IS HEREBY GIVEN that the Selrat No. 181 lode mining claim has been located by AMERICAN SELCO INC. a New York corporation, whose address is 90 West Grove Street, Suite 100, Reno, Nevada 89509. The general course of this claim is N 20° W. This claim is 1500 feet in length along the course of the claim, being 1420 feet from the point of discovery in a N 20° W direction to the North end line of this claim, and 10 feet in a S 70° E direction to the South end line of the claim. This claim is 600 feet in width, being 300 feet in width on each side of the center line of the claim.

This claim is located within the NW Quarter of Section 34, Township 18 North, Range 53 East, Mount Diablo Base and Meridian, unknown Mining District, Eureka County, Nevada. The location monument of this claim is situated with reference to some natural object or permanent monument as follows: Corner No. 1 of this claim is located appx. 5850 ft. S 38° W from Claim Location Marker SRI. Claim Location

Marker SRI a 3' x 6' steel pipe, is located appx.: 1.93 mi. N76°E from Grays Peak; 2.50 mi. N8° E from South Hill Peak; 0.55 mi. S27° W from Surprise Peak.

The corners of this claim are marked by 4"x4" posts or 4" trees with metal tags inscribed with the appropriate corner number as shown on the following sketch and the accompanying claim map.

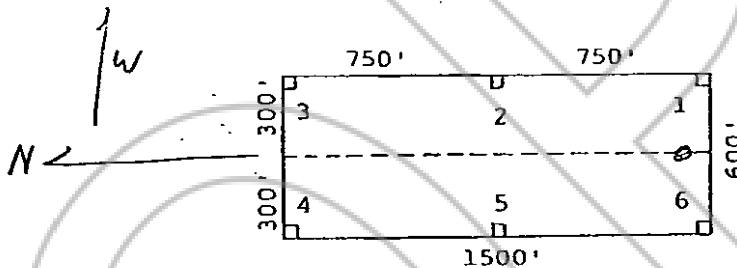

The location work consisted of making the maps as provided in NRS 517.040.

Dated and posted on the ground this 11 day of December, 1979.

Witnesses:

Locator:

AMERICAN SELCO INC

By [Signature]
Agent for
American Selco Inc.

RECORDED AT THE REQUEST OF American Selco Inc.
on February 27, 1980 at 45 mins. past 9 A. M. In
Book 79 of OFFICIAL RECORDS, page 206, RECORDS OF
EUREKA COUNTY, NEVADA. WILLIS A. DePAOLI Recorder
File No. 72639 Fee \$ 3.00

STATE OF NEVADA

COUNTY OF _____

I hereby certify that the within instrument was filed and recorded at the request of: _____

FILE NO. _____
on _____
at _____
Docket _____ Page _____

Witness my hand and official seal the day and year aforesaid.

County Recorder

By _____
Deputy Recorder

BOOK 79 PAGE 206

CERTIFICATE OF MINING LOCATION
LODE CLAIM ON PUBLIC DOMAIN

72640

NOTICE IS HEREBY GIVEN that the Selrat No. 182 lode mining claim has been located by AMERICAN SELCO INC. a New York corporation, whose address is 90 West Grove Street, Suite 100, Reno, Nevada 89509. The general course of this claim is N70°W. This claim is 1500 feet in length along the course of the claim, being 1490 feet from the point of discovery in a N70°W direction to the Nth end line of this claim, and 10 feet in a S20°E direction to the South end line of the claim. This claim is 600 feet in width, being 300 feet in width on each side of the center line of the claim.

This claim is located within the NW Quarter of Section 34, Township 18 North, Range S3 East, Mount Diablo Base and Meridian, unknown Mining District, Eureka County, Nevada. The location monument of this claim is situated with reference to some natural object or permanent monument as follows: Corner No. 1 of this claim is located appx. 4600 ft. S32°W from Claim Location Marker SRI. Claim Location

Marker SRI a 3' x 6' steel pipe, is located appx.: 1.93 mi. N76°E from Grays Peak; 2.50 mi. N8° E from South Hill Peak; 0.55 mi. S27° W from Surprise Peak.

The corners of this claim are marked by 4"x4" posts or 4" trees with metal tags inscribed with the appropriate corner number as shown on the following sketch and the accompanying claim map.

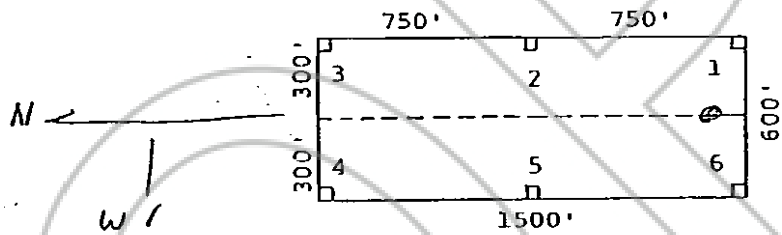

The location work consisted of making the maps as provided in NRS 517.040.

Dated and posted on the ground this 11 day of December 1979.

Witnesses:

Locator:

AMERICAN SELCO INC.

By [Signature]
Agent for
American Selco Inc.

STATE OF NEVADA)
COUNTY OF _____)

RECORDED AT THE REQUEST OF American Selco Inc.
on February 27, 19 80 at 45 mins. past 9 A.M. 19
Book 79 of OFFICIAL RECORDS, page 207, RECORDS OF
EUREKA COUNTY, NEVADA WILLIS A. DePAOLI Recorder
File No. 72640 Fee \$ 3.00

I hereby certify that the within instrument was filed and recorded at the request of: _____
FILE NO. _____
on _____
at _____
Docket _____ Page _____

Witness my hand and official seal the day and year aforesaid.

County Recorder

By _____
Deputy Recorder

72641

STATE OF NEVADA
CERTIFICATE OF MINING LOCATION
LODE CLAIM ON PUBLIC DOMAIN

NOTICE IS HEREBY GIVEN that the Selrat No. 183 lode mining claim has been located by AMERICAN SELCO INC. a New York corporation, whose address is 90 West Grove Street, Suite 100, Reno Nevada 89509. The general course of this claim is N 20° W. This claim is 1500 feet in length along the course of the claim, being 10 feet from the point of discovery in a N 20° W direction to the North end line of this claim and 1490 feet in a S 20° E direction to the South end line of the claim. This claim is 600 feet in width, being 300 feet in width on each side of the center line of the claim.

This claim is located within the SW Quarter of Section 34, Township 18 North, Range 53 East, Mount Diablo Base and Meridian, unknown Mining District, Eureka County, Nevada. The location monument of this claim is situated with reference to some natural object or permanent monument as follows: Corner No. 1 of this claim is located appx. 5850 ft. S 38° W from Claim Location Marker SR1. Claim Location Marker SR1 a 3' x 6' steel pipe, is located appx.: 1.93 mi. N 76° E from Grays Peak; 2.50 mi. N 8° E from South Hill Peak; 0.55 mi. S 27° W from Surprise Peak.

The corners of this claim are marked by 4"x4" posts or 4" trees with metal tags inscribed with the appropriate corner number as shown on the following sketch and the accompanying claim map.

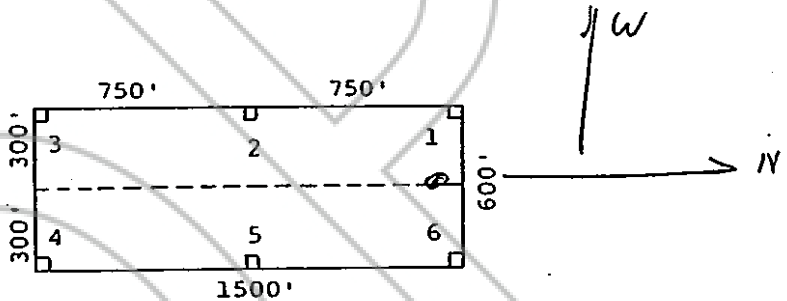

The location work consisted of making the maps as provided in NRS 517.040.

Dated and posted on the ground this 11 day of December 1979.

Witnesses:

Locator:

AMERICAN SELCO INC.

By [Signature]
Agent for
American Selco Inc.

RECORDED AT THE REQUEST OF American Selco Inc.
on February 27, 1980, at 45 mins. past 9 A. M. in
Book 79 of OFFICIAL RECORDS, page 208, RECORDS OF
) SS. EUREKA COUNTY, NEVADA. WILLIS A. DePAOLI Recorder
) File No. 72641 Fee \$ 3.00

STATE OF NEVADA

COUNTY OF _____

I hereby certify that the within instrument was filed and recorded at the request of: _____

FILE NO. _____
on _____
at _____
Docket _____ Page _____

Witness my hand and official seal the day and year aforesaid.

County Recorder

By _____
Deputy Recorder

BOOK 79 PAGE 208

72642

STATE OF NEVADA
CERTIFICATE OF MINING LOCATION
LODE CLAIM ON PUBLIC DOMAIN

NOTICE IS HEREBY GIVEN that the Selrat No. 184 lode mining claim has been located by AMERICAN SELCO INC. a New York corporation, whose address is 90 West Grove Street, Suite 100, Reno, Nevada 89509. The general course of this claim is N 20° W. This claim is 1500 feet in length along the course of the claim, being 10 feet from the point of discovery in a N 20° W direction to the North end line of this claim, and 1790 feet in a S 20° E direction to the South end line of the claim. This claim is 600 feet in width, being 300 feet in width on each side of the center line of the claim.

This claim is located within the SW Quarter of Section 34, Township 18 North, Range S 3 East, Mount Diablo Base and Meridian, unknown Mining District, Eureka County, Nevada. The location monument of this claim is situated with reference to some natural object or permanent monument as follows: Corner No. 1 of this claim is located appx. 4600 ft. S 32° W from Claim Location Marker SR1. Claim Location Marker SR1 a 3' x 6' steel pipe, is located appx.: 1.93 mi. N76°E from Grays Peak; 2.50 mi. N8° E from South Hill Peak; 0.55 mi. S27° W from Surprise Peak.

The corners of this claim are marked by 4"x4" posts or 4" trees with metal tags inscribed with the appropriate corner number as shown on the following sketch and the accompanying claim map.

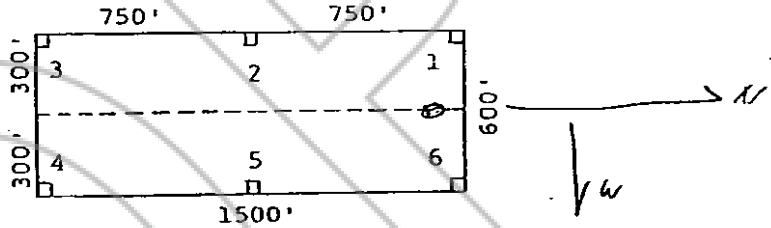

The location work consisted of making the maps as provided in NRS 517.040.

Dated and posted on the ground this 11 day of December, 1979.

Witnesses:

Locator:

AMERICAN SELCO INC.

By [Signature]
Agent for
American Selco Inc.

STATE OF NEVADA

COUNTY OF _____

)
) ss.
)

RECORDED AT THE REQUEST OF American Selco Inc.
on February 27, 1980 at 45 mins. past 9 A. M. In
Book 79 of OFFICIAL RECORDS, page 209, RECORDS OF
EUREKA COUNTY, NEVADA. WILLIS A. DePAOLI Recorder
File No. 72642 Fee \$ 3.00

I hereby certify that the within instrument was filed and recorded at the request of: _____
FILE NO. _____
on _____
at _____
Docket _____ Page _____

Witness my hand and official seal the day and year aforesaid.

County Recorder

By _____
Deputy Recorder

BOOK 79 PAGE 209

72643

STATE OF NEVADA
CERTIFICATE OF MINING LOCATION
LODE CLAIM ON PUBLIC DOMAIN

NOTICE IS HEREBY GIVEN that the Selrat No. 185 lode mining claim has been located by AMERICAN SELCO INC. a New York corporation, whose address is 90 West Grove Street, Suite 100, Reno, Nevada 89509. The general course of this claim is N 20° W. This claim is 1500 feet in length along the course of the claim, being 1490 feet from the point of discovery in a N 20° W direction to the Northern end line of this claim, and 10 feet in a S 70° E direction to the Southern end line of the claim. This claim is 600 feet in width, being 300 feet in width on each side of the center line of the claim.

This claim is located within the SW Quarter of Section 34, Township 18 North, Range 5 East, Mount Diablo Base and Meridian, unknown Mining District, Eureka County, Nevada. The location monument of this claim is situated with reference to some natural object or permanent monument as follows: Corner No. 1 of this claim is located appx. 7700 ft. S 17° E from Claim Location Marker SRI. Claim Location

Marker SRI a 3' x 6' steel pipe, is located appx.: 1.93 mi. N76°E from Grays Peak; 2.50 mi. N8° E from South Hill Peak; 0.55 mi. S27° W from Surprise Peak.

The corners of this claim are marked by 4"x4" posts or 4" trees with metal tags inscribed with the appropriate corner number as shown on the following sketch and the accompanying claim map.

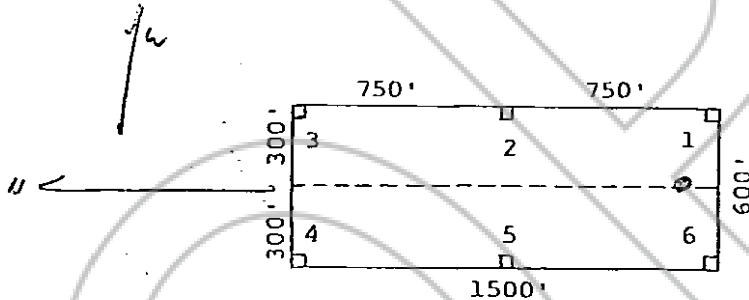

The location work consisted of making the maps as provided in NRS 517.040.

Dated and posted on the ground this 10 day of December 1979.

Witnesses:

Locator:

AMERICAN SELCO INC.

By [Signature]
Agent for
American Selco Inc.

STATE OF NEVADA)
COUNTY OF _____)

RECORDED AT THE REQUEST OF American Selco Inc.
on February 27, 1980, at 45 mins. past 9 A. M. 1980
Book 79 of OFFICIAL RECORDS, page 210, RECORDS OF
EUREKA COUNTY, NEVADA. WILLIS A. DePAOLI Recorder
File No. 72643 Fee \$ 3.00

I hereby certify that the within instrument was filed and recorded at the request of: _____

Witness my hand and official seal the day and year aforesaid.

FILE NO. _____
on _____
at _____
Docket _____ Page _____

County Recorder
By _____
Deputy Recorder

BOOK 79 PAGE 210

STATE OF NEVADA
 CERTIFICATE OF MINING LOCATION
 LODE CLAIM ON PUBLIC DOMAIN

72644

NOTICE IS HEREBY GIVEN that the Selrat No. 186 lode mining claim has been located by AMERICAN SELCO INC. a New York corporation, whose address is 90 West Grove Street, Suite 100, Reno, Nevada 89509. The general course of this claim is N 20° W. This claim is 1500 feet in length along the course of the claim, being 1490 feet from the point of discovery in a N 20° W direction to the N 1/4 end line of this claim, and 10 feet in a S 20° E direction to the South end line of the claim. This claim is 600 feet in width, being 300 feet in width on each side of the center line of the claim.

This claim is located within the SW Quarter of Section 34, Township 18 North, Range S 3 East, Mount Diablo Base and Meridian, unknown Mining District, Eureka County, Nevada. The location monument of this claim is situated with reference to some natural object or permanent monument as follows: Corner No. 1 of this claim is located appx. 6900 ft. S 10° W from Claim Location Marker SRI. Claim Location

Marker SRI a 3' x 6' steel pipe, is located appx.: 1.93 mi. N76°E from Grays Peak; 2.50 mi. N8° E from South Hill Peak; 0.55 mi. S27° W from Surprise Peak.

The corners of this claim are marked by 4"x4" posts or 4" trees with metal tags inscribed with the appropriate corner number as shown on the following sketch and the accompanying claim map.

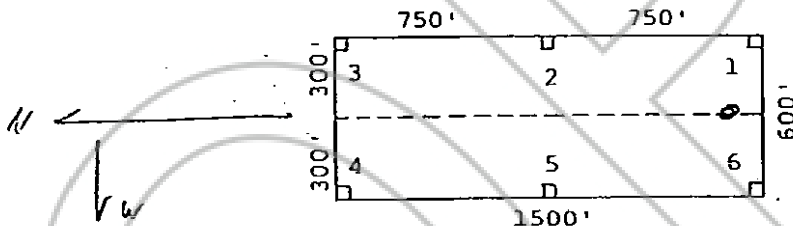

The location work consisted of making the maps as provided in NRS 517.040.

Dated and posted on the ground this 10 day of December, 1979.

Witnesses:

Locator:

AMERICAN SELCO INC.

By [Signature]
 Agent for
 American Selco Inc.

RECORDED AT THE REQUEST OF American Selco Inc.
 on February 27, 19 80, at 45 mins. past 9 A. M. In
 Book 79 of OFFICIAL RECORDS, page 211, RECORDS OF
) ss. EUREKA COUNTY, NEVADA. WILLIS A. DePAOLI Recorder
) File No. 72644 Fee \$ 3.00

STATE OF NEVADA

COUNTY OF _____

I hereby certify that the within instrument was filed and recorded at the request of: _____

FILE NO. _____
 on _____
 at _____
 Docket _____ Page _____

Witness my hand and official seal the day and year aforesaid.

County Recorder

By _____
 Deputy Recorder

BOOK 79 PAGE 211

NOTICE IS HEREBY GIVEN that the Selrat No. 187 lode mining claim has been located by AMERICAN SELCO INC. a New York corporation, whose address is 90 West Grove Street, Suite 100, Reno, Nevada 89509. The general course of this claim is N70°W. This claim is 1500 feet in length along the course of the claim, being 10 feet from the point of discovery in a N70°W direction to the North end line of this claim, and 400 feet in a S70°E direction to the South end line of the claim. This claim is 600 feet in width, being 300 feet in width on each side of the center line of the claim.

This claim is located within the NW Quarter of Section 3, Township 17 North, Range S3 East, Mount Diablo Base and Meridian, unknown Mining District, Eureka County, Nevada. The location monument of this claim is situated with reference to some natural object or permanent monument as follows: Corner No. 1 of this claim is located appx. 7700 ft. S17°W from Claim Location Marker SRL. Claim Location

Marker SRL a 3' x 6' steel pipe, is located appx.: 1.93 mi. N76°E from Grays Peak; 2.50 mi. N8° E from South Hill Peak; 0.55 mi. S27° W from Surprise Peak.

The corners of this claim are marked by 4"x4" posts or 4" trees with metal tags inscribed with the appropriate corner number as shown on the following sketch and the accompanying claim map.

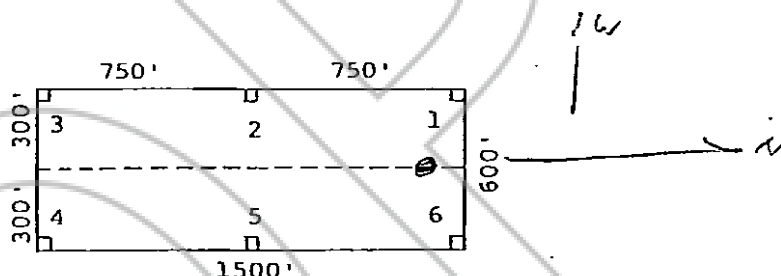

The location work consisted of making the maps as provided in NRS 517.040.

Dated and posted on the ground this 10 day of December, 1979.

Witnesses:

Locator:

AMERICAN SELCO INC.

By [Signature]
Agent for
American Selco Inc.

RECORDED AT THE REQUEST OF American Selco Inc.
on February 27, 19 80, at 45 mins. past 9 A.M. In
Book 79 of OFFICIAL RECORDS, page 212, RECORDS OF
EUREKA COUNTY, NEVADA. WILLIS A. DePAOLI Recorder
File No. 72645 Fee \$ 3.00

STATE OF NEVADA)

COUNTY OF _____)

I hereby certify that the within instrument was filed and recorded at the request of: _____

FILE NO. _____
on _____
at _____
Docket _____ Page _____

Witness my hand and official seal the day and year aforesaid.

County Recorder

By _____
Deputy Recorder

BOOK 79 PAGE 212

NOTICE IS HEREBY GIVEN that the Selrat No. 188 lode mining claim has been located by AMERICAN SELCO INC. a New York corporation, whose address is 90 West Grove Street, Suite 100, Reno, Nevada 89509. The general course of this claim is N72°0'W. This claim is 1500 feet in length along the course of the claim, being 10 feet from the point of discovery in a N72°0'W direction to the N64° end line of this claim, and 1490 feet in a S20°E direction to the South end line of the claim. This claim is 600 feet in width, being 300 feet in width on each side of the center line of the claim.

This claim is located within the 11W Quarter of Section 3, Township 17 North, Range 53 East, Mount Diablo Base and Meridian, unknown Mining District, Eureka County, Nevada. The location monument of this claim is situated with reference to some natural object or permanent monument as follows: Corner No. 1 of this claim is located appx 6400 ft. S10°W from Claim Location Marker SRI. Claim Location

Marker SRI a 3' x 6' steel pipe, is located appx.: 1.93 mi. N76°E from Grays Peak; 2.50 mi. N8° E from South Hill Peak; 0.55 mi. S27° W from Surprise Peak.

The corners of this claim are marked by 4"x4" posts or 4" trees with metal tags inscribed with the appropriate corner number as shown on the following sketch and the accompanying claim map.

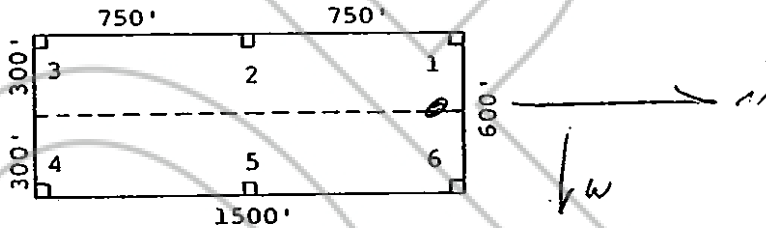

The location work consisted of making the maps as provided in NRS 517.040.

Dated and posted on the ground this 10 day of December 1979.

Witnesses: _____ Locator: AMERICAN SELCO INC.
By [Signature]
Agent for American Selco Inc.

STATE OF NEVADA
COUNTY OF _____

RECORDED AT THE REQUEST OF American Selco Inc.
on February 27, 19 80, at 45 mins. past 9 A.M. '19
) ss. Book 79 of OFFICIAL RECORDS, page 213, RECORDS OF
) EUREKA COUNTY, NEVADA. WILLIS A. DePAOLI Recorder
File No. 72646 Fee \$ 3.00

I hereby certify that the within instrument was filed and recorded at the request of: _____
FILE NO. _____
on _____
at _____
Docket _____ Page _____

Witness my hand and official seal the day and year aforesaid.
County Recorder
By _____
Deputy Recorder

BOOK 79 PAGE 213