

NOTICE IS HEREBY GIVEN that the Sam No. /
 lode mining claim has been located by Lyle F. Campbell. This
 claim is a relocation of the Samarkand No. / lode mining claim,
 the certificate of location of which is of record in the office
 of the recorder of Eureka County, Nevada in Book 22 page
386, in accordance with NRS 517.080. The general course of
 this claim is North/ South. This claim is
 1500 feet in length along the course of the claim, being 1490
 feet from the point of discovery in a North direction to
 the North end line of this claim, and 10 feet in
 a South direction to the South end line of the claim.
 This claim is 600 feet in width, being 300 feet in width on each
 side of the center line of the claim.

This claim is located within the NW Quarter
 of Section 5, Township 22 North, Range 51 East,
 Mount Diablo Base and Meridian, unknown Mining District,
Eureka County, Nevada. The location monument of
 this claim is situated with reference to some natural object or
 permanent monument as follows: Corner no. 1 of this claim is located
approximately 14900 feet N 17° W of the located SE corner of
Section 17 T22N, R51E, MDM

The corners of this claim are marked by 4"x4"x5" posts of
native timber with metal tags inscribed with the appropriate corner number
 as shown on the following sketch and the accompanying claim map.

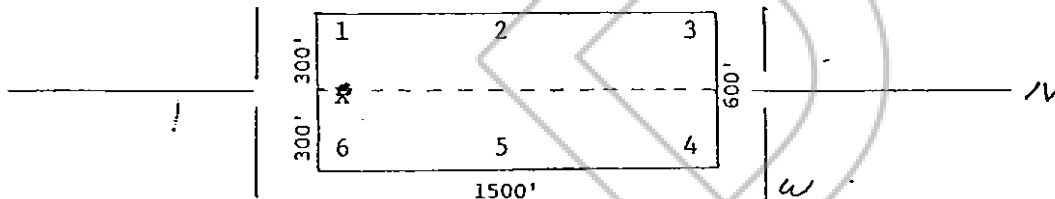

The location work consisted of making the maps as provided
 in NRS 517.040.

Dated and posted on the ground this 7 day of March,
 1980

Witnesses:

Locator:

LYLE F. CAMPBELL
 P.O. Box 7377
 Reno, Nevada 89510

STATE OF NEVADA

COUNTY OF _____

ss.

I hereby certify that the within
 instrument was filed and recorded at
 the request of: _____

FILE NO. _____
 on _____
 at _____ M.,
 Docket _____ Page _____

Witness my hand and official
 seal the day and
 year aforesaid.

County Recorder

By

Deputy Recorder

DPK/jlm 2/1/79 (3)

BOOK 81 PAGE 367

FILED AT REQUEST OF
 American Seals, Inc.
 6004 - 81 - 367367

60 MAY 30 AIO: 33

CLERK OF DISTRICT COURT
 COUNTY OF EUREKA
 FILED
 MAY 30 1980
 73755

STATE OF NEVADA
 CERTIFICATE OF MINING LOCATION
 LOSE CLAIM ON PUBLIC DOMAIN

NOTICE IS HEREBY GIVEN that the Sam No. 2 lode mining claim has been located by Lyle F. Campbell. This claim is a relocation of the Samarkand No. 2 lode mining claim, the certificate of location of which is of record in the office of the recorder of Eureka County, Nevada in Book 22 page 387, in accordance with NRS 517.080. The general course of this claim is North/ South. This claim is 1500 feet in length along the course of the claim, being 10 feet from the point of discovery in a North direction to the North end line of this claim, and 1490 feet in a South direction to the South end line of the claim. This claim is 600 feet in width, being 300 feet in width on each side of the center line of the claim.

This claim is located within the NW Quarter of Section 5, Township 22 North, Range 51 East, Mount Diablo Base and Meridian, unknown Mining District, Eureka County, Nevada. The location monument of this claim is situated with reference to some natural object or permanent monument as follows: Corner no. 1 of this claim is located approximately 14900 feet N 17° W of the located SE corner of Section 17 T22N, R51E, MDM

The corners of this claim are marked by 4"x4"x5" posts of 4" native timber with metal tags inscribed with the appropriate corner number as shown on the following sketch and the accompanying claim map.

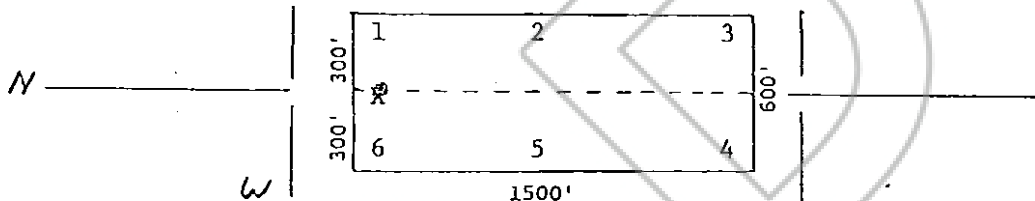

The location work consisted of making the maps as provided in NRS 517.040.

Dated and posted on the ground this 7 day of March, 1980

Witnesses:

Locator:

LYLE F. CAMPBELL
 P.O. Box 7377-
 Reno, Nevada 89510

STATE OF NEVADA)

COUNTY OF _____) ss.

I hereby certify that the within instrument was filed and recorded at the request of: _____

FILE NO. _____

on _____

at _____ M.,

Docket _____

Page _____

Witness my hand and official seal the day and year aforesaid.

County Recorder

By _____

Deputy Recorder

DPK/jlm 2/1/79 (3)

BOOK 81 PAGE 368

RECORDED AT REQUEST OF
 American Seale Inc.
 BOOK 81 PAGE 368

80 MAY 30 A.D. 80
 EUREKA COUNTY
 WILLIAM D. BROWN
 CLERK

STATE OF NEVADA
 CERTIFICATE OF MINING LOCATION
 LODE CLAIM ON PUBLIC DOMAIN

NOTICE IS HEREBY GIVEN that the Sam No. 3 lode mining claim has been located by Lyle F. Campbell. This claim is a relocation of the Samarkand No. 3 lode mining claim, the certificate of location of which is of record in the office of the recorder of Eureka County, Nevada in Book 22 page 388, in accordance with NRS 517.080. The general course of this claim is North/South. This claim is 1500 feet in length along the course of the claim, being 10 feet from the point of discovery in a North direction to the North end line of this claim, and 1490 feet in a South direction to the South end line of the claim. This claim is 600 feet in width, being 300 feet in width on each side of the center line of the claim.

This claim is located within the NW Quarter of Section 5, Township 22 North, Range 51 East, Mount Diablo Base and Meridian, unknown Mining District, Eureka County, Nevada. The location monument of this claim is situated with reference to some natural object or permanent monument as follows: Corner no. 1 of this claim is located approximately 14900 feet N 17° W of the located SE corner of Section 17 T22N, R51E, MDM

The corners of this claim are marked by 4"x4"x5" posts of 4" native timber with metal tags inscribed with the appropriate corner number as shown on the following sketch and the accompanying claim map.

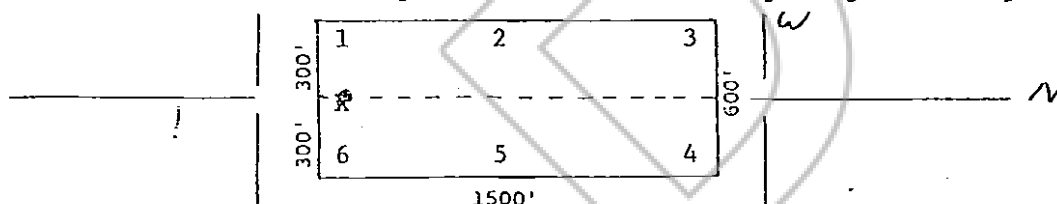

The location work consisted of making the maps as provided in NRS 517.040.

Dated and posted on the ground this 7 day of March, 1980

Witnesses:

Locator:

LYLE F. CAMPBELL
 P.O. Box 7377
 Reno, Nevada 89510

STATE OF NEVADA

COUNTY OF _____

) ss.

I hereby certify that the within instrument was filed and recorded at the request of:

FILE NO. _____
 on _____
 at _____ M.,
 Docket _____ Page _____

Witness my hand and official seal the day and year aforesaid.

County Recorder

By _____ Deputy Recorder

DPK/jlm 2/1/79 (3)

BOOK 81 PAGE 369

RECORDED AT REQUEST OF
 American Galse Inc.
 BOOK 81 PAGE 369

90 MAY 30 AIO: 33
 COUNTY RECORDER
 EUREKA COUNTY, NEVADA
 WILLIAM J. CAMPBELL
 73757

STATE OF NEVADA
CERTIFICATE OF MINING LOCATION
LODE CLAIM ON PUBLIC DOMAIN

73758

NOTICE IS HEREBY GIVEN that the Sam No. 4 lode mining claim has been located by Lyle F. Campbell. This claim is a relocation of the Samarkand No. 4 lode mining claim, the certificate of location of which is of record in the office of the recorder of Eureka County, Nevada in Book 22 page 389, in accordance with NRS 517.080. The general course of this claim is North/ South. This claim is 1500 feet in length along the course of the claim, being 10 feet from the point of discovery in a North direction to the North end line of this claim, and 1490 feet in a South direction to the South end line of the claim. This claim is 600 feet in width, being 300 feet in width on each side of the center line of the claim.

This claim is located within the NW Quarter of Section 5, Township 22 North, Range 51 East, Mount Diablo Base and Meridian, unknown Mining District, Eureka County, Nevada. The location monument of this claim is situated with reference to some natural object or permanent monument as follows: Corner no. 1 of this claim is located approximately 14900 feet N 17 W of the located SE corner of Section 17 T22N, R51E, MDM

The corners of this claim are marked by 4"x4"x5" posts of with metal tags inscribed with the appropriate corner number as shown on the following sketch and the accompanying claim map.

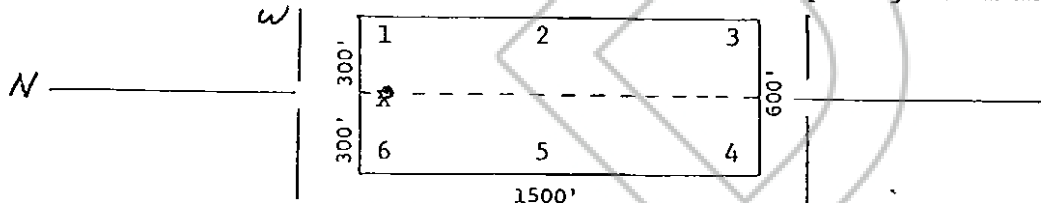

The location work consisted of making the maps as provided in NRS 517.040.

Dated and posted on the ground this 7 day of March, 1980

Witnesses:

Locator:

LYLE F. CAMPBELL
P.O. Box 7377
Reno, Nevada 89510

STATE OF NEVADA)
COUNTY OF _____) ss.

I hereby certify that the within instrument was filed and recorded at the request of: _____
FILE NO. _____
on _____
at _____ M.,
Docket _____ Page _____

Witness my hand and official seal the day and year aforesaid.

County Recorder
By _____ Deputy Recorder

DPK/jlm 2/1/79 (3)

BOOK 81 PAGE 370

RECORDED AT REQUEST OF
American Sales, Inc.
BOOK 81 PAGE 370

10 MAY 30 AID: 33
FILED
73758
EUREKA COUNTY, NEVADA

STATE OF NEVADA
 CERTIFICATE OF MINING LOCATION
 LODE CLAIM ON PUBLIC DOMAIN

NOTICE IS HEREBY GIVEN that the Sam No. 5 lode mining claim has been located by Lyle F. Campbell. This claim is a relocation of the Samarkand No. 5 lode mining claim, the certificate of location of which is of record in the office of the recorder of Eureka County, Nevada in Book 22 page 390, in accordance with NRS 517.080. The general course of this claim is North/ South. This claim is 1500 feet in length along the course of the claim, being 1490 feet from the point of discovery in a North direction to the North end line of this claim, and 10 feet in a South direction to the South end line of the claim. This claim is 600 feet in width, being 300 feet in width on each side of the center line of the claim.

This claim is located within the 11W Quarter of Section 5, Township 22 North, Range 51 East, Mount Diablo Base and Meridian, unknown Mining District, Eureka County, Nevada. The location monument of this claim is situated with reference to some natural object or permanent monument as follows: Corner no. 1 of this claim is located approximately 14600 feet N 12° W of the located SE corner of Section 17 T22N, R51E, MDM

The corners of this claim are marked by 4"x4"x5" posts of 4" native timber with metal tags inscribed with the appropriate corner number as shown on the following sketch and the accompanying claim map.

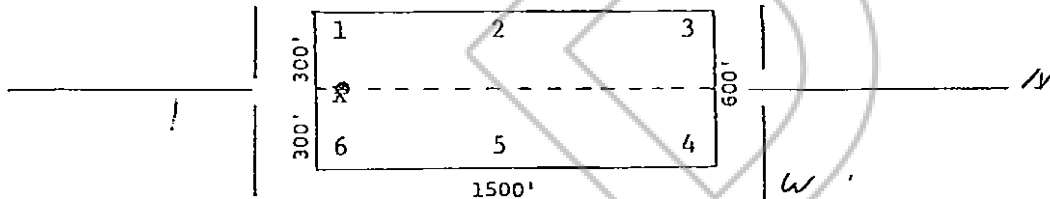

The location work consisted of making the maps as provided in NRS 517.040.

Dated and posted on the ground this 7 day of March, 1980

Witnesses:

Locator:

LYLE F. CAMPBELL
 P.O. Box 7377
 Reno, Nevada 89510

STATE OF NEVADA)

) ss.

COUNTY OF _____)

I hereby certify that the within instrument was filed and recorded at the request of: _____

FILE NO. _____

on _____

at _____ M.,

Docket _____

Page _____

Witness my hand and official seal the day and year aforesaid.

County Recorder

By _____

Deputy Recorder

DPK/jlm 2/1/79 (3)

BOOK 81 PAGE 371

RECORDED AT REQUEST OF
 American Helco Inc.
 BOOK 81 PAGE 371

OFFICIAL SEAL
 COUNTY OF EUREKA
 REC'D MAY 30 10:33 AM '80
 FILE NO. 73759
 300

STATE OF NEVADA
 CERTIFICATE OF MINING LOCATION
 LODE CLAIM ON PUBLIC DOMAIN

NOTICE IS HEREBY GIVEN that the Sam No. 6 lode mining claim has been located by Lyle F. Campbell. This claim is a relocation of the Samarkand No. 6 lode mining claim, the certificate of location of which is of record in the office of the recorder of Eureka County, Nevada in Book 22 page 391, in accordance with NRS 517.080. The general course of this claim is North/South. This claim is 1500 feet in length along the course of the claim, being 10 feet from the point of discovery in a North direction to the North end line of this claim, and 1490 feet in a South direction to the South end line of the claim. This claim is 600 feet in width, being 300 feet in width on each side of the center line of the claim.

This claim is located within the NW Quarter of Section 5, Township 22 North, Range 51 East, Mount Diablo Base and Meridian, unknown Mining District, Eureka County, Nevada. The location monument of this claim is situated with reference to some natural object or permanent monument as follows: Corner no. 1 of this claim is located approximately 14600 feet N 1/2 W of the located SE corner of Section 17 T22N, R51E, MDM

The corners of this claim are marked by 4"x4"x5" posts of native timber with metal tags inscribed with the appropriate corner number as shown on the following sketch and the accompanying claim map.

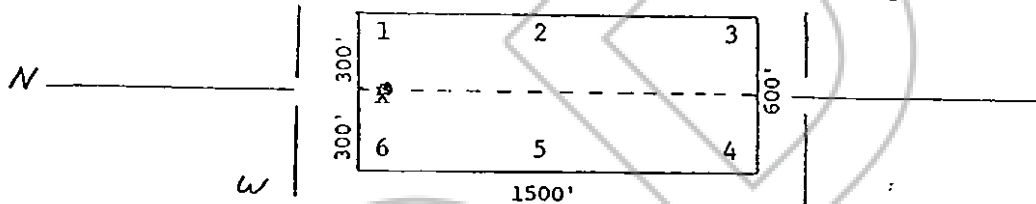

The location work consisted of making the maps as provided in NRS 517.040.

Dated and posted on the ground this 7 day of March, 1980

Witnesses:

Locator:

LYLE F. CAMPBELL
 P.O. Box 7377
 Reno, Nevada 89510

STATE OF NEVADA

COUNTY OF _____

ss.

I hereby certify that the within instrument was filed and recorded at the request of:

FILE NO. _____
 on _____
 at _____ M.,
 Docket _____ Page _____

Witness my hand and official seal the day and year aforesaid.

County Recorder

By _____
 Deputy Recorder

DPK/jlm 2/1/79 (3)

BOOK 81 PAGE 372

RECORDED AT REQUEST OF
 American Sales Inc.
 BOOK 81 PAGE 372

60 MAY 30 A10:33
 73760
 300

STATE OF NEVADA
 CERTIFICATE OF MINING LOCATION
 LODE CLAIM ON PUBLIC DOMAIN

NOTICE IS HEREBY GIVEN that the Sam No. 7 lode mining claim has been located by Lyle F. Campbell. This claim is a relocation of the Samarkand No. 7 lode mining claim, the certificate of location of which is of record in the office of the recorder of Eureka County, Nevada in Book 22 page 392, in accordance with NRS 517.080. The general course of this claim is North/South. This claim is 1500 feet in length along the course of the claim, being 1490 feet from the point of discovery in a North direction to the North end line of this claim, and 10 feet in a South direction to the South end line of the claim. This claim is 600 feet in width, being 300 feet in width on each side of the center line of the claim.

This claim is located within the NW Quarter of Section 5, Township 22 North, Range 51 East, Mount Diablo Base and Meridian, unknown Mining District, Eureka County, Nevada. The location monument of this claim is situated with reference to some natural object or permanent monument as follows: Corner no. 1 of this claim is located approximately 14600 feet N 12° W of the located SE corner of Section 17 T22N, R51E, MDM

The corners of this claim are marked by 4"x4"x5" posts of 4" native timber with metal tags inscribed with the appropriate corner number as shown on the following sketch and the accompanying claim map.

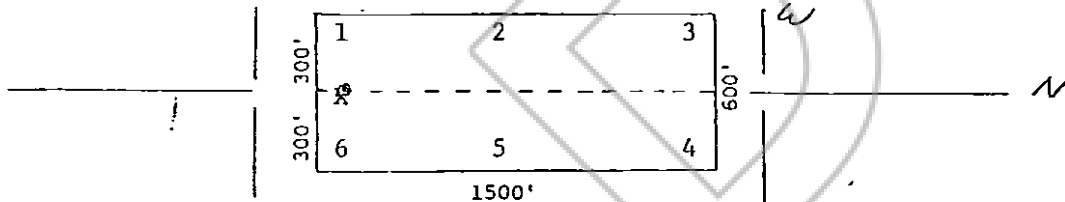

The location work consisted of making the maps as provided in NRS 517.040.

Dated and posted on the ground this 7 day of March, 1980

Witnesses:

Locator:

LYLE F. CAMPBELL
 P.O. Box 7377
 Reno, Nevada 89510

[Signature of Lyle F. Campbell]

STATE OF NEVADA

COUNTY OF _____

ss.

I hereby certify that the within instrument was filed and recorded at the request of: _____

FILE NO. _____

on _____

at _____ M.,

Docket _____

Page _____

Witness my hand and official seal the day and year aforesaid.

County Recorder

By _____

Deputy Recorder

DPK/jlm 2/1/79 (3)

RECORDED AT REQUEST OF
 American Sales, Inc.
 81-10-373

60 MAR 30 AIO:33

STATE OF NEVADA
 CERTIFICATE OF MINING LOCATION
 LODE CLAIM ON PUBLIC DOMAIN

NOTICE IS HEREBY GIVEN that the Sam No. 8 lode mining claim has been located by Lyle F. Campbell. This claim is a relocation of the Samarkand No. 8 lode mining claim, the certificate of location of which is of record in the office of the recorder of Eureka County, Nevada in Book 22 page 393, in accordance with NRS 517.080. The general course of this claim is North/ South. This claim is 1500 feet in length along the course of the claim, being 10 feet from the point of discovery in a North direction to the North end line of this claim, and 1490 feet in a South direction to the South end line of the claim. This claim is 600 feet in width, being 300 feet in width on each side of the center line of the claim.

This claim is located within the NW Quarter of Section 5, Township 22 North, Range 51 East, Mount Diablo Base and Meridian, unknown Mining District, Eureka County, Nevada. The location monument of this claim is situated with reference to some natural object or permanent monument as follows: Corner no. 1 of this claim is located approximately 14600 feet N 1/2 W of the located SE corner of Section 17 T22N, R51E, MDM

The corners of this claim are marked by 4"x4"x5" posts of 4" native timber with metal tags inscribed with the appropriate corner number as shown on the following sketch and the accompanying claim map.

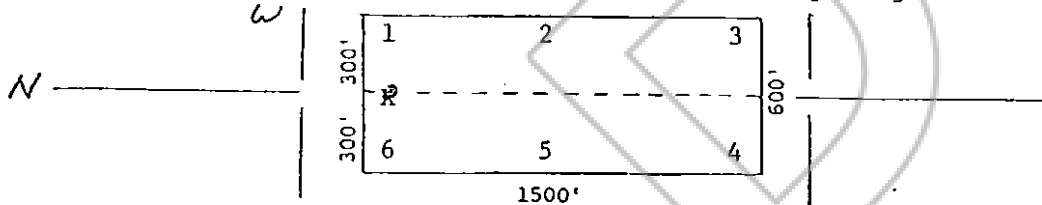

The location work consisted of making the maps as provided in NRS 517.040.

Dated and posted on the ground this 7 day of March, 1980

Witnesses:

Locator:

LYLE F. CAMPBELL
 P.O. Box 7377
 Reno, Nevada 89510

STATE OF NEVADA

COUNTY OF _____

ss.

I hereby certify that the within instrument was filed and recorded at the request of: _____

FILE NO. _____
 on _____
 at _____ M.,
 Docket _____ Page _____

Witness my hand and official seal the day and year aforesaid.

County Recorder
 By _____ Deputy Recorder

DPK/jlm 2/1/79 (3)

NOTICE IS HEREBY GIVEN that the Sam No. 9 lode mining claim has been located by Lyle F. Campbell. This claim is a relocation of the Samarkand No. 9 lode mining claim, the certificate of location of which is of record in the office of the recorder of Eureka County, Nevada in Book 22 page 394, in accordance with NRS 517.080. The general course of this claim is North/ South. This claim is 1500 feet in length along the course of the claim, being 1490 feet from the point of discovery in a North direction to the North end line of this claim, and 10 feet in a South direction to the South end line of the claim. This claim is 600 feet in width, being 300 feet in width on each side of the center line of the claim.

This claim is located within the N/E Quarter of Section 5, Township 22 North, Range 51 East, Mount Diablo Base and Meridian, unknown Mining District, Eureka County, Nevada. The location monument of this claim is situated with reference to some natural object or permanent monument as follows: Corner no. 1 of this claim is located approximately 14500 feet N & W of the located SE corner of Section 17 T22N, R51E, MDM

The corners of this claim are marked by 4"x4"x5" posts of 4" native timber with metal tags inscribed with the appropriate corner number as shown on the following sketch and the accompanying claim map.

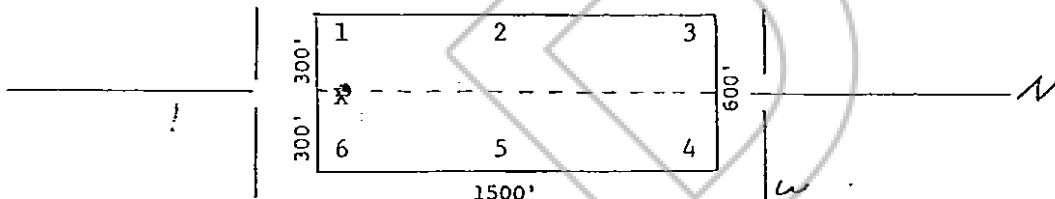

The location work consisted of making the maps as provided in NRS 517.040.

Dated and posted on the ground this 7 day of March, 1980

Witnesses:

Locator:

LYLE F. CAMPBELL
P.O. Box 7377
Reno, Nevada 89510

STATE OF NEVADA)

) ss.

COUNTY OF _____)

I hereby certify that the within instrument was filed and recorded at the request of: _____

FILE NO. _____

on _____

at _____ M.,

Docket _____ Page _____

Witness my hand and official seal the day and year aforesaid.

County Recorder

By _____
Deputy Recorder

DPK/jlm 2/1/79 (3)

BOOK 81 PAGE 375

RECORDED AT REQUEST OF
Angela 82-56169-195
BOOK 81 PAGE 375

80 MAY 30 10:33
EUREKA COUNTY, NEVADA
FILED
73763
300

STATE OF NEVADA
 CERTIFICATE OF MINING LOCATION
 LOSE CLAIM ON PUBLIC DOMAIN

NOTICE IS HEREBY GIVEN that the Sam No. 10 lode mining claim has been located by Lyle F. Campbell. This claim is a relocation of the Samarkand No. 10 lode mining claim, the certificate of location of which is of record in the office of the recorder of Eureka County, Nevada in Book 22 page 395, in accordance with NRS 517.080. The general course of this claim is North/South. This claim is 1500 feet in length along the course of the claim, being 10 feet from the point of discovery in a North direction to the North end line of this claim, and 1490 feet in a South direction to the South end line of the claim. This claim is 600 feet in width, being 300 feet in width on each side of the center line of the claim.

This claim is located within the N/E Quarter of Section 5, Township 22 North, Range 51 East, Mount Diablo Base and Meridian, unknown Mining District, Eureka County, Nevada. The location monument of this claim is situated with reference to some natural object or permanent monument as follows: Corner no. 1 of this claim is located approximately 1450 feet N 8 W of the located SE corner of Section 17 T22N, R51E, MDM

The corners of this claim are marked by 4"x4"x5' posts of 4" native timber with metal tags inscribed with the appropriate corner number as shown on the following sketch and the accompanying claim map.

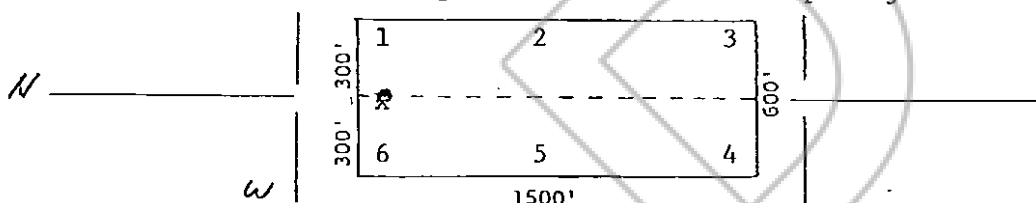

The location work consisted of making the maps as provided in NRS 517.040.

Dated and posted on the ground this 7 day of March, 1980

Witnesses:

Locator:

LYLE F. CAMPBELL
 P.O. Box 7377
 Reno, Nevada 89510

STATE OF NEVADA

COUNTY OF _____

) ss.

I hereby certify that the within instrument was filed and recorded at the request of: _____

FILE NO. _____

on _____

at _____

Docket _____

Page _____

Witness my hand and official seal the day and year aforesaid.

County Recorder

By _____

Deputy Recorder

DPK/jlm 2/1/79 (3)

BOOK 81 PAGE 376

RECORDED AT REQUEST OF
 American Seals, Inc.
 8800 N. 81st Street
 876

80 MAY 30 10:33

WILLIAM A. CAMPBELL
 COUNTY RECORDER
 EUREKA, NEVADA
 73764

STATE OF NEVADA
 CERTIFICATE OF MINING LOCATION
 LODE CLAIM ON PUBLIC DOMAIN

NOTICE IS HEREBY GIVEN that the Sam No. // lode mining claim has been located by Lyle F. Campbell. This claim is a relocation of the Samarkand No. // lode mining claim, the certificate of location of which is of record in the office of the recorder of Eureka County, Nevada in Book 22 page 396, in accordance with NRS 517.080. The general course of this claim is North/ South. This claim is 1500 feet in length along the course of the claim, being 1490 feet from the point of discovery in a North direction to the North end line of this claim, and 10 feet in a South direction to the South end line of the claim. This claim is 600 feet in width, being 300 feet in width on each side of the center line of the claim.

This claim is located within the N1E Quarter of Section 5, Township 22 North, Range 51 East, Mount Diablo Base and Meridian, unknown Mining District, Eureka County, Nevada. The location monument of this claim is situated with reference to some natural object or permanent monument as follows: Corner no. 1 of this claim is located approximately 1450 feet N 8 W of the located SE corner of Section 17 T22N, R51E, MDM

The corners of this claim are marked by 4"x4"x5" posts of 4" native timber with metal tags inscribed with the appropriate corner number as shown on the following sketch and the accompanying claim map.

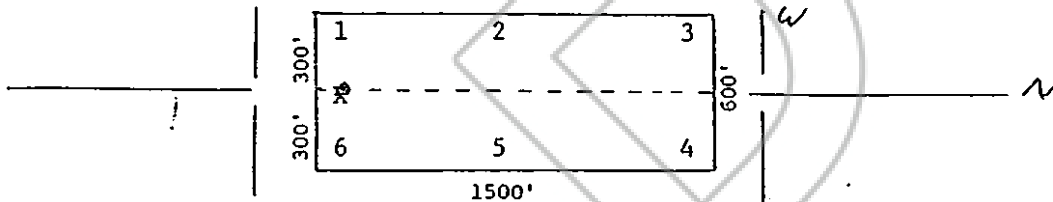

The location work consisted of making the maps as provided in NRS 517.040.

Dated and posted on the ground this 7 day of March, 1980

Witnesses:

Locator:

LYLE F. CAMPBELL
 P.O. Box 7377
 Reno, Nevada 89510

STATE OF NEVADA

COUNTY OF _____

I hereby certify that the within instrument was filed and recorded at the request of: _____
 FILE NO. _____
 on _____
 at _____ M.,
 Docket _____ Page _____

Witness my hand and official seal the day and year aforesaid.

County Recorder

By _____
 Deputy Recorder

DPK/jlm 2/1/79 (3)

RECORDED AT REQUEST OF
 American Sales Inc.
 Book 81 Page 377
 MAY 30 10:33
 EUREKA COUNTY
 WILLIS A. LYNCH
 REC. 3.00
 73765

NOTICE IS HEREBY GIVEN that the Sam No. 12 lode mining claim has been located by Lyle F. Campbell. This claim is a relocation of the Samarkand No. 12 lode mining claim, the certificate of location of which is of record in the office of the recorder of Eureka County, Nevada in Book 22 page 397, in accordance with NRS 517.080. The general course of this claim is North/South. This claim is 1500 feet in length along the course of the claim, being 10 feet from the point of discovery in a North direction to the North end line of this claim, and 1490 feet in a South direction to the South end line of the claim. This claim is 600 feet in width, being 300 feet in width on each side of the center line of the claim.

This claim is located within the NE Quarter of Section 5, Township 22 North, Range 51 East, Mount Diablo Base and Meridian, unknown Mining District, Eureka County, Nevada. The location monument of this claim is situated with reference to some natural object or permanent monument as follows: Corner no. 1 of this claim is located approximately 14500 feet N & W of the located SE corner of Section 17 T22N, R51E, MDM

The corners of this claim are marked by 4"x4"x5" posts of native timber with metal tags inscribed with the appropriate corner number as shown on the following sketch and the accompanying claim map.

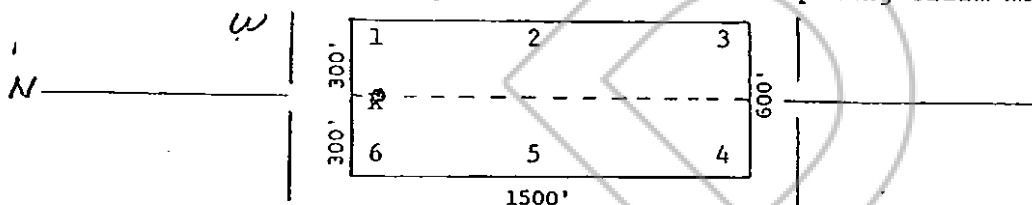

The location work consisted of making the maps as provided in NRS 517.040.

Dated and posted on the ground this 7 day of March, 1980

Witnesses:

Locator:

LYLE F. CAMPBELL
P.O. Box 7377
Reno, Nevada 89510

STATE OF NEVADA

COUNTY OF _____

) ss.

I hereby certify that the within instrument was filed and recorded at the request of: _____

FILE NO. _____

on _____

at _____

Docket _____

Page _____

M.,

Witness my hand and official seal the day and year aforesaid.

County Recorder

By _____

Deputy Recorder

RECORDED AT REQUEST OF
American Sales, Inc.
BOOK 81 PAGE 378
60 MAY 30 AID: 83
FILE NO. 73766
FEE \$ 3.00

DPK/jlm 2/1/79 (3)

BOOK 81 PAGE 378

STATE OF NEVADA
 CERTIFICATE OF MINING LOCATION
 LOSE CLAIM ON PUBLIC DOMAIN

NOTICE IS HEREBY GIVEN that the Sam No. 13 lode mining claim has been located by Lyle F. Campbell. This claim is a relocation of the Samarkand No. 13 lode mining claim, the certificate of location of which is of record in the office of the recorder of Eureka County, Nevada in Book 22 page 398, in accordance with NRS 517.080. The general course of this claim is North/ South. This claim is 1500 feet in length along the course of the claim, being 1490 feet from the point of discovery in a North direction to the North end line of this claim, and 10 feet in a South direction to the South end line of the claim. This claim is 600 feet in width, being 300 feet in width on each side of the center line of the claim.

This claim is located within the NE Quarter of Section 5, Township 22 North, Range 51 East, Mount Diablo Base and Meridian, unknown Mining District, Eureka County, Nevada. The location monument of this claim is situated with reference to some natural object or permanent monument as follows: Corner no. 1 of this claim is located approximately 19400 feet N 2 W of the located SE corner of Section 17 T22N, R51E, MDM

The corners of this claim are marked by 4"x4"x5" posts of with metal tags inscribed with the appropriate corner number as shown on the following sketch and the accompanying claim map.

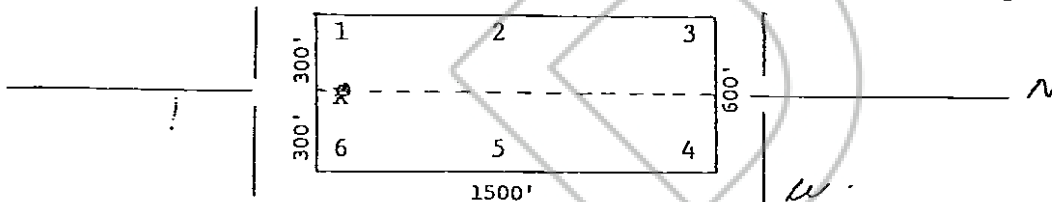

The location work consisted of making the maps as provided in NRS 517.040.

Dated and posted on the ground this 7 day of March, 1980

Witnesses:

Locator:

LYLE F. CAMPBELL
 P.O. Box 7377-
 Reno, Nevada 89510

STATE OF NEVADA

COUNTY OF _____

) ss.

I hereby certify that the within instrument was filed and recorded at the request of:

FILE NO. _____
 on _____
 at _____ M.,
 Docket _____ Page _____

Witness my hand and official seal the day and year aforesaid.

County Recorder

By _____
 Deputy Recorder

DPK/jlm 2/1/79 (3)

RECEIVED
 CLERK'S OFFICE
 FILE NO. 73767
 FILED 3.00

MAY 30 10:34

RECEIVED AT REQUEST OF
 American Sales Inc.
 BOOK 81 PAGE 379

NOTICE IS HEREBY GIVEN that the Sam No. 14 lode mining claim has been located by Lyle F. Campbell. This claim is a relocation of the Samarkand No. 14 lode mining claim, the certificate of location of which is of record in the office of the recorder of Eureka County, Nevada in Book 22 page 399, in accordance with NRS 517.080. The general course of this claim is North/ South. This claim is 1500 feet in length along the course of the claim, being 10 feet from the point of discovery in a North direction to the North end line of this claim, and 1490 feet in a South direction to the South end line of the claim. This claim is 600 feet in width, being 300 feet in width on each side of the center line of the claim.

This claim is located within the NE Quarter of Section 5, Township 22 North, Range 51 East, Mount Diablo Base and Meridian, unknown Mining District, Eureka County, Nevada. The location monument of this claim is situated with reference to some natural object or permanent monument as follows: Corner no. 1 of this claim is located approximately 1440 feet N 2° W of the located SE corner of Section 17 T22N, R51E, MDM

The corners of this claim are marked by 4"x4"x5' posts of 4" native timber with metal tags inscribed with the appropriate corner number as shown on the following sketch and the accompanying claim map.

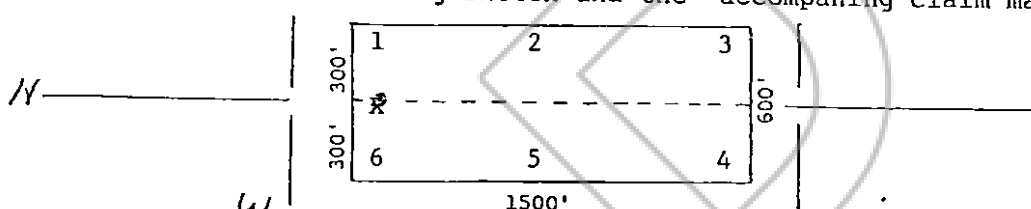

The location work consisted of making the maps as provided in NRS 517.040.

Dated and posted on the ground this 7 day of March, 1980

Witnesses:

Locator:

LYLE F. CAMPBELL
P.O. Box 7377
Reno, Nevada 89510

STATE OF NEVADA

COUNTY OF _____

ss.

I hereby certify that the within instrument was filed and recorded at the request of:

FILE NO. _____
on _____
at _____ M.,
Docket _____ Page _____

Witness my hand and official seal the day and year aforesaid.

County Recorder

By _____
Deputy Recorder

DPK/jlm 2/1/79 (3)

RECORDED AT REQUEST OF
American Sales Inc.
BOOK 81 PAGE 380
80 MAY 30 AIO: 34
OFFICE OF THE COUNTY CLERK
EUREKA COUNTY, NEVADA
FILE NO. 73768
FEE \$3.00

BOOK 81 PAGE 380

STATE OF NEVADA
 CERTIFICATE OF MINING LOCATION
 LODE CLAIM ON PUBLIC DOMAIN

NOTICE IS HEREBY GIVEN that the Sam No. 15 lode mining claim has been located by Lyle F. Campbell. This claim is a relocation of the Samarkand No. 15 lode mining claim, the certificate of location of which is of record in the office of the recorder of Eureka County, Nevada in Book 22 page 400, in accordance with NRS 517.080. The general course of this claim is North/ South. This claim is 1500 feet in length along the course of the claim, being 490 feet from the point of discovery in a North direction to the North end line of this claim, and 10 feet in a South direction to the South end line of the claim. This claim is 600 feet in width, being 300 feet in width on each side of the center line of the claim.

This claim is located within the NE Quarter of Section 5, Township 22 North, Range 51 East, Mount Diablo Base and Meridian, unknown Mining District, Eureka County, Nevada. The location monument of this claim is situated with reference to some natural object or permanent monument as follows: Corner no. 1 of this claim is located approximately 1400 feet N 2 W of the located SE corner of Section 17 T22N, R51E, MDM

The corners of this claim are marked by 4"x4"x5' posts of 4" native timber with metal tags inscribed with the appropriate corner number as shown on the following sketch and the accompanying claim map.

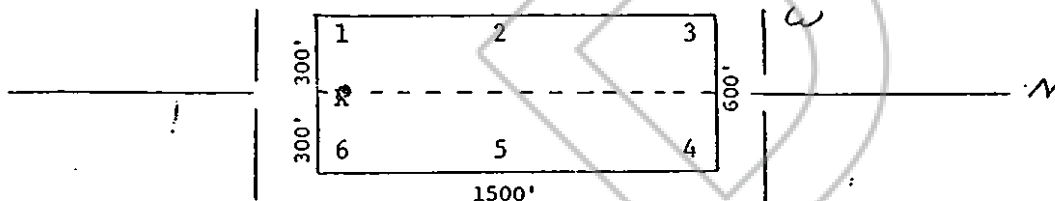

The location work consisted of making the maps as provided in NRS 517.040.

Dated and posted on the ground this 7 day of March, 1980

Witnesses:

Locator:

LYLE F. CAMPBELL
 P.O. Box 7377
 Reno, Nevada 89510

STATE OF NEVADA

COUNTY OF _____

ss.

I hereby certify that the within instrument was filed and recorded at the request of: _____

FILE NO. _____

on _____

at _____

Docket _____

Page _____

M.,

Witness my hand and official seal the day and year aforesaid.

County Recorder

By _____
 Deputy Recorder

DPK/jlm 2/1/79 (3)

RECORDED AT REQUEST OF
 American Sales, Inc.
 BOOK 81 PAGE 381
 MAY 30 10:34
 DEPUTY COUNTY CLERK
 EUREKA COUNTY, NEVADA
 FILED
 73769
 10:53 AM

BOOK 81 PAGE 381

STATE OF NEVADA
 CERTIFICATE OF MINING LOCATION
 LODE CLAIM ON PUBLIC DOMAIN

NOTICE IS HEREBY GIVEN that the Sam No. 16 lode mining claim has been located by Lyle F. Campbell. This claim is a relocation of the Samarkand No. 16 lode mining claim, the certificate of location of which is of record in the office of the recorder of Eureka County, Nevada in Book 22 page 401, in accordance with NRS 517.080. The general course of this claim is North/South. This claim is 1500 feet in length along the course of the claim, being 10 feet from the point of discovery in a North direction to the North end line of this claim, and 1490 feet in a South direction to the South end line of the claim. This claim is 600 feet in width, being 300 feet in width on each side of the center line of the claim.

This claim is located within the N/E Quarter of Section 5, Township 22 North, Range 51 East, Mount Diablo Base and Meridian, unknown Mining District, Eureka County, Nevada. The location monument of this claim is situated with reference to some natural object or permanent monument as follows: Corner no. 1 of this claim is located approximately 1400 feet N 2° W of the located SE corner of Section 17 T22N, R51E, MDM

The corners of this claim are marked by 4"x4"x5" posts of 4" native timber with metal tags inscribed with the appropriate corner number as shown on the following sketch and the accompanying claim map.

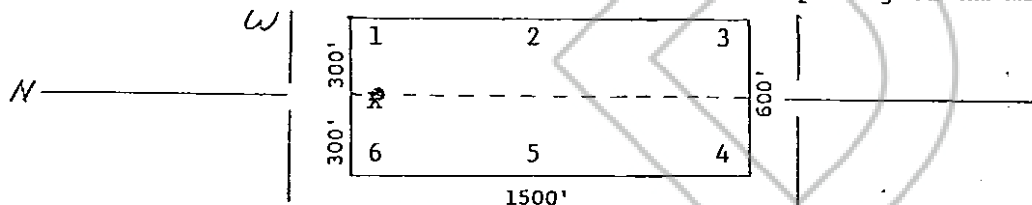

The location work consisted of making the maps as provided in NRS 517.040.

Dated and posted on the ground this 7 day of March, 1980

Witnesses:

Locator:

LYLE F. CAMPBELL
 P.O. Box 7377
 Reno, Nevada 89510

STATE OF NEVADA)

COUNTY OF _____) ss.

I hereby certify that the within instrument was filed and recorded at the request of: _____

FILE NO. _____

on _____

at _____ M.,

Docket _____

Page _____

Witness my hand and official seal the day and year aforesaid.

County Recorder

By _____

Deputy Recorder

DPK/jlm 2/1/79 (3)

RECORDED AT REQUEST OF
Amesbury, Sola, Inc.
 BOOK 81 PAGE 382

80 MAY 30 10:34

RECEIVED
 EUREKA COUNTY, NEVADA
 FILED IN 73770
 FILE 5

STATE OF NEVADA
CERTIFICATE OF MINING LOCATION
LODE CLAIM ON PUBLIC DOMAIN

NOTICE IS HEREBY GIVEN that the Sam No. 17 lode mining claim has been located by Lyle F. Campbell. This claim is a relocation of the Samarkand No. 17 lode mining claim, the certificate of location of which is of record in the office of the recorder of Eureka County, Nevada in Book 22, page 402, in accordance with NRS 517.080. The general course of this claim is North/South. This claim is 1500 feet in length along the course of the claim, being 1490 feet from the point of discovery in a North direction to the North end line of this claim, and 10 feet in a South direction to the South end line of the claim. This claim is 600 feet in width, being 300 feet in width on each side of the center line of the claim.

This claim is located within the 56 Quarter of Section 5, Township 22 North, Range 51 East, Mount Diablo Base and Meridian, unknown Mining District, Eureka County, Nevada. The location monument of this claim is situated with reference to some natural object or permanent monument as follows: Corner no. 1 of this claim is located approximately 12100 feet N 20° W of the located SE corner of Section 17 T22N, R51E, MDM

The corners of this claim are marked by 4"x4"x5' posts of native timber with metal tags inscribed with the appropriate corner number as shown on the following sketch and the accompanying claim map.

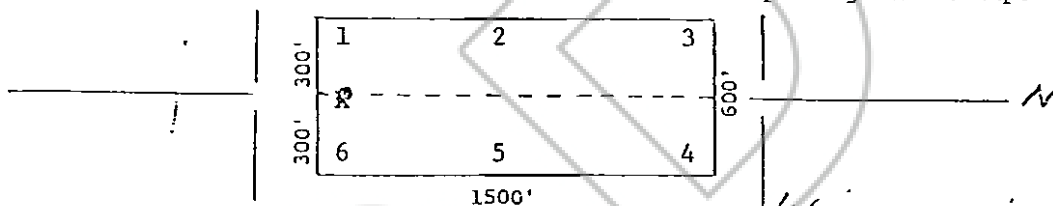

The location work consisted of making the maps as provided in NRS 517.040.

Dated and posted on the ground this 7 day of March, 1980

Witnesses:

Locator:

LYLE F. CAMPBELL
P.O. Box 7377
Reno, Nevada 89510

STATE OF NEVADA

COUNTY OF _____

) ss.

I hereby certify that the within instrument was filed and recorded at the request of: _____

FILE NO. _____

on _____

at _____ M.,

Docket _____

Page _____

Witness my hand and official seal the day and year aforesaid.

County Recorder

By _____ Deputy Recorder

RECORDED AT REQUEST OF
American Sales, Inc.
BOOK 81 PAGE 383
MAY 30 10:34
73771
3.00

DPK/jlm 2/1/79 (3)

STATE OF NEVADA
 CERTIFICATE OF MINING LOCATION
 LOSE CLAIM ON PUBLIC DOMAIN

NOTICE IS HEREBY GIVEN that the Sam No. 18 lode mining claim has been located by Lyle F. Campbell. This claim is a relocation of the Samarkand No. 18 lode mining claim, the certificate of location of which is of record in the office of the recorder of Eureka County, Nevada in Book 22 page 403, in accordance with NRS 517.080. The general course of this claim is North/South. This claim is 1500 feet in length along the course of the claim, being 10 feet from the point of discovery in a North direction to the North end line of this claim, and 1490 feet in a South direction to the South end line of the claim. This claim is 600 feet in width, being 300 feet in width on each side of the center line of the claim.

This claim is located within the SW Quarter of Section 5, Township 22 North, Range 51 East, Mount Diablo Base and Meridian, unknown Mining District, Eureka County, Nevada. The location monument of this claim is situated with reference to some natural object or permanent monument as follows: Corner no. 1 of this claim is located approximately 12100 feet N 20° W of the located SE corner of Section 17 T22N, R51E, MDM

The corners of this claim are marked by 4"x4"x5' posts of with metal tags inscribed with the appropriate corner number as shown on the following sketch and the accompanying claim map.

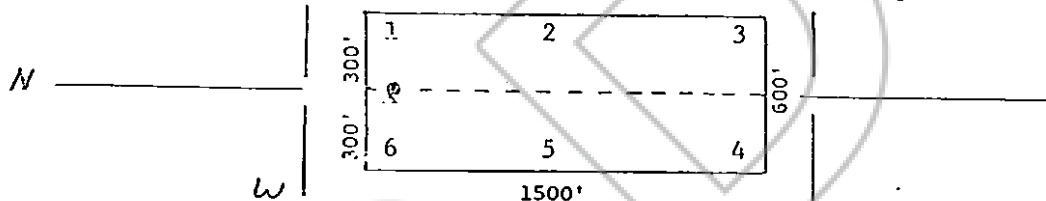

The location work consisted of making the maps as provided in NRS 517.040.

Dated and posted on the ground this 7 day of March, 1980

Witnesses:

Locator:

LYLE F. CAMPBELL
 P.O. Box 7377
 Reno, Nevada 89510

STATE OF NEVADA)

COUNTY OF _____) ss.

I hereby certify that the within instrument was filed and recorded at the request of: _____

FILE NO. _____

on _____

at _____

Docket _____

Page _____

Witness my hand and official seal the day and year aforesaid.

County Recorder

By _____ Deputy Recorder

DPK/jlm 2/1/79 (3)

RECORDED AT REQUEST OF
 American Sales, Inc.
 BOOK 81 PAGE 384
 60 MAY 30 AID: 34
 OFFICE OF THE COUNTY CLERK
 EUREKA COUNTY, NEVADA
 FILED FOR RECORD
 MAY 3 1980

BOOK 81 PAGE 384

STATE OF NEVADA
CERTIFICATE OF MINING LOCATION
LODE CLAIM ON PUBLIC DOMAIN

73773

NOTICE IS HEREBY GIVEN that the Sam No. 19 lode mining claim has been located by Lyle F. Campbell. This claim is a relocation of the Samarkand No. 19 lode mining claim, the certificate of location of which is of record in the office of the recorder of Eureka County, Nevada in Book 22 page 404, in accordance with NRS 517.080. The general course of this claim is North/ South. This claim is 1500 feet in length along the course of the claim, being 1490 feet from the point of discovery in a North direction to the North end line of this claim, and 10 feet in a South direction to the South end line of the claim. This claim is 600 feet in width, being 300 feet in width on each side of the center line of the claim.

This claim is located within the SW Quarter of Section 5, Township 22 North, Range 51 East, Mount Diablo Base and Meridian, unknown Mining District, Eureka County, Nevada. The location monument of this claim is situated with reference to some natural object or permanent monument as follows: Corner no. 1 of this claim is located approximately 12100 feet N 20° W of the located SE corner of Section 17 T22N, R51E, MDM

The corners of this claim are marked by 4"x4"x5" posts of native timber with metal tags inscribed with the appropriate corner number as shown on the following sketch and the accompanying claim map.

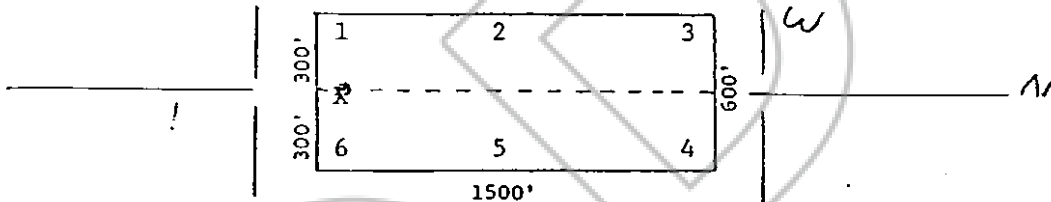

The location work consisted of making the maps as provided in NRS 517.040.

Dated and posted on the ground this 7 day of March, 1980

Witnesses:

Locator:

LYLE F. CAMPBELL
P.O. Box 7377
Reno, Nevada 89510

STATE OF NEVADA

COUNTY OF _____

) ss.

I hereby certify that the within instrument was filed and recorded at the request of: _____

FILE NO. _____

on _____

at _____

Docket _____

Page _____

Witness my hand and official seal the day and year aforesaid.

County Recorder

By _____ Deputy Recorder

RECORDED
EUREKA COUNTY, NEVADA
FILED
73773
FEB 28 1980

80 MAY 30 AIO: 94

RECORDED AT REQUEST OF
American Balco, Inc.
JUNE 81 11:38 AM '81

DPK/jlm 2/1/79 (3)

BOOK 81 PAGE 385

STATE OF NEVADA
CERTIFICATE OF MINING LOCATION
LODE CLAIM ON PUBLIC DOMAIN

NOTICE IS HEREBY GIVEN that the Sam No. 20 lode mining claim has been located by Lyle F. Campbell. This claim is a relocation of the Samarkand No. 20 lode mining claim, the certificate of location of which is of record in the office of the recorder of Eureka County, Nevada in Book 22 page 405, in accordance with NRS 517.080. The general course of this claim is North/ South. This claim is 1500 feet in length along the course of the claim, being 10 feet from the point of discovery in a North direction to the North end line of this claim, and 1490 feet in a South direction to the South end line of the claim. This claim is 600 feet in width, being 300 feet in width on each side of the center line of the claim.

This claim is located within the SW Quarter of Section 5, Township 22 North, Range 51 East, Mount Diablo Base and Meridian, unknown Mining District, Eureka County, Nevada. The location monument of this claim is situated with reference to some natural object or permanent monument as follows: Corner no. 1 of this claim is located approximately 12100 feet N 20° W of the located SE corner of Section 17 T22N, R51E, MDM

The corners of this claim are marked by 4"x4"x5" posts of native timber with metal tags inscribed with the appropriate corner number as shown on the following sketch and the accompanying claim map.

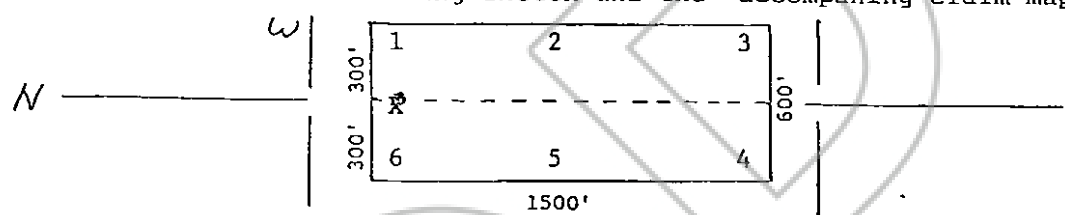

The location work consisted of making the maps as provided in NRS 517.040.

Dated and posted on the ground this 7 day of March, 1980

Witnesses: _____ Locator: _____
LYLE F. CAMPBELL
P.O. Box 7377
Reno, Nevada 89510

STATE OF NEVADA)
COUNTY OF _____) ss.

I hereby certify that the within instrument was filed and recorded at the request of: _____
FILE NO. _____
on _____
at _____ M.,
Docket _____ Page _____

Witness my hand and official seal the day and year aforesaid.

County Recorder _____
By Deputy Recorder _____

DPK/jlm 2/1/79 (3)

RECORDED AT REQUEST OF
American Sales, Inc.
BOOK 81 PAGE 386
80 MAY 30 AIO: 34
FILED
73774
COUNTY RECORDER
DEPUTY RECORDER

STATE OF NEVADA
CERTIFICATE OF MINING LOCATION
LODE CLAIM ON PUBLIC DOMAIN

73775

NOTICE IS HEREBY GIVEN that the Sam No. 21 lode mining claim has been located by Lyle F. Campbell. This claim is a relocation of the Samarkand No. 21 lode mining claim, the certificate of location of which is of record in the office of the recorder of Eureka County, Nevada in Book 22 page 400, in accordance with NRS 517.080. The general course of this claim is North/ South. This claim is 1500 feet in length along the course of the claim, being 1490 feet from the point of discovery in a North direction to the North end line of this claim, and 10 feet in a South direction to the South end line of the claim. This claim is 600 feet in width, being 300 feet in width on each side of the center line of the claim.

This claim is located within the SW Quarter of Section 5, Township 22 North, Range 51 East, Mount Diablo Base and Meridian, unknown Mining District, Eureka County, Nevada. The location monument of this claim is situated with reference to some natural object or permanent monument as follows: Corner no. 1 of this claim is located approximately 11800 feet N 15 W of the located SE corner of Section 17 T22N, R51E, MDM

The corners of this claim are marked by 4"x4"x5" posts of native timber with metal tags inscribed with the appropriate corner number as shown on the following sketch and the accompanying claim map.

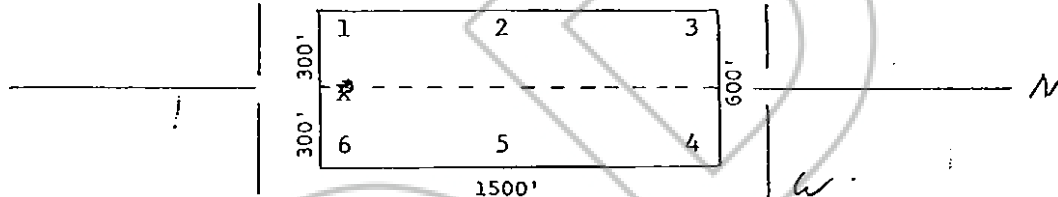

The location work consisted of making the maps as provided in NRS 517.040.

Dated and posted on the ground this 7 day of March, 1980

Witnesses:

Locator:

LYLE F. CAMPBELL
P.O. Box 7377
Reno, Nevada 89510

STATE OF NEVADA)

COUNTY OF _____)

I hereby certify that the within instrument was filed and recorded at the request of: _____

FILE NO. _____

on _____

at _____

Docket _____

Page _____

M.,

Witness my hand and official seal the day and year aforesaid.

County Recorder

By _____

Deputy Recorder

DPK/jlm 2/1/79 (3)

RECORDED AT REQUEST OF
American Sales, Inc.
BOOK 81 PAGE 387
MAY 30 10:34
FILE NO. 73775
FEE \$ 3.00

BOOK 81 PAGE 387

NOTICE IS HEREBY GIVEN that the Sam No. 22 lode mining claim has been located by Lyle F. Campbell. This claim is a relocation of the Samarkand No. 22 lode mining claim, the certificate of location of which is of record in the office of the recorder of Eureka County, Nevada in Book 22 page 407, in accordance with NRS 517.080. The general course of this claim is North/ South. This claim is 1500 feet in length along the course of the claim, being 10 feet from the point of discovery in a North direction to the North end line of this claim, and 1490 feet in a South direction to the South end line of the claim. This claim is 600 feet in width, being 300 feet in width on each side of the center line of the claim.

This claim is located within the SW Quarter of Section 5, Township 22 North, Range 51 East, Mount Diablo Base and Meridian, unknown Mining District, Eureka County, Nevada. The location monument of this claim is situated with reference to some natural object or permanent monument as follows: Corner no. 1 of this claim is located approximately 11800 feet N 15° W of the located SE corner of Section 17 T22N, R51E, MDM

The corners of this claim are marked by 4"x4"x5' posts of with metal tags inscribed with the appropriate corner number as shown on the following sketch and the accompanying claim map.

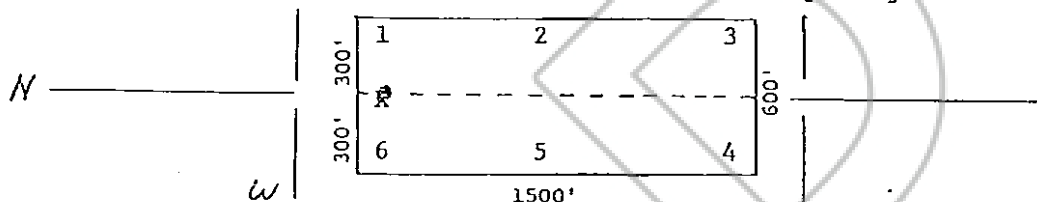

The location work consisted of making the maps as provided in NRS 517.040.

Dated and posted on the ground this 7 day of March, 1980

Witnesses:

Locator:

LYLE F. CAMPBELL
P.O. Box 7377
Reno, Nevada 89510

STATE OF NEVADA)

) ss.

COUNTY OF _____)

I hereby certify that the within instrument was filed and recorded at the request of: _____

FILE NO. _____

on _____

at _____

Docket _____

Page _____

M.,

Witness my hand and official seal the day and year aforesaid.

County Recorder

By _____
Deputy Recorder

DPK/jlm 2/1/79 (3)

BOOK 81 PAGE 388

80 MAY 30 AIO: 34

RECORDED AT REQUEST OF
American Sales, Inc.
BOOK 81 PAGE 388

OFFICE OF THE COUNTY RECORDER
EUREKA COUNTY, NEVADA
FILED 73776
MAY 31 1980

NOTICE IS HEREBY GIVEN that the Sam No. 23 lode mining claim has been located by Lyle F. Campbell. This claim is a relocation of the Samarkand No. 23 lode mining claim, the certificate of location of which is of record in the office of the recorder of Eureka County, Nevada in Book 22 page 408, in accordance with NRS 517.080. The general course of this claim is North/ South. This claim is 1500 feet in length along the course of the claim, being 1490 feet from the point of discovery in a North direction to the North end line of this claim, and 10 feet in a South direction to the South end line of the claim. This claim is 600 feet in width, being 300 feet in width on each side of the center line of the claim.

This claim is located within the SW Quarter of Section 5, Township 22 North, Range 51 East, Mount Diablo Base and Meridian, unknown Mining District, Eureka County, Nevada. The location monument of this claim is situated with reference to some natural object or permanent monument as follows: Corner no. 1 of this claim is located approximately 11800 feet N 15° W of the located SE corner of Section 17 T22N, R51E, MDM

The corners of this claim are marked by 4"x4"x5" posts of native timber with metal tags inscribed with the appropriate corner number as shown on the following sketch and the accompanying claim map.

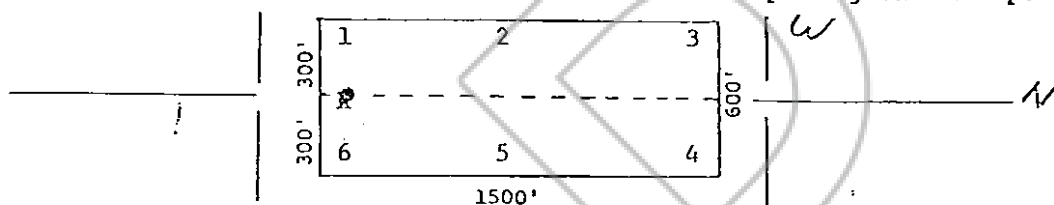

The location work consisted of making the maps as provided in NRS 517.040.

Dated and posted on the ground this 7 day of March, 1980

Witnesses:

Locator:

LYLE F. CAMPBELL
P.O. Box 7377
Reno, Nevada 89510

STATE OF NEVADA)

) ss.

COUNTY OF _____)

I hereby certify that the within instrument was filed and recorded at the request of: _____

FILE NO. _____

on _____

at _____

Docket _____

Page _____

Witness my hand and official seal the day and year aforesaid.

County Recorder

By _____
Deputy Recorder

DPK/jlm 2/1/79 (3)

ORIGINAL FILED IN
EUREKA COUNTY
FILE NO. 73777
FEE \$ 3.00

80 MAY 30 10:34

RECORDED AT REQUEST OF
American Sales Inc.
BOOK 81 PAGE 389

STATE OF NEVADA
 CERTIFICATE OF MINING LOCATION
 LODE CLAIM ON PUBLIC DOMAIN

NOTICE IS HEREBY GIVEN that the Sam No. 24 lode mining claim has been located by Lyle F. Campbell. This claim is a relocation of the Samarkand No. 24 lode mining claim, the certificate of location of which is of record in the office of the recorder of Eureka County, Nevada in Book 22 page 409, in accordance with NRS 517.080. The general course of this claim is North/South. This claim is 1500 feet in length along the course of the claim, being 10 feet from the point of discovery in a North direction to the North end line of this claim, and 1490 feet in a South direction to the South end line of the claim. This claim is 600 feet in width, being 300 feet in width on each side of the center line of the claim.

This claim is located within the 500 Quarter of Section 5, Township 22 North, Range 51 East, Mount Diablo Base and Meridian, unknown Mining District, Eureka County, Nevada. The location monument of this claim is situated with reference to some natural object or permanent monument as follows: Corner no. 1 of this claim is located approximately 11800 feet N 15 W of the located SE corner of Section 17 T22N, R51E, MDM

The corners of this claim are marked by 4"x4"x5" posts of native timber with metal tags inscribed with the appropriate corner number as shown on the following sketch and the accompanying claim map.

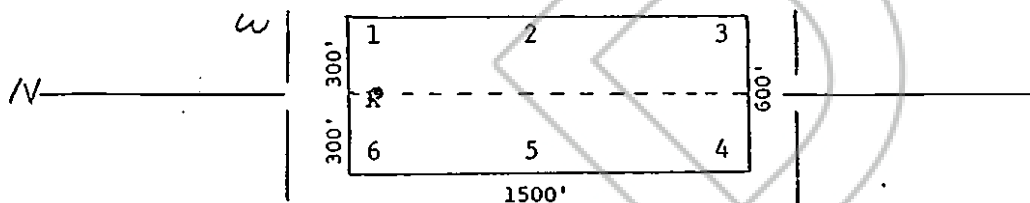

The location work consisted of making the maps as provided in NRS 517.040.

Dated and posted on the ground this 7 day of March, 1980

Witnesses:

Locator:

LYLE F. CAMPBELL
 P.O. Box 7377
 Reno, Nevada 89510

STATE OF NEVADA)

COUNTY OF _____) ss.

I hereby certify that the within instrument was filed and recorded at the request of: _____

FILE NO. _____

on _____

at _____

Docket _____

Page _____

M.,

Witness my hand and official seal the day and year aforesaid.

County Recorder

By _____

Deputy Recorder

DPK/jlm 2/1/79 (3)

BOOK 81 PAGE 390

RECORDED AT REQUEST OF
 Eureka & Sons, Inc.
 1421 - 73778
 FEB 3 1980

80 MAY 30 AIO: 34

STATE OF NEVADA
 CERTIFICATE OF MINING LOCATION
 LOSE CLAIM ON PUBLIC DOMAIN

NOTICE IS HEREBY GIVEN that the Sam No. 25 lode mining claim has been located by Lyle F. Campbell. This claim is a relocation of the Samarkand No. 25 lode mining claim, the certificate of location of which is of record in the office of the recorder of Eureka County, Nevada in Book 22 page 410, in accordance with NRS 517.080. The general course of this claim is North/ South. This claim is 1500 feet in length along the course of the claim, being 1490 feet from the point of discovery in a North direction to the North end line of this claim, and 10 feet in a South direction to the South end line of the claim. This claim is 600 feet in width, being 300 feet in width on each side of the center line of the claim.

This claim is located within the SE Quarter of Section 5, Township 22 North, Range 51 East, Mount Diablo Base and Meridian, unknown Mining District, Eureka County, Nevada. The location monument of this claim is situated with reference to some natural object or permanent monument as follows: Corner no. 1 of this claim is located approximately 11600 feet N 10 W of the located SE corner of Section 17 T22N, R51E, MDM

The corners of this claim are marked by 4"x4"x5" posts of 4" native timber with metal tags inscribed with the appropriate corner number as shown on the following sketch and the accompanying claim map.

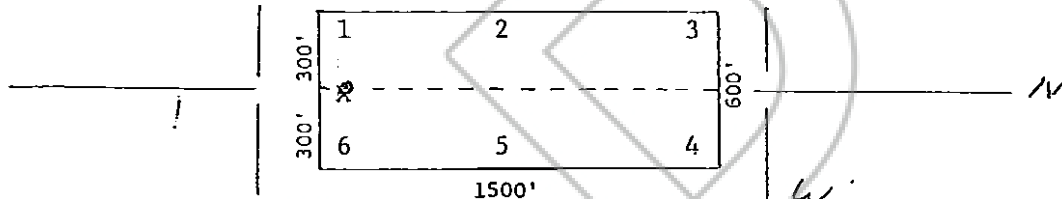

The location work consisted of making the maps as provided in NRS 517.040.

Dated and posted on the ground this 7 day of March, 1980

Witnesses:

Locator:

LYLE F. CAMPBELL
 P.O. Box 7377
 Reno, Nevada 89510

STATE OF NEVADA)

) ss.

COUNTY OF _____)

I hereby certify that the within instrument was filed and recorded at the request of: _____
 FILE NO. _____
 on _____
 at _____ M.,
 Docket _____ Page _____

Witness my hand and official seal the day and year aforesaid.

County Recorder

By _____
 Deputy Recorder

DPK/jlm 2/1/79 (3)

RECORDED AT REQUEST OF
 American S&Co. Inc.
 BOOK 81 PAGE 391
 80 MAY 30 AID: 34
 FILE NO. 73779
 FEE \$ 3.00

STATE OF NEVADA
CERTIFICATE OF MINING LOCATION
LODE CLAIM ON PUBLIC DOMAIN

73780

NOTICE IS HEREBY GIVEN that the Sam No. 26 lode mining claim has been located by Lyle F. Campbell. This claim is a relocation of the Samarkand No. 26 lode mining claim, the certificate of location of which is of record in the office of the recorder of Eureka County, Nevada in Book 22 page 411, in accordance with NRS 517.080. The general course of this claim is North/South. This claim is 1500 feet in length along the course of the claim, being 10 feet from the point of discovery in a North direction to the North end line of this claim, and 1490 feet in a South direction to the South end line of the claim. This claim is 600 feet in width, being 300 feet in width on each side of the center line of the claim.

This claim is located within the SE Quarter of Section 5, Township 22 North, Range 51 East, Mount Diablo Base and Meridian, unknown Mining District, Eureka County, Nevada. The location monument of this claim is situated with reference to some natural object or permanent monument as follows: Corner no. 1 of this claim is located approximately 11600 feet N 10° W of the located SE corner of Section 17 T22N, R51E, MNM

The corners of this claim are marked by 4"x4"x5" posts of with metal tags inscribed with the appropriate corner number as shown on the following sketch and the accompanying claim map.

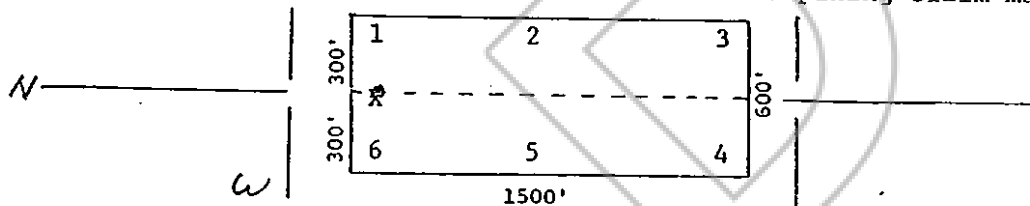

The location work consisted of making the maps as provided in NRS 517.040.

Dated and posted on the ground this 7 day of March, 1980

Witnesses:

Locator:

LYLE F. CAMPBELL
P.O. Box 7377
Reno, Nevada 89510

STATE OF NEVADA)
COUNTY OF _____) ss.

I hereby certify that the within instrument was filed and recorded at the request of: _____
FILE NO. _____
on _____
at _____ M.,
Docket _____ Page _____

Witness my hand and official seal the day and year aforesaid.

County Recorder

By _____
Deputy Recorder

DPK/jlm 2/1/79 (3)

BOOK 81 PAGE 392

RECORDED AT REQUEST OF
American Sales, Inc.
BOOK 81 PAGE 372
80 MAY 30 4:03:35
EUREKA COUNTY, NEVADA
RECORDERS OFFICE
FILE # 73780
FEE \$ 3.00

73781

STATE OF NEVADA
 CERTIFICATE OF MINING LOCATION
 LODE CLAIM ON PUBLIC DOMAIN

NOTICE IS HEREBY GIVEN that the Sam No. 27 lode mining claim has been located by Lyle F. Campbell. This claim is a relocation of the Samarkand No. 27 lode mining claim, the certificate of location of which is of record in the office of the recorder of Eureka County, Nevada in Book 22 page 412, in accordance with NRS 517.080. The general course of this claim is North/South. This claim is 1500 feet in length along the course of the claim, being 1490 feet from the point of discovery in a North direction to the North end line of this claim, and 10 feet in a South direction to the South end line of the claim. This claim is 600 feet in width, being 300 feet in width on each side of the center line of the claim.

This claim is located within the SE Quarter of Section 5, Township 22 North, Range 51 East, Mount Diablo Base and Meridian, unknown Mining District, Eureka County, Nevada. The location monument of this claim is situated with reference to some natural object or permanent monument as follows: Corner no. 1 of this claim is located approximately 11400 feet N 10 W of the located SE corner of Section 17 T22N, R51E, MDM

The corners of this claim are marked by 4"x4"x5' posts of with metal tags inscribed with the appropriate corner number as shown on the following sketch and the accompanying claim map.

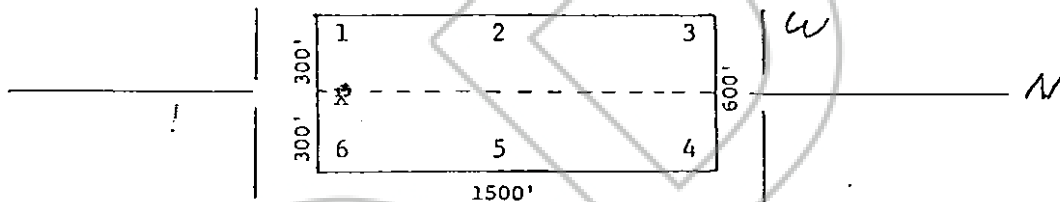

The location work consisted of making the maps as provided in NRS 517.040.

Dated and posted on the ground this 7 day of March, 1980

Witnesses:

Locator:

LYLE F. CAMPBELL
 P.O. Box 7377
 Reno, Nevada 89510

[Signature of Lyle F. Campbell]

STATE OF NEVADA)

) ss.

COUNTY OF _____)

I hereby certify that the within instrument was filed and recorded at the request of: _____

FILE NO. _____

on _____

at _____

Docket _____

Page _____

Witness my hand and official seal the day and year aforesaid.

County Recorder

By _____ Deputy Recorder

DPK/jlm 2/1/79 (3)

BOOK 81 PAGE 393

RECORDED AT REQUEST OF
 American Sales Inc.
 BOOK 81 PAGE 393

80 MAY 30 AIO: 35

CLERK OF DISTRICT COURT
 WILLIAM H. WILSON
 73781
 12-3-80

STATE OF NEVADA
 CERTIFICATE OF MINING LOCATION
 LODE CLAIM ON PUBLIC DOMAIN

NOTICE IS HEREBY GIVEN that the Sam No. 28 lode mining claim has been located by Lyle F. Campbell. This claim is a relocation of the Samarkand No. 28 lode mining claim, the certificate of location of which is of record in the office of the recorder of Eureka County, Nevada in Book 22 page 413, in accordance with NRS 517.080. The general course of this claim is North/South. This claim is 1500 feet in length along the course of the claim, being 10 feet from the point of discovery in a North direction to the North end line of this claim, and 1490 feet in a South direction to the South end line of the claim. This claim is 600 feet in width, being 300 feet in width on each side of the center line of the claim.

This claim is located within the SE Quarter of Section 5, Township 22 North, Range 51 East, Mount Diablo Base and Meridian, unknown Mining District, Eureka County, Nevada. The location monument of this claim is situated with reference to some natural object or permanent monument as follows: Corner no. 1 of this claim is located approximately 11600 feet N 10° W of the located SE corner of Section 17 T22N, R51E, MDM

The corners of this claim are marked by 4"x4"x5" posts of 4" native timber with metal tags inscribed with the appropriate corner number as shown on the following sketch and the accompanying claim map.

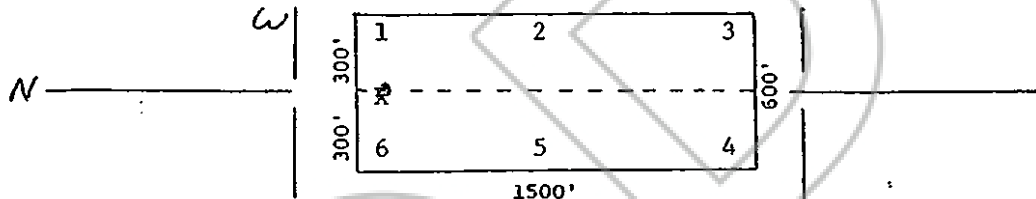

The location work consisted of making the maps as provided in NRS 517.040.

Dated and posted on the ground this 7 day of March, 1980

Witnesses:

Locator:

LYLE F. CAMPBELL
 P.O. Box 7377
 Reno, Nevada 89510

STATE OF NEVADA)

) ss.

COUNTY OF _____)

I hereby certify that the within instrument was filed and recorded at the request of:

FILE NO. _____

on _____

at _____

Docket _____

Page _____

Witness my hand and official seal the day and year aforesaid.

County Recorder

By _____ Deputy Recorder

DPK/jlm 2/1/79 (3)

80 MAY 30 AID: 35
 FILE NO. 73782
 REC'D 5:00

73783

STATE OF NEVADA
 CERTIFICATE OF MINING LOCATION
 LODGE CLAIM ON PUBLIC DOMAIN

NOTICE IS HEREBY GIVEN that the Sam No. 29 lode mining claim has been located by Lyle F. Campbell. This claim is a relocation of the Samarkand No. 29 lode mining claim, the certificate of location of which is of record in the office of the recorder of Eureka County, Nevada in Book 22 page 414, in accordance with NRS 517.080. The general course of this claim is North/ South. This claim is 1500 feet in length along the course of the claim, being 1490 feet from the point of discovery in a North direction to the North end line of this claim, and 10 feet in a South direction to the South end line of the claim. This claim is 600 feet in width, being 300 feet in width on each side of the center line of the claim.

This claim is located within the SE Quarter of Section 5, Township 22 North, Range 51 East, Mount Diablo Base and Meridian, unknown Mining District, Eureka County, Nevada. The location monument of this claim is situated with reference to some natural object or permanent monument as follows: Corner no. 1 of this claim is located approximately 11400 feet N 4° W of the located SE corner of Section 17 T22N, R51E, MDM

The corners of this claim are marked by 4"x4"x5' posts of 4" native timber with metal tags inscribed with the appropriate corner number as shown on the following sketch and the accompanying claim map.

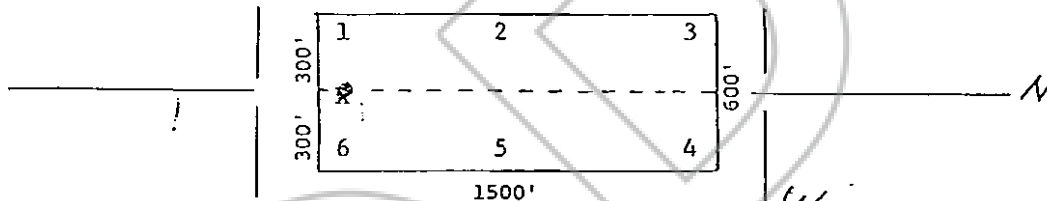

The location work consisted of making the maps as provided in NRS 517.040.

Dated and posted on the ground this 7 day of March, 1980

Witnesses:

Locator:

LYLE F. CAMPBELL
 P.O. Box 7377-
 Reno, Nevada 89510

[Signature]

STATE OF NEVADA

) ss.

COUNTY OF _____

I hereby certify that the within instrument was filed and recorded at the request of: _____

FILE NO. _____

on _____

at _____

Docket _____

Page _____

M.,

Witness my hand and official seal the day and year aforesaid.

County Recorder

By _____
 Deputy Recorder

DPK/jlm 2/1/79 (3)

RECORDED
 MAY 30 10:35
 EUREKA COUNTY RECORDER
 FILE NO. 73783
 BOOK 81 PAGE 395

BOOK 81 PAGE 395

STATE OF NEVADA
CERTIFICATE OF MINING LOCATION
LODE CLAIM ON PUBLIC DOMAIN

73784

NOTICE IS HEREBY GIVEN that the Sam No. 30 lode mining claim has been located by Lyle F. Campbell. This claim is a relocation of the Samarkand No. 30 lode mining claim, the certificate of location of which is of record in the office of the recorder of Eureka County, Nevada in Book 22 page 415, in accordance with NRS 517.080. The general course of this claim is North/ South. This claim is 1500 feet in length along the course of the claim, being 10 feet from the point of discovery in a North direction to the North end line of this claim, and 1490 feet in a South direction to the South end line of the claim. This claim is 600 feet in width, being 300 feet in width on each side of the center line of the claim.

This claim is located within the SE Quarter of Section 5, Township 22 North, Range 51 East, Mount Diablo Base and Meridian, unknown Mining District, Eureka County, Nevada. The location monument of this claim is situated with reference to some natural object or permanent monument as follows: Corner no. 1 of this claim is located approximately 11500 feet N 4 W of the located SE corner of Section 17 T22N, R51E, MDM

The corners of this claim are marked by 4"x4"x5" posts of 4" native timber with metal tags inscribed with the appropriate corner number as shown on the following sketch and the accompanying claim map.

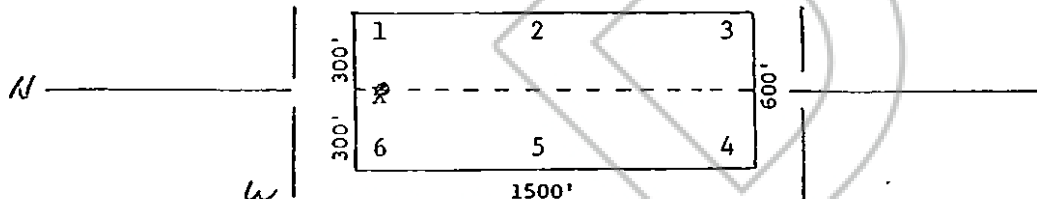

The location work consisted of making the maps as provided in NRS 517.040.

Dated and posted on the ground this 7 day of March, 1980

Witnesses:

Locator:

LYLE F. CAMPBELL
P.O. Box 7377
Reno, Nevada 89510

STATE OF NEVADA

COUNTY OF _____

ss.

I hereby certify that the within instrument was filed and recorded at the request of: _____

FILE NO. _____

on _____

at _____

Docket _____

Page _____

Witness my hand and official seal the day and year aforesaid.

County Recorder

By _____ Deputy Recorder

DPK/jlm 2/1/79 (3)

BOOK 81 PAGE 396

RECORDED AT REQUEST OF
American Salco Inc.
5000 81 396
MAY 30 10:35
73784
FEE \$3.00

STATE OF NEVADA
 CERTIFICATE OF MINING LOCATION
 LOSE CLAIM ON PUBLIC DOMAIN

NOTICE IS HEREBY GIVEN that the Sam No. 31 lode mining claim has been located by Lyle F. Campbell. This claim is a relocation of the Samarkand No. 31 lode mining claim, the certificate of location of which is of record in the office of the recorder of Eureka County, Nevada in Book 22 page 416, in accordance with NRS 517.080. The general course of this claim is North/ South. This claim is 1500 feet in length along the course of the claim, being 1490 feet from the point of discovery in a North direction to the North end line of this claim, and 10 feet in a South direction to the South end line of the claim. This claim is 600 feet in width, being 300 feet in width on each side of the center line of the claim.

This claim is located within the SE Quarter of Section 5, Township 22 North, Range 51 East, Mount Diablo Base and Meridian, unknown Mining District, Eureka County, Nevada. The location monument of this claim is situated with reference to some natural object or permanent monument as follows: Corner no. 1 of this claim is located approximately 11400 feet N 2° W of the located SE corner of Section 17 T22N, R51E, MDM

The corners of this claim are marked by 4"x4"x5" posts of 4" native timber with metal tags inscribed with the appropriate corner number as shown on the following sketch and the accompanying claim map.

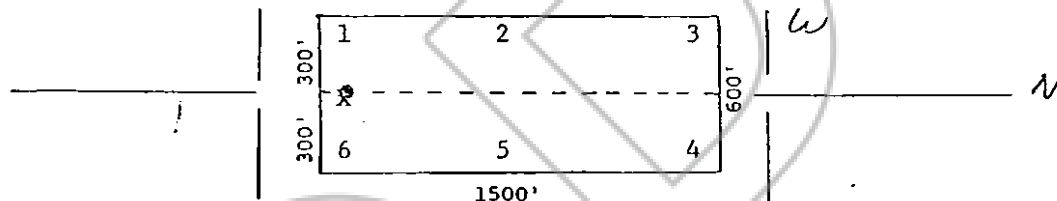

The location work consisted of making the maps as provided in NRS 517.040.

Dated and posted on the ground this 7 day of March, 1980

Witnesses:

Locator:

LYLE F. CAMPBELL
 P.O. Box 7377
 Reno, Nevada 89510

STATE OF NEVADA)

) ss.

COUNTY OF _____)

I hereby certify that the within instrument was filed and recorded at the request of:

FILE NO. _____

on _____

at _____

M.,

Docket _____

Page _____

Witness my hand and official seal the day and year aforesaid.

County Recorder

By _____ Deputy Recorder

DPK/jlm 2/1/79 (3)

RECORDED AT REQUEST OF
 America, Sales, Inc.
 500X-81-1-1397
 20 MAY 30 AIO: 35
 OFFICE OF THE COUNTY RECORDER
 EUREKA COUNTY, NEVADA
 FILE NO. 73785
 FEES \$3.00

STATE OF NEVADA
CERTIFICATE OF MINING LOCATION
LODE CLAIM ON PUBLIC DOMAIN

73786

NOTICE IS HEREBY GIVEN that the Sam No. 32 lode mining claim has been located by Lyle F. Campbell. This claim is a relocation of the Samarkand No. 32 lode mining claim, the certificate of location of which is of record in the office of the recorder of Eureka County, Nevada in Book 22 page 417, in accordance with NRS 517.080. The general course of this claim is North/South. This claim is 1500 feet in length along the course of the claim, being 10 feet from the point of discovery in a North direction to the North end line of this claim, and 1490 feet in a South direction to the South end line of the claim. This claim is 600 feet in width, being 300 feet in width on each side of the center line of the claim.

This claim is located within the SE Quarter of Section 5, Township 22 North, Range 51 East, Mount Diablo Base and Meridian, unknown Mining District, Eureka County, Nevada. The location monument of this claim is situated with reference to some natural object or permanent monument as follows: Corner no. 1 of this claim is located approximately 11400 feet N 2 W of the located SE corner of Section 17 T22N, R51E, MDM

The corners of this claim are marked by 4"x4"x5" posts of 4" native timber with metal tags inscribed with the appropriate corner number as shown on the following sketch and the accompanying claim map.

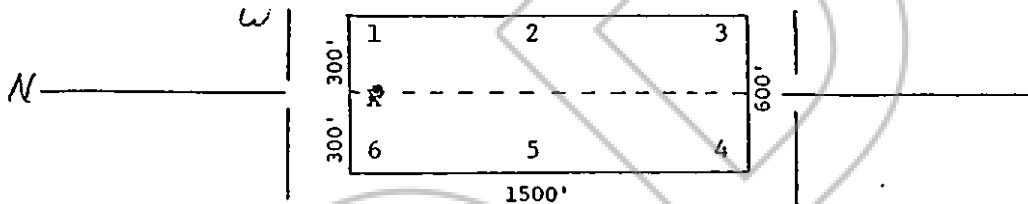

The location work consisted of making the maps as provided in NRS 517.040.

Dated and posted on the ground this 7 day of March, 1980

Witnesses:

Locator:

LYLE F. CAMPBELL
P.O. Box 7377
Reno, Nevada 89510

STATE OF NEVADA)

COUNTY OF _____) ss.

I hereby certify that the within instrument was filed and recorded at the request of: _____

FILE NO. _____

on _____

at _____ M.,

Docket _____

Page _____

Witness my hand and official seal the day and year aforesaid.

County Recorder

By _____

Deputy Recorder

DPK/jlm 2/1/79 (3)

BOOK 81 PAGE 398

RECORDED
MAY 30 10:35
73786
DEPUTY RECORDER
OFFICE OF THE COUNTY RECORDER
EUREKA, CALIF.

RECORDED AT REQUEST OF
American Salco, Inc.
BOOK 81 PAGE 398

STATE OF NEVADA
CERTIFICATE OF MINING LOCATION
LODE CLAIM ON PUBLIC DOMAIN

73787

NOTICE IS HEREBY GIVEN that the Sam No. 33 lode mining claim has been located by Lyle F. Campbell. This claim is a relocation of the Oxy No. 78 lode mining claim, the certificate of location of which is of record in the office of the recorder of Eureka County, Nevada in Book 36 page 235, in accordance with NRS 517.080. The general course of this claim is North/ South. This claim is 1500 feet in length along the course of the claim, being 1490 feet from the point of discovery in a North direction to the North end line of this claim, and 10 feet in a South direction to the South end line of the claim. This claim is 600 feet in width, being 300 feet in width on each side of the center line of the claim.

This claim is located within the SW Quarter of Section 4, Township 22 North, Range 51 East, Mount Diablo Base and Meridian, unknown Mining District, Eureka County, Nevada. The location monument of this claim is situated with reference to some natural object or permanent monument as follows: Corner no. 1 of this claim is located approximately 11660 feet N 3° E of the located SE corner of Section 17 T22N, R51E, MDN

The corners of this claim are marked by 4"x4"x5" posts of native timber with metal tags inscribed with the appropriate corner number as shown on the following sketch and the accompanying claim map.

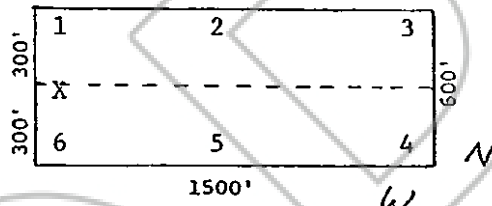

The location work consisted of making the maps as provided in NRS 517.040.

Dated and posted on the ground this 7 day of March, 1980

Witnesses:

Locator:

LYLE F. CAMPBELL
P.O. Box 7377
Reno, Nevada 89510

STATE OF NEVADA)

) ss.

COUNTY OF _____)

I hereby certify that the within instrument was filed and recorded at the request of: _____

FILE NO. _____

on _____

at _____ M.,

Docket _____ Page _____

Witness my hand and official seal the day and year aforesaid.

County Recorder

By _____
Deputy Recorder

DPK/jlm 2/1/79 (3)

RECORDED AT REC'D LIST OF
American Seals, Inc.
BOOK 81 PAGE 399
MAY 30 10:35
FILE NO. 73787
FEE \$ 3.00

BOOK 81 PAGE 399

STATE OF NEVADA
CERTIFICATE OF MINING LOCATION
LODE CLAIM ON PUBLIC DOMAIN

73788

NOTICE IS HEREBY GIVEN that the Sam No. 34 lode mining claim has been located by Lyle F. Campbell. This claim is a relocation of the Oxy No. 77 lode mining claim, the certificate of location of which is of record in the office of the recorder of Eureka County, Nevada in Book 36 page 234, in accordance with NRS 517.080. The general course of this claim is North/ South. This claim is 1500 feet in length along the course of the claim, being 10 feet from the point of discovery in a North direction to the North end line of this claim, and 1490 feet in a South direction to the South end line of the claim. This claim is 600 feet in width, being 300 feet in width on each side of the center line of the claim.

This claim is located within the SW Quarter of Section 4, Township 22 North, Range 51 East, Mount Diablo Base and Meridian, unknown Mining District, Eureka County, Nevada. The location monument of this claim is situated with reference to some natural object or permanent monument as follows: Corner no. 1 of this claim is located approximately 11600 feet N 3° E of the located SE corner of Section 17 T22N, R51E, MDM

The corners of this claim are marked by 4"x4"x5" posts of with metal tags inscribed with the appropriate corner number as shown on the following sketch and the accompanying claim map.

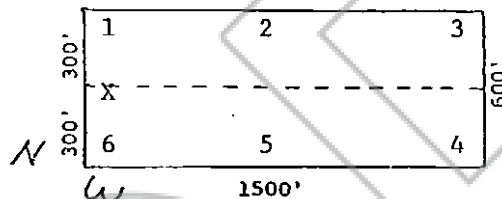

The location work consisted of making the maps as provided in NRS 517.040.

Dated and posted on the ground this 7 day of March, 1980

Witnesses:

Locator:

LYLE F. CAMPBELL
P.O. Box 7377
Reno, Nevada 89510

STATE OF NEVADA

COUNTY OF _____

ss.

I hereby certify that the within instrument was filed and recorded at the request of: _____

FILE NO. _____

on _____

at _____ M.,

Docket _____ Page _____

Witness my hand and official seal the day and year aforesaid.

County Recorder

By _____ Deputy Recorder

DPK/jlm 2/1/79 (3)

BOOK 81 PAGE 400

RECORDED AT REQUEST OF
American Sales, Inc.
BOOK 81 PAGE 400
80 MAY 30 AIO: 35
WILLIAM C. CAMPBELL
CLERK
\$ 3.00

STATE OF NEVADA
CERTIFICATE OF MINING LOCATION
LODE CLAIM ON PUBLIC DOMAIN

73789

NOTICE IS HEREBY GIVEN that the Sam No. 35 lode mining claim has been located by Lyle F. Campbell. This claim is a relocation of the Oxy No. 79 lode mining claim, the certificate of location of which is of record in the office of the recorder of Eureka County, Nevada in Book 36 page 236, in accordance with NRS 517.080. The general course of this claim is North/ South. This claim is 1500 feet in length along the course of the claim, being 1490 feet from the point of discovery in a North direction to the North end line of this claim, and 10 feet in a South direction to the South end line of the claim. This claim is 600 feet in width, being 300 feet in width on each side of the center line of the claim.

This claim is located within the SW Quarter of Section 4, Township 22 North, Range 51 East, Mount Diablo Base and Meridian, unknown Mining District, Eureka County, Nevada. The location monument of this claim is situated with reference to some "natural object or permanent monument as follows: Corner no.1 of this claim is located approximately 1160 feet N 3 E of the located SE corner of Section 17 T22N, R51E, MDM

The corners of this claim are marked by 4"x4"x5" posts of with metal tags inscribed with the appropriate corner number as shown on the following sketch and the accompanying claim map.

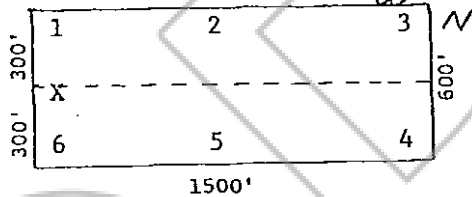

The location work consisted of making the maps as provided in NRS 517.040.

Dated and posted on the ground this 7 day of March, 1980

Witnesses:

Locator:

LYLE F. CAMPBELL
P.O. Box 7377
Reno, Nevada 89510

STATE OF NEVADA

COUNTY OF _____

) ss.

I hereby certify that the within instrument was filed and recorded at the request of: _____

FILE NO. _____
on _____
at _____ M.,
Docket _____ Page _____

Witness my hand and official seal the day and year aforesaid.

County Recorder

By Deputy Recorder

DPK/jlm 2/1/79 (3)

RECORDED AT REQUEST OF
American Sales, Inc.
BOOK 81 PAGE 401
80 MAY 30 A10:36
FILE NO. 73789
FILE \$ 3.00

BOOK 81 PAGE 401

STATE OF NEVADA
 CERTIFICATE OF MINING LOCATION
 LOSE CLAIM ON PUBLIC DOMAIN

NOTICE IS HEREBY GIVEN that the Sam No. 36
 lode mining claim has been located by Lyle F. Campbell. This
 claim is a relocation of the Oxy No. 76 lode mining claim,
 the certificate of location of which is of record in the office
 of the recorder of Eureka County, Nevada in Book 36 page
233, in accordance with NRS 517.080. The general course of
 this claim is North/ South. This claim is
 1500 feet in length along the course of the claim, being 10
 feet from the point of discovery in a North direction to
 the North end line of this claim, and 1490 feet in
 a South direction to the South end line of the claim.
 This claim is 600 feet in width, being 300 feet in width on each
 side of the center line of the claim.

This claim is located within the SW Quarter
 of Section 4, Township 22 North, Range 51 East,
 Mount Diablo Base and Meridian, unknown Mining District,
Eureka County, Nevada. The location monument of
 this claim is situated with reference to some natural object or
 permanent monument as follows: Corner no. 1 of this claim is located
approximately 11460 feet N 3° E of the located SE corner of
Section 17 T22N, R51E, MDM

The corners of this claim are marked by 4"x4"x5" posts of
with metal tags inscribed with the appropriate corner number
as shown on the following sketch and the accompanying claim map.

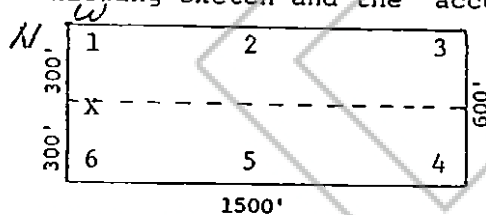

The location work consisted of making the maps as provided
 in NRS 517.040.

Dated and posted on the ground this 7 day of March,
 1980

Witnesses:

Locator:

LYLE F. CAMPBELL
 P.O. Box 7377
 Reno, Nevada 89510

STATE OF NEVADA

COUNTY OF _____

ss.

I hereby certify that the within
 instrument was filed and recorded at
 the request of: _____
 FILE NO. _____
 on _____
 at _____ M.,
 Docket _____ Page _____

Witness my hand and official
 seal the day and
 year aforesaid.

County Recorder

By _____
 Deputy Recorder

DPK/jlm 2/1/79 (3)

OFFICE
 EUREKA COUNTY, NEVADA
 WILLIS A. BROWN, JR., RECORDER
 FILE NO. 73790
 FEE \$ 3.00

80 MAY 30 AIO: 36

RECORDED AT REQUEST OF
 American Sales, Inc.
 BOOK 81 PAGE 402

STATE OF NEVADA
CERTIFICATE OF MINING LOCATION
LODE CLAIM ON PUBLIC DOMAIN

73791

NOTICE IS HEREBY GIVEN that the Sam No. 37 lode mining claim has been located by Lyle F. Campbell. This claim is a relocation of the Oxy No. 80 lode mining claim; the certificate of location of which is of record in the office of the recorder of Eureka County, Nevada in Book 36 page 237, in accordance with NRS 517.080. The general course of this claim is North/ South. This claim is 1500 feet in length along the course of the claim, being 1490 feet from the point of discovery in a North direction to the North end line of this claim, and 10 feet in a South direction to the South end line of the claim. This claim is 600 feet in width, being 300 feet in width on each side of the center line of the claim.

This claim is located within the SW Quarter of Section 4, Township 22 North, Range 51 East, Mount Diablo Base and Meridian, unknown Mining District, Eureka County, Nevada. The location monument of this claim is situated with reference to some natural object or permanent monument as follows: Corner no. 1 of this claim is located approximately 11800 feet N 4° E of the located SE corner of Section 17 T22N, R51E, MDM

The corners of this claim are marked by 4"x4"x5" posts of native timber with metal tags inscribed with the appropriate corner number as shown on the following sketch and the accompanying claim map.

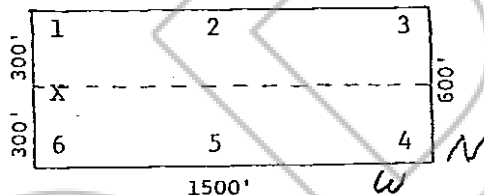

The location work consisted of making the maps as provided in NRS 517.040.

Dated and posted on the ground this 7 day of March, 1980

Witnesses:

Locator:

LYLE F. CAMPBELL
P.O. Box 7377
Reno, Nevada 89510

STATE OF NEVADA)

) ss.

COUNTY OF _____)

I hereby certify that the within instrument was filed and recorded at the request of:

FILE NO. _____

on _____

at _____

Docket _____

Page _____

Witness my hand and official seal the day and year aforesaid.

County Recorder

By _____ Deputy Recorder

DPK/jlm 2/1/79 (3)

OFFICIAL RECORD
EUREKA COUNTY, NEVADA
CLIFF A. DEPAULI, RECORDER
FILE NO. 73791
FEE \$ 3.00

80 MAY 30 AIO: 36

RECORDED AT REQUEST OF
American Sales Inc.
BOOK - 81 PAGE 403

BOOK 81 PAGE 403

STATE OF NEVADA
CERTIFICATE OF MINING LOCATION
LODE CLAIM ON PUBLIC DOMAIN

73792

NOTICE IS HEREBY GIVEN that the Sam No. 38 lode mining claim has been located by Lyle F. Campbell. This claim is a relocation of the Oxy No. 75 lode mining claim, the certificate of location of which is of record in the office of the recorder of Eureka County, Nevada in Book 36 page 232, in accordance with NRS 517.080. The general course of this claim is North/South. This claim is 1500 feet in length along the course of the claim, being 10 feet from the point of discovery in a North direction to the North end line of this claim, and 1490 feet in a South direction to the South end line of the claim. This claim is 600 feet in width, being 300 feet in width on each side of the center line of the claim.

This claim is located within the SW Quarter of Section 4, Township 22 North, Range 51 East, Mount Diablo Base and Meridian, unknown Mining District, Eureka County, Nevada. The location monument of this claim is situated with reference to some natural object or permanent monument as follows: Corner no. 1 of this claim is located approximately 11800 feet N 9° E of the located SE corner of Section 17 T22N, R51E, MDM

The corners of this claim are marked by 4"x4"x5" posts of native timber with metal tags inscribed with the appropriate corner number as shown on the following sketch and the accompanying claim map.

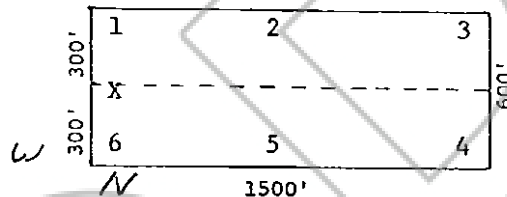

The location work consisted of making the maps as provided in NRS 517.040.

Dated and posted on the ground this 7 day of March, 1980

Witnesses:

Locator:

LYLE F. CAMPBELL
P.O. Box 7377
Reno, Nevada 89510

STATE OF NEVADA)
COUNTY OF _____) ss.

I hereby certify that the within instrument was filed and recorded at the request of: _____
FILE NO. _____
on _____
at _____ M.,
Docket _____ Page _____

Witness my hand and official seal the day and year aforesaid.

County Recorder

By _____ Deputy Recorder

DPK/jlm 2/1/79 (3)

OFFICE OF THE COUNTY RECORDER
EUREKA COUNTY, NEVADA
FILE NO. 73792
FEE \$ 3.00

80 MAY 30 AIO: 36

RECORDED AT THE REQUEST OF
American Sales Inc.
BOOK 81 PAGE 404

BOOK 81 PAGE 404

STATE OF NEVADA
 CERTIFICATE OF MINING LOCATION
 LODE CLAIM ON PUBLIC DOMAIN

NOTICE IS HEREBY GIVEN that the Sam No. 39 lode mining claim has been located by Lyle F. Campbell. This claim is a relocation of the Samarkand No. 33 lode mining claim, the certificate of location of which is of record in the office of the recorder of Eureka County, Nevada in Book 22 page 418, in accordance with NRS 517.080. The general course of this claim is North/ South. This claim is 1500 feet in length along the course of the claim, being 1490 feet from the point of discovery in a North direction to the North end line of this claim, and 10 feet in a South direction to the South end line of the claim. This claim is 600 feet in width, being 300 feet in width on each side of the center line of the claim.

This claim is located within the 1100 Quarter of Section 8, Township 22 North, Range 51 East, Mount Diablo Base and Meridian, unknown Mining District, Eureka County, Nevada. The location monument of this claim is situated with reference to some natural object or permanent monument as follows: Corner no. 1 of this claim is located approximately 9200 feet N 27° W of the located SE corner of Section 17 T22N, R51E, MDM

The corners of this claim are marked by 4"x4"x5" posts of native timber with metal tags inscribed with the appropriate corner number as shown on the following sketch and the accompanying claim map.

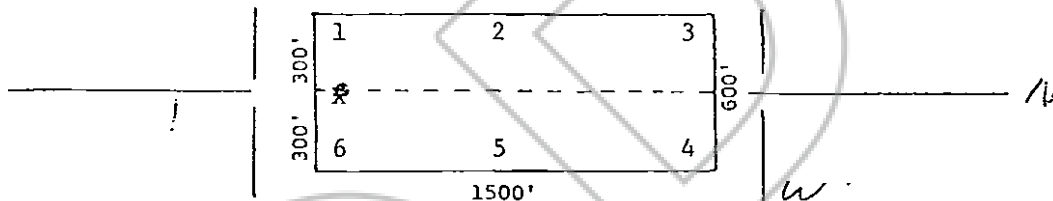

The location work consisted of making the maps as provided in NRS 517.040.

Dated and posted on the ground this 6 day of March, 1980

Witnesses:

Locator:

LYLE F. CAMPBELL
 P.O. Box 7377
 Reno, Nevada 89510

STATE OF NEVADA)

) ss.

COUNTY OF _____)

I hereby certify that the within instrument was filed and recorded at the request of: _____

FILE NO. _____

on _____

at _____

Docket _____

Page _____

M.,

Witness my hand and official seal the day and year aforesaid.

County Recorder

By _____ Deputy Recorder

DPK/jlm 2/1/79 (3)

RECEIVED AT REC'D
 EUREKA COUNTY
 CLERK'S OFFICE
 FILE NO. 73793
 FILED 3-00

80 MAY 30 AIO: 36

RECORDED AT REC'D
 EUREKA COUNTY
 CLERK'S OFFICE
 FILE NO. 73793
 FILED 3-00

STATE OF NEVADA
CERTIFICATE OF MINING LOCATION
LODE CLAIM ON PUBLIC DOMAIN

73794

NOTICE IS HEREBY GIVEN that the Sam No. 40 lode mining claim has been located by Lyle F. Campbell. This claim is a relocation of the Samarkand No. 34 lode mining claim, the certificate of location of which is of record in the office of the recorder of Eureka County, Nevada in Book 22 page 419, in accordance with NRS 517.080. The general course of this claim is North/ South. This claim is 1500 feet in length along the course of the claim, being 10 feet from the point of discovery in a North direction to the North end line of this claim, and 1490 feet in a South direction to the South end line of the claim. This claim is 600 feet in width, being 300 feet in width on each side of the center line of the claim.

This claim is located within the NW Quarter of Section 8, Township 22 North, Range 51 East, Mount Diablo Base and Meridian, unknown Mining District, Eureka County, Nevada. The location monument of this claim is situated with reference to some natural object or permanent monument as follows: Corner no.1 of this claim is located approximately 9200 feet N 27 W of the located SE corner of Section 17 T22N, R51E, MDM

The corners of this claim are marked by 4"x4"x5" posts of native timber with metal tags inscribed with the appropriate corner number as shown on the following sketch and the accompanying claim map.

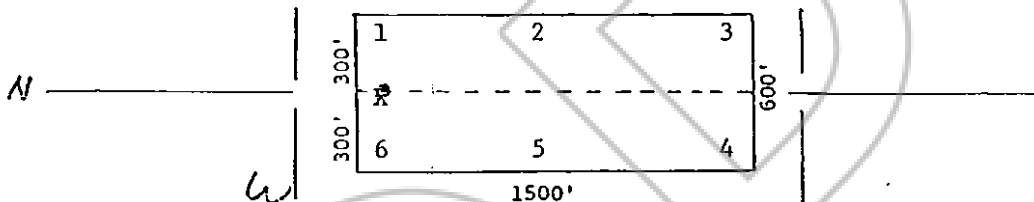

The location work consisted of making the maps as provided in NRS 517.040.

Dated and posted on the ground this 6 day of March, 1980

Witnesses:

Locator:

LYLE F. CAMPBELL
P.O. Box 7377
Reno, Nevada 89510

STATE OF NEVADA

COUNTY OF _____

) ss.

I hereby certify that the within instrument was filed and recorded at the request of: _____

FILE NO. _____

on _____

at _____

Docket _____

Page _____

M.,

Witness my hand and official seal the day and year aforesaid.

County Recorder

By _____

Deputy Recorder

RECORDED
INDEXED
FILED
FEB 27 1980
COUNTY RECORDER
EUREKA COUNTY, NEVADA
FEE \$3.00
BOOK NO. 73794

BONAY 30 AIO: 36

RECORDED AT REQUEST OF
American Sales Inc.
BOOK 81 PAGE 406

DPK/jlm 2/1/79 (3)

STATE OF NEVADA
CERTIFICATE OF MINING LOCATION
LODE CLAIM ON PUBLIC DOMAIN

73795

NOTICE IS HEREBY GIVEN that the Sam No. 41 lode mining claim has been located by Lyle F. Campbell. This claim is a relocation of the Samarkand No. 35 lode mining claim, the certificate of location of which is of record in the office of the recorder of Eureka County, Nevada in Book 22 page 420, in accordance with NRS 517.080. The general course of this claim is North/ South. This claim is 1500 feet in length along the course of the claim, being 1490 feet from the point of discovery in a North direction to the North end line of this claim, and 10 feet in a South direction to the South end line of the claim. This claim is 600 feet in width, being 300 feet in width on each side of the center line of the claim.

This claim is located within the NW Quarter of Section 8, Township 22 North, Range 51 East, Mount Diablo Base and Meridian, unknown Mining District, Eureka County, Nevada. The location monument of this claim is situated with reference to some natural object or permanent monument as follows: Corner no. 1 of this claim is located approximately 9200 feet N 77° W of the located SE corner of Section 17 T22N, R51E, MDM

The corners of this claim are marked by 4"x4"x5" posts of 4" native timber with metal tags inscribed with the appropriate corner number as shown on the following sketch and the accompanying claim map.

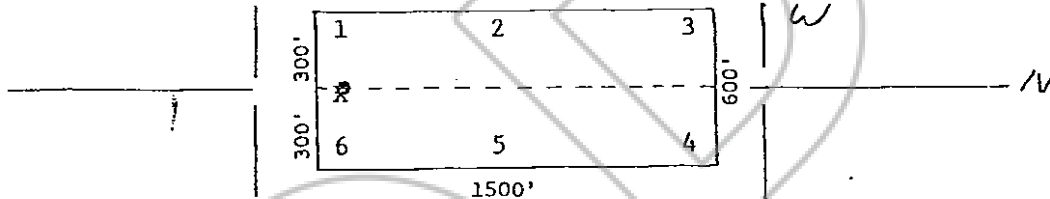

The location work consisted of making the maps as provided in NRS 517.040.

Dated and posted on the ground this 6 day of March, 1980

Witnesses:

Locator:

LYLE F. CAMPBELL
P.O. Box 7377
Reno, Nevada 89510

STATE OF NEVADA

COUNTY OF _____

I hereby certify that the within instrument was filed and recorded at the request of: _____

FILE NO. _____

on _____

at _____ M.,

Docket _____ Page _____

Witness my hand and official seal the day and year aforesaid.

County Recorder

By _____
Deputy Recorder

DPK/jlm 2/1/79 (3)

RECORDED AT REQUEST OF
American Sales, Inc.
BOOK 22 PAGE 420
80 MAY 30 AIO: 36
EUREKA COUNTY, NEVADA
FILE NO. 73795
FEE \$ 3.00

BOOK 21 PAGE 407

STATE OF NEVADA
CERTIFICATE OF MINING LOCATION
LODE CLAIM ON PUBLIC DOMAIN

73796

NOTICE IS HEREBY GIVEN that the Sam No. 42 lode mining claim has been located by Lyle F. Campbell. This claim is a relocation of the Samarkand No. 36 lode mining claim, the certificate of location of which is of record in the office of the recorder of Eureka County, Nevada in Book 22 page 421, in accordance with NRS 517.080. The general course of this claim is North/South. This claim is 1500 feet in length along the course of the claim, being 10 feet from the point of discovery in a North direction to the North end line of this claim, and 1497 feet in a South direction to the South end line of the claim. This claim is 600 feet in width, being 300 feet in width on each side of the center line of the claim.

This claim is located within the NW Quarter of Section 8, Township 22 North, Range 51 East, Mount Diablo Base and Meridian, unknown Mining District, Eureka County, Nevada. The location monument of this claim is situated with reference to some natural object or permanent monument as follows: Corner no. 1 of this claim is located approximately 9200 feet N 27° W of the located SE corner of Section 17 T22N, R51E, MDM

The corners of this claim are marked by 4"x4"x5' posts of with metal tags inscribed with the appropriate corner number as shown on the following sketch and the accompanying claim map.

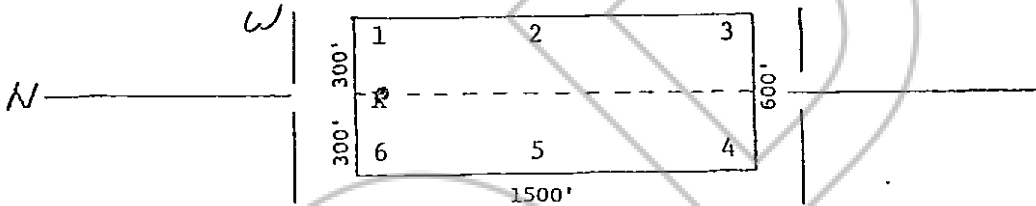

The location work consisted of making the maps as provided in NRS 517.040.

Dated and posted on the ground this 6 day of March, 1980

Witnesses:

Locator:

LYLE F. CAMPBELL
P.O. Box 7377
Reno, Nevada 89510

STATE OF NEVADA)
) ss.
COUNTY OF _____)

I hereby certify that the within instrument was filed and recorded at the request of: _____
FILE NO. _____
on _____
at _____ M.,
Docket _____ Page _____

Witness my hand and official seal the day and year aforesaid.

County Recorder
By _____ Deputy Recorder

OFFICE OF THE COUNTY RECORDER
EUREKA COUNTY, NEVADA
FILE NO. 73796
\$3.00

80 MAY 30 AIO: 36

RECORDED AT REQUEST OF
American Sales, Inc.
BOOK 81 PAGE 408

DPK/jlm 2/1/79 (3)

BOOK 81 PAGE 408

STATE OF NEVADA
CERTIFICATE OF MINING LOCATION
LODE CLAIM ON PUBLIC DOMAIN

73797

NOTICE IS HEREBY GIVEN that the Sam No. 43 lode mining claim has been located by Lyle F. Campbell. This claim is a relocation of the Samarkand No. 37 lode mining claim, the certificate of location of which is of record in the office of the recorder of Eureka County, Nevada in Book 22 page 422, in accordance with NRS 517.080. The general course of this claim is North/South. This claim is 1500 feet in length along the course of the claim, being 1490 feet from the point of discovery in a North direction to the North end line of this claim, and 10 feet in a South direction to the South end line of the claim. This claim is 600 feet in width, being 300 feet in width on each side of the center line of the claim.

This claim is located within the NW Quarter of Section 8, Township 22 North, Range 51 East, Mount Diablo Base and Meridian, unknown Mining District, Eureka County, Nevada. The location monument of this claim is situated with reference to some natural object or permanent monument as follows: Corner no. 1 of this claim is located approximately 8700 feet N 19 W of the located SE corner of Section 17 T22N, R51E, MDM

The corners of this claim are marked by 4"x4"x5" posts of 4" native timber with metal tags inscribed with the appropriate corner number as shown on the following sketch and the accompanying claim map.

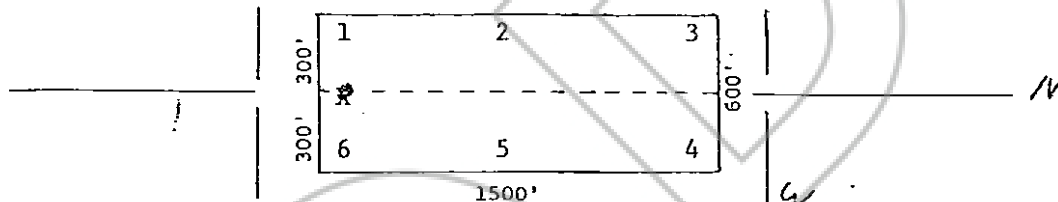

The location work consisted of making the maps as provided in NRS 517.040.

Dated and posted on the ground this 6 day of March, 1980

Witnesses:

Locator:

LYLE F. CAMPBELL
P.O. Box 7377
Reno, Nevada 89510

STATE OF NEVADA)
COUNTY OF _____) ss.

I hereby certify that the within instrument was filed and recorded at the request of: _____
FILE NO. _____
on _____
at _____ M.,
Docket _____ Page _____

Witness my hand and official seal the day and year aforesaid.

County Recorder

By _____
Deputy Recorder

OFFICIAL RECORDS
EUREKA COUNTY, NEVADA
FILED NO. 73797
FEB 23 1980

80 MAY 30 AIO: 36

RECORDED AT REQUEST OF
American Sales Inc.
BOOK 81 PAGE 409

DPK/jlm 2/1/79 (3)

BOOK 81 PAGE 409

STATE OF NEVADA
CERTIFICATE OF MINING LOCATION
LODE CLAIM ON PUBLIC DOMAIN

73798

NOTICE IS HEREBY GIVEN that the Sam No. 44 lode mining claim has been located by Lyle F. Campbell. This claim is a relocation of the Samarkand No. 38 lode mining claim, the certificate of location of which is of record in the office of the recorder of Eureka County, Nevada in Book 22 page 423, in accordance with NRS 517.080. The general course of this claim is North/ South. This claim is 1500 feet in length along the course of the claim, being 10 feet from the point of discovery in a North direction to the North end line of this claim, and 1490 feet in a South direction to the South end line of the claim. This claim is 600 feet in width, being 300 feet in width on each side of the center line of the claim.

This claim is located within the NW Quarter of Section 8, Township 22 North, Range 51 East, Mount Diablo Base and Meridian, unknown Mining District, Eureka County, Nevada. The location monument of this claim is situated with reference to some natural object or permanent monument as follows: Corner no. 1 of this claim is located approximately 5700 feet N, 700 W of the located SE corner of Section 17 T22N, R51E, MDM

The corners of this claim are marked by 4"x4"x5" posts of 4" native timber with metal tags inscribed with the appropriate corner number as shown on the following sketch and the accompanying claim map.

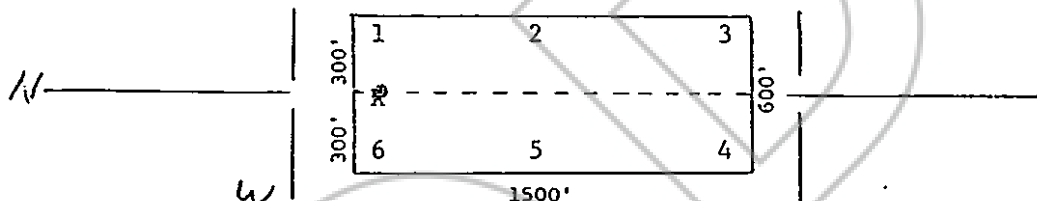

The location work consisted of making the maps as provided in NRS 517.040.

Dated and posted on the ground this 6 day of March, 1980

Witnesses:

Locator:

LYLE F. CAMPBELL
P.O. Box 7377
Reno, Nevada 89510

STATE OF NEVADA)
COUNTY OF _____) ss.

I hereby certify that the within instrument was filed and recorded at the request of: _____

FILE NO. _____
on _____
at _____ M.,
Docket _____ Page _____

Witness my hand and official seal the day and year aforesaid.

County Recorder
By _____ Deputy Recorder

80 MAY 31 A/D: 36
OFFICE OF THE COUNTY CLERK
EUREKA COUNTY, NEVADA
FILED 73798
300

DPK/jlm 2/1/79 (3)

RECORDED AT REQUEST OF
American Sales Inc.
BOOK 81 PAGE 410

BOOK 81 PAGE 410

73799

STATE OF NEVADA
 CERTIFICATE OF MINING LOCATION
 LODE CLAIM ON PUBLIC DOMAIN

NOTICE IS HEREBY GIVEN that the Sam No. 45 lode mining claim has been located by Lyle F. Campbell. This claim is a relocation of the Samarkand No. 39 lode mining claim, the certificate of location of which is of record in the office of the recorder of Eureka County, Nevada in Book 22 page 424, in accordance with NRS 517.080. The general course of this claim is North/ South. This claim is 1500 feet in length along the course of the claim, being 1490 feet from the point of discovery in a North direction to the North end line of this claim, and 10 feet in a South direction to the South end line of the claim. This claim is 600 feet in width, being 300 feet in width on each side of the center line of the claim.

This claim is located within the NW Quarter of Section 8, Township 22 North, Range 51 East, Mount Diablo Base and Meridian, unknown Mining District, Eureka County, Nevada. The location monument of this claim is situated with reference to some natural object or permanent monument as follows: Corner no. 1 of this claim is located approximately 8700 feet N 1/4 W of the located SE corner of Section 17 T22N, R51E, MDM

The corners of this claim are marked by 4"x4"x5" posts of native timber with metal tags inscribed with the appropriate corner number as shown on the following sketch and the accompanying claim map.

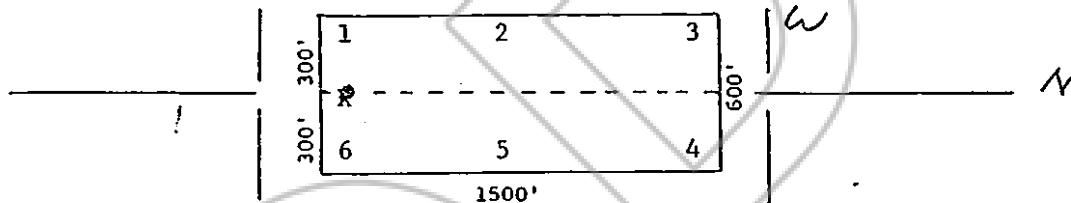

The location work consisted of making the maps as provided in NRS 517.040.

Dated and posted on the ground this 6 day of March, 1980

Witnesses:

Locator:

LYLE F. CAMPBELL
 P.O. Box 7377 -
 Reno, Nevada 89510

STATE OF NEVADA

COUNTY OF _____

I hereby certify that the within instrument was filed and recorded at the request of:

FILE NO. _____

on _____

at _____ M.,

Docket _____

Page _____

Witness my hand and official seal the day and year aforesaid.

County Recorder

By _____
 Deputy Recorder

DPK/jlm 2/1/79 (3)

RECORDED AT REQUEST OF
 American-Sale, Inc.
 BOOK 81 PAGE 411
 80 MAY 30 AIO: 36
 OFFICE OF THE COUNTY CLERK
 EUREKA COUNTY, NEVADA
 FILED 73799
 REC'D 8:00

BOOK 81 PAGE 411

73800

STATE OF NEVADA
 CERTIFICATE OF MINING LOCATION
 LODE CLAIM ON PUBLIC DOMAIN

NOTICE IS HEREBY GIVEN that the Sam No. 46 lode mining claim has been located by Lyle F. Campbell. This claim is a relocation of the Samarkand No. 40 lode mining claim, the certificate of location of which is of record in the office of the recorder of Eureka County, Nevada in Book 22 page 425, in accordance with NRS 517.080. The general course of this claim is North/ South. This claim is 1500 feet in length along the course of the claim, being 10 feet from the point of discovery in a North direction to the North end line of this claim, and 1490 feet in a South direction to the South end line of the claim. This claim is 600 feet in width, being 300 feet in width on each side of the center line of the claim.

This claim is located within the NW Quarter of Section 8, Township 22 North, Range 51 East, Mount Diablo Base and Meridian, unknown Mining District, Eureka County, Nevada. The location monument of this claim is situated with reference to some natural object or permanent monument as follows: Corner no. 1 of this claim is located approximately 8700 feet N 79 W of the located SE corner of Section 17 T22N, R51E, MDM

The corners of this claim are marked by 4"x4"x5' posts of 4" native timber with metal tags inscribed with the appropriate corner number as shown on the following sketch and the accompanying claim map.

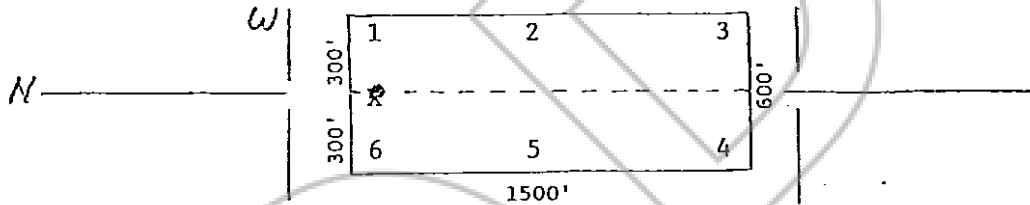

The location work consisted of making the maps as provided in NRS 517.040.

Dated and posted on the ground this 6 day of March, 1980

Witnesses:

Locator:

LYLE F. CAMPBELL
 P.O. Box 7377
 Reno, Nevada 89510

STATE OF NEVADA)

COUNTY OF _____)

I hereby certify that the within instrument was filed and recorded at the request of: _____

FILE NO. _____
 on _____
 at _____ M.,
 Docket _____ Page _____

Witness my hand and official seal the day and year aforesaid.

County Recorder

By _____ Deputy Recorder

DPK/jlm 2/1/79 (3)

RECORDED
 MAY 30 10:36
 73800
 1113-3-80

BOOK 81 PAGE 412

STATE OF NEVADA
 CERTIFICATE OF MINING LOCATION
 LORE CLAIM ON PUBLIC DOMAIN

NOTICE IS HEREBY GIVEN that the Sam No. 47 lode mining claim has been located by Lyle F. Campbell. This claim is a relocation of the Samarkand No. 41 lode mining claim, the certificate of location of which is of record in the office of the recorder of Eureka County, Nevada in Book 22 page 4210, in accordance with NRS 517.080. The general course of this claim is North/ South. This claim is 1500 feet in length along the course of the claim, being 1490 feet from the point of discovery in a North direction to the North end line of this claim, and 10 feet in a South direction to the South end line of the claim. This claim is 600 feet in width, being 300 feet in width on each side of the center line of the claim.

This claim is located within the N1E Quarter of Section 8, Township 22 North Range 51 East, Mount Diablo Base and Meridian, unknown Mining District, Eureka County, Nevada. The location monument of this claim is situated with reference to some natural object or permanent monument as follows: Corner no. 1 of this claim is located approximately 8400 feet N 13 W of the located SE corner of Section 17 T22N, R51E, MDM

The corners of this claim are marked by 4"x4"x5" posts of native timber with metal tags inscribed with the appropriate corner number as shown on the following sketch and the accompanying claim map.

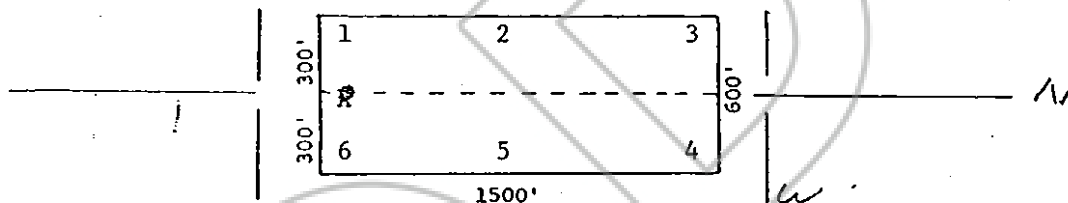

The location work consisted of making the maps as provided in NRS 517.040.

Dated and posted on the ground this 6 day of March, 1980

Witnesses:

Locator:

LYLE F. CAMPBELL
 P.O. Box 7377
 Reno, Nevada 89510

STATE OF NEVADA

COUNTY OF _____

ss.

I hereby certify that the within instrument was filed and recorded at the request of: _____

FILE NO. _____

on _____

at _____

Docket _____

Page _____

Witness my hand and official seal the day and year aforesaid.

County Recorder

By _____
 Deputy Recorder

DPK/jlm 2/1/79 (3)

OFFICIAL RECORDS
 EUREKA COUNTY, NEVADA
 FILE NO. 73801
 FEE \$ 3.00

80 MAY 30 AID: 36

RECORDED AT REQUEST OF
 American Sales, Inc.
 80011-81-1413

73802

STATE OF NEVADA
CERTIFICATE OF MINING LOCATION
LODE CLAIM ON PUBLIC DOMAIN

NOTICE IS HEREBY GIVEN that the Sam No. 48 lode mining claim has been located by Lyle F. Campbell. This claim is a relocation of the Samarkand No. 42 lode mining claim, the certificate of location of which is of record in the office of the recorder of Eureka County, Nevada in Book 22 page 427, in accordance with NRS 517.080. The general course of this claim is North/ South. This claim is 1500 feet in length along the course of the claim, being 10 feet from the point of discovery in a North direction to the North end line of this claim, and 1490 feet in a South direction to the South end line of the claim. This claim is 600 feet in width, being 300 feet in width on each side of the center line of the claim.

This claim is located within the N1E Quarter of Section 8, Township 22 North, Range 51 East, Mount Diablo Base and Meridian, unknown Mining District, Eureka County, Nevada. The location monument of this claim is situated with reference to some natural object or permanent monument as follows: Corner no. 1 of this claim is located approximately 8400 feet N 13° W of the located SE corner of Section 17 T22N, R51E, MDM

The corners of this claim are marked by 4"x4"x5" posts of with metal tags inscribed with the appropriate corner number as shown on the following sketch and the accompanying claim map.

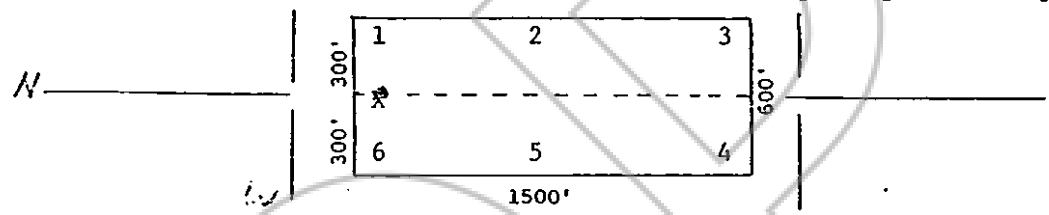

The location work consisted of making the maps as provided in NRS 517.040.

Dated and posted on the ground this 6 day of March, 1980

Witnesses:

Locator:

LYLE F. CAMPBELL
P.O. Box 7377
Reno, Nevada 89510

STATE OF NEVADA

COUNTY OF _____

I hereby certify that the within instrument was filed and recorded at the request of: _____
FILE NO. _____
on _____
at _____ M.,
Docket _____ Page _____

Witness my hand and official seal the day and year aforesaid.

County Recorder
By _____ Deputy Recorder

DPK/jlm 2/1/79 (3)

RECORDED AT REQUEST OF
American Seismic, Inc.
BOOK 81 PAGE 414
80 MAY 30 A10:36
OFFICE REC'D
EUREKA COUNTY, NEVADA
FILED
FEE \$ 3.00
73802

BOOK 81 PAGE 414

73803

STATE OF NEVADA
 CERTIFICATE OF MINING LOCATION
 LOSE CLAIM ON PUBLIC DOMAIN

NOTICE IS HEREBY GIVEN that the Sam No. 49 lode mining claim has been located by Lyle F. Campbell. This claim is a relocation of the Samarkand No. 43 lode mining claim, the certificate of location of which is of record in the office of the recorder of Eureka County, Nevada in Book 22 page 428, in accordance with NRS 517.080. The general course of this claim is North/South. This claim is 1500 feet in length along the course of the claim, being 1490 feet from the point of discovery in a North direction to the North end line of this claim, and 10 feet in a South direction to the South end line of the claim. This claim is 600 feet in width, being 300 feet in width on each side of the center line of the claim.

This claim is located within the NE Quarter of Section 8, Township 22 North, Range 51 East, Mount Diablo Base and Meridian, unknown Mining District, Eureka County, Nevada. The location monument of this claim is situated with reference to some natural object or permanent monument as follows: Corner no. 1 of this claim is located approximately 8400 feet N 13 W of the located SE corner of Section 17 T22N, R51E, MDM.

The corners of this claim are marked by 4"x4"x5" posts of 4" native timber with metal tags inscribed with the appropriate corner number as shown on the following sketch and the accompanying claim map.

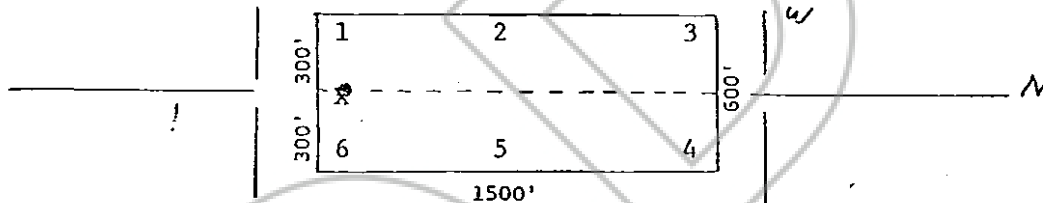

The location work consisted of making the maps as provided in NRS 517.040.

Dated and posted on the ground this 6 day of March, 1980

Witnesses:

Locator:

LYLE F. CAMPBELL
 P.O. Box 7377
 Reno, Nevada 89510

STATE OF NEVADA)

) ss.

COUNTY OF _____)

I hereby certify that the within instrument was filed and recorded at the request of: _____

FILE NO. _____

on _____

at _____ M.,

Docket _____

Page _____

Witness my hand and official seal the day and year aforesaid.

County Recorder

By _____

Deputy Recorder

DPK/jlm 2/1/79 (3)

OFFICE OF THE COUNTY CLERK
 EUREKA COUNTY, NEVADA
 WILLIS A. BROWN, CLERK
 FILED 73803
 FEB 3 1980

80 MAY 30 AIO: 36

RECEIVED AT REQUEST OF
 American Sales Inc.
 BOOK 81 PAGE 415

BOOK 81 PAGE 415

73804

STATE OF NEVADA
 CERTIFICATE OF MINING LOCATION
 LODE CLAIM ON PUBLIC DOMAIN

NOTICE IS HEREBY GIVEN that the Sam No. 50 lode mining claim has been located by Lyle F. Campbell. This claim is a relocation of the Samarkand No. 44 lode mining claim, the certificate of location of which is of record in the office of the recorder of Eureka County, Nevada in Book 22 page 429, in accordance with NRS 517.080. The general course of this claim is North/ South. This claim is 1500 feet in length along the course of the claim, being 10 feet from the point of discovery in a North direction to the North end line of this claim, and 490 feet in a South direction to the South end line of the claim. This claim is 600 feet in width, being 300 feet in width on each side of the center line of the claim.

This claim is located within the N1E Quarter of Section 8, Township 22 North, Range 51 East, Mount Diablo Base and Meridian, unknown Mining District, Eureka County, Nevada. The location monument of this claim is situated with reference to some natural object or permanent monument as follows: Corner no. 1 of this claim is located approximately 8400 feet N 13 W of the located SE corner of Section 17 T22N, R51E, MDM

The corners of this claim are marked by 4"x4"x5" posts of native timber with metal tags inscribed with the appropriate corner number as shown on the following sketch and the accompanying claim map.

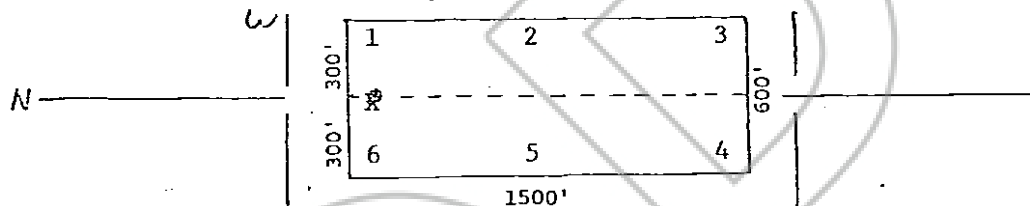

The location work consisted of making the maps as provided in NRS 517.040.

Dated and posted on the ground this 6 day of March, 1980

Witnesses:

Locator:

LYLE F. CAMPBELL
 P.O. Box 7377
 Reno, Nevada 89510

STATE OF NEVADA)

COUNTY OF _____) ss.

I hereby certify that the within instrument was filed and recorded at the request of: _____

FILE NO. _____
 on _____
 at _____ M.,
 Docket _____ Page _____

Witness my hand and official seal the day and year aforesaid.

County Recorder

By Deputy Recorder

DPK/jlm 2/1/79 (3)

OFFICIAL RECORDS
 BUREAU OF MINES
 FILE NO. 73804
 FEE \$ 3.00

80 MAY 30 A10:37

RECORDED AT REQUEST OF
 American Seale Inc.
 BOOK 81 PAGE 416

BOOK 81 PAGE 416

73805

STATE OF NEVADA
 CERTIFICATE OF MINING LOCATION
 LOSE CLAIM ON PUBLIC DOMAIN

NOTICE IS HEREBY GIVEN that the Sam No. 51 lode mining claim has been located by Lyle F. Campbell. This claim is a relocation of the Samarkand No. 45 lode mining claim, the certificate of location of which is of record in the office of the recorder of Eureka County, Nevada in Book 22 page 430, in accordance with NRS 517.080. The general course of this claim is North/South. This claim is 1500 feet in length along the course of the claim, being 10 feet from the point of discovery in a North direction to the North end line of this claim, and 1490 feet in a South direction to the South end line of the claim. This claim is 600 feet in width, being 300 feet in width on each side of the center line of the claim.

This claim is located within the N/E Quarter of Section 8, Township 22 North, Range 51 East, Mount Diablo Base and Meridian, unknown Mining District, Eureka County, Nevada. The location monument of this claim is situated with reference to some natural object or permanent monument as follows: Corner no. 1 of this claim is located approximately 8300 feet N 5° W of the located SE corner of Section 17 T22N, R51E, MDM

The corners of this claim are marked by 4"x4"x5" posts of 4" native timber with metal tags inscribed with the appropriate corner number as shown on the following sketch and the accompanying claim map.

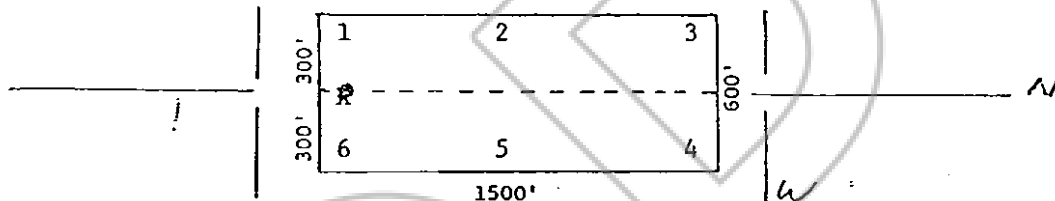

The location work consisted of making the maps as provided in NRS 517.040.

Dated and posted on the ground this 6 day of March, 1980

Witnesses:

Locator:

LYLE F. CAMPBELL
 P.O. Box 7377
 Reno, Nevada 89510

[Signature of Lyle F. Campbell]

STATE OF NEVADA

COUNTY OF _____

ss.

I hereby certify that the within instrument was filed and recorded at the request of:

FILE NO. _____

on _____

at _____

Docket _____

Page _____

M.,

Witness my hand and official seal the day and year aforesaid.

County Recorder

By _____
 Deputy Recorder

DPK/jlm 2/1/79 (3)

OFFICE OF THE
 CLERK OF THE
 COUNTY OF EUREKA
 FILE NO. 73805
 FILED 3.00

80 MAY 30 AID: 37

RECORDED AT REQUEST OF
 American Sales
 BOOK 81 PAGE 417

BOOK 81 PAGE 417

STATE OF NEVADA
 CERTIFICATE OF MINING LOCATION
 LOSE CLAIM ON PUBLIC DOMAIN

NOTICE IS HEREBY GIVEN that the Sam No. 52 lode mining claim has been located by Lyle F. Campbell. This claim is a relocation of the Samarkand No. 46 lode mining claim, the certificate of location of which is of record in the office of the recorder of Eureka County, Nevada in Book 22 page 431, in accordance with NRS 517.080. The general course of this claim is North/ South. This claim is 1500 feet in length along the course of the claim, being 10 feet from the point of discovery in a North direction to the North end line of this claim, and 1490 feet in a South direction to the South end line of the claim. This claim is 600 feet in width, being 300 feet in width on each side of the center line of the claim.

This claim is located within the A/E Quarter of Section 8, Township 22 North, Range 51 East, Mount Diablo Base and Meridian, unknown Mining District, Eureka County, Nevada. The location monument of this claim is situated with reference to some natural object or permanent monument as follows: Corner no. 1 of this claim is located approximately 8300 feet N 0 W of the located SE corner of Section 17 T22N, R51E, MDM

The corners of this claim are marked by 4"x4"x5' posts of with metal tags inscribed with the appropriate corner number as shown on the following sketch and the accompanying claim map.

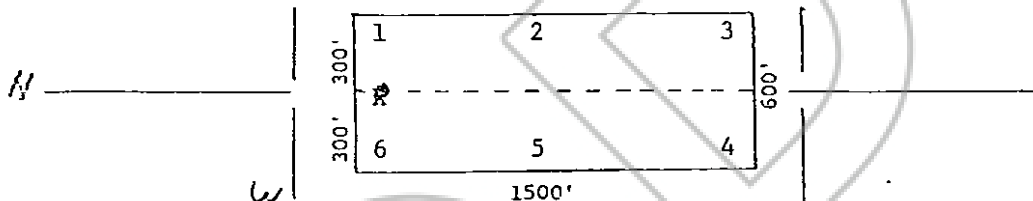

The location work consisted of making the maps as provided in NRS 517.040.

Dated and posted on the ground this 6 day of March, 1980

Witnesses:

Locator:

LYLE F. CAMPBELL
 P.O. Box 7377
 Reno, Nevada 89510

STATE OF NEVADA)

) ss.

COUNTY OF _____)

I hereby certify that the within instrument was filed and recorded at the request of:

FILE NO. _____

on _____

at _____ M.,

Docket _____ Page _____

Witness my hand and official seal the day and year aforesaid.

County Recorder

By _____ Deputy Recorder

DPK/jlm 2/1/79 (3)

OFFICE OF THE COUNTY CLERK
 EUREKA COUNTY, NEVADA
 FILE NO. 73806
 FEE \$ 3.00

80 MAY 30 AIO:37

RECORDED AT REQUEST OF
 American Seals, Inc.
 BOOK 81 PAGE 418

BOOK 81 PAGE 418

73807

STATE OF NEVADA
 CERTIFICATE OF MINING LOCATION
 LOSE CLAIM ON PUBLIC DOMAIN

NOTICE IS HEREBY GIVEN that the Sam No. 53 lode mining claim has been located by Lyle F. Campbell. This claim is a relocation of the Samarkand No. 47 lode mining claim, the certificate of location of which is of record in the office of the recorder of Eureka County, Nevada in Book 22 page 432, in accordance with NRS 517.080. The general course of this claim is North/South. This claim is 1500 feet in length along the course of the claim, being 1490 feet from the point of discovery in a North direction to the North end line of this claim, and 10 feet in a South direction to the South end line of the claim. This claim is 600 feet in width, being 300 feet in width on each side of the center line of the claim.

This claim is located within the NE Quarter of Section 8, Township 22 North, Range 51 East, Mount Diablo Base and Meridian, unknown Mining District, Eureka County, Nevada. The location monument of this claim is situated with reference to some natural object or permanent monument as follows: Corner no. 1 of this claim is located approximately 8300 feet N 5° W of the located SE corner of Section 17 T22N, R51E, MDM

The corners of this claim are marked by 4"x4"x5" posts of 4" native timber with metal tags inscribed with the appropriate corner number as shown on the following sketch and the accompanying claim map.

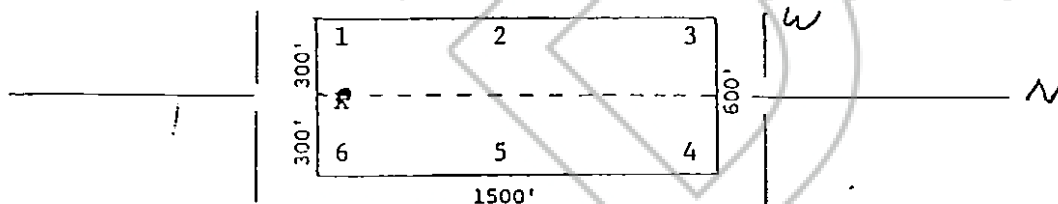

The location work consisted of making the maps as provided in NRS 517.040.

Dated and posted on the ground this 6 day of March, 1980

Witnesses:

Locator:

LYLE F. CAMPBELL
 P.O. Box 7377
 Reno, Nevada 89510

STATE OF NEVADA)

) ss.

COUNTY OF _____)

I hereby certify that the within instrument was filed and recorded at the request of: _____

FILE NO. _____

on _____

at _____ M.,

Docket _____ Page _____

Witness my hand and official seal the day and year aforesaid.

County Recorder

By _____
 Deputy Recorder

DPK/jlm 2/1/79 (3)

OFFICE OF THE COUNTY CLERK
 EUREKA COUNTY, NEVADA
 WILLIS A. GRIFFIN, CLERK
 FILE NO. 73807
 FEB 5 3 00

80 MAY 30 AIO: 37

RECORDED AT REQUEST OF
 American Sales Inc.
 BOOK 81 PAGE 419

BOOK 81 PAGE 419

NOTICE IS HEREBY GIVEN that the Sam No. 54 lode mining claim has been located by Lyle F. Campbell. This claim is a relocation of the Samarkand No. 48 lode mining claim, the certificate of location of which is of record in the office of the recorder of Eureka County, Nevada in Book 22, page 433, in accordance with NRS 517.080. The general course of this claim is North/South. This claim is 1500 feet in length along the course of the claim, being 10 feet from the point of discovery in a North direction to the North end line of this claim, and 1490 feet in a South direction to the South end line of the claim. This claim is 600 feet in width, being 300 feet in width on each side of the center line of the claim.

This claim is located within the NE Quarter of Section 8, Township 22 North, Range 51 East, Mount Diablo Base and Meridian, unknown Mining District, Eureka County, Nevada. The location monument of this claim is situated with reference to some natural object or permanent monument as follows: Corner no. 1 of this claim is located approximately 8300 feet N 5° W of the located SE corner of Section 17 T22N, R51E, MDM

The corners of this claim are marked by 4"x4"x5" posts of 4" native timber with metal tags inscribed with the appropriate corner number as shown on the following sketch and the accompanying claim map.

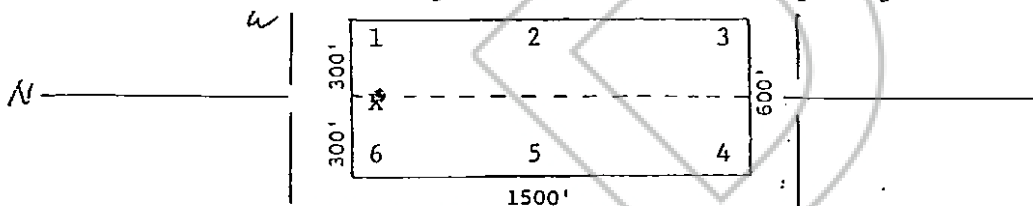

The location work consisted of making the maps as provided in NRS 517.040.

Dated and posted on the ground this 6 day of March, 1980

Witnesses:

Locator:

LYLE F. CAMPBELL
P.O. Box 7377
Reno, Nevada 89510

STATE OF NEVADA)

) ss.

COUNTY OF _____)

I hereby certify that the within instrument was filed and recorded at the request of: _____

FILE NO. _____

on _____

at _____

Docket _____

Page _____

Witness my hand and official seal the day and year aforesaid.

County Recorder

By Deputy Recorder

DPK/jlm 2/1/79 (3)

OFFICE OF THE COUNTY CLERK
EUREKA COUNTY, NEVADA
FILE NO. 73808
FEE \$ 3.00

80 MAY 30 10:37

RECORDED AT REQUEST OF
American Sako, Inc.
BOOK 81 PAGE 420

BOOK 81 PAGE 420

STATE OF NEVADA
 CERTIFICATE OF MINING LOCATION
 LODE CLAIM ON PUBLIC DOMAIN

NOTICE IS HEREBY GIVEN that the Sam No. 55 lode mining claim has been located by Lyle F. Campbell. This claim is a relocation of the Oxy No. 72 lode mining claim, the certificate of location of which is of record in the office of the recorder of Eureka County, Nevada in Book 36 page 229, in accordance with NRS 517.080. The general course of this claim is North/ South. This claim is 1500 feet in length along the course of the claim, being 1490 feet from the point of discovery in a North direction to the North end line of this claim, and 10 feet in a South direction to the South end line of the claim. This claim is 600 feet in width, being 300 feet in width on each side of the center line of the claim.

This claim is located within the NW Quarter of Section 9, Township 22 North, Range 51 East, Mount Diablo Base and Meridian, unknown Mining District, Eureka County, Nevada. The location monument of this claim is situated with reference to some natural object or permanent monument as follows: Corner no. 1 of this claim is located approximately 8670 feet N 4° E of the located SE corner of Section 17 T22N, R51E, MDM

The corners of this claim are marked by 4"x4"x5" posts of native timber with metal tags inscribed with the appropriate corner number as shown on the following sketch and the accompanying claim map.

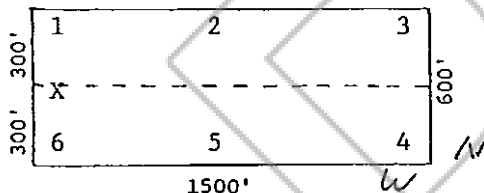

The location work consisted of making the maps as provided in NRS 517.040.

Dated and posted on the ground this 6 day of March, 1980

Witnesses:

Locator:

LYLE F. CAMPBELL
 P.O. Box 7377
 Reno, Nevada 89510

STATE OF NEVADA

COUNTY OF _____

) ss.

I hereby certify that the within instrument was filed and recorded at the request of: _____

FILE NO. _____

on _____

at _____

Docket _____

Page _____

M.,

Witness my hand and official seal the day and year aforesaid.

County Recorder

By _____

Deputy Recorder

DPK/jlm 2/1/79 (3)

OFFICIAL RECORDS
 EUREKA COUNTY, NEVADA
 WILLIS A. BISHOP, RECORDER
 FILE NO. 73809
 FEE \$ 3.00

80 MAY 30 AIO: 37

RECORDED AT REQUEST OF
 American Sales, Inc.
 BOOK 81 PAGE 421

NOTICE IS HEREBY GIVEN that the Sam No. 56 lode mining claim has been located by Lyle F. Campbell. This claim is a relocation of the Oxy No. 71 lode mining claim, the certificate of location of which is of record in the office of the recorder of Eureka County, Nevada in Book 36 page 228, in accordance with NRS 517.080. The general course of this claim is North/ South. This claim is 1500 feet in length along the course of the claim, being 10 feet from the point of discovery in a North direction to the North end line of this claim, and 1490 feet in a South direction to the South end line of the claim. This claim is 600 feet in width, being 300 feet in width on each side of the center line of the claim.

This claim is located within the 11/6 Quarter of Section 9, Township 22 North, Range 51 East, Mount Diablo Base and Meridian, unknown Mining District, Eureka County, Nevada. The location monument of this claim is situated with reference to some natural object or permanent monument as follows: Corner no. 1 of this claim is located approximately 8670 feet N 4° E of the located SE corner of Section 17 T22N, R51E, MDM

The corners of this claim are marked by 4"x4"x5' posts of 4" native timber with metal tags inscribed with the appropriate corner number as shown on the following sketch and the accompanying claim map.

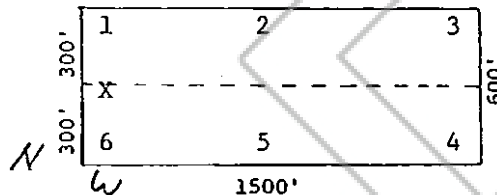

The location work consisted of making the maps as provided in NRS 517.040.

Dated and posted on the ground this 6 day of March, 1980

Witnesses:

Locator:

LYLE F. CAMPBELL
P.O. Box 7377
Reno, Nevada 89510

STATE OF NEVADA

COUNTY OF _____

) ss.

I hereby certify that the within instrument was filed and recorded at the request of: _____

FILE NO. _____

on _____

at _____

Docket _____

Page _____

M.,

Witness my hand and official seal the day and year aforesaid.

County Recorder

By _____

Deputy Recorder

RECORDED AT REQUEST OF
American Safe Inc.
BOOK 81 PAGE 422
MAY 30 AIO: 37

DPK/jlm 2/1/79 (3)

NOTICE IS HEREBY GIVEN that the Sam No. 57 lode mining claim has been located by Lyle F. Campbell. This claim is a relocation of the Oxy No. 73 lode mining claim, the certificate of location of which is of record in the office of the recorder of Eureka County, Nevada in Book 36 page 230, in accordance with NRS 517.080. The general course of this claim is North/ South. This claim is 1500 feet in length along the course of the claim, being 1490 feet from the point of discovery in a North direction to the North end line of this claim, and 10 feet in a South direction to the South end line of the claim. This claim is 600 feet in width, being 300 feet in width on each side of the center line of the claim.

This claim is located within the NW Quarter of Section 9, Township 22 North, Range 51 East, Mount Diablo Base and Meridian, unknown Mining District, Eureka County, Nevada. The location monument of this claim is situated with reference to some natural object or permanent monument as follows: Corner no. 1 of this claim is located approximately 8670 feet N 4° E of the located SE corner of Section 17 T22N, R51E, MDM

The corners of this claim are marked by 4"x4"x5' posts of 4" native timber with metal tags inscribed with the appropriate corner number as shown on the following sketch and the accompanying claim map.

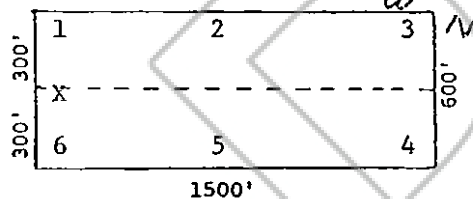

The location work consisted of making the maps as provided in NRS 517.040.

Dated and posted on the ground this 6 day of March, 1980

Witnesses:

Locator:

LYLE F. CAMPBELL
P.O. Box 7377
Reno, Nevada 89510

STATE OF NEVADA

COUNTY OF _____

) ss.

I hereby certify that the within instrument was filed and recorded at the request of: _____

FILE NO. _____

on _____

at _____

Docket: _____

Page _____

M.,

Witness my hand and official seal the day and year aforesaid.

County Recorder

By _____

Deputy

80 MAY 30 A10:37

DEPUTY RECORDER
WILLIS R. DODD
FILE NO. 73811
FEE \$3.00

RECORDED AT REQUEST OF
American Seize, Inc.
BOOK 81 PAGE 423

DPK/jlm 2/1/79 (3)

NOTICE IS HEREBY GIVEN that the Sam No. 58 lode mining claim has been located by Lyle F. Campbell. This claim is a relocation of the Oxy No. 70 lode mining claim, the certificate of location of which is of record in the office of the recorder of Eureka County, Nevada in Book 36 page 227, in accordance with NRS 517.080. The general course of this claim is North/ South. This claim is 1500 feet in length along the course of the claim, being 10 feet from the point of discovery in a North direction to the North end line of this claim, and 1490 feet in a South direction to the South end line of the claim. This claim is 600 feet in width, being 300 feet in width on each side of the center line of the claim.

This claim is located within the NW Quarter of Section 9, Township 22 North, Range 51 East, Mount Diablo Base and Meridian, unknown Mining District, Eureka County, Nevada. The location monument of this claim is situated with reference to some natural object or permanent monument as follows: Corner no. 1 of this claim is located approximately S 67° E feet N 4 E of the located SE corner of Section 17 T22N, R51E, MDM

The corners of this claim are marked by 4"x4"x5" posts of 4" native timber with metal tags inscribed with the appropriate corner number as shown on the following sketch and the accompanying claim map.

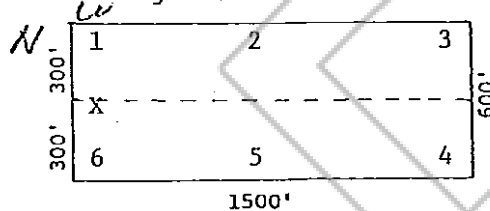

The location work consisted of making the maps as provided in NRS 517.040.

Dated and posted on the ground this 6 day of March, 1980

Witnesses:

Locator:

LYLE F. CAMPBELL
P.O. Box 7377
Reno, Nevada 89510

STATE OF NEVADA

COUNTY OF _____

I hereby certify that the within instrument was filed and recorded at the request of: _____

FILE NO. _____

on _____

at _____

Docket _____

Page _____

M.,

Witness my hand and official seal the day and year aforesaid.

County Recorder

By _____

Deputy Recorder

DPR/jlm 2/1/79 (3)

BOOK 81 PAGE 434

RECORDED AT REQUEST OF
American Sales, Inc.
BOOK 81 PAGE 434
80 MAY 30 10:37
WILLIAM A. CAMPBELL
DEPUTY RECORDER
73812
PL 3.00

STATE OF NEVADA
 CERTIFICATE OF MINING LOCATION
 LODE CLAIM ON PUBLIC DOMAIN

NOTICE IS HEREBY GIVEN that the Sam No. 59 lode mining claim has been located by Lyle F. Campbell. This claim is a relocation of the Oxy No. 74 lode mining claim, the certificate of location of which is of record in the office of the recorder of Eureka County, Nevada in Book 36 page 231, in accordance with NRS 517.080. The general course of this claim is North/ South. This claim is 1500 feet in length along the course of the claim, being 1490 feet from the point of discovery in a North direction to the North end line of this claim, and 10 feet in a South direction to the South end line of the claim. This claim is 600 feet in width, being 300 feet in width on each side of the center line of the claim.

This claim is located within the NW Quarter of Section 4, Township 22 North, Range 51 East, Mount Diablo Base and Meridian, unknown Mining District, Eureka County, Nevada. The location monument of this claim is situated with reference to some natural object or permanent monument as follows: Corner no.1 of this claim is located approximately 68.50 feet N 12° E of the located SE corner of Section 17 T22N, R51E, MDM

The corners of this claim are marked by 4"x4"x5" posts of 4" native timber with metal tags inscribed with the appropriate corner number as shown on the following sketch and the accompanying claim map.

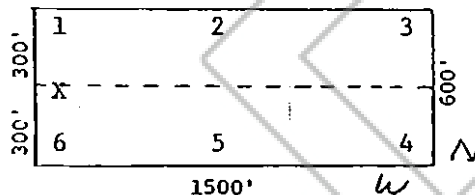

The location work consisted of making the maps as provided in NRS 517.040.

Dated and posted on the ground this 6 day of March, 1980

Witnesses:

Locator:

LYLE F. CAMPBELL
 P.O. Box 7377
 Reno, Nevada 89510

STATE OF NEVADA

COUNTY OF _____

) ss.

I hereby certify that the within instrument was filed and recorded at the request of: _____

FILE NO. _____

on _____

at _____

Docket _____

Page _____

M.,

Witness my hand and official seal the day and year aforesaid.

County Recorder

By _____

Deputy Recorder

DPK/jlm 2/1/79 (3)

OFFICIAL RECORDS
 CLERK OF DISTRICT COURT
 JUDICIAL DEPARTMENT
 FILE NO. 73813
 FEE \$ 3.00

80 MAY 30 10:37

RECORDED AT REQUEST OF
 American Seals, Inc.
 BOOK 81 PAGE 425

BOOK 81 PAGE 425

BOOK 81 PAGE 426

73815

STATE OF NEVADA
 CERTIFICATE OF MINING LOCATION
 LOSE CLAIM ON PUBLIC DOMAIN

NOTICE IS HEREBY GIVEN that the Sam No. 61 lode mining claim has been located by Lyle F. Campbell. This claim is a relocation of the Samarkand No. 49 lode mining claim, the certificate of location of which is of record in the office of the recorder of Eureka County, Nevada in Book 22 page 434, in accordance with NRS 517.080. The general course of this claim is North/ South. This claim is 1500 feet in length along the course of the claim, being 1490 feet from the point of discovery in a North direction to the North end line of this claim, and 10 feet in a South direction to the South end line of the claim. This claim is 600 feet in width, being 300 feet in width on each side of the center line of the claim.

This claim is located within the SW Quarter of Section 8, Township 22 North, Range 51 East, Mount Diablo Base and Meridian, unknown Mining District, Eureka County, Nevada. The location monument of this claim is situated with reference to some natural object or permanent monument as follows: Corner no. 1 of this claim is located approximately 6700 feet N 37° W of the located SE corner of Section 17 T22N, R51E, MDM

The corners of this claim are marked by 4"x4"x5" posts of native timber with metal tags inscribed with the appropriate corner number as shown on the following sketch and the accompanying claim map.

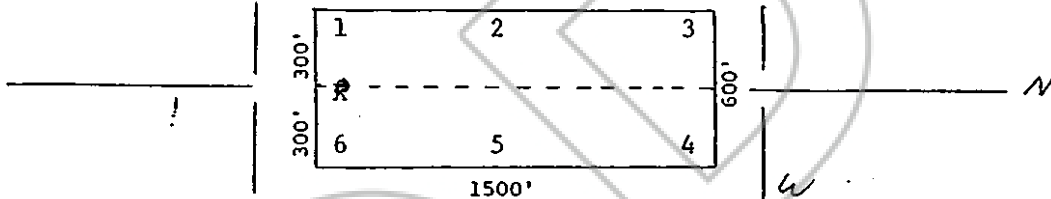

The location work consisted of making the maps as provided in NRS 517.040.

Dated and posted on the ground this 6 day of March, 1980

Witnesses:

Locator:

LYLE F. CAMPBELL
 P.O. Box 7377
 Reno, Nevada 89510

STATE OF NEVADA

COUNTY OF _____

I hereby certify that the within instrument was filed and recorded at the request of:

FILE NO. _____
 on _____
 at _____ M.,
 Docket _____ Page _____

Witness my hand and official seal the day and year aforesaid.

County Recorder

By _____ Deputy Recorder

DPK/jlm 2/1/79 (3)

BOOK 81 PAGE 427

RECORDED AT REQUEST OF
 American-Sale, Inc.
 BOOK 81 PAGE 427

80 MAY 30 AID: 37

RECEIVED
 WILLIAMSON COUNTY, NEVADA
 MAY 30 1980
 73815

STATE OF NEVADA
CERTIFICATE OF MINING LOCATION
LODE CLAIM ON PUBLIC DOMAIN

73816

NOTICE IS HEREBY GIVEN that the Sam No. 62 lode mining claim has been located by Lyle F. Campbell. This claim is a relocation of the Samarkand No. 50 lode mining claim, the certificate of location of which is of record in the office of the recorder of Eureka County, Nevada in Book 22 page 435, in accordance with NRS 517.080. The general course of this claim is North/South. This claim is 1500 feet in length along the course of the claim, being 10 feet from the point of discovery in a North direction to the North end line of this claim, and 1490 feet in a South direction to the South end line of the claim. This claim is 600 feet in width, being 300 feet in width on each side of the center line of the claim.

This claim is located within the SW Quarter of Section 8, Township 22 North, Range 51 East, Mount Diablo Base and Meridian, unknown Mining District, Eureka County, Nevada. The location monument of this claim is situated with reference to some natural object or permanent monument as follows: Corner no. 1 of this claim is located approximately 6700 feet N 37° W of the located SE corner of Section 17 T22N, R51E, MDM

The corners of this claim are marked by 4"x4"x5" posts of native timber with metal tags inscribed with the appropriate corner number as shown on the following sketch and the accompanying claim map.

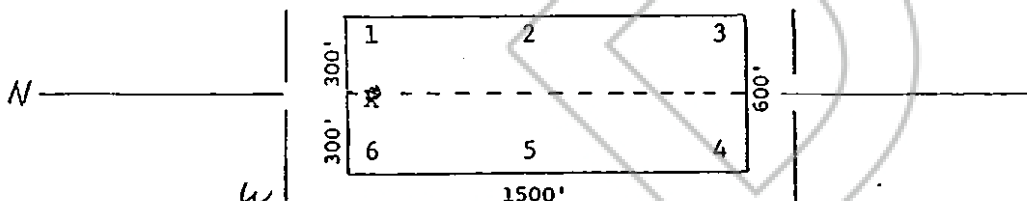

The location work consisted of making the maps as provided in NRS 517.040.

Dated and posted on the ground this 6 day of March, 1980

Witnesses:

Locator:

LYLE F. CAMPBELL
P.O. Box 7377
Reno, Nevada 89510

STATE OF NEVADA)

) ss.

COUNTY OF _____)

I hereby certify that the within instrument was filed and recorded at the request of: _____

FILE NO. _____

on _____

at _____ M.,

Docket _____

Page _____

Witness my hand and official seal the day and year aforesaid.

County Recorder

By _____
Deputy Recorder

DPK/jlm 2/1/79 (3)

OFFICIAL RECORDS
EUREKA COUNTY, NEVADA
FILE NO. 73816
FEE \$ 3.00

80 MAY 30 A10: 37

RECORDED AT REQUEST OF
American Sales, Inc.
BOOK 81 PAGE 438

BOOK 81 PAGE 438

STATE OF NEVADA
 CERTIFICATE OF MINING LOCATION
 LOSE CLAIM ON PUBLIC DOMAIN

NOTICE IS HEREBY GIVEN that the Sam No. 63 lode mining claim has been located by Lyle F. Campbell. This claim is a relocation of the Samarkand No. 51 lode mining claim, the certificate of location of which is of record in the office of the recorder of Eureka County, Nevada in Book 22 page 436, in accordance with NRS 517.080. The general course of this claim is North/ South. This claim is 1500 feet in length along the course of the claim, being 1490 feet from the point of discovery in a North direction to the North end line of this claim, and 10 feet in a South direction to the South end line of the claim. This claim is 600 feet in width, being 300 feet in width on each side of the center line of the claim.

This claim is located within the SW Quarter of Section 8, Township 22 North, Range 51 East, Mount Diablo Base and Meridian, unknown Mining District, Eureka County, Nevada. The location monument of this claim is situated with reference to some natural object or permanent monument as follows: Corner no. 1 of this claim is located approximately 6700 feet N 37° W of the located SE corner of Section 17 T22N, R51E, MDM

The corners of this claim are marked by 4"x4"x5" posts of 4" native timber with metal tags inscribed with the appropriate corner number as shown on the following sketch and the accompanying claim map.

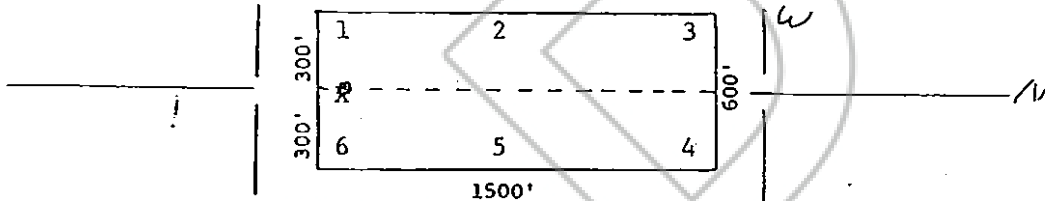

The location work consisted of making the maps as provided in NRS 517.040.

Dated and posted on the ground this 6 day of March, 1980

Witnesses:

Locator:

LYLE F. CAMPBELL
 P.O. Box 7377
 Reno, Nevada 89510

STATE OF NEVADA

COUNTY OF _____

ss.

I hereby certify that the within instrument was filed and recorded at the request of: _____

FILE NO. _____
 on _____
 at _____ M.,
 Docket _____ Page _____

Witness my hand and official seal the day and year aforesaid.

County Recorder

By _____
 Deputy Recorder

RECORDED AT REQUEST OF
 American Sales Inc
 BOOK 81 PAGE 429
 80 MAY 30 AID: 37
 WILLIAM CAMPBELL
 FILE NO. 73817
 \$3.00

DPK/jlm 2/1/79 (3)

73818

STATE OF NEVADA
 CERTIFICATE OF MINING LOCATION
 LODE CLAIM ON PUBLIC DOMAIN

NOTICE IS HEREBY GIVEN that the Sam No. 64 lode mining claim has been located by Lyle F. Campbell. This claim is a relocation of the Samarkand No. 52 lode mining claim, the certificate of location of which is of record in the office of the recorder of Eureka County, Nevada in Book 22 page 437, in accordance with NRS 517.080. The general course of this claim is North/ South. This claim is 1500 feet in length along the course of the claim, being 10 feet from the point of discovery in a North direction to the North end line of this claim, and 1490 feet in a South direction to the South end line of the claim. This claim is 600 feet in width, being 300 feet in width on each side of the center line of the claim.

This claim is located within the SW Quarter of Section 8, Township 22 North, Range 51 East, Mount Diablo Base and Meridian, unknown Mining District, Eureka County, Nevada. The location monument of this claim is situated with reference to some natural object or permanent monument as follows: Corner no. 1 of this claim is located approximately 6700 feet N 37° W of the located SE corner of Section 17 T22N, R51E, MDM

The corners of this claim are marked by 4"x4"x5" posts of 4" native timber with metal tags inscribed with the appropriate corner number as shown on the following sketch and the accompanying claim map.

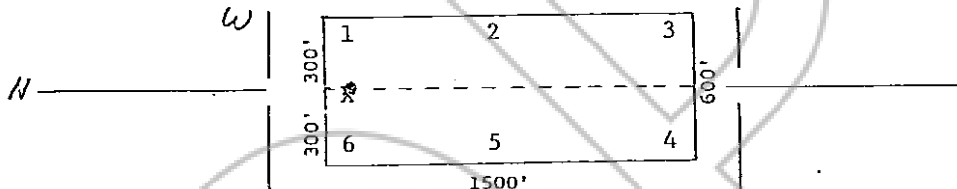

The location work consisted of making the maps as provided in NRS 517.040.

Dated and posted on the ground this 6 day of March, 1980

Witnesses:

Locator:

LYLE F. CAMPBELL
 P.O. Box 7377
 Reno, Nevada 89510

STATE OF NEVADA

COUNTY OF _____

I hereby certify that the within instrument was filed and recorded at the request of:
 FILE NO. _____

on _____ at _____ M.,
 Docket _____ Page _____

Witness my hand and official seal the day and year aforesaid.

County Recorder

By _____ Deputy Recorder

DPK/jlm 2/1/79 (3)

BOOK 81 PAGE 430

NOTICE OF RECORD OF
 RECORDED
 81-430

MAY 30 10:37

RECORDED
 FILED
 73818

NOTICE IS HEREBY GIVEN that the Sam No. 65 lode mining claim has been located by Lyle F. Campbell. This claim is a relocation of the Samarkand No. 53 lode mining claim, the certificate of location of which is of record in the office of the recorder of Eureka County, Nevada in Book 22 page 438, in accordance with NRS 517.080. The general course of this claim is North/South. This claim is 1500 feet in length along the course of the claim, being 1492 feet from the point of discovery in a North direction to the North end line of this claim, and 10 feet in a South direction to the South end line of the claim. This claim is 600 feet in width, being 300 feet in width on each side of the center line of the claim.

This claim is located within the SW Quarter of Section 8, Township 22 North, Range 51 East, Mount Diablo Base and Meridian, unknown Mining District, Eureka County, Nevada. The location monument of this claim is situated with reference to some natural object or permanent monument as follows: Corner no. 1 of this claim is located approximately 6100 feet N 28° W of the located SE corner of Section 17 T22N, R51E, MDM

The corners of this claim are marked by 4"x4"x5" posts of native timber with metal tags inscribed with the appropriate corner number as shown on the following sketch and the accompanying claim map.

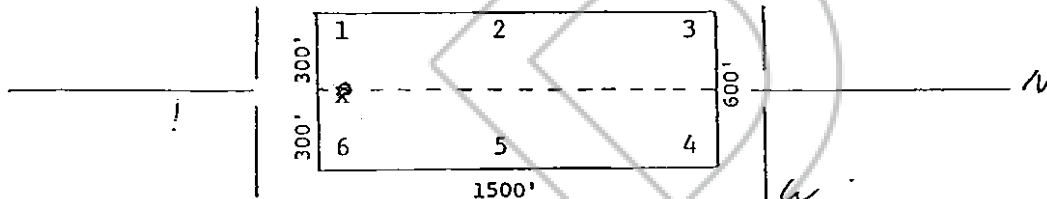

The location work consisted of making the maps as provided in NRS 517.040.

Dated and posted on the ground this 6 day of March, 1980

Witnesses:

Locator:

LYLE F. CAMPBELL
P.O. Box 7377
Reno, Nevada 89510

STATE OF NEVADA)

) ss.

COUNTY OF _____)

I hereby certify that the within instrument was filed and recorded at the request of: _____

FILE NO. _____

on _____

at _____

Docket _____

Page _____

M.,

Witness my hand and official seal the day and year aforesaid.

County Recorder

By _____

Deputy Recorder

DPK/jlm 2/1/79 (3)

BOOK 81 PAGE 431

RECORDED AT REQUEST OF
American Sales, Inc.
BOOK 81 PAGE 431

80 MAY 30 AIO: 38

OFFICIAL RECORD
EUREKA COUNTY
CLERK
WILLIAM E. CAMPBELL
FEB 10 1980
73819
S. 3.00

73820

STATE OF NEVADA
 CERTIFICATE OF MINING LOCATION
 LODE CLAIM ON PUBLIC DOMAIN

NOTICE IS HEREBY GIVEN that the Sam No. 66 lode mining claim has been located by Lyle F. Campbell. This claim is a relocation of the Samarkand No. 54 lode mining claim, the certificate of location of which is of record in the office of the recorder of Eureka County, Nevada in Book 22 page 439, in accordance with NRS 517.080. The general course of this claim is North/ South. This claim is 1500 feet in length along the course of the claim, being 10 feet from the point of discovery in a North direction to the North end line of this claim, and 1490 feet in a South direction to the South end line of the claim. This claim is 600 feet in width, being 300 feet in width on each side of the center line of the claim.

This claim is located within the 8W Quarter of Section 8, Township 22 North, Range 51 East, Mount Diablo Base and Meridian, unknown Mining District, Eureka County, Nevada. The location monument of this claim is situated with reference to some natural object or permanent monument as follows: Corner no. 1 of this claim is located approximately 6100 feet N 28° W of the located SE corner of Section 17 T22N, R51E, MDM

The corners of this claim are marked by 4"x4"x5" posts of 4" native timber with metal tags inscribed with the appropriate corner number as shown on the following sketch and the accompanying claim map.

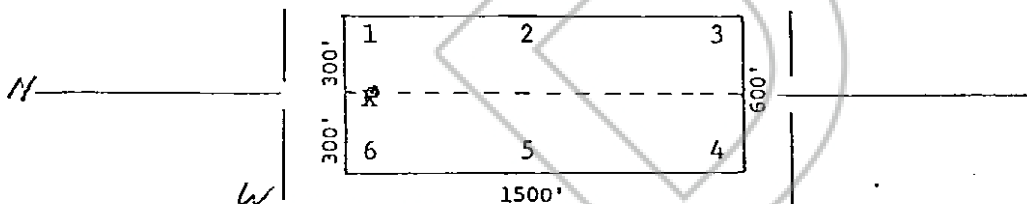

The location work consisted of making the maps as provided in NRS 517.040.

Dated and posted on the ground this 6 day of March, 1980

Witnesses:

Locator:

LYLE F. CAMPBELL
 P.O. Box 7377
 Reno, Nevada 89510

STATE OF NEVADA)

) ss.

COUNTY OF _____)

I hereby certify that the within instrument was filed and recorded at the request of: _____

FILE NO. _____

on _____

at _____

Docket _____

Page _____

M.,

Witness my hand and official seal the day and year aforesaid.

County Recorder

By _____ Deputy Recorder

DPK/jlm 2/1/79 (3)

RECORDED AT REQUEST OF
 American Safety Inc.
 BOOK 81 PAGE 432
 80 MAY 30 A10:38
 DEPUTY RECORDER
 FILE NO. 73820
 FEE \$ 3.00

BOOK 81 PAGE 432

STATE OF NEVADA
 CERTIFICATE OF MINING LOCATION
 LODE CLAIM ON PUBLIC DOMAIN

NOTICE IS HEREBY GIVEN that the Sam No. 67 lode mining claim has been located by Lyle F. Campbell. This claim is a relocation of the Samarkand No. 55 lode mining claim, the certificate of location of which is of record in the office of the recorder of Eureka County, Nevada in Book 22 page 440, in accordance with NRS 517.080. The general course of this claim is North/ South. This claim is 1500 feet in length along the course of the claim, being 1490 feet from the point of discovery in a North direction to the North end line of this claim, and 10 feet in a South direction to the South end line of the claim. This claim is 600 feet in width, being 300 feet in width on each side of the center line of the claim.

This claim is located within the 56 Quarter of Section 8, Township 22 North, Range 51 East, Mount Diablo Base and Meridian, unknown Mining District, Eureka County, Nevada. The location monument of this claim is situated with reference to some natural object or permanent monument as follows: Corner no. 1 of this claim is located approximately 6100 feet N 28° W of the located SE corner of Section 17 T22N, R51E, MDM

The corners of this claim are marked by 4"x4"x5" posts of 4" native timber with metal tags inscribed with the appropriate corner number as shown on the following sketch and the accompanying claim map.

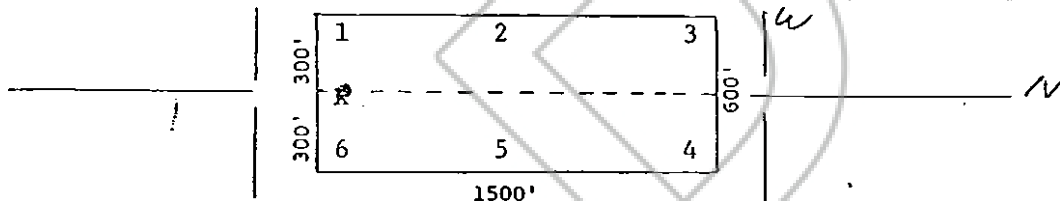

The location work consisted of making the maps as provided in NRS 517.040.

Dated and posted on the ground this 6 day of March, 1980

Witnesses:

Locator:

LYLE F. CAMPBELL
 P.O. Box 7377
 Reno, Nevada 89510

STATE OF NEVADA

COUNTY OF _____

ss.

I hereby certify that the within instrument was filed and recorded at the request of: _____

FILE NO. _____

on _____

at _____

Docket _____

Page _____

M.,

Witness my hand and official seal the day and year aforesaid.

County Recorder

By _____

Deputy Recorder

DPK/jlm 2/1/79 (3)

RECORDED AT REQUEST OF
 American Solar Inc.
 BOOK 81 PAGE 433
 80 MAY 30 AIO: 38
 DEPUTY RECORDER
 FILE NO. 73821
 FILE \$ 3.00

STATE OF NEVADA
 CERTIFICATE OF MINING LOCATION
 LODE CLAIM ON PUBLIC DOMAIN

NOTICE IS HEREBY GIVEN that the Sam No. 68 lode mining claim has been located by Lyle F. Campbell. This claim is a relocation of the Samarkand No. 56 lode mining claim, the certificate of location of which is of record in the office of the recorder of Eureka County, Nevada in Book 22 page 441, in accordance with NRS 517.080. The general course of this claim is North/ South. This claim is 1500 feet in length along the course of the claim, being 10 feet from the point of discovery in a North direction to the North end line of this claim, and 1490 feet in a South direction to the South end line of the claim. This claim is 600 feet in width, being 300 feet in width on each side of the center line of the claim.

This claim is located within the 861 Quarter of Section 8, Township 22 North, Range 51 East, Mount Diablo Base and Meridian, unknown Mining District, Eureka County, Nevada. The location monument of this claim is situated with reference to some natural object or permanent monument as follows: Corner no. 1 of this claim is located approximately 6100 feet N 28° W of the located SE corner of Section 17 T22N, R51E, MDM

The corners of this claim are marked by 4"x4"x5' posts of 4" native timber with metal tags inscribed with the appropriate corner number as shown on the following sketch and the accompanying claim map.

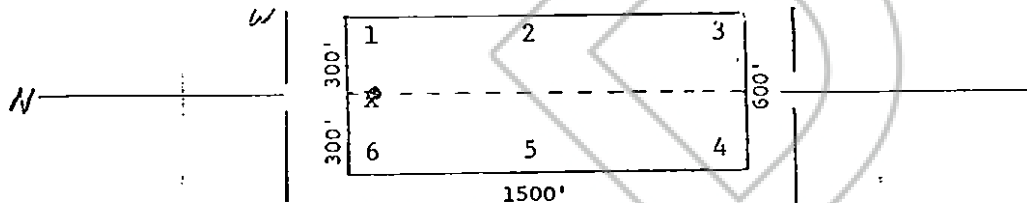

The location work consisted of making the maps as provided in NRS 517.040.

Dated and posted on the ground this 6 day of March, 1980

Witnesses:

Locator:

LYLE F. CAMPBELL
 P.O. Box 7377
 Reno, Nevada 89500

STATE OF NEVADA

COUNTY OF _____

ss.

I hereby certify that the within instrument was filed and recorded at the request of: _____

FILE NO. _____

on _____

at _____

Docket _____

Page _____

M.,

Witness my hand and official seal the day and year aforesaid.

County Recorder

By _____ Deputy Recorder

DPK/jlm 2/1/79 (3)

DEPT. OF CLERK & REC.
 EUREKA COUNTY, N.V.
 FILE NO. 73822
 FEE \$ 3.00

80 MAY 30 AID: 38

RETURNED AT REQUEST OF
 American Sales Inc.
 BOOK 8 L 434

NOTICE IS HEREBY GIVEN that the Sam No. 69 lode mining claim has been located by Lyle F. Campbell. This claim is a relocation of the Samarkand No. 57 lode mining claim; the certificate of location of which is of record in the office of the recorder of Eureka County, Nevada in Book 22 page 442, in accordance with NRS 517.080. The general course of this claim is North/ South. This claim is 1500 feet in length along the course of the claim, being 1490 feet from the point of discovery in a North direction to the North end line of this claim, and 10 feet in a South direction to the South end line of the claim. This claim is 600 feet in width, being 300 feet in width on each side of the center line of the claim.

This claim is located within the SE Quarter of Section 8, Township 22 North, Range 51 East, Mount Diablo Base and Meridian, unknown Mining District, Eureka County, Nevada. The location monument of this claim is situated with reference to some natural object or permanent monument as follows: Corner no. 1 of this claim is located approximately 5600 feet N 19 W of the located SE corner of Section 17 T22N, R51E, MDM

The corners of this claim are marked by 4"x4"x5" posts of native timber with metal tags inscribed with the appropriate corner number as shown on the following sketch and the accompanying claim map.

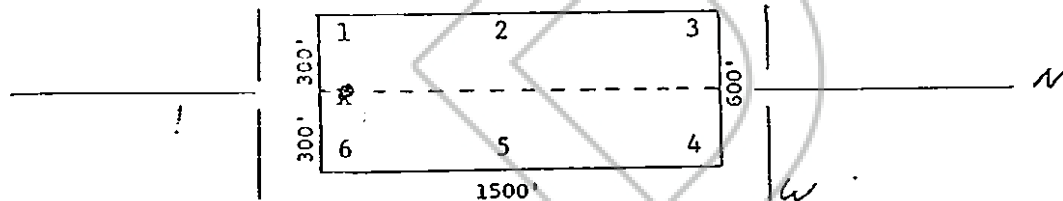

The location work consisted of making the maps as provided in NRS 517.040.

Dated and posted on the ground this 6 day of March, 1980

Witnesses:

Locator:

LYLE F. CAMPBELL
P.O. Box 7377-
Reno, Nevada 89510

STATE OF NEVADA

COUNTY OF _____

ss.

I hereby certify that the within instrument was filed and recorded at the request of: _____

FILE NO. _____
on _____
at _____ M.,
Docket _____ Page _____

Witness my hand and official seal the day and year aforesaid.

County Recorder

By _____
Deputy Recorder

DPK/jlm 2/1/79 (3)

RECORDED AT REQUEST OF
BOOK 81 PAGE 435
80 MAY 30 10:38
DEPUTY RECORDER
FILE NO. 73823
FEE \$ 3.00

BOOK 81 PAGE 435

NOTICE IS HEREBY GIVEN that the Sam No. 70 lode mining claim has been located by Lyle F. Campbell. This claim is a relocation of the Samarkand No. 58 lode mining claim, the certificate of location of which is of record in the office of the recorder of Eureka County, Nevada in Book 22 page 443, in accordance with NRS 517.080. The general course of this claim is North/ South. This claim is 1500 feet in length along the course of the claim, being 10 feet from the point of discovery in a North direction to the North end line of this claim, and 1490 feet in a South direction to the South end line of the claim. This claim is 600 feet in width, being 300 feet in width on each side of the center line of the claim.

This claim is located within the SE Quarter of Section 8, Township 22 North, Range 51 East, Mount Diablo Base and Meridian, unknown Mining District, Eureka County, Nevada. The location monument of this claim is situated with reference to some natural object or permanent monument as follows: Corner no. 1 of this claim is located approximately 5600 feet N 19° W of the located SE corner of Section 17 T22N, R51E, MDM

The corners of this claim are marked by 4" native timber with metal tags inscribed with the appropriate corner number as shown on the following sketch and the accompanying claim map.

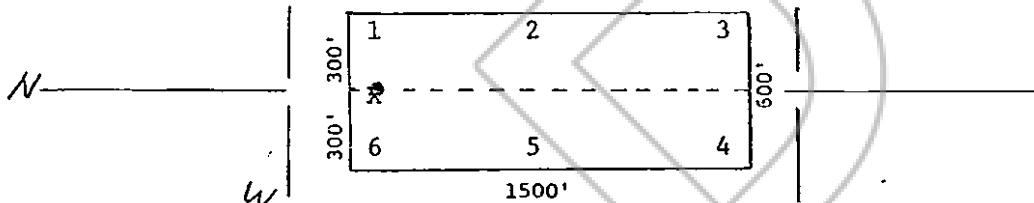

The location work consisted of making the maps as provided in NRS 517.040.

Dated and posted on the ground this 6 day of March, 1980

Witnesses:

Locator:

LYLE F. CAMPBELL
P.O. Box 7377
Reno, Nevada 89510

STATE OF NEVADA)

) ss.

COUNTY OF _____)

I hereby certify that the within instrument was filed and recorded at the request of: _____

FILE NO. _____

on _____

at _____

Docket _____

Page _____

M.,

Witness my hand and official seal the day and year aforesaid.

County Recorder

By _____

Deputy Recorder

OFFICE OF THE COUNTY RECORDER
EUREKA COUNTY, NEVADA
FILE NO. 73824
FEB 23 3 00 PM '80

80 MAY 30 AIO: 38

RECORDED AT REQUEST OF
American Sales Inc.
BOOK 81 PAGE 436

DPK/jlm 2/1/79 (3)

STATE OF NEVADA
 CERTIFICATE OF MINING LOCATION
 LODE CLAIM ON PUBLIC DOMAIN

NOTICE IS HEREBY GIVEN that the Sam No. 71 lode mining claim has been located by Lyle F. Campbell. This claim is a relocation of the Samarkand No. 59 lode mining claim, the certificate of location of which is of record in the office of the recorder of Eureka County, Nevada in Book 22 page 444, in accordance with NRS 517.080. The general course of this claim is North/ South. This claim is 1500 feet in length along the course of the claim, being 1490 feet from the point of discovery in a North direction to the North end line of this claim, and 10 feet in a South direction to the South end line of the claim. This claim is 600 feet in width, being 300 feet in width on each side of the center line of the claim.

This claim is located within the SE Quarter of Section 8, Township 22 North, Range 51 East, Mount Diablo Base and Meridian, unknown Mining District, Eureka County, Nevada. The location monument of this claim is situated with reference to some natural object or permanent monument as follows: Corner no. 1 of this claim is located approximately 5600 feet N 19° W of the located SE corner of Section 17 T22N, R51E, MDM

The corners of this claim are marked by 4"x4"x5" posts of native timber with metal tags inscribed with the appropriate corner number as shown on the following sketch and the accompanying claim map.

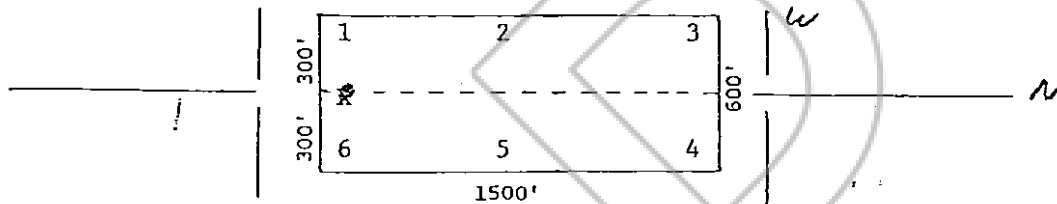

The location work consisted of making the maps as provided in NRS 517.040.

Dated and posted on the ground this 6 day of March, 1980

Witnesses:

Locator:

LYLE F. CAMPBELL
 P.O. Box 7377
 Reno, Nevada 89510

STATE OF NEVADA

COUNTY OF _____

) ss.

I hereby certify that the within instrument was filed and recorded at the request of:

FILE NO. _____
 on _____
 at _____ M.,
 Docket _____ Page _____

Witness my hand and official seal the day and year aforesaid.

County Recorder

By _____
 Deputy Recorder

DPK/jlm 2/1/79 (3)

BOOK 81 PAGE 437

OFFICE OF THE COUNTY RECORDER
 EUREKA, NEVADA
 WILLIS A. DEWITT, RECORDER
 FILE NO. 73825
 FEES \$3.00

80 MAY 30 AIO: 38

RECORDED AT REQUEST OF
 American Sales, Inc.
 BOOK 81 PAGE 437

STATE OF NEVADA
 CERTIFICATE OF MINING LOCATION
 LOSE CLAIM ON PUBLIC DOMAIN

NOTICE IS HEREBY GIVEN that the Sam No. 7.2 lode mining claim has been located by Lyle F. Campbell. This claim is a relocation of the Samarkand No. 60 lode mining claim, the certificate of location of which is of record in the office of the recorder of Eureka County, Nevada in Book 22 page 445, in accordance with NRS 517.080. The general course of this claim is North/ South. This claim is 1500 feet in length along the course of the claim, being 10 feet from the point of discovery in a North direction to the North end line of this claim, and 1490 feet in a South direction to the South end line of the claim. This claim is 600 feet in width, being 300 feet in width on each side of the center line of the claim.

This claim is located within the SE Quarter of Section 8, Township 22 North, Range 51 East, Mount Diablo Base and Meridian, unknown Mining District, Eureka County, Nevada. The location monument of this claim is situated with reference to some natural object or permanent monument as follows: Corner no. 1 of this claim is located approximately 500 feet N 19 W of the located SE corner of Section 17 T22N, R51E, MDM

The corners of this claim are marked by 4"x4"x5" posts of 4" native timber with metal tags inscribed with the appropriate corner number as shown on the following sketch and the accompanying claim map.

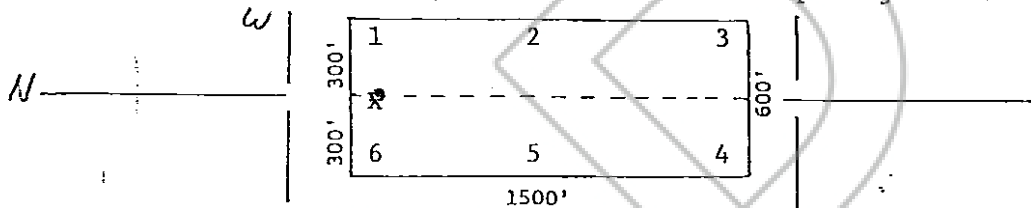

The location work consisted of making the maps as provided in NRS 517.040.

Dated and posted on the ground this 6 day of March, 1980

Witnesses:

Locator:

LYLE F. CAMPBELL
 P.O. Box 7377
 Reno, Nevada 89510

STATE OF NEVADA

COUNTY OF _____

I hereby certify that the within instrument was filed and recorded at the request of: _____

FILE NO. _____
 on _____
 at _____ M.,
 Docket _____ Page _____

Witness my hand and official seal the day and year aforesaid.

County Recorder

By _____
 Deputy Recorder

DPK/jlm 2/1/79 (3)

RECORDED AT REQUEST OF
 American Sales, Inc.
 BOOK 81 PAGE 438
 80 MAY 30 AIO:38
 WILL ALBERTSON
 73826
 3.00

NOTICE IS HEREBY GIVEN that the Sam No. 73 lode mining claim has been located by Lyle F. Campbell. This claim is a relocation of the Samarkand No. 61 lode mining claim, the certificate of location of which is of record in the office of the recorder of Eureka County, Nevada in Book 22 page 446, in accordance with NRS 517.080. The general course of this claim is North/South. This claim is 1500 feet in length along the course of the claim, being 1490 feet from the point of discovery in a North direction to the North end line of this claim, and 10 feet in a South direction to the South end line of the claim. This claim is 600 feet in width, being 300 feet in width on each side of the center line of the claim.

This claim is located within the SE Quarter of Section 8, Township 22 North, Range 51 East, Mount Diablo Base and Meridian, unknown Mining District, Eureka County, Nevada. The location monument of this claim is situated with reference to some natural object or permanent monument as follows: Corner no. 1 of this claim is located approximately 5400 feet N 7 W of the located SE corner of Section 17 T22N, R51E, MDM

The corners of this claim are marked by 4"x4"x5" posts of 4" native timber with metal tags inscribed with the appropriate corner number as shown on the following sketch and the accompanying claim map.

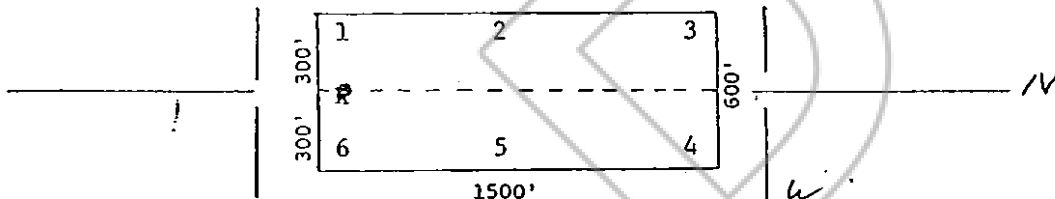

The location work consisted of making the maps as provided in NRS 517.040.

Dated and posted on the ground this 7 day of March, 1980

Witnesses:

Locator:

LYLE F. CAMPBELL
P.O. Box 7377
Reno, Nevada, 89510

STATE OF NEVADA)

) ss.

COUNTY OF _____)

I hereby certify that the within instrument was filed and recorded at the request of: _____

FILE NO. _____

on _____

at _____

Docket _____

Page _____

M.,

Witness my hand and official seal the day and year aforesaid.

County Recorder

By _____

Deputy Recorder

DPK/jlm 2/1/79 (3)

STATE OF NEVADA
 CERTIFICATE OF MINING LOCATION
 LODE CLAIM ON PUBLIC DOMAIN

NOTICE IS HEREBY GIVEN that the Sam No. 74 lode mining claim has been located by Lyle F. Campbell. This claim is a relocation of the Samarkand No. 62 lode mining claim, the certificate of location of which is of record in the office of the recorder of Eureka County, Nevada in Book 22 page 447, in accordance with NRS 517.080. The general course of this claim is North/South. This claim is 1500 feet in length along the course of the claim, being 10 feet from the point of discovery in a North direction to the North end line of this claim, and 1490 feet in a South direction to the South end line of the claim. This claim is 600 feet in width, being 300 feet in width on each side of the center line of the claim.

This claim is located within the SE Quarter of Section 8, Township 22 North, Range 51 East, Mount Diablo Base and Meridian, unknown Mining District, Eureka County, Nevada. The location monument of this claim is situated with reference to some natural object or permanent monument as follows: Corner no. 1 of this claim is located approximately 5400 feet N 7 W of the located SE corner of Section 17 T22N, R51E, MDM

The corners of this claim are marked by 4"x4"x5" posts of 4" native timber with metal tags inscribed with the appropriate corner number as shown on the following sketch and the accompanying claim map.

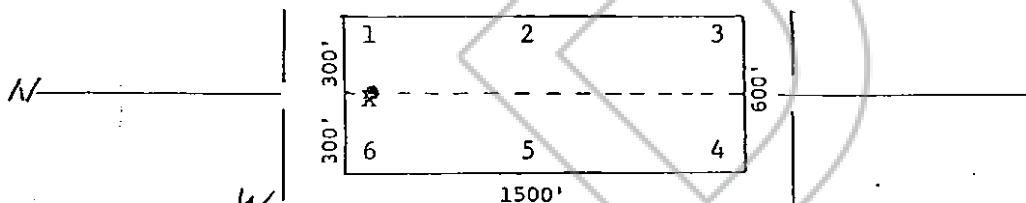

The location work consisted of making the maps as provided in NRS 517.040.

Dated and posted on the ground this 7 day of March, 1980

Witnesses:

Locator:

LYLE F. CAMPBELL
 P.O. Box 7377
 Reno, Nevada 89510

STATE OF NEVADA)

) ss.

COUNTY OF _____)

I hereby certify that the within instrument was filed and recorded at the request of: _____

FILE NO. _____

on _____

at _____

Docket _____

Page _____

Witness my hand and official seal the day and year aforesaid.

County Recorder

By _____

Deputy Recorder

DPK/jlm 2/1/79 (3)

RECORDED AT REQUEST OF
 American Sales Inc.
 BOOK 81 PAGE 440
 MAY 30 AIO: 38
 OFFICE OF THE COUNTY CLERK
 EUREKA COUNTY, NEVADA
 WILLIS A. LEBER
 FILE NO. 73828
 FEE \$ 3.00

STATE OF NEVADA
 CERTIFICATE OF MINING LOCATION
 LODE CLAIM ON PUBLIC DOMAIN

NOTICE IS HEREBY GIVEN that the Sam No. 75 lode mining claim has been located by Lyle F. Campbell. This claim is a relocation of the Samarkand No. 63 lode mining claim, the certificate of location of which is of record in the office of the recorder of Eureka County, Nevada in Book 22 page 448, in accordance with NRS 517.080. The general course of this claim is North/South. This claim is 1500 feet in length along the course of the claim, being 1490 feet from the point of discovery in a North direction to the North end line of this claim, and 10 feet in a South direction to the South end line of the claim. This claim is 600 feet in width, being 300 feet in width on each side of the center line of the claim.

This claim is located within the SE Quarter of Section 8, Township 22 North, Range 51 East, Mount Diablo Base and Meridian, unknown Mining District, Eureka County, Nevada. The location monument of this claim is situated with reference to some natural object or permanent monument as follows: Corner no. 1 of this claim is located approximately 5400 feet N 7 W of the located SE corner of Section 17 T22N, R51E, MDM

The corners of this claim are marked by 4"x4"x5" posts of 4" native timber with metal tags inscribed with the appropriate corner number as shown on the following sketch and the accompanying claim map.

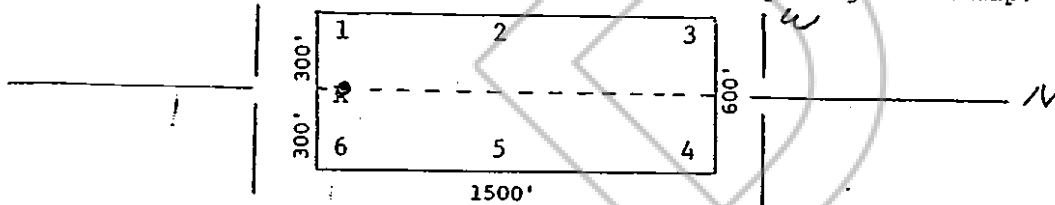

The location work consisted of making the maps as provided in NRS 517.040.

Dated and posted on the ground this 7 day of March, 1980

Witnesses:

Locator:

LYLE F. CAMPBELL
 P.O. Box 7377-
 Reno, Nevada 89510

STATE OF NEVADA

COUNTY OF _____

ss.

I hereby certify that the within instrument was filed and recorded at the request of:

FILE NO. _____
 on _____
 at _____ M.,
 Docket _____ Page _____

Witness my hand and official seal the day and year aforesaid.

County Recorder

By _____
 Deputy Recorder

DPK/jlm 2/1/79 (3)

RECORDED AT REQUEST OF
 American Sales, Inc.
 BOOK 81 PAGE 441
 80 MAY 30 AIO:38
 DEPT. OF REVENUE
 EUREKA COUNTY, NEVADA
 WILLIS A. LEE, RECORDER
 FILE NO. 73829
 REC. 3.00

BOOK 81 PAGE 441

STATE OF NEVADA
 CERTIFICATE OF MINING LOCATION
 LOSE CLAIM ON PUBLIC DOMAIN

NOTICE IS HEREBY GIVEN that the Sam No. 76 lode mining claim has been located by Lyle F. Campbell. This claim is a relocation of the Samarkand No. 64 lode mining claim, the certificate of location of which is of record in the office of the recorder of Eureka County, Nevada in Book 22 page 449, in accordance with NRS 517.080. The general course of this claim is North/South. This claim is 1500 feet in length along the course of the claim, being 10 feet from the point of discovery in a North direction to the North end line of this claim, and 1490 feet in a South direction to the South end line of the claim. This claim is 600 feet in width, being 300 feet in width on each side of the center line of the claim.

This claim is located within the SE Quarter of Section 8, Township 22 North, Range 51 East, Mount Diablo Base and Meridian, unknown Mining District, Eureka County, Nevada. The location monument of this claim is situated with reference to some natural object or permanent monument as follows: Corner no. 1 of this claim is located approximately 5400 feet N 7 W of the located SE corner of Section 17 T22N, R51E, MDM

The corners of this claim are marked by 4"x4"x5" posts of native timber with metal tags inscribed with the appropriate corner number as shown on the following sketch and the accompanying claim map.

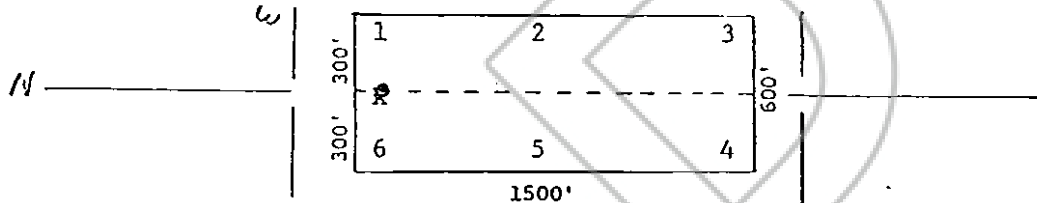

The location work consisted of making the maps as provided in NRS 517.040.

Dated and posted on the ground this 7 day of March, 1980

Witnesses:

Locator:

LYLE F. CAMPBELL
 P.O. Box 7377
 Reno, Nevada 89510

STATE OF NEVADA

COUNTY OF _____

) ss.

I hereby certify that the within instrument was filed and recorded at the request of: _____

FILE NO. _____

on _____

at _____

Docket _____

Page _____

M.,

Witness my hand and official seal the day and year aforesaid.

County Recorder

By _____

Deputy Recorder

DPK/jlm 2/1/79 (3)

BOOK 81 PAGE 442

RECORDED
 MAY 30 1980
 73830

80 MAY 30 A/D: 3

RECEIVED
 American Salt, Inc.
 8/1/80

STATE OF NEVADA
 CERTIFICATE OF MINING LOCATION
 LORE CLAIM ON PUBLIC DOMAIN

NOTICE IS HEREBY GIVEN that the Sam No. 77 lode mining claim has been located by Lyle F. Campbell. This claim is a relocation of the Oxy No. 66 lode mining claim, the certificate of location of which is of record in the office of the recorder of Eureka County, Nevada in Book 36 page 223, in accordance with NRS 517.080. The general course of this claim is North/ South. This claim is 1500 feet in length along the course of the claim, being 1490 feet from the point of discovery in a North direction to the North end line of this claim, and 10 feet in a South direction to the South end line of the claim. This claim is 600 feet in width, being 300 feet in width on each side of the center line of the claim.

This claim is located within the SW Quarter of Section 9, Township 22 North, Range 51 East, Mount Diablo Base and Meridian, unknown Mining District, Eureka County, Nevada. The location monument of this claim is situated with reference to some natural object or permanent monument as follows: Corner no. 1 of this claim is located approximately 5690 feet N 7° E of the located SE corner of Section 17 T22N, R51E, MDM

The corners of this claim are marked by 4"x4"x5' posts of native timber with metal tags inscribed with the appropriate corner number as shown on the following sketch and the accompanying claim map.

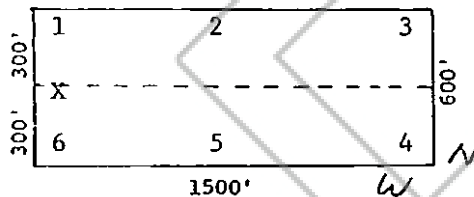

The location work consisted of making the maps as provided in NRS 517.040.

Dated and posted on the ground this 7 day of March, 1980

Witnesses:

Locator:

LYLE F. CAMPBELL
 P.O. Box 7377
 Reno, Nevada 89510

STATE OF NEVADA

COUNTY OF _____

ss.

I hereby certify that the within instrument was filed and recorded at the request of: _____

FILE NO. _____

on _____

at _____

Docket _____

Page _____

M.,

Witness my hand and official seal the day and year aforesaid.

County Recorder

By _____

Deputy Recorder

DPK/jlm 2/1/79 (3)

RECORDED AT REQUEST OF
 American Sales Inc.
 BOOK 81 PAGE 443
 80 MAY 30 AIO: 38
 DEPT. OF REVENUE
 EUREKA COUNTY, NEVADA
 FILE NO. 73831
 FILE 3-22

BOOK 81 PAGE 443

STATE OF NEVADA
 CERTIFICATE OF MINING LOCATION
 LOSE CLAIM ON PUBLIC DOMAIN

NOTICE IS HEREBY GIVEN that the Sam No. 78 lode mining claim has been located by Lyle F. Campbell. This claim is a relocation of the Oxy No. 65 lode mining claim, the certificate of location of which is of record in the office of the recorder of Eureka County, Nevada in Book 36 page 222, in accordance with NRS 517.080. The general course of this claim is North/ South. This claim is 1500 feet in length along the course of the claim, being 10 feet from the point of discovery in a North direction to the North end line of this claim, and 1490 feet in a South direction to the South end line of the claim. This claim is 600 feet in width, being 300 feet in width on each side of the center line of the claim.

This claim is located within the 50 Quarter of Section 9, Township 22 North, Range 51 East, Mount Diablo Base and Meridian, unknown Mining District, Eureka County, Nevada. The location monument of this claim is situated with reference to some natural object or permanent monument as follows: Corner no. 1 of this claim is located approximately 5690 feet N 7° E of the located SE corner of Section 17 T22N, R51E, MDM

The corners of this claim are marked by 4"x4"x5" posts of 4" native timber with metal tags inscribed with the appropriate corner number as shown on the following sketch and the accompanying claim map.

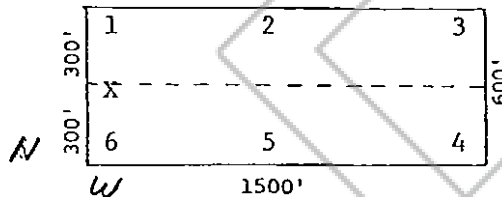

The location work consisted of making the maps as provided in NRS 517.040.

Dated and posted on the ground this 7 day of March, 1980

Witnesses:

Locator:

LYLE F. CAMPBELL
 P.O. Box 7377
 Reno, Nevada 89510

STATE OF NEVADA

COUNTY OF _____

ss.

I hereby certify that the within instrument was filed and recorded at the request of: _____

FILE NO. _____
 on _____
 at _____ M.,
 Docket _____ Page _____

Witness my hand and official seal the day and year aforesaid.

County Recorder

By _____
 Deputy Recorder

80 MAY 30 AIO: 38

OFFICIAL SEAL OF
 EUREKA COUNTY, NEVADA
 WILLIS E. CAMPBELL
 RECORDER
 FILE NO. 73832
 BOOK 36

RECORDED AT REQUEST OF
 American Sales, Inc.
 BOOK 81 PAGE 444

DPK/jlm 2/1/79 (3)

STATE OF NEVADA
 CERTIFICATE OF MINING LOCATION
 LODE CLAIM ON PUBLIC DOMAIN

NOTICE IS HEREBY GIVEN that the Sam No. 79 lode mining claim has been located by Lyle F. Campbell. This claim is a relocation of the Oxy No. 67 lode mining claim, the certificate of location of which is of record in the office of the recorder of Eureka County, Nevada in Book 36 page 224, in accordance with NRS 517.080. The general course of this claim is North/South. This claim is 1500 feet in length along the course of the claim, being 1490 feet from the point of discovery in a North direction to the North end line of this claim, and 10 feet in a South direction to the South end line of the claim. This claim is 600 feet in width, being 300 feet in width on each side of the center line of the claim.

This claim is located within the SW Quarter of Section 9, Township 22 North, Range 51 East, Mount Diablo Base and Meridian, unknown Mining District, Eureka County, Nevada. The location monument of this claim is situated with reference to some natural object or permanent monument as follows: Corner no. 1 of this claim is located approximately 5.90 feet N 7 E of the located SE corner of Section 17 T22N, R51E, MDM

The corners of this claim are marked by 4"x4"x5" posts of 4" native timber with metal tags inscribed with the appropriate corner number as shown on the following sketch and the accompanying claim map.

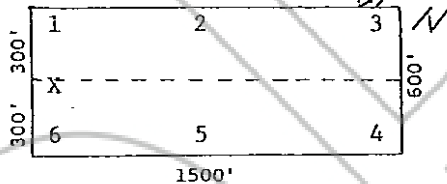

The location work consisted of making the maps as provided in NRS 517.040.

Dated and posted on the ground this 7 day of March, 1980

Witnesses:

Locator:

LYLE F. CAMPBELL
 P.O. Box 7377
 Reno, Nevada 89510

STATE OF NEVADA)

) ss.

COUNTY OF _____)

I hereby certify that the within instrument was filed and recorded at the request of: _____

FILE NO. _____

on _____

at _____

Docket _____ Page _____ M.,

Witness my hand and official seal the day and year aforesaid.

County Recorder

By _____ Deputy Recorder

DPK/jlm 2/1/79 (3)

CERTIFICATE OF MINING LOCATION
LODE CLAIM ON PUBLIC DOMAIN

NOTICE IS HEREBY GIVEN that the Sam No. 80 lode mining claim has been located by Lyle F. Campbell. This claim is a relocation of the Oxy No. 64 lode mining claim, the certificate of location of which is of record in the office of the recorder of Eureka County, Nevada in Book 36 page 221, in accordance with NRS 517.080. The general course of this claim is North/ South. This claim is 1500 feet in length along the course of the claim, being 10 feet from the point of discovery in a North direction to the North end line of this claim, and 1490 feet in a South direction to the South end line of the claim. This claim is 600 feet in width, being 300 feet in width on each side of the center line of the claim.

This claim is located within the SW Quarter of Section 9, Township 22 North, Range 51 East, Mount Diablo Base and Meridian, unknown Mining District, Eureka County, Nevada. The location monument of this claim is situated with reference to some natural object or permanent monument as follows: Corner no. 1 of this claim is located approximately 5690 feet N 7° E of the located SE corner of Section 17 T22N, R51E, MDM

The corners of this claim are marked by 4"x4"x5" posts of 4" native timber with metal tags inscribed with the appropriate corner number as shown on the following sketch and the accompanying claim map.

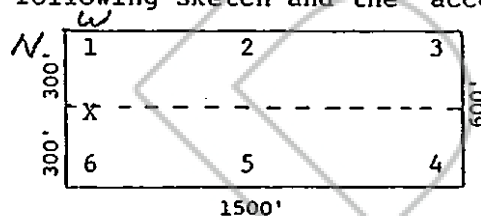

The location work consisted of making the maps as provided in NRS 517.040.

Dated and posted on the ground this 7 day of March, 1980

Witnesses:

Locator:

LYLE F. CAMPBELL
P.O. Box 7377
Reno, Nevada 89510

STATE OF NEVADA)

) ss.

COUNTY OF _____)

I hereby certify that the within instrument was filed and recorded at the request of:

FILE NO. _____
on _____
at _____ M.,
Docket _____ Page _____

Witness my hand and official seal the day and year aforesaid.

County Recorder

By _____
Deputy Recorder

DPK/jlm 2/1/79 (3)

RECEIVED AT REQUEST OF
HARRISON, Sisco, Inc.
BOOK 81 PAGE 446
FILE 53.00
EUREKA COUNTY, NEVADA
FILE NO. 73834
JAN 30 1980

80 MAY 30 AM 10:39

BOOK 81 PAGE 446

STATE OF NEVADA
 CERTIFICATE OF MINING LOCATION
 LORE CLAIM ON PUBLIC DOMAIN

NOTICE IS HEREBY GIVEN that the Sam No. 81 lode mining claim has been located by Lyle F. Campbell. This claim is a relocation of the Oxy No. 68 lode mining claim; the certificate of location of which is of record in the office of the recorder of Eureka County, Nevada in Book 36 page 225, in accordance with NRS 517.080. The general course of this claim is North/ South. This claim is 1500 feet in length along the course of the claim, being 1490 feet from the point of discovery in a North direction to the North end line of this claim, and 10 feet in a South direction to the South end line of the claim. This claim is 600 feet in width, being 300 feet in width on each side of the center line of the claim.

This claim is located within the SW Quarter of Section 9, Township 22 North, Range 51 East, Mount Diablo Base and Meridian, unknown Mining District, Eureka County, Nevada. The location monument of this claim is situated with reference to some natural object or permanent monument as follows: Corner no. 1 of this claim is located approximately 5970 feet N 18 E of the located SE corner of Section 17 T22N, R51E, MDM

The corners of this claim are marked by 4"x4"x5" posts of 4" native timber with metal tags inscribed with the appropriate corner number as shown on the following sketch and the accompanying claim map.

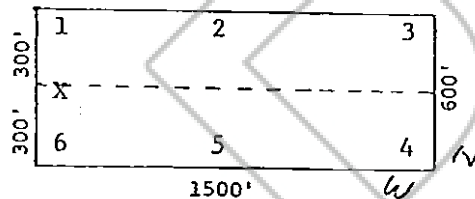

The location work consisted of making the maps as provided in NRS 517.040.

Dated and posted on the ground this 7 day of March, 1980

Witnesses:

Locator:

LYLE F. CAMPBELL
 P.O. Box 7377
 Reno, Nevada 89510

STATE OF NEVADA)

) ss.

COUNTY OF _____)

I hereby certify that the within instrument was filed and recorded at the request of: _____

FILE NO. _____

on _____

at _____

Docket _____

Page _____

M.,

Witness my hand and official seal the day and year aforesaid.

County Recorder

By _____

Deputy Recorder

DPK/jlm 2/1/79 (3)

RECEIVED
 EUREKA COUNTY RECORDER
 FILE NO. 73835
 FEB 2 1980

80 MAY 30 AIO: 39

RECEIVED
 EUREKA COUNTY RECORDER
 BOOK 81 PAGE 447

STATE OF NEVADA
 CERTIFICATE OF MINING LOCATION
 LODE CLAIM ON PUBLIC DOMAIN

NOTICE IS HEREBY GIVEN that the Sam No. 82 lode mining claim has been located by Lyle F. Campbell. This claim is a relocation of the Oxy No. 63 lode mining claim, the certificate of location of which is of record in the office of the recorder of Eureka County, Nevada in Book 36 page 220, in accordance with NRS 517.080. The general course of this claim is North/South. This claim is 1500 feet in length along the course of the claim, being 10 feet from the point of discovery in a North direction to the North end line of this claim, and 1490 feet in a South direction to the South end line of the claim. This claim is 600 feet in width, being 300 feet in width on each side of the center line of the claim.

This claim is located within the SE 1/4 Quarter of Section 9, Township 22 North, Range 51 East, Mount Diablo Base and Meridian, unknown Mining District, Eureka County, Nevada. The location monument of this claim is situated with reference to some natural object or permanent monument as follows: Corner no. 1 of this claim is located approximately 5970 feet N 18 E of the located SE corner of Section 17 T22N, R51E, MDM

The corners of this claim are marked by 4"x4"x5" posts of 4" native timber with metal tags inscribed with the appropriate corner number as shown on the following sketch and the accompanying claim map.

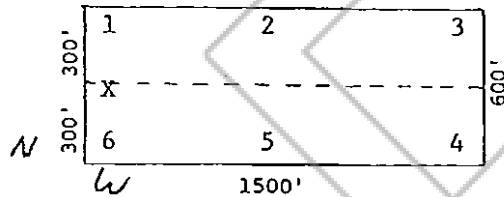

The location work consisted of making the maps as provided in NRS 517.040.

Dated and posted on the ground this 7 day of March, 1980

Witnesses:

Locator:

LYLE F. CAMPBELL
 P.O. Box 7377
 Reno, Nevada 89510

STATE OF NEVADA

COUNTY OF _____

ss.

I hereby certify that the within instrument was filed and recorded at the request of: _____

FILE NO. _____

on _____

at _____

Docket _____

Page _____

M.,

Witness my hand and official seal the day and year aforesaid.

County Recorder

By _____
 Deputy Recorder

DPK/jlm 2/1/79 (3)

RECORDED AT REQUEST OF
 American Sales, Inc.
 BOOK 81 PAGE 448
 MAY 30 10:39
 DEPUTY RECORDER
 FILE NO. 73836
 REELS 3.00

BOOK 81 PAGE 448