

STATE OF NEVADA
 CERTIFICATE OF MINING LOCATION
 LOSE CLAIM ON PUBLIC DOMAIN

NOTICE IS HEREBY GIVEN that the Sam No. 13 lode mining claim has been located by Lyle F. Campbell. This claim is a relocation of the Samarkand No. 13 lode mining claim, the certificate of location of which is of record in the office of the recorder of Eureka County, Nevada in Book 22 page 398, in accordance with NRS 517.080. The general course of this claim is North/ South. This claim is 1500 feet in length along the course of the claim, being 1490 feet from the point of discovery in a North direction to the North end line of this claim, and 10 feet in a South direction to the South end line of the claim. This claim is 600 feet in width, being 300 feet in width on each side of the center line of the claim.

This claim is located within the NE Quarter of Section 5, Township 22 North, Range 51 East, Mount Diablo Base and Meridian, unknown Mining District, Eureka County, Nevada. The location monument of this claim is situated with reference to some natural object or permanent monument as follows: Corner no. 1 of this claim is located approximately 19400 feet N 2 W of the located SE corner of Section 17 T22N, R51E, MDM

The corners of this claim are marked by 4"x4"x5" posts of native timber with metal tags inscribed with the appropriate corner number as shown on the following sketch and the accompanying claim map.

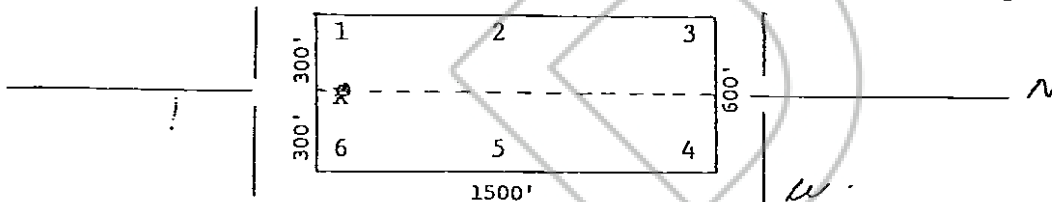

The location work consisted of making the maps as provided in NRS 517.040.

Dated and posted on the ground this 7 day of March, 1980

Witnesses:

Locator:

LYLE F. CAMPBELL
 P.O. Box 7377-
 Reno, Nevada 89510

STATE OF NEVADA

COUNTY OF _____

ss.

I hereby certify that the within instrument was filed and recorded at the request of:

FILE NO. _____
 on _____
 at _____ M.,
 Docket _____ Page _____

Witness my hand and official seal the day and year aforesaid.

County Recorder

By _____
 Deputy Recorder

DPK/jlm 2/1/79 (3)

RECORDED
 FILED
 MAY 30 1980
 73767
 300

RECORDED
 FILED
 MAY 30 1980
 73767
 300