

All Claims Are Staked As Below

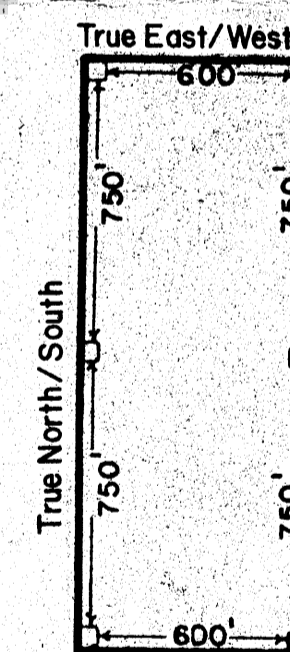

Filed  
 RECORDED AT THE REQUEST OF *American Selco, Inc.*  
 on *May 30*, 1980, at 39 mins. past 10 A.M. in  
 Book \_\_\_\_\_ of OFFICIAL RECORDS, page \_\_\_\_\_, RECORDS OF  
 EUREKA COUNTY, NEVADA. WILLIS A. DePAOLI, Recorder  
 File No. **73837** Fee \$ *16.40*.00

## AMERICAN SELCO INC.

Claim map for Sam 1 thru 83  
 Unpatented mining claims  
 Located in surveyed Sec. 4, 5, 8, 9, 16, 17, T22N, R51E,  
 MDM  
 Eureka County, Nevada  
 The S.E. corner of Sam 76 is located approximately 4050'  
 N1/4 of the located S.W. corner Sec. 17, T22N, R51E, MDM  
 Claims located by: Lyle F. Campbell  
 P.O. Box 7377  
 Reno, Nevada 89510  
 Dated and posted on the ground on  
 March 6, 7 1980  
 All claims measure 600' x 1500'  
 All corners are marked by 4" x 4" posts or 4" trees  
 Scale: 1" = 500'