

75535

STATE OF NEVADA
 CERTIFICATE OF MINING LOCATION
 LODE CLAIM ON PUBLIC DOMAIN

NOTICE IS HEREBY GIVEN that the Twin No. 7
 lode mining claim has been located by AMERICAN SELCO INC.
 a New York corporation, whose address is 99 West Grove Street,
Suite 100, Reno, Nevada 89509. The general course of this claim
 is North/South. This claim is 1500 feet in length
 along the course of the claim, being 10 feet from the point
 of discovery in a North direction to the North end
 line of this claim, and 1490 feet in a South
 direction to the South end line of the claim. This claim is
600 feet in width, being 300 feet in width on each side of the
 center line of the claim.

This claim is located within the SW Quarter
 of Section 36, Township 19 North, Range 49
East, Mount Diablo Base and Meridian, unknown Mining District
Eureka County, Nevada. The location monument of this claim is
 situated with reference to some natural object or permanent monument
 as follows: Corner no. 1 of this claim is located approximately 2400
feet N SO E from the located SW corner section 36 T19N R49E MDM

The corners of this claim are marked by 4"x4" posts or 4" trees
 with metal tags inscribed with the appropriate corner number as
 shown on the following sketch and the accompanying claim map.

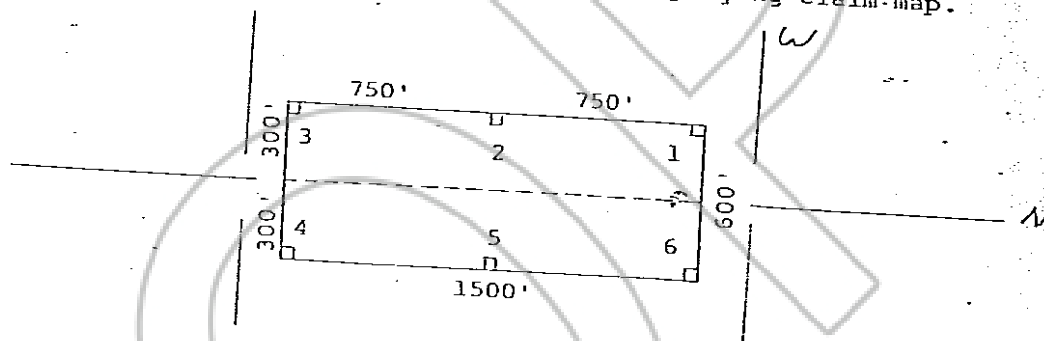

The location work consisted of making the maps as provided in
 NRS 517.040.

Dated and posted on the ground this 22 day of May,
 19 80)

Witnesses:

Locator:

AMERICAN SELCO INC.

By:

Agent for
American Selco Inc.

STATE OF NEVADA)

COUNTY OF _____) ss.

I hereby certify that the within
 instrument was filed and recorded at
 the request of: _____

FILE NO. _____

on _____

at _____

Docket _____

Page _____

RECORDED AT REQUEST OF
American Selco Inc.
 BOOK 85 PAGE 193
 80 AUG 22 11:25
 CLERK OF COUNTY CLERK
 WILLIAM A. BROWN
 FILE NO. 25535
 FEE \$3.00