

75542

STATE OF NEVADA
CERTIFICATE OF MINING LOCATION
LODE CLAIM ON PUBLIC DOMAIN

NOTICE IS HEREBY GIVEN that the Twin No. 14
lode mining claim has been located by AMERICAN SELCO INC.
a New York corporation, whose address is 99 West Grove Street,
Suite 100, Reno, Nevada 89509. The general course of this claim
is North/South. This claim is 1500 feet in length
along the course of the claim, being 1490 feet from the point
of discovery in a North direction to the North end
line of this claim, and 10 feet in a South
direction to the South end line of the claim. This claim is
600 feet in width, being 300 feet in width on each side of the
center line of the claim.

This claim is located within the SE Quarter
of Section 36, Township 19 North, Range 49
East, Mount Diablo Base and Meridian, unknown Mining District,
Eureka County, Nevada. The location monument of this claim is
situated with reference to some natural object or permanent monument
as follows: Corner no. 1 of this claim is located approximately 4500
feet N 70° E from the located SW corner section 36 T19N R49E MDM.

The corners of this claim are marked by 4"x4" posts or 4" trees
with metal tags inscribed with the appropriate corner number as
shown on the following sketch and the accompanying claim-map.

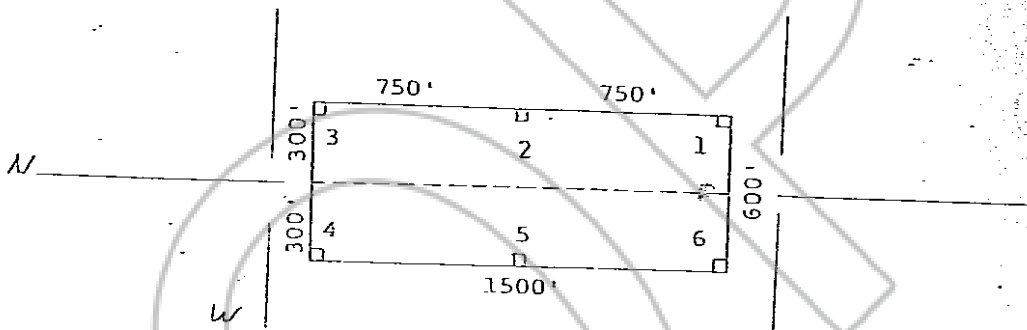

The location work consisted of making the maps as provided in
NRS 517.040.

Dated and posted on the ground this 28 day of May,
19 80

Witnesses:

Locator:

AMERICAN SELCO INC.

By [Signature]
Agent for
American Selco Inc.

STATE OF NEVADA)
) ss.
COUNTY OF _____)

I hereby certify that the within
instrument was filed and recorded at
the request of: _____
FILE NO. _____
on _____
at _____
Docket _____ Page _____

RECORDED AT REQUEST OF
American Selco, Inc.
BOOK 85 PAGE 200
80 AUG 22 11:28
OFFICIAL REGISTRAR
EUREKA COUNTY NEVADA
WILLIAM A. DEPAULI-REGISTRAR
FILE NO. 75542
Fees \$ 30.00

BOOK 85 PAGE 200