

STATE OF NEVADA
77035 CERTIFICATE OF MINING LOCATION
LODE CLAIM ON PUBLIC DOMAIN

NOTICE IS HEREBY GIVEN that Afgan No. 1 lode mining claim has been located by American Selco, a New York corporation, whose address 90 West Grove Street, Suite 100, Reno, Nevada 89509. This claim is a relocation of the Afgan No. 1 lode mining claim, the certificate of location of which is of record in the office of the recorder of Eureka County, Nevada in Book 81 Page 449, in accordance with NRS 517.080. The general course of this claim is East/West. This claim is 1500 feet in length along the course of the claim, being 10 feet from the point of discovery in an East direction to the East end line of this claim, and 1490 feet in a West direction to the West end line of the claim. This claim is 600 feet in width, being 300 feet in width on each side of the center line of the claim.

This claim is located within the SW Quarter of Section 17, Township 22 North, Range 51 East Mount Diablo Base and Meridian, unknown Mining District, Eureka County, Nevada. The location monument of this claim is situated with reference to some natural object or permanent monument as follows: Corner No. 1 of this claim is located approximately 4400 feet N65°W from the located SE corner of Section 17, T22N, R51 E, MDM.

The corners of this claim are marked by 4" x 4" posts or pipe with metal tags inscribed with the appropriate corner number as shown on the following sketch and the accompanying claim map.

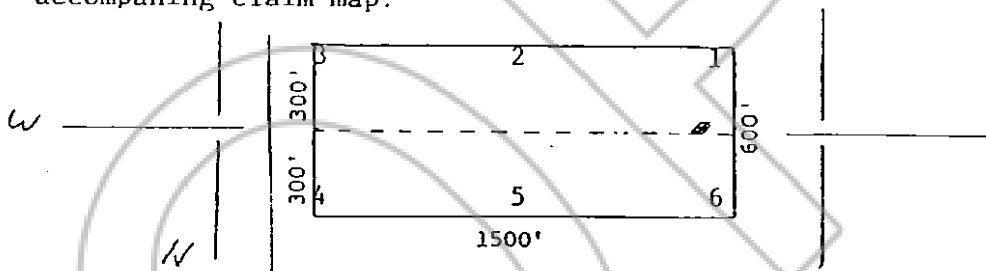

The location work consisted of making the maps provided in NRS 517.040.

Dated and posted on the ground this 22 day of July, 1980.

Witnesses:

Locator:

AMERICAN SELCO INC.

By

Jim Rice
Agent for
AMERICAN SELCO INC.

STATE OF NEVADA)
COUNTY OF _____) ss.

I hereby certify that the within instrument was filed and recorded at the request of : _____
FILE NO. _____
on _____
at _____
Docket _____ Page _____

Witness my hand and official seal the day and year aforesaid.

County Recorder

By

Deputy Recorder

RECORDED AT REQUEST OF
American Selco, Inc.
BOOK 88 PAGE 57

30 OCT 15 AID: 81

OFFICIAL RECORDS
EUREKA COUNTY, NEVADA
WILLIS A. DICKSON, RECORDER
FILE NO. 77035
FEE \$ 3.00

STATE OF NEVADA
 CERTIFICATE OF MINING LOCATION
 LODGE CLAIM ON PUBLIC DOMAIN

NOTICE IS HEREBY GIVEN that Afgan No. 2 lode mining claim has been located by American Selco, a New York corporation, whose address 90 West Grove Street, Suite 100, Reno, Nevada 89509. This claim is a relocation of the Afgan No. 2 lode mining claim, the certificate of location of which is of record in the office of the recorder of Eureka County, Nevada in Book 81 Page 430, in accordance with NRS 517.080. The general course of this claim is East/West. This claim is 1500 feet in length along the course of the claim, being 10 feet from the point of discovery in an East direction to the East end line of this claim, and 1490 feet in a West direction to the West end line of the claim. This claim is 600 feet in width, being 300 feet in width on each side of the center line of the claim.

This claim is located within the SW Quarter of Section 17, Township 22 North, Range 51 East Mount Diablo Base and Meridian, unknown Mining District, Eureka County, Nevada. The location monument of this claim is situated with reference to some natural object or permanent monument as follows: Corner No. 1 of this claim is located approximately 4400 feet S 1/4 N 65° W from the located SE corner of Section 17, T22N, R51 E, MDM.

The corners of this claim are marked by 4" x 4" posts or pipe with metal tags inscribed with the appropriate corner number as shown on the following sketch and the accompanying claim map.

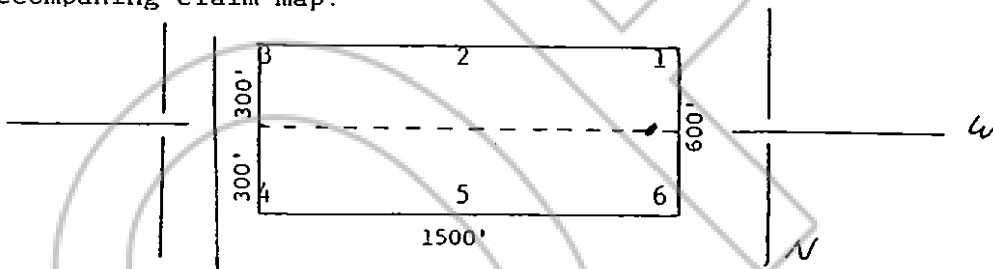

The location work consisted of making the maps provided in NRS 517.040.

Dated and posted on the ground this 22 day of July, 1980.

Witnesses:

Locator:

AMERICAN SELCO INC.

By

Jim Rice
 Agent for
 AMERICAN SELCO INC.

STATE OF NEVADA)
) ss.
 COUNTY OF _____)

I hereby certify that the within instrument was filed and recorded at the request of : _____
 FILE NO. _____
 on _____
 at _____

Witness my hand and official seal the day and year aforesaid.

County Recorder _____

By

Deputy Recorder _____

RECORDED AT REQUEST OF
 American Selco, Inc.
 BOOK 88 PAGE 58

60 OCT 15 A10

OFFICIAL RECORDS
 EUREKA COUNTY, NEVADA
 WILLIS A. DEPAOLI, RECORDER
 FILE NO. 77036
 FEE \$3.00

Page _____

BOOK 88 PAGE 58

STATE OF NEVADA
 CERTIFICATE OF MINING LOCATION
 LODE CLAIM ON PUBLIC DOMAIN

NOTICE IS HEREBY GIVEN that Afgan No. 3 lode mining claim has been located by American Selco, a New York corporation, whose address 90 West Grove Street, Suite 100, Reno, Nevada 89509. This claim is a relocation of the Afgan No. 3 lode mining claim, the certificate of location of which is of record in the office of the recorder of Eureka County, Nevada in Book 81 Page 451, in accordance with NRS 517.080. The general course of this claim is East/West. This claim is 1500 feet in length along the course of the claim, being 10 feet from the point of discovery in an East direction to the East end line of this claim, and 1490 feet in a West direction to the West end line of the claim. This claim is 600 feet in width, being 300 feet in width on each side of the center line of the claim.

This claim is located within the SW Quarter of Section 17, Township 22 North, Range 51 East Mount Diablo Base and Meridian, unknown Mining District, Eureka County, Nevada. The location monument of this claim is situated with reference to some natural object or permanent monument as follows: Corner No. 1 of this claim is located approximately 4400 feet N65°W from the located SE corner of Section 17, T22N, R51 E, MDM.

The corners of this claim are marked by 4" x 4" posts or pipe with metal tags inscribed with the appropriate corner number as shown on the following sketch and the accompanying claim map.

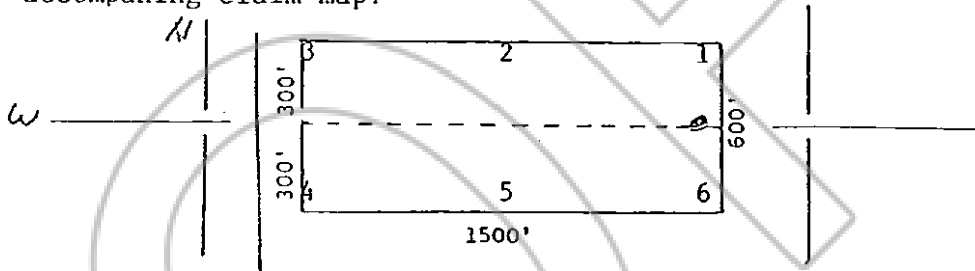

The location work consisted of making the maps provided in NRS 517.040.

Dated and posted on the ground this 22 day of July, 1980.

Witnesses:

Locator:

AMERICAN SELCO INC.

By Jim Rice
 Agent for
 AMERICAN SELCO INC.

STATE OF NEVADA)
) ss.
 COUNTY OF _____)

I hereby certify that the within instrument was filed and recorded at the request of:

FILE NO. 22013
 at 10008
 Docket 3.00 Page _____

Witness my hand and official seal the day and year aforesaid.

County Recorder

By _____
 Deputy Recorder

RECORDED AT REQUEST OF
 American Selco, Inc.
 BOOK 88 PAGE 59

80001

OFFICE OF THE COUNTY RECORDER
 EUREKA COUNTY, NEVADA
 WILLIS A. DUNN, RECORDER
 FILE NO. 22013
 FEE 3.00

STATE OF NEVADA
 CERTIFICATE OF MINING LOCATION
LODE CLAIM ON PUBLIC DOMAIN

NOTICE IS HEREBY GIVEN that Afgan No. 4 lode mining claim has been located by American Selco, a New York corporation, whose address 90 West Grove Street, Suite 100, Reno, Nevada 89509. This claim is a relocation of the Afgan No. 4 lode mining claim, the certificate of location of which is of record in the office of the recorder of Eureka County, Nevada in Book 81 Page 452, in accordance with NRS 517.080. The general course of this claim is East/West. This claim is 1500 feet in length along the course of the claim, being 1490 feet from the point of discovery in an East direction to the East end line of this claim, and 10 feet in a West direction to the West end line of the claim. This claim is 600 feet in width, being 300 feet in width on each side of the center line of the claim.

This claim is located within the SW Quarter of Section 17, Township 22 North, Range 51 East Mount Diablo Base and Meridian, unknown Mining District, Eureka County, Nevada. The location monument of this claim is situated with reference to some natural object or permanent monument as follows: Corner No. 1 of this claim is located approximately 4400 feet S 118° W from the located SE corner of Section 17, T22N, R51 E, MDM.

The corners of this claim are marked by 4" x 4" posts or pipe with metal tags inscribed with the appropriate corner number as shown on the following sketch and the accompanying claim map.

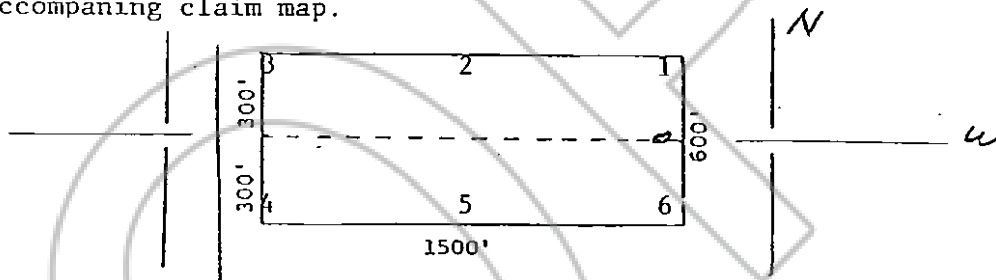

The location work consisted of making the maps provided in NRS 517.040.

Dated and posted on the ground this 22 day of July, 1980.

Witnesses:

Locator:

AMERICAN SELCO INC.

By Jim Rice
 Agent for
 AMERICAN SELCO INC.

STATE OF NEVADA)
) ss.
 COUNTY OF _____)

I hereby certify that the within instrument was filed and recorded at the request of : _____
 FILE NO: _____

Witness my hand and official seal the day and year aforesaid.

County Recorder

By _____
 Deputy Recorder

RECORDED AT REQUEST OF
 American Selco Inc.
 BOOK 88 PAGE 60

80 OCT 15 A10:28

OFFICIAL RECORDS
 EUREKA COUNTY, NEVADA
 WILLIS A. DEGEN, CLERK
 FILE NO. 77038
 FEE \$3.00

Page _____

BOOK 88 PAGE 60

77039

STATE OF NEVADA
 CERTIFICATE OF MINING LOCATION
 LODE CLAIM ON PUBLIC DOMAIN

NOTICE IS HEREBY GIVEN that Afgan No. 5 lode mining claim has been located by American Selco, a New York corporation, whose address 90 West Grove Street, Suite 100, Reno, Nevada 89509. This claim is a relocation of the Afgan No. 5 lode mining claim, the certificate of location of which is of record in the office of the recorder of Eureka County, Nevada in Book 81 Page 453, in accordance with NRS 517.080. The general course of this claim is East/West. This claim is 1500 feet in length along the course of the claim, being 10 feet from the point of discovery in an East direction to the East end line of this claim, and 1490 feet in a West direction to the West end line of the claim. This claim is 600 feet in width, being 300 feet in width on each side of the center line of the claim.

This claim is located within the NW Quarter of Section 20, Township 22 North, Range 51 East Mount Diablo Base and Meridian, unknown Mining District, Eureka County, Nevada. The location monument of this claim is situated with reference to some natural object or permanent monument as follows: Corner No. 1 of this claim is located approximately 9475 feet S 79° W from the located SE corner of Section 17, T22N, R51 E, MDM.

The corners of this claim are marked by 4" x 4" posts or pipe with metal tags inscribed with the appropriate corner number as shown on the following sketch and the accompanying claim map.

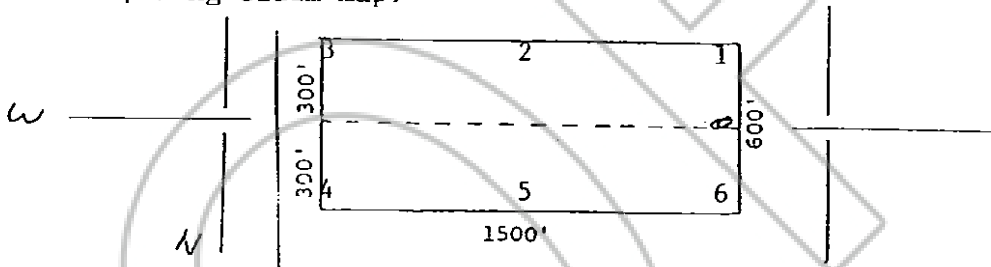

The location work consisted of making the maps provided in NRS 517.040.

Dated and posted on the ground this 22 day of July, 1980.

Witnesses:

Locator:

AMERICAN SELCO INC.

By

Jim Rice
 Agent for
 AMERICAN SELCO INC.

STATE OF NEVADA

COUNTY OF _____

ss.

I hereby certify that the within instrument was filed and recorded at the request of: _____

Witness my hand and official seal the day and year aforesaid.

FILE NO. _____

at _____

Book _____

Page _____

County Recorder _____

By

Deputy Recorder _____

RECORDED AT REQUEST OF
American Selco Inc.
 BOOK 88 PAGE 61

80 OCT 16 AIB

OFFICIAL RECORDS
 EUREKA COUNTY, NEVADA
 WILLIS A. DEPAUL, RECORDER
 FILE NO. 77039
 FEE \$ 3.00

BOOK 88 PAGE 61

STATE OF NEVADA
77040 CERTIFICATE OF MINING LOCATION
LODE CLAIM ON PUBLIC DOMAIN

NOTICE IS HEREBY GIVEN that Afgan No. 6 lode mining claim has been located by American Selco, a New York corporation, whose address 90 West Grove Street, Suite 100, Reno, Nevada 89509. This claim is a relocation of the Afgan No. 6 lode mining claim, the certificate of location of which is of record in the office of the recorder of Eureka County, Nevada in Book 81 Page 454, in accordance with NRS 517.080. The general course of this claim is East/West. This claim is 1500 feet in length along the course of the claim, being 1490 feet from the point of discovery in an East direction to the East end line of this claim, and 10 feet in a West direction to the West end line of the claim. This claim is 600 feet in width, being 300 feet in width on each side of the center line of the claim.

This claim is located within the NW Quarter of Section 20, Township 22 North, Range 51 East Mount Diablo Base and Meridian, unknown Mining District, Eureka County, Nevada. The location monument of this claim is situated with reference to some natural object or permanent monument as follows: Corner No. 1 of this claim is located approximately 4475 feet S 79° W from the located SE corner of Section 17, T22N, R51 E, MDM.

The corners of this claim are marked by 4" x 4" posts or pipe with metal tags inscribed with the appropriate corner number as shown on the following sketch and the accompanying claim map.

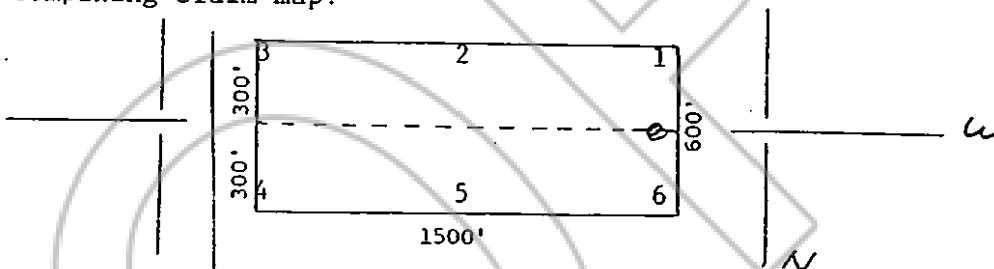

The location work consisted of making the maps provided in NRS 517.040.

Dated and posted on the ground this 22 day of July, 1980.

Witnesses:

Locator:

AMERICAN SELCO INC.

By

Jan Rice
Agent for
AMERICAN SELCO INC.

STATE OF NEVADA }
COUNTY OF _____ } ss.

I hereby certify that the within instrument was filed and recorded at the request of: _____

Witness my hand and official seal the day and year aforesaid.

County Recorder

By _____
Deputy Recorder

RECORDED AT REQUEST OF
American Selco Inc.
BOOK 88 PAGE 62

80 OCT 15 1980
OFFICIAL RECORDS
EUREKA COUNTY, NEVADA
WILLIS A. DEPAULIS, RECORDER
FILE NO. 77040
FEE \$ 3.00

BOOK 88 PAGE 62

77041

CERTIFICATE OF MINING LOCATION
LODE CLAIM ON PUBLIC DOMAIN

NOTICE IS HEREBY GIVEN that Afgan No. 7 lode mining claim has been located by American Selco, a New York corporation, whose address 90 West Grove Street, Suite 100, Reno, Nevada 89509. This claim is a relocation of the Afgan No. 7 lode mining claim, the certificate of location of which is of record in the office of the recorder of Eureka County, Nevada in Book 81 Page 455, in accordance with NRS 517.080. The general course of this claim is East/West. This claim is 1500 feet in length along the course of the claim, being 10 feet from the point of discovery in an East direction to the East end line of this claim, and 1490 feet in a West direction to the West end line of the claim. This claim is 600 feet in width, being 300 feet in width on each side of the center line of the claim.

This claim is located within the NW Quarter of Section 20, Township 22 North, Range 51 East Mount Diablo Base and Meridian, unknown Mining District, Eureka County, Nevada. The location monument of this claim is situated with reference to some natural object or permanent monument as follows: Corner No. 1 of this claim is located approximately 475 feet S 79° W from the located SE corner of Section 17, T22N, R51 E, MDM.

The corners of this claim are marked by 4" x 4" posts or pipe with metal tags inscribed with the appropriate corner number as shown on the following sketch and the accompanying claim map.

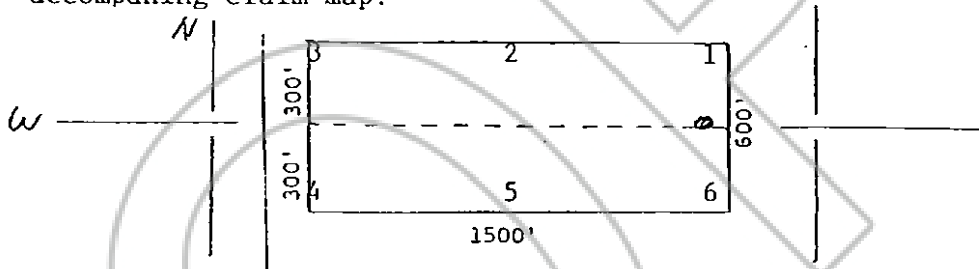

The location work consisted of making the maps provided in NRS 517.040.

Dated and posted on the ground this 22 day of July, 1980.

Witnesses:

Locator:

AMERICAN SELCO INC.

By

Jim Rice
Agent for
AMERICAN SELCO INC.

STATE OF NEVADA

COUNTY OF _____

) ss.

I hereby certify that the within instrument was filed and recorded at the request of : _____
FILE NO. _____
on _____

Witness my hand and official seal the day and year aforesaid.

County Recorder

By

Deputy Recorder

RECORDED AT REQUEST OF
American Selco, Inc.
BOOK 88 PAGE 63

80 OCT 15 AIO:

OFFICIAL RECORDS
EUREKA COUNTY, NEVADA
FILE NO. 77041
FEE \$ 3.00

Page _____

BOOK 88 PAGE 63

CERTIFICATE OF MINING LOCATION

LODE CLAIM ON PUBLIC DOMAIN

NOTICE IS HEREBY GIVEN that Afgan No. 8 lode mining claim has been located by American Selco, a New York corporation, whose address 90 West Grove Street, Suite 100, Reno, Nevada 89509. This claim is a relocation of the Afgan No. 8 lode mining claim, the certificate of location of which is of record in the office of the recorder of Eureka County, Nevada in Book 81 Page 456, in accordance with NRS 517.080. The general course of this claim is East/West. This claim is 1500 feet in length along the course of the claim, being 1490 feet from the point of discovery in an East direction to the East end line of this claim, and 10 feet in a West direction to the West end line of the claim. This claim is 600 feet in width, being 300 feet in width on each side of the center line of the claim.

This claim is located within the NW Quarter of Section 20, Township 22 North, Range 51 East Mount Diablo Base and Meridian, unknown Mining District, Eureka County, Nevada. The location monument of this claim is situated with reference to some natural object or permanent monument as follows: Corner No. 1 of this claim is located approximately 475 feet S 79° W from the located SE corner of Section 17, T22N, R51 E, MDM.

The corners of this claim are marked by 4" x 4" posts or pipe with metal tags inscribed with the appropriate corner number as shown on the following sketch and the accompanying claim map.

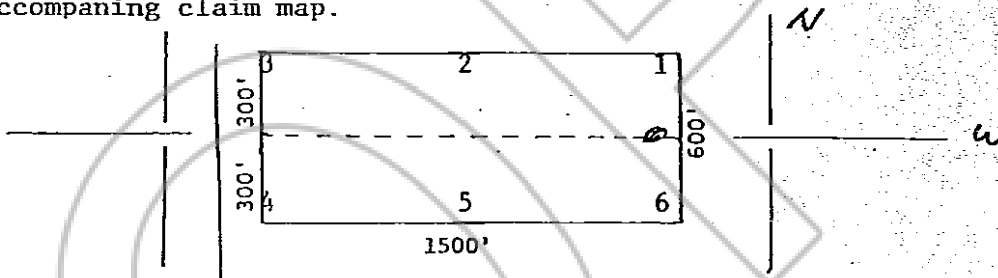

The location work consisted of making the maps provided in NRS 517.040.

Dated and posted on the ground this 22 day of July, 1980.

Witnesses:

Locator:

AMERICAN SELCO INC

By

Jim Rice
Agent for
AMERICAN SELCO INC.

STATE OF NEVADA

COUNTY OF _____

ss.

I hereby certify that the within instrument was filed and recorded at the request of : _____

FILE NO. _____

on _____

at _____

Do not _____

Page _____

Witness my hand and official seal the day and year aforesaid.

County Recorder

By

Deputy Recorder

RECORDED AT REQUEST OF

American Selco Inc.

BOOK 88 PAGE 64

80 OCT 15 AIO: 88

OFFICIAL RECORDS
EUREKA COUNTY, NEVADA
WILLIS A. DEBRA, CLERK
FILE NO. 77042
FILE \$ 3.00

BOOK 88 PAGE 64

STATE OF NEVADA
77043 CERTIFICATE OF MINING LOCATION
LODE CLAIM ON PUBLIC DOMAIN

NOTICE IS HEREBY GIVEN that Afgan No. 9 lode mining claim has been located by American Selco, a New York corporation, whose address 90 West Grove Street, Suite 100, Reno, Nevada 89509. This claim is a relocation of the Afgan No. 9 lode mining claim, the certificate of location of which is of record in the office of the recorder of Eureka County, Nevada in Book 81 Page 457, in accordance with NRS 517.080. The general course of this claim is East/West. This claim is 1500 feet in length along the course of the claim, being 10 feet from the point of discovery in an East direction to the East end line of this claim, and 1490 feet in a West direction to the West end line of the claim. This claim is 600 feet in width, being 300 feet in width on each side of the center line of the claim.

This claim is located within the NW Quarter of Section 20, Township 22 North, Range 51 East Mount Diablo Base and Meridian, unknown Mining District, Eureka County, Nevada. The location monument of this claim is situated with reference to some natural object or permanent monument as follows: Corner No. 1 of this claim is located approximately 4850 feet S 65° W from the located SE corner of Section 17, T22N, R51 E, MDM.

The corners of this claim are marked by 4" x 4" posts or pipe with metal tags inscribed with the appropriate corner number as shown on the following sketch and the accompanying claim map.

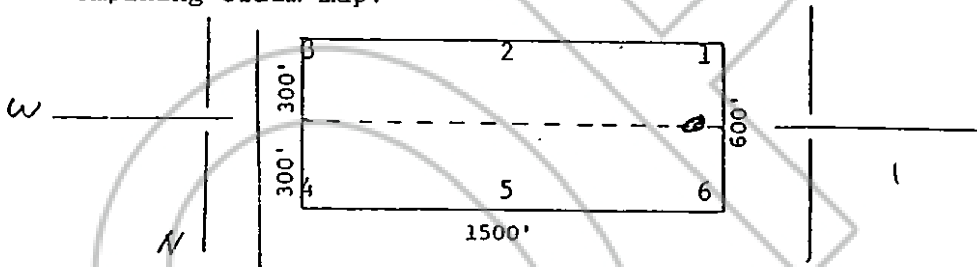

The location work consisted of making the maps provided in NRS 517.040.

Dated and posted on the ground this 22 day of July, 1980.

Witnesses:

Locator:

AMERICAN SELCO INC.

By

Jim Rice
Agent for
AMERICAN SELCO INC.

STATE OF NEVADA)
COUNTY OF _____) ss.

I hereby certify that the within instrument was filed and recorded at the request of :
FILE NO. _____
on _____

Witness my hand and official seal the day and year aforesaid.

County Recorder

By _____
Deputy Recorder

RECORDED AT REQUEST OF
American Selco Inc.
BOOK 88 PAGE 65

80 OCT 15 AM 10:20
DOCKET
OFFICIAL RECORDS
EUREKA COUNTY, NEVADA
WILLIS A. DEPAOLI - RECORDER
FILE NO. 77043
FEE \$ 3.00

BOOK 88 PAGE 65

STATE OF NEVADA
77044 CERTIFICATE OF MINING LOCATION
LODE CLAIM ON PUBLIC DOMAIN

NOTICE IS HEREBY GIVEN that Afgan No. 10 lode mining claim has been located by American Selco, a New York corporation, whose address 90 West Grove Street, Suite 100, Reno, Nevada 89509. This claim is a relocation of the Afgan No. 10 lode mining claim, the certificate of location of which is of record in the office of the recorder of Eureka County, Nevada in Book 81 Page 458, in accordance with NRS 517.080. The general course of this claim is East/West. This claim is 1500 feet in length along the course of the claim, being 1490 feet from the point of discovery in an East direction to the East end line of this claim, and 10 feet in a West direction to the West end line of the claim. This claim is 600 feet in width, being 300 feet in width on each side of the center line of the claim.

This claim is located within the 1160 Quarter of Section 20, Township 22 North, Range 51 East Mount Diablo Base and Meridian, unknown Mining District, Eureka County, Nevada. The location monument of this claim is situated with reference to some natural object or permanent monument as follows: Corner No. 1 of this claim is located approximately 4650 feet S 65° W from the located SE corner of Section 17, T22N, R51 E, MDM.

The corners of this claim are marked by 4" x 4" posts or pipe with metal tags inscribed with the appropriate corner number as shown on the following sketch and the accompanying claim map.

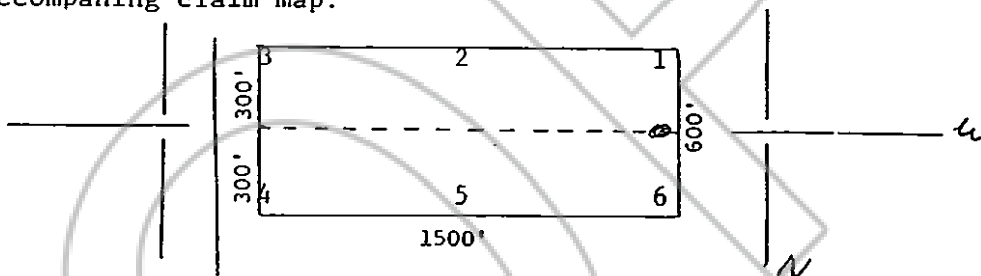

The location work consisted of making the maps provided in NRS 517.040.

Dated and posted on the ground this 22 day of July, 1980.

Witnesses:

Locator:

AMERICAN SELCO INC.

By

Jim Rice
Agent for
AMERICAN SELCO, INC.

STATE OF NEVADA)
COUNTY OF _____) ss.

I hereby certify that the within instrument was filed and recorded at the request of:

FILE NO. 77044
Book 88 Page 66

Witness my hand and official seal the day and year aforesaid.

County Recorder

By _____
Deputy Recorder

RECORDED AT REQUEST OF
American Selco, Inc.
BOOK 88 PAGE 66

80 OCT 15 A 11 55

OFFICIAL RECORDS
EUREKA COUNTY, NEVADA
#115 A. O. C. S. D. H. REC'D
FILE NO. 77044
FEB 3 3 00

BOOK 88 PAGE 66

STATE OF NEVADA
 CERTIFICATE OF MINING LOCATION
LODE CLAIM ON PUBLIC DOMAIN

NOTICE IS HEREBY GIVEN that Afgan No. // lode mining claim has been located by American Selco, a New York corporation, whose address 90 West Grove Street, Suite 100, Reno, Nevada 89509. This claim is a relocation of the Afgan No. // lode mining claim, the certificate of location of which is of record in the office of the recorder of Eureka County, Nevada in Book 81 Page 459, in accordance with NRS 517.080. The general course of this claim is East/West. This claim is 1500 feet in length along the course of the claim, being 10 feet from the point of discovery in an East direction to the East end line of this claim, and 1490 feet in a West direction to the West end line of the claim. This claim is 600 feet in width, being 300 feet in width on each side of the center line of the claim.

This claim is located within the NW Quarter of Section 20, Township 22 North, Range 51 East Mount Diablo Base and Meridian, unknown Mining District, Eureka County, Nevada. The location monument of this claim is situated with reference to some natural object or permanent monument as follows: Corner No. 1 of this claim is located approximately 4850 feet S 65° W from the located SE corner of Section 17, T22N, R51 E, MDM.

The corners of this claim are marked by 4" x 4" posts or pipe with metal tags inscribed with the appropriate corner number as shown on the following sketch and the accompanying claim map.

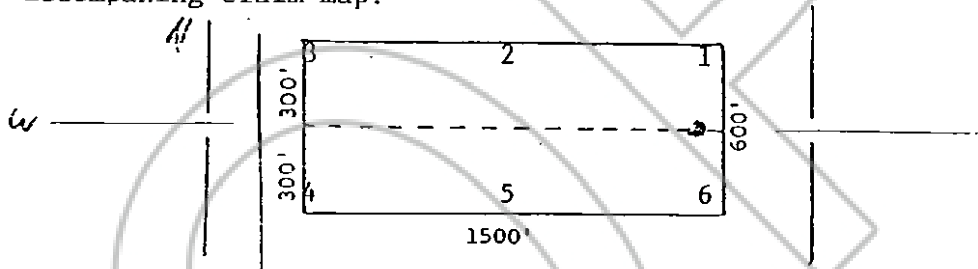

The location work consisted of making the maps provided in NRS 517.040.

Dated and posted on the ground this 22 day of July, 1980.

Witnesses:

Locator:

AMERICAN SELCO INC.

By

Jan Rie
 Agent for
 AMERICAN SELCO INC.

STATE OF NEVADA)
) ss.
 COUNTY OF _____)

I hereby certify that the within instrument was filed and recorded at the request of : _____
 FILE NO. _____

Witness my hand and official seal the day and year aforesaid.

County Recorder

By _____
 Deputy Recorder

RECORDED AT REQUEST OF
 American Selco Inc.
 BOOK 88 PAGE 67

80 OCT 15 1980

OFFICIAL RECORDS
 EUREKA COUNTY, NEVADA
 WILLIS A. DEPT. CLERK
 FILE NO. 77045
 FEE \$ 3.00

BOOK 88 PAGE 67

STATE OF NEVADA
77046 CERTIFICATE OF MINING LOCATION
LODE CLAIM ON PUBLIC DOMAIN

NOTICE IS HEREBY GIVEN that Afgan No. 12 lode mining claim has been located by American Selco, a New York corporation, whose address 90 West Grove Street, Suite 100, Reno, Nevada 89509. This claim is a relocation of the Afgan No. 12 lode mining claim, the certificate of location of which is of record in the office of the recorder of Eureka County, Nevada in Book 81 Page 460, in accordance with NRS 517.080. The general course of this claim is East/West. This claim is 1500 feet in length along the course of the claim, being 1490 feet from the point of discovery in an East direction to the East end line of this claim, and 10 feet in a West direction to the West end line of the claim. This claim is 600 feet in width, being 300 feet in width on each side of the center line of the claim.

This claim is located within the NW1 Quarter of Section 20, Township 22 North, Range 51 East Mount Diablo Base and Meridian, unknown Mining District, Eureka County, Nevada. The location monument of this claim is situated with reference to some natural object or permanent monument as follows: Corner No. 1 of this claim is located approximately feet S W from the located SE corner of Section 17, T22N, R51 E, MDM.

The corners of this claim are marked by 4" x 4" posts or pipe with metal tags inscribed with the appropriate corner number as shown on the following sketch and the accompanying claim map.

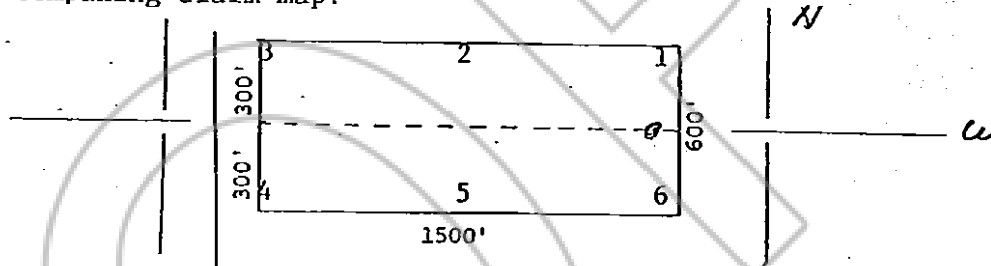

The location work consisted of making the maps provided in NRS 517.040.

Dated and posted on the ground this 22 day of July, 1980.

Witnesses:

Locator:

AMERICAN SELCO INC

By Jim Rice
Agent for
AMERICAN SELCO INC.

STATE OF NEVADA }
COUNTY OF } ss.

I hereby certify that the within instrument was filed and recorded at the request of : Witness my hand and official seal the day and year aforesaid.
FILE NO.
on.
at.

County Recorder

By
Deputy Recorder

RECORDED AT REQUEST OF
American Selco Inc.
BOOK 88 PAGE 68

30 OCT 15 AIO: 23

OFFICIAL RECORDS
EUREKA COUNTY, NEVADA
WILLIS A. ORPAIN, RECORDER
FILE NO. 77046
FEE \$ 3.00

Page

BOOK 88 PAGE 68

STATE OF NEVADA
 CERTIFICATE OF MINING LOCATION
 LODE CLAIM ON PUBLIC DOMAIN

NOTICE IS HEREBY GIVEN that Afgan No. 13 lode mining claim has been located by American Selco, a New York corporation, whose address 90 West Grove Street, Suite 100, Reno, Nevada 89509. This claim is a relocation of the Afgan No. 13 lode mining claim, the certificate of location of which is of record in the office of the recorder of Eureka County, Nevada in Book 81 Page 461, in accordance with NRS 517.080. The general course of this claim is East/West. This claim is 1500 feet in length along the course of the claim, being 170 feet from the point of discovery in an East direction to the East end line of this claim, and 1490 feet in a West direction to the West end line of the claim. This claim is 600 feet in width, being 300 feet in width on each side of the center line of the claim.

This claim is located within the SW Quarter of Section 20, Township 22 North, Range 51 East Mount Diablo Base and Meridian, unknown Mining District, Eureka County, Nevada. The location monument of this claim is situated with reference to some natural object or permanent monument as follows: Corner No. 1 of this claim is located approximately 5430 feet S 54° W from the located SE corner of Section 17, T22N, R51 E, MDM.

The corners of this claim are marked by 4" x 4" posts or pipe with metal tags inscribed with the appropriate corner number as shown on the following sketch and the accompanying claim map.

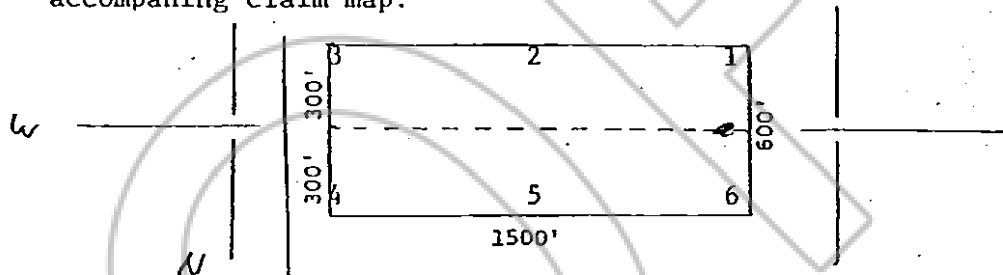

The location work consisted of making the maps provided in NRS 517.040.

Dated and posted on the ground this 22 day of July, 1980.

Witnesses:

Locator:

AMERICAN SELCO INC.

By

John Rice
 Agent for
 AMERICAN SELCO INC.

STATE OF NEVADA

COUNTY OF

ss.

I hereby certify that the within instrument was filed and recorded at the request of:

Witness my hand and official seal the day and year aforesaid.

FILE NO. _____

on _____

at _____

Book _____ Page _____

County Recorder

By

Deputy Recorder

RECORDED AT REQUEST OF
American Selco, Inc.
 BOOK 88 PAGE 69

80 OCT 15 AIO: 23

OFFICIAL RECORDS
 EUREKA COUNTY, NEVADA
 WILLIS A. DEBELL-RECORDER
 FILE NO. 77047
 FEE \$ 3.00

STATE OF NEVADA
 CERTIFICATE OF MINING LOCATION
 LODE CLAIM ON PUBLIC DOMAIN

NOTICE IS HEREBY GIVEN that Afgan No. 14 lode mining claim has been located by American Selco, a New York corporation, whose address 90 West Grove Street, Suite 100, Reno, Nevada 89509. This claim is a relocation of the Afgan No. 14 lode mining claim, the certificate of location of which is of record in the office of the recorder of Eureka County, Nevada in Book 81 Page 462, in accordance with NRS 517.080. The general course of this claim is East/West. This claim is 1500 feet in length along the course of the claim, being 1490 feet from the point of discovery in an East direction to the East end line of this claim, and 10 feet in a West direction to the West end line of the claim. This claim is 600 feet in width, being 300 feet in width on each side of the center line of the claim.

This claim is located within the SW Quarter of Section 20, Township 22 North, Range 51 East Mount Diablo Base and Meridian, unknown Mining District, Eureka County, Nevada. The location monument of this claim is situated with reference to some natural object or permanent monument as follows: Corner No. 1 of this claim is located approximately 3450 feet S 54 W from the located SE corner of Section 17, T22N, R51 E, MDM.

The corners of this claim are marked by 4" x 4" posts or pipe with metal tags inscribed with the appropriate corner number as shown on the following sketch and the accompanying claim map.

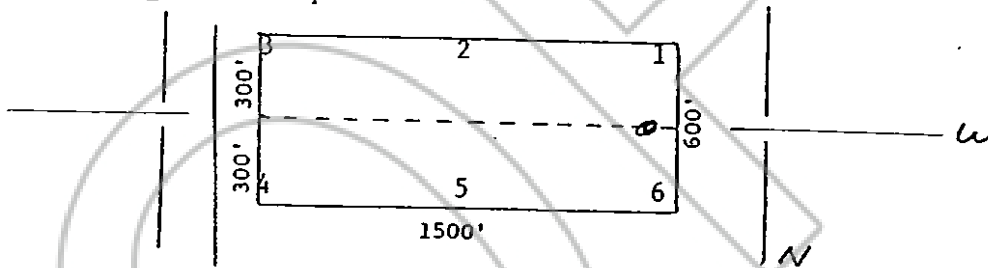

The location work consisted of making the maps provided in NRS 517.040.

Dated and posted on the ground this 22 day of July, 1980.

Witnesses:

Locator:

AMERICAN SELCO INC.

By

Jan. Rie
 Agent for
 AMERICAN SELCO INC.

STATE OF NEVADA)
) ss.
 COUNTY OF _____)

I hereby certify that the within instrument was filed and recorded at the request of: _____
 FILE NO. _____
 on _____

Witness my hand and official seal the day and year aforesaid.

County Recorder

By _____
 Deputy Recorder

RECORDED AT REQUEST OF
American Selco Inc.
 BOOK 88 PAGE 70

80 OCT 15 AIO: 123

OFFICIAL RECORDS
 EUREKA COUNTY, NEVADA
 WILLIS A. DEPAOLI - RECORDER
 FILE NO. 77048
 FEE \$ 3.00

Page _____

BOOK 88 PAGE 70

STATE OF NEVADA
CERTIFICATE OF MINING LOCATION
LODE CLAIM ON PUBLIC DOMAIN

77049

NOTICE IS HEREBY GIVEN that Afgan No. 15 lode mining claim has been located by American Selco, a New York corporation, whose address 90 West Grove Street, Suite 100, Reno, Nevada 89509. This claim is a relocation of the Afgan No. 15 lode mining claim, the certificate of location of which is of record in the office of the recorder of Eureka County, Nevada in Book 81 Page 463, in accordance with NRS 517.080. The general course of this claim is East/West. This claim is 1500 feet in length along the course of the claim, being 10 feet from the point of discovery in an East direction to the East end line of this claim, and 1490 feet in a West direction to the West end line of the claim. This claim is 600 feet in width, being 300 feet in width on each side of the center line of the claim.

This claim is located within the SW Quarter of Section 20, Township 22 North, Range 51 East Mount Diablo Base and Meridian, unknown Mining District, Eureka County, Nevada. The location monument of this claim is situated with reference to some natural object or permanent monument as follows: Corner No. 1 of this claim is located approximately 5450 feet S 54° W from the located SE corner of Section 17, T22N, R51 E, MDM.

The corners of this claim are marked by 4" x 4" posts or pipe with metal tags inscribed with the appropriate corner number as shown on the following sketch and the accompanying claim map.

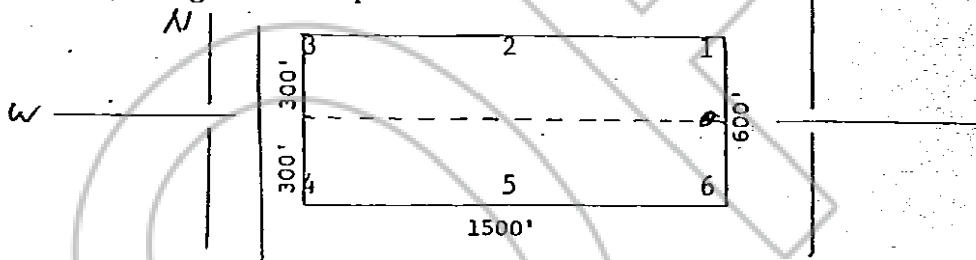

The location work consisted of making the maps provided in NRS 517.040.

Dated and posted on the ground this 22 day of July, 1980.

Witnesses:

Locator:

AMERICAN SELCO INC.

By

Jim Rice
Agent for
AMERICAN SELCO INC.

STATE OF NEVADA)
COUNTY OF _____) ss.

I hereby certify that the within instrument was filed and recorded at the request of: oi

FILE NO. 80

on _____
at _____
Docket _____ Page _____

Witness my hand and official seal the day and year aforesaid.

County Recorder

By

Deputy Recorder

RECORDED AT REQUEST OF
American Selco Inc.
BOOK 88 PAGE 71

80 OCT 15 AIO: 23

OFFICIAL RECORDS
EUREKA COUNTY, NEVADA
WILLIS A. DEPAUL RECORDER
FILE NO. 77049
FEE \$ 3.00

BOOK 88 PAGE 71

STATE OF NEVADA
 CERTIFICATE OF MINING LOCATION
 LODE CLAIM ON PUBLIC DOMAIN

NOTICE IS HEREBY GIVEN that Afgan No. 16 lode mining claim has been located by American Selco, a New York corporation, whose address 90 West Grove Street, Suite 100, Reno, Nevada 89509. This claim is a relocation of the Afgan No. 16 lode mining claim, the certificate of location of which is of record in the office of the recorder of Eureka County, Nevada in Book 81 Page 464, in accordance with NRS 517.080. The general course of this claim is East/West. This claim is 1500 feet in length along the course of the claim, being 10 feet from the point of discovery in an East direction to the East end line of this claim, and 1490 feet in a West direction to the West end line of the claim. This claim is 600 feet in width, being 300 feet in width on each side of the center line of the claim.

This claim is located within the SW Quarter of Section 20, Township 22 North, Range 51 East Mount Diablo Base and Meridian, unknown Mining District, Eureka County, Nevada. The location monument of this claim is situated with reference to some natural object or permanent monument as follows: Corner No. 1 of this claim is located approximately 5430 feet S 54° W from the located SE corner of Section 17, T22N, R51 E, MDM.

The corners of this claim are marked by 4" x 4" posts or pipe with metal tags inscribed with the appropriate corner number as shown on the following sketch and the accompanying claim map.

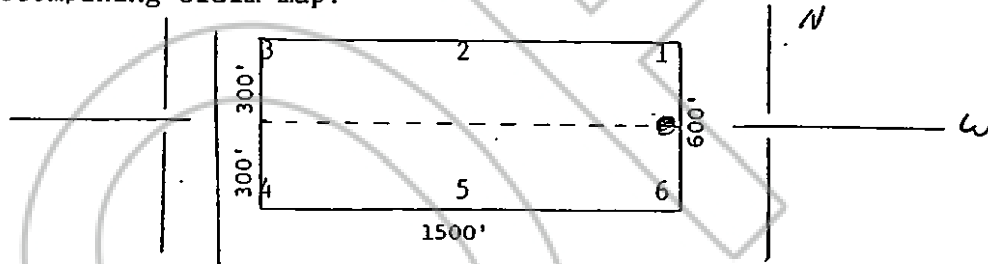

The location work consisted of making the maps provided in NRS 517.040.

Dated and posted on the ground this 22 day of July, 1980.

Witnesses:

Locator:

AMERICAN SELCO INC.

By

Jim Rice
 Agent for
 AMERICAN SELCO INC.

STATE OF NEVADA)
) ss.
 COUNTY OF _____)

I hereby certify that the within instrument was filed and recorded at the request of: _____

Witness my hand and official seal the day and year aforesaid.

FILE NO. _____
 at _____
 Docket _____

County Recorder

By

Deputy Recorder

RECORDED AT REQUEST OF
 American Selco, Inc.
 BOOK 88 PAGE 72

80 OCT 15 1980

OFFICIAL RECORDS
 EUREKA COUNTY, NEVADA
 WILLIS A. DEBOL, RECORDER
 FILE NO. 77050
 FEE \$ 3.00

77051

STATE OF NEVADA
 CERTIFICATE OF MINING LOCATION
 LODE CLAIM ON PUBLIC DOMAIN

NOTICE IS HEREBY GIVEN that Afgan No. 17 lode mining claim has been located by American Selco, a New York corporation, whose address 90 West Grove Street, Suite 100, Reno, Nevada 89509. This claim is a relocation of the Afgan No. 17 lode mining claim, the certificate of location of which is of record in the office of the recorder of Eureka County, Nevada in Book 81 Page 465, in accordance with NRS 517.080. The general course of this claim is East/West. This claim is 1500 feet in length along the course of the claim, being 10 feet from the point of discovery in an East direction to the East end line of this claim, and 1490 feet in a West direction to the West end line of the claim. This claim is 600 feet in width, being 300 feet in width on each side of the center line of the claim.

This claim is located within the SW Quarter of Section 20, Township 22 North, Range 51 East Mount Diablo Base and Meridian, unknown Mining District, Eureka County, Nevada. The location monument of this claim is situated with reference to some natural object or permanent monument as follows: Corner No. 1 of this claim is located approximately 6250 feet S 45° W from the located SE corner of Section 17, T22N, R51 E, MDM.

The corners of this claim are marked by 4" x 4" posts or pipe with metal tags inscribed with the appropriate corner number as shown on the following sketch and the accompanying claim map.

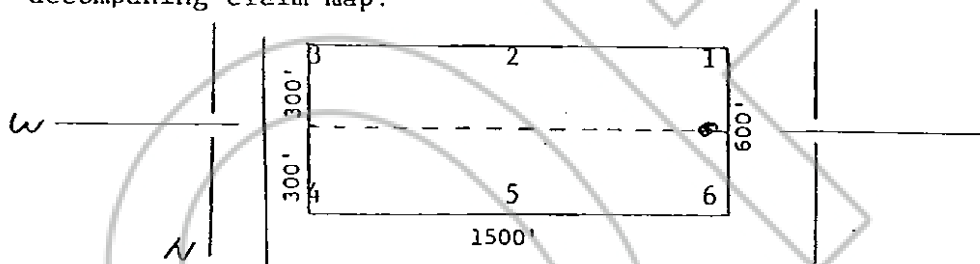

The location work consisted of making the maps provided in NRS 517.040.

Dated and posted on the ground this 22 day of July, 1980.

Witnesses:

Locator:

AMERICAN SELCO INC.

By

Agent for
AMERICAN SELCO INC.

STATE OF NEVADA

COUNTY OF

ss.

I hereby certify that the within instrument was filed and recorded at the request of : _____
 FILE NO. _____
 on _____

Witness my hand and official seal the day and year aforesaid.

County Recorder

By

Deputy Recorder

RECORDED AT REQUEST OF
American Selco Inc.
BOOK 88 PAGE 73

800CT 15 A10:

OFFICIAL RECORDS
 EUREKA COUNTY, NEVADA
 WILLIS A. DEBAUGH - RECORDER
 FILE NO. 77051
 REC \$ 3.00

Page

BOOK 88 PAGE 73

STATE OF NEVADA
77052 CERTIFICATE OF MINING LOCATION
LODE CLAIM ON PUBLIC DOMAIN

NOTICE IS HEREBY GIVEN that Afgan No. 18 lode mining claim has been located by American Selco, a New York corporation, whose address 90 West Grove Street, Suite 100, Reno, Nevada 89509. This claim is a relocation of the Afgan No. 18 lode mining claim, the certificate of location of which is of record in the office of the recorder of Eureka County, Nevada in Book 81 Page 466, in accordance with NRS 517.080. The general course of this claim is East/West. This claim is 1500 feet in length along the course of the claim, being 1490 feet from the point of discovery in an East direction to the East end line of this claim, and 10 feet in a West direction to the West end line of the claim. This claim is 600 feet in width, being 300 feet in width on each side of the center line of the claim.

This claim is located within the SW Quarter of Section 20, Township 22 North, Range 51 East Mount Diablo Base and Meridian, unknown Mining District, Eureka County, Nevada. The location monument of this claim is situated with reference to some natural object or permanent monument as follows: Corner No. 1 of this claim is located approximately 6250 feet S 45° W from the located SE corner of Section 17, T22N, R51 E, MDM.

The corners of this claim are marked by 4" x 4" posts or pipe with metal tags inscribed with the appropriate corner number as shown on the following sketch and the accompanying claim map.

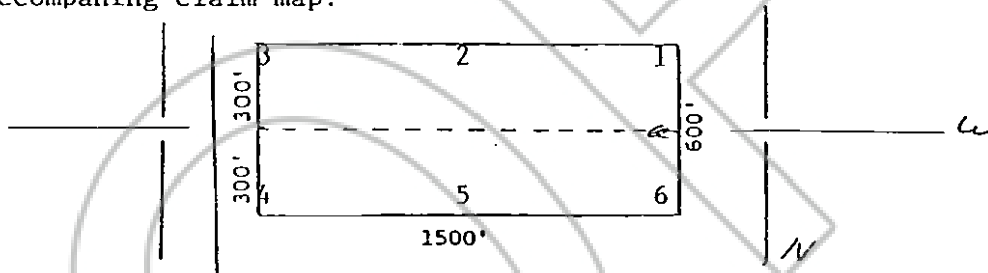

The location work consisted of making the maps provided in NRS 517.040.

Dated and posted on the ground this 22 day of July, 1980.

Witnesses:

Locator:

AMERICAN SELCO INC.

By

John Rice
Agent for
AMERICAN SELCO INC.

STATE OF NEVADA)
COUNTY OF _____) ss.

I hereby certify that the within instrument was filed and recorded at the request of : _____
FILE NO. _____
on _____
at _____
Docket _____ Page _____

Witness my hand and official seal the day and year aforesaid.

County Recorder

By _____
Deputy Recorder

RECORDED AT REQUEST OF
American Selco Inc.
BOOK 88 PAGE 74

DOCT IS A10:23

OFFICIAL RECORDS
EUREKA COUNTY, NEVADA
CLERK & DEPUTY RECORDER
FILE NO. 22052
FEE \$ 3.00

BOOK 88 PAGE 74

CERTIFICATE OF MINING LOCATION

LODE CLAIM ON PUBLIC DOMAIN

NOTICE IS HEREBY GIVEN that Afgan No. 19 lode mining claim has been located by American Selco, a New York corporation, whose address 90 West Grove Street, Suite 100, Reno, Nevada 89509. This claim is a relocation of the Afgan No. 19 lode mining claim, the certificate of location of which is of record in the office of the recorder of Eureka County, Nevada in Book 81 Page 467, in accordance with NRS 517.080. The general course of this claim is East/West. This claim is 1500 feet in length along the course of the claim, being 10 feet from the point of discovery in an East direction to the East end line of this claim, and 1490 feet in a West direction to the West end line of the claim. This claim is 600 feet in width, being 300 feet in width on each side of the center line of the claim.

This claim is located within the SW Quarter of Section 20, Township 22 North, Range 51 East Mount Diablo Base and Meridian, unknown Mining District, Eureka County, Nevada. The location monument of this claim is situated with reference to some natural object or permanent monument as follows: Corner No. 1 of this claim is located approximately 6250 feet S 45° W from the located SE corner of Section 17, T22N, R51 E, MDM.

The corners of this claim are marked by 4" x 4" posts or pipe with metal tags inscribed with the appropriate corner number as shown on the following sketch and the accompanying claim map.

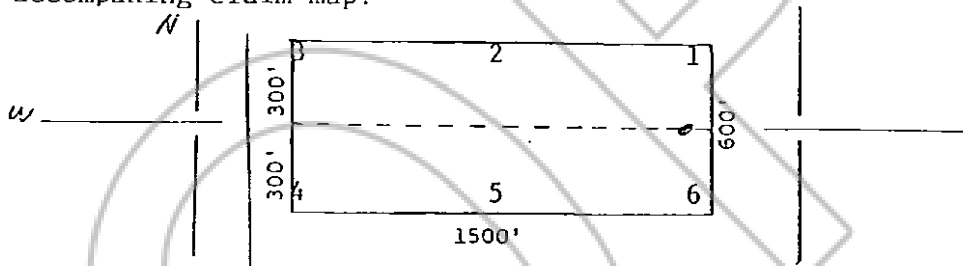

The location work consisted of making the maps provided in NRS 517.040.

Dated and posted on the ground this 22 day of July, 1980.

Witnesses:

Locator:

AMERICAN SELCO INC.

By

Jim Rice
Agent for
AMERICAN SELCO INC.

STATE OF NEVADA)

COUNTY OF _____)

ss.

I hereby certify that the within instrument was filed and recorded at the request of : _____

FILE NO. _____

on _____

at _____

Book _____

Page _____

Witness my hand and official seal the day and year aforesaid.

County Recorder

By

Deputy Recorder

RECORDED AT REQUEST OF
American Selco Inc.
BOOK 88 PAGE 75

000115 A10:23

OFFICIAL RECORDS
EUREKA COUNTY, NEVADA
JULIS A. DEBAOL-RECORDER
FILE NO. 77053
FEE \$ 3.00

BOOK 88 PAGE 75

77054

STATE OF NEVADA
 CERTIFICATE OF MINING LOCATION
 LODE CLAIM ON PUBLIC DOMAIN

NOTICE IS HEREBY GIVEN that Afgan No. 20 lode mining claim has been located by American Selco, a New York corporation, whose address 90 West Grove Street, Suite 100, Reno, Nevada 89509. This claim is a relocation of the Afgan No. 20 lode mining claim, the certificate of location of which is of record in the office of the recorder of Eureka County, Nevada in Book 81 Page 468, in accordance with NRS 517.080. The general course of this claim is East/West. This claim is 1500 feet in length along the course of the claim, being 1490 feet from the point of discovery in an East direction to the East end line of this claim, and 10 feet in a West direction to the West end line of the claim. This claim is 600 feet in width, being 300 feet in width on each side of the center line of the claim.

This claim is located within the SW Quarter of Section 20, Township 22 North, Range 51 East Mount Diablo Base and Meridian, unknown Mining District, Eureka County, Nevada. The location monument of this claim is situated with reference to some natural object or permanent monument as follows: Corner No. 1 of this claim is located approximately 6250 feet S 45° W from the located SE corner of Section 17, T22N, R51 E, MDM.

The corners of this claim are marked by 4" x 4" posts or pipe with metal tags inscribed with the appropriate corner number as shown on the following sketch and the accompanying claim map.

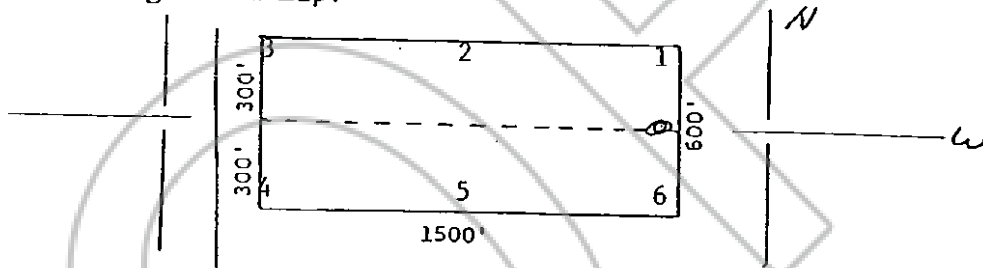

The location work consisted of making the maps provided in NRS 517.040.

Dated and posted on the ground this 22 day of July, 1980.

Witnesses:

Locator:

AMERICAN SELCO INC

By

Jim Rice
 Agent for
 AMERICAN SELCO INC.

STATE OF NEVADA)
 COUNTY OF _____) ss.

I hereby certify that the within instrument was filed and recorded at the request of: _____
 FILE NO. _____

Witness my hand and official seal the day and year aforesaid.

County Recorder

By

Deputy Recorder

BOOK 88 PAGE 76

RECORDED AT REQUEST OF
 American Selco Inc.
 BOOK 88 PAGE 76

80 OCT 15 AIO
 DOCKET
 OFFICIAL RECORDS
 EUREKA COUNTY, NEVADA
 WILLIS A. DEPAQUET, CLERK
 FILE NO. 77054
 FEE \$ 3.00

CERTIFICATE OF MINING LOCATION

77055

LODE CLAIM ON PUBLIC DOMAIN

NOTICE IS HEREBY GIVEN that Afgan No. 21 lode mining claim has been located by American Selco, a New York corporation, whose address 90 West Grove Street, Suite 100, Reno, Nevada 89509. This claim is a relocation of the Afgan No. 21 lode mining claim, the certificate of location of which is of record in the office of the recorder of Eureka County, Nevada in Book 81 Page 469, in accordance with NRS 517.080. The general course of this claim is East/West. This claim is 1500 feet in length along the course of the claim, being 10 feet from the point of discovery in an East direction to the East end line of this claim, and 1490 feet in a West direction to the West end line of the claim. This claim is 600 feet in width, being 300 feet in width on each side of the center line of the claim.

This claim is located within the SW Quarter of Section 20, Township 22 North, Range 51 East Mount Diablo Base and Meridian, unknown Mining District, Eureka County, Nevada. The location monument of this claim is situated with reference to some natural object or permanent monument as follows: Corner No. 1 of this claim is located approximately 750 feet S 38° W from the located SE corner of Section 17, T22N, R51 E, MDM.

The corners of this claim are marked by 4" x 4" posts or pipe with metal tags inscribed with the appropriate corner number as shown on the following sketch and the accompanying claim map.

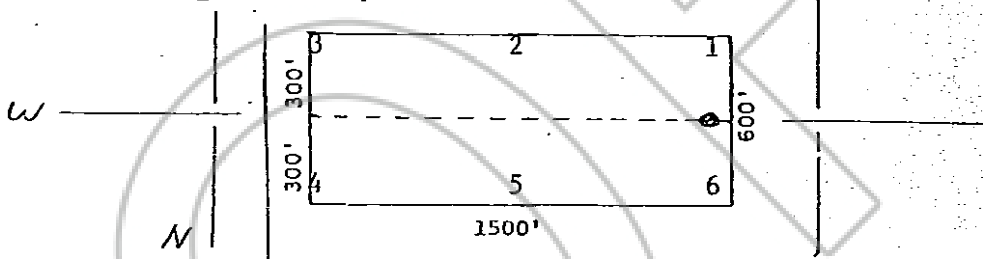

The location work consisted of making the maps provided in NRS 517.040.

Dated and posted on the ground this 22 day of July, 1980.

Witnesses:

Locator:

AMERICAN SELCO INC.

By

Jim Rie
Agent for
AMERICAN SELCO INC.

STATE OF NEVADA

COUNTY OF _____

) ss.

I hereby certify that the within instrument was filed and recorded at the request of: _____

FILE NO: _____

on _____

at _____

Book _____

Page _____

Witness my hand and official seal the day and year aforesaid.

County Recorder

By

Deputy Recorder

BOOK 88 PAGE 77

RECORDED AT REQUEST OF
American Selco Inc.
BOOK 88 PAGE 77

80 OCT 15 AID: 3.00

OFFICIAL RECORDS
EUREKA COUNTY, NEVADA
WILLIS A. DEPOSE
FILE NO. 77055
FEE \$ 3.00

77056

STATE OF NEVADA
 CERTIFICATE OF MINING LOCATION
 LODE CLAIM ON PUBLIC DOMAIN

NOTICE IS HEREBY GIVEN that Afgan No. 22 lode mining claim has been located by American Selco, a New York corporation, whose address 90 West Grove Street, Suite 100, Reno, Nevada 89509. This claim is a relocation of the Afgan No. 22 lode mining claim, the certificate of location of which is of record in the office of the recorder of Eureka County, Nevada in Book 81 Page 470, in accordance with NRS 517.080. The general course of this claim is East/West. This claim is 1500 feet in length along the course of the claim, being 1490 feet from the point of discovery in an East direction to the East end line of this claim, and 10 feet in a West direction to the West end line of the claim. This claim is 600 feet in width, being 300 feet in width on each side of the center line of the claim.

This claim is located within the SW Quarter of Section 20, Township 22 North, Range 51 East Mount Diablo Base and Meridian, unknown Mining District, Eureka County, Nevada. The location monument of this claim is situated with reference to some natural object or permanent monument as follows: Corner No. 1 of this claim is located approximately 750 feet S 38° W from the located SE corner of Section 17, T22N, R51 E, MDM.

The corners of this claim are marked by 4" x 4" posts or pipe with metal tags inscribed with the appropriate corner number as shown on the following sketch and the accompanying claim map.

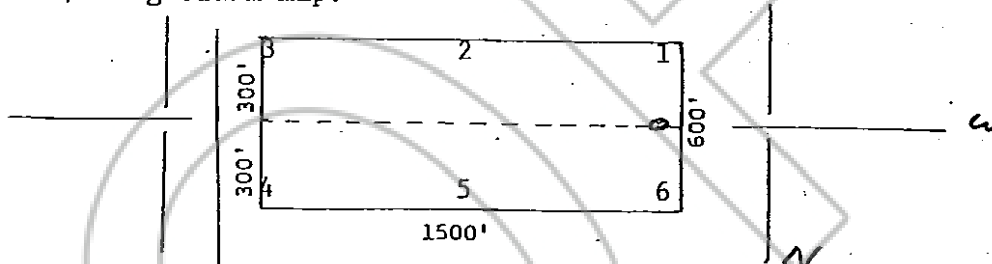

The location work consisted of making the maps provided in NRS 517.040.

Dated and posted on the ground this 22 day of July, 1980.

Witnesses:

Locator:

AMERICAN SELCO INC.

By

John Rice
 Agent for
 AMERICAN SELCO INC.

STATE OF NEVADA

COUNTY OF _____

ss.

I hereby certify that the within instrument was filed and recorded at the request of: _____
 FILE NO. _____
 on _____

Witness my hand and official seal the day and year aforesaid.

County Recorder

By

Deputy Recorder

RECORDED AT REQUEST OF
 American Selco, Inc.
 BOOK 88 PAGE 78

80 OCT 15 AID: 24

OFFICIAL RECORDER
 EUREKA COUNTY, NEVADA
 WILLIS A. DEPAUL
 FILE NO. 77056
 FEE \$ 3.00

Page _____

BOOK 88 PAGE 78

STATE OF NEVADA
 CERTIFICATE OF MINING LOCATION
 LODE CLAIM ON PUBLIC DOMAIN

NOTICE IS HEREBY GIVEN that Afgan No. 23 lode mining claim has been located by American Selco, a New York corporation, whose address 90 West Grove Street, Suite 100, Reno, Nevada 89509. This claim is a relocation of the Afgan No. 23 lode mining claim, the certificate of location of which is of record in the office of the recorder of Eureka County, Nevada in Book 81 Page 471, in accordance with NRS 517.080. The general course of this claim is East/West. This claim is 1500 feet in length along the course of the claim, being 10 feet from the point of discovery in an East direction to the East end line of this claim, and 1490 feet in a West direction to the West end line of the claim. This claim is 600 feet in width, being 300 feet in width on each side of the center line of the claim.

This claim is located within the NW Quarter of Section 29, Township 22 North, Range 51 East Mount Diablo Base and Meridian, unknown Mining District, Eureka County, Nevada. The location monument of this claim is situated with reference to some natural object or permanent monument as follows: Corner No. 1 of this claim is located approximately 7150 feet S 38° W from the located SE corner of Section 17, T22N, R51 E, MDM.

The corners of this claim are marked by 4" x 4" posts or pipe with metal tags inscribed with the appropriate corner number as shown on the following sketch and the accompanying claim map.

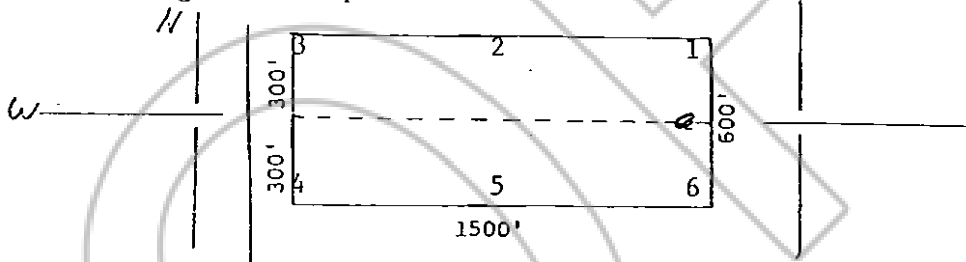

The location work consisted of making the maps provided in NRS 517.040.

Dated and posted on the ground this 22 day of July, 1980.

Witnesses:

Locator:

AMERICAN SELCO INC

By

Jim Rice
 Agent for
 AMERICAN SELCO INC.

STATE OF NEVADA)
) ss.
 COUNTY OF _____)

I hereby certify that the within instrument was filed and recorded at the request of : _____

FILE NO. _____

Witness my hand and official seal the day and year aforesaid.

County Recorder _____

By

Deputy Recorder _____

RECORDED AT REQUEST OF
 American Selco, Inc.
 BOOK 88 PAGE 79

80 OCT 15 A 10:30

OFFICIAL RECORDS
 EUREKA COUNTY
 WILLIS A. DEPOSEL
 FILE NO. 77057
 FEE \$ 3.00

BOOK 88 PAGE 79

CERTIFICATE OF MINING LOCATION

LODE CLAIM ON PUBLIC DOMAIN

NOTICE IS HEREBY GIVEN that Afgan No. 24 lode mining claim has been located by American Selco, a New York corporation, whose address 90 West Grove Street, Suite 100, Reno, Nevada 89509. This claim is a relocation of the Afgan No. 24 lode mining claim, the certificate of location of which is of record in the office of the recorder of Eureka County, Nevada in Book 81 Page 472, in accordance with NRS 517.080. The general course of this claim is East/West. This claim is 1500 feet in length along the course of the claim, being 1490 feet from the point of discovery in an East direction to the East end line of this claim, and 10 feet in a West direction to the West end line of the claim. This claim is 600 feet in width, being 300 feet in width on each side of the center line of the claim.

This claim is located within the NW Quarter of Section 29, Township 22 North, Range 51 East Mount Diablo Base and Meridian, unknown Mining District, Eureka County, Nevada. The location monument of this claim is situated with reference to some natural object or permanent monument as follows: Corner No. 1 of this claim is located approximately 750 feet S 38° W from the located SE corner of Section 17, T22N, R51 E, MDM.

The corners of this claim are marked by 4" x 4" posts or pipe with metal tags inscribed with the appropriate corner number as shown on the following sketch and the accompanying claim map.

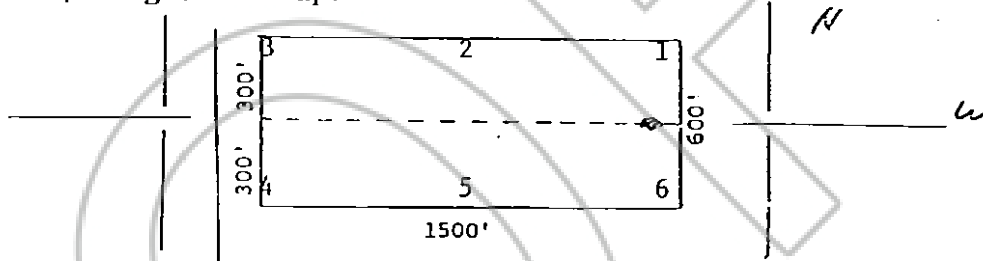

The location work consisted of making the maps provided in NRS 517.040.

Dated and posted on the ground this 22 day of July, 1980.

Witnesses:

Locator:

AMERICAN SELCO INC.

By

Jan Rice
Agent for
AMERICAN SELCO INC.

STATE OF NEVADA

COUNTY OF _____

ss.

I hereby certify that the within instrument was filed and recorded at the request of : _____

FILE NO. _____

Page _____

Witness my hand and official seal the day and year aforesaid.

County Recorder

By

Deputy Recorder

RECORDED AT REQUEST OF
American Selco Inc.
BOOK 88 PAGE 80

30 OCT 15 A 10:29

OFFICIAL RECORDS
EUREKA COUNTY, NEVADA
WILLIS A. DEPAUL
FILE NO. 77058
FEE \$ 3.00

77059

CERTIFICATE OF MINING LOCATION

LODE CLAIM ON PUBLIC DOMAIN

NOTICE IS HEREBY GIVEN that Afgan No. 25 lode mining claim has been located by American Selco, a New York corporation, whose address 90 West Grove Street, Suite 100, Reno, Nevada 89509. This claim is a relocation of the Afgan No. 25 lode mining claim, the certificate of location of which is of record in the office of the recorder of Eureka County, Nevada in Book 81 Page 473, in accordance with NRS 517.080. The general course of this claim is East/West. This claim is 1500 feet in length along the course of the claim, being 10 feet from the point of discovery in an East direction to the East end line of this claim, and 1490 feet in a West direction to the West end line of the claim. This claim is 600 feet in width, being 300 feet in width on each side of the center line of the claim.

This claim is located within the NW Quarter of Section 29, Township 22 North, Range 51 East Mount Diablo Base and Meridian, unknown Mining District, Eureka County, Nevada. The location monument of this claim is situated with reference to some natural object or permanent monument as follows: Corner No. 1 of this claim is located approximately 850 feet S 35° W from the located SE corner of Section 17, T22N, R51 E, MDM.

The corners of this claim are marked by 4" x 4" posts or pipe with metal tags inscribed with the appropriate corner number as shown on the following sketch and the accompanying claim map.

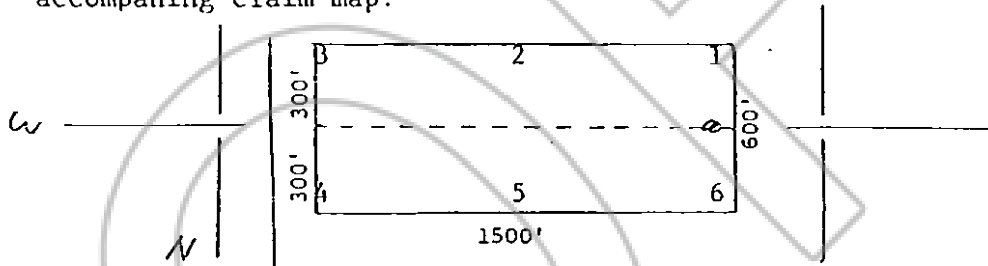

The location work consisted of making the maps provided in NRS 517.040.

Dated and posted on the ground this 22 day of July, 1980.

Witnesses:

Locator:

AMERICAN SELCO INC.

By

Jim Rice
Agent for
AMERICAN SELCO INC.

STATE OF NEVADA)
COUNTY OF) ss.

I hereby certify that the within instrument was filed and recorded at the request of :

FILE NO. _____

on _____

at _____

Docket _____ Page _____

Witness my hand and official seal the day and year aforesaid.

County Recorder

By

Deputy Recorder

BOOK 88 PAGE 81

RECORDED AT REQUEST OF
American Selco, Inc.
BOOK 88 PAGE 81

000115 A10:24

OFFICIAL RECORDS
EUREKA COUNTY, NEVADA
JILLIS A. DEWITT - RECORDER
77059
FILE NO. 3.00

77060

STATE OF NEVADA
 CERTIFICATE OF MINING LOCATION
 LODE CLAIM ON PUBLIC DOMAIN

NOTICE IS HEREBY GIVEN that Afgan No. 26 lode mining claim has been located by American Selco, a New York corporation, whose address 90 West Grove Street, Suite 100, Reno, Nevada 89509. This claim is a relocation of the Afgan No. 26 lode mining claim, the certificate of location of which is of record in the office of the recorder of Eureka County, Nevada in Book 81 Page 474, in accordance with NRS 517.080. The general course of this claim is East/West. This claim is 1500 feet in length along the course of the claim, being 1490 feet from the point of discovery in an East direction to the East end line of this claim, and 10 feet in a West direction to the West end line of the claim. This claim is 600 feet in width, being 300 feet in width on each side of the center line of the claim.

This claim is located within the NW Quarter of Section 29, Township 22 North, Range 51 East Mount Diablo Base and Meridian, unknown Mining District, Eureka County, Nevada. The location monument of this claim is situated with reference to some natural object or permanent monument as follows: Corner No. 1 of this claim is located approximately 8150 feet S 35° W from the located SE corner of Section 17, T22N, R51 E, MDM.

The corners of this claim are marked by 4" x 4" posts or pipe with metal tags inscribed with the appropriate corner number as shown on the following sketch and the accompanying claim map.

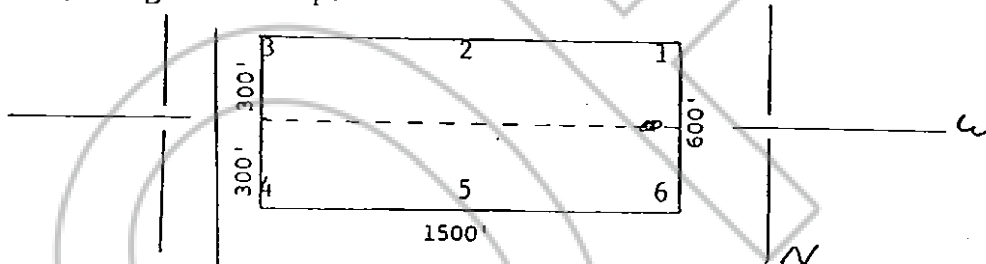

The location work consisted of making the maps provided in NRS 517.040.

Dated and posted on the ground this 22 day of July, 1980.

Witnesses:

Locator:

AMERICAN SELCO INC.

By

Agent for
 AMERICAN SELCO INC.

STATE OF NEVADA)
 COUNTY OF _____) ss.

I hereby certify that the within instrument was filed and recorded at the request of : _____
 FILE NO: _____

Witness my hand and official seal the day and year aforesaid.

County Recorder

By _____
 Deputy Recorder

BOOK 88 PAGE 82

RECORDED AT REQUEST OF
 American Selco Inc.
 BOOK 88 PAGE 82

80 OCT 15 AIO 22 B

OFFICIAL RECORDS
 EUREKA COUNTY, NEVADA
 WILLIS A. DEWITT, RECORDER
 FILE NO. 77060
 FEE \$ 3.00

Page _____

STATE OF NEVADA
77061 CERTIFICATE OF MINING LOCATION
LODE CLAIM ON PUBLIC DOMAIN

NOTICE IS HEREBY GIVEN that Afgan No. 27 lode mining claim has been located by American Selco, a New York corporation, whose address 90 West Grove Street, Suite 100, Reno, Nevada 89509. This claim is a relocation of the Afgan No. 27 lode mining claim, the certificate of location of which is of record in the office of the recorder of Eureka County, Nevada in Book 81 Page 475, in accordance with NRS 517.080. The general course of this claim is East/West. This claim is 1500 feet in length along the course of the claim, being 1490 feet from the point of discovery in an East direction to the East end line of this claim, and 10 feet in a West direction to the West end line of the claim. This claim is 600 feet in width, being 300 feet in width on each side of the center line of the claim.

This claim is located within the N/E Quarter of Section 20, Township 22 North, Range 51 East Mount Diablo Base and Meridian, unknown Mining District, Eureka County, Nevada. The location monument of this claim is situated with reference to some natural object or permanent monument as follows: Corner No. 1 of this claim is located approximately 750 feet N 73° W from the located SE corner of Section 17, T22N, R51 E, MDM.

The corners of this claim are marked by 4" x 4" posts or pipe with metal tags inscribed with the appropriate corner number as shown on the following sketch and the accompanying claim map.

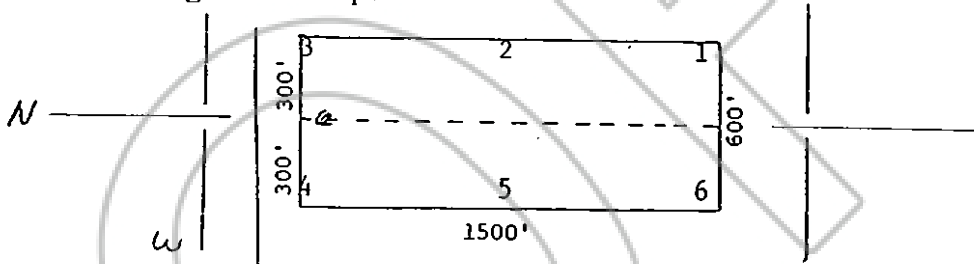

The location work consisted of making the maps provided in NRS 517.040.

Dated and posted on the ground this 22 day of July, 1980.

Witnesses:

Locator:

AMERICAN SELCO INC.

By

Agent for Rice
AMERICAN SELCO INC.

STATE OF NEVADA

COUNTY OF

ss.

I hereby certify that the within instrument was filed and recorded at the request of :
FILE NO. _____

Witness my hand and official seal the day and year aforesaid.

County Recorder

By

Deputy Recorder

RECORDED AT REQUEST OF
American Selco Inc.
BOOK 88 PAGE 83

80 OCT 15 A 10:23

OFFICIAL RECORDER
EUREKA COUNTY, NEVADA
WILLIS A. BELL
77061
FEE \$3.00

Page

BOOK 88 PAGE 83

STATE OF NEVADA
77062 CERTIFICATE OF MINING LOCATION
LODE CLAIM ON PUBLIC DOMAIN

NOTICE IS HEREBY GIVEN that Afgan No. 28 lode mining claim has been located by American Selco, a New York corporation, whose address 90 West Grove Street, Suite 100, Reno, Nevada 89509. This claim is a relocation of the Afgan No. 28 lode mining claim, the certificate of location of which is of record in the office of the recorder of Eureka County, Nevada in Book 81 Page 476, in accordance with NRS 517.080. The general course of this claim is East/West. This claim is 1500 feet in length along the course of the claim, being 1490 feet from the point of discovery in an East direction to the East end line of this claim, and 10 feet in a West direction to the West end line of the claim. This claim is 600 feet in width, being 300 feet in width on each side of the center line of the claim.

This claim is located within the NE Quarter of Section 20, Township 22 North, Range 51 East Mount Diablo Base and Meridian, unknown Mining District, Eureka County, Nevada. The location monument of this claim is situated with reference to some natural object or permanent monument as follows: Corner No. 1 of this claim is located approximately 1750 feet $S\ N\ 23^{\circ} W$ from the located SE corner of Section 17, T22N, R51 E, MDM.

The corners of this claim are marked by 4" x 4" posts or pipe with metal tags inscribed with the appropriate corner number as shown on the following sketch and the accompanying claim map.

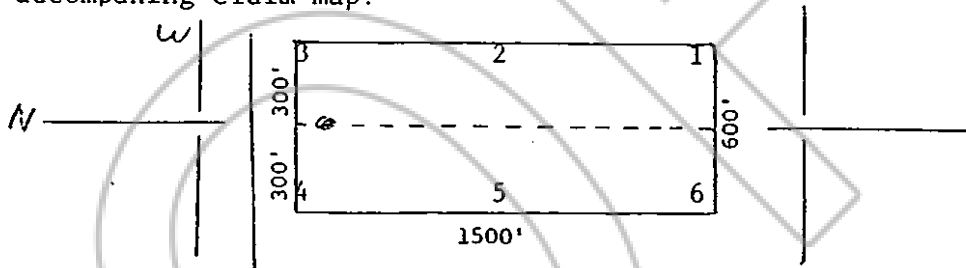

The location work consisted of making the maps provided in NRS 517.040.

Dated and posted on the ground this 22 day of July, 1980.

Witnesses:

Locator:

AMERICAN SELCO INC.

By Jim Rice
Agent for
AMERICAN SELCO INC.

STATE OF NEVADA)
COUNTY OF _____) ss.

I hereby certify that the within instrument was filed and recorded at the request of : _____
FILE NO. _____

Witness my hand and official seal the day and year aforesaid.

County Recorder

By _____
Deputy Recorder

RECORDED AT REQUEST OF
American Selco, Inc.
BOOK 88 PAGE 84

800 OCT 15 A10

OFFICIAL RECORDS
EUREKA COUNTY, NEVADA
WILLIS A. DEPAOLIS, RECORDER
FILE NO. 77062
REC \$3.00

BOOK 88 PAGE 84

STATE OF NEVADA
77063 CERTIFICATE OF MINING LOCATION
LODE CLAIM ON PUBLIC DOMAIN

NOTICE IS HEREBY GIVEN that Afgan No. 29 lode mining claim has been located by American Selco, a New York corporation, whose address 90 West Grove Street, Suite 100, Reno, Nevada 89509. This claim is a relocation of the Afgan No. 29 lode mining claim, the certificate of location of which is of record in the office of the recorder of Eureka County, Nevada in Book 81 Page 477, in accordance with NRS 517.080. The general course of this claim is East/West. This claim is 1500 feet in length along the course of the claim, being 1490 feet from the point of discovery in an East direction to the East end line of this claim, and 10 feet in a West direction to the West end line of the claim. This claim is 600 feet in width, being 300 feet in width on each side of the center line of the claim.

This claim is located within the NE Quarter of Section 20, Township 22 North, Range 51 East Mount Diablo Base and Meridian, unknown Mining District, Eureka County, Nevada. The location monument of this claim is situated with reference to some natural object or permanent monument as follows: Corner No. 1 of this claim is located approximately 1600 feet S 67° W from the located SE corner of Section 17, T22N, R51 E, MDM.

The corners of this claim are marked by 4" x 4" posts or pipe with metal tags inscribed with the appropriate corner number as shown on the following sketch and the accompanying claim map.

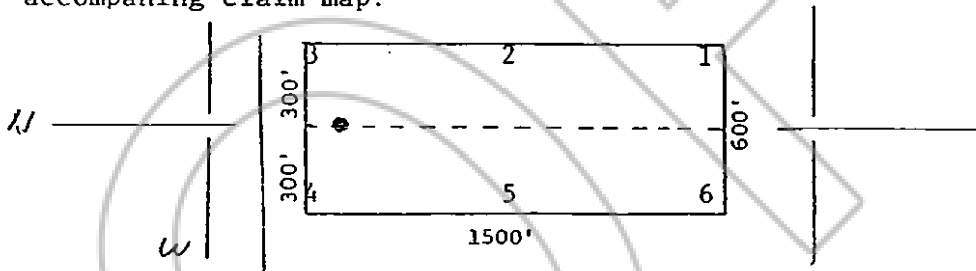

The location work consisted of making the maps provided in NRS 517.040.

Dated and posted on the ground this 22 day of July, 1980.

Witnesses:

Locator:

AMERICAN SELCO INC

By

Jim Rice
Agent for
AMERICAN SELCO INC.

STATE OF NEVADA)
COUNTY OF) ss.

I hereby certify that the within instrument was filed and recorded at the request of :
FILE NO. _____

Witness my hand and official seal the day and year aforesaid.

County Recorder

By _____
Deputy Recorder

RECORDED AT REQUEST OF
American Selco, Inc.
BOOK 88 PAGE 85

80 OCT 15 AIO:CH

OFFICIAL RECORDS
EUREKA COUNTY, NEVADA
WILLIS A. DEPAOLI-RECORDER
FILE NO. 77063
FEE \$ 3.00

Page _____

BOOK 88 PAGE 85

77064

STATE OF NEVADA

CERTIFICATE OF MINING LOCATION

LODE CLAIM ON PUBLIC DOMAIN

NOTICE IS HEREBY GIVEN that Afgan No. 30 lode mining claim has been located by American Selco, a New York corporation, whose address 90 West Grove Street, Suite 100, Reno, Nevada 89509. This claim is a relocation of the Afgan No. 30 lode mining claim, the certificate of location of which is of record in the office of the recorder of Eureka County, Nevada in Book 81 Page 478, in accordance with NRS 517.080. The general course of this claim is East/West. This claim is 1500 feet in length along the course of the claim, being 1490 feet from the point of discovery in an East direction to the East end line of this claim, and 10 feet in a West direction to the West end line of the claim. This claim is 600 feet in width, being 300 feet in width on each side of the center line of the claim.

This claim is located within the N/E Quarter of Section 20, Township 22 North, Range 51 East Mount Diablo Base and Meridian, unknown Mining District, Eureka County, Nevada. The location monument of this claim is situated with reference to some natural object or permanent monument as follows: Corner No. 1 of this claim is located approximately 600 feet S 67° W from the located SE corner of Section 17, T22N, R51 E, MDM.

The corners of this claim are marked by 4" x 4" posts or pipe with metal tags inscribed with the appropriate corner number as shown on the following sketch and the accompanying claim map.

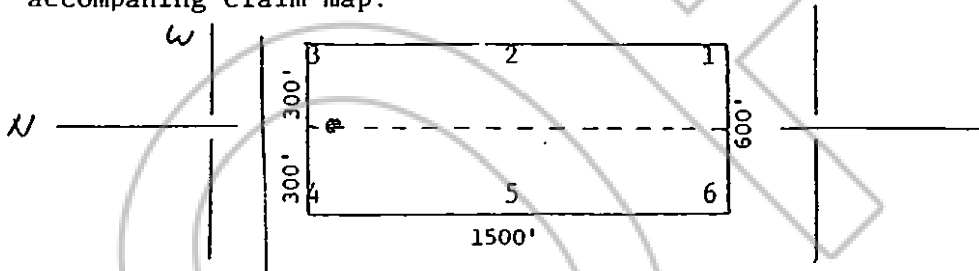

The location work consisted of making the maps provided in NRS 517.040.

Dated and posted on the ground this 22 day of July, 1980.

Witnesses:

Locator:

AMERICAN SELCO INC

By

Agent for
AMERICAN SELCO INC.

STATE OF NEVADA)

) ss.

COUNTY OF _____)

I hereby certify that the within instrument was filed and recorded at the request of _____

Witness my hand and official seal the day and year aforesaid.

County Recorder

By

Deputy Recorder

RECORDED AT REQUEST OF
American Selco Inc.
BOOK 88 PAGE 86

80 OCT 15 1980
OFFICIAL RECORDS
EUREKA COUNTY, NEVADA
WILLIS A. DEPAUL RECORDER
FILE NO. 77064
FEE \$ 3.00

Page

BOOK 88 PAGE 86

STATE OF NEVADA
77065 CERTIFICATE OF MINING LOCATION
LODE CLAIM ON PUBLIC DOMAIN

NOTICE IS HEREBY GIVEN that Afgan No. 31 lode mining claim has been located by American Selco, a New York corporation, whose address 90 West Grove Street, Suite 100, Reno, Nevada 89509. This claim is a relocation of the Afgan No. 31 lode mining claim, the certificate of location of which is of record in the office of the recorder of Eureka County, Nevada in Book 81 Page 479, in accordance with NRS 517.080. The general course of this claim is East/West. This claim is 1500 feet in length along the course of the claim, being 1490 feet from the point of discovery in an East direction to the East end line of this claim, and 10 feet in a West direction to the West end line of the claim. This claim is 600 feet in width, being 300 feet in width on each side of the center line of the claim.

This claim is located within the N/E Quarter of Section 20, Township 22 North, Range 51 East Mount Diablo Base and Meridian, unknown Mining District, Eureka County, Nevada. The location monument of this claim is situated with reference to some natural object or permanent monument as follows: Corner No. 1 of this claim is located approximately 2500 feet S 41° W from the located SE corner of Section 17, T22N, R51 E, MDM.

The corners of this claim are marked by 4" x 4" posts or pipe with metal tags inscribed with the appropriate corner number as shown on the following sketch and the accompanying claim map.

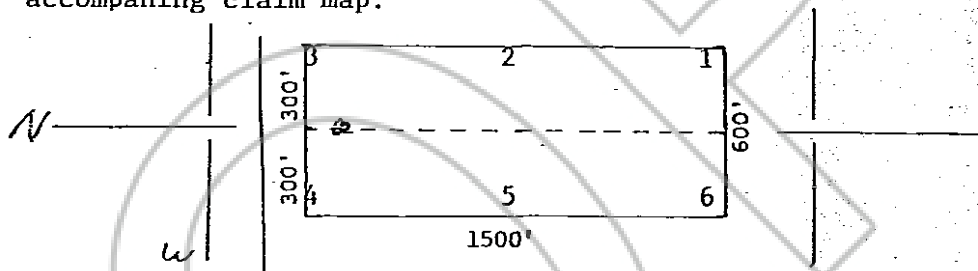

The location work consisted of making the maps provided in NRS 517.040.

Dated and posted on the ground this 22 day of July, 1980.

Witnesses:

Locator:

AMERICAN SELCO INC.

By

Jim Rice
Agent for
AMERICAN SELCO INC.

STATE OF NEVADA

COUNTY OF _____

ss.

I hereby certify that the within instrument was filed and recorded at the request of : _____

FILE NO. _____

on _____

at _____

Book _____

Page _____

Witness my hand and official seal the day and year aforesaid.

County Recorder

By

Deputy Recorder

RECORDED AT REQUEST OF
American Selco, Inc.
BOOK 88 PAGE 87

80 OCT 15 A10:22

OFFICIAL RECORDS
EUREKA COUNTY, NEVADA
WILLIS A. DEBOL, RECORDER
FILE NO. 77065
FEE \$ 3.00

BOOK 88 PAGE 87

STATE OF NEVADA
 CERTIFICATE OF MINING LOCATION
 LODE CLAIM ON PUBLIC DOMAIN

NOTICE IS HEREBY GIVEN that Afgan No. 32 lode mining claim has been located by American Selco, a New York corporation, whose address 90 West Grove Street, Suite 100, Reno, Nevada 89509. This claim is a relocation of the Afgan No. 32 lode mining claim, the certificate of location of which is of record in the office of the recorder of Eureka County, Nevada in Book 81 Page 480, in accordance with NRS 517.080. The general course of this claim is East/West. This claim is 1500 feet in length along the course of the claim, being 1490 feet from the point of discovery in an East direction to the East end line of this claim, and 10 feet in a West direction to the West end line of the claim. This claim is 600 feet in width, being 300 feet in width on each side of the center line of the claim.

This claim is located within the NE Quarter of Section 20, Township 22 North, Range 51 East Mount Diablo Base and Meridian, unknown Mining District, Eureka County, Nevada. The location monument of this claim is situated with reference to some natural object or permanent monument as follows: Corner No. 1 of this claim is located approximately 2500 feet S 41° W from the located SE corner of Section 17, T22N, R51 E, MDM.

The corners of this claim are marked by 4" x 4" posts or pipe with metal tags inscribed with the appropriate corner number as shown on the following sketch and the accompanying claim map.

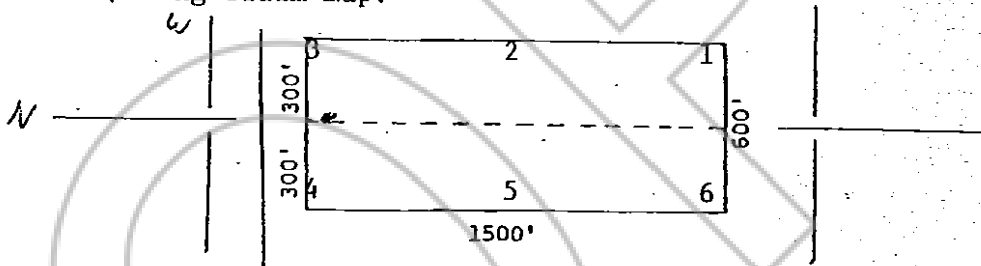

The location work consisted of making the maps provided in NRS 517.040.

Dated and posted on the ground this 22 day of July, 1980.

Witnesses:

Locator:

AMERICAN SELCO INC.

By

Jim Rice
 Agent for
 AMERICAN SELCO INC.

STATE OF NEVADA

ss.

COUNTY OF _____

I hereby certify that the within instrument was filed and recorded at the request of: _____
 FILE NO. _____

Witness my hand and official seal the day and year aforesaid.

County Recorder

By

Deputy Recorder

RECORDED AT REQUEST OF
 American Selco Inc.
 BOOK 88 PAGE 88

80 OCT 15 AIO 229

OFFICIAL RECORDS
 EUREKA COUNTY, NEVADA
 WILLIS A. DEPAUL-BEDDNER
 FILE NO. 77066
 FEE \$3.00

Page

BOOK 88 PAGE 88

STATE OF NEVADA
 CERTIFICATE OF MINING LOCATION
 LODE CLAIM ON PUBLIC DOMAIN

NOTICE IS HEREBY GIVEN that Afgan No. 33 lode mining claim has been located by American Selco, a New York corporation, whose address 90 West Grove Street, Suite 100, Reno, Nevada 89509. This claim is a relocation of the Afgan No. 33 lode mining claim, the certificate of location of which is of record in the office of the recorder of Eureka County, Nevada in Book 81 Page 481, in accordance with NRS 517.080. The general course of this claim is East/West. This claim is 1500 feet in length along the course of the claim, being 1470 feet from the point of discovery in an East direction to the East end line of this claim, and 10 feet in a West direction to the West end line of the claim. This claim is 600 feet in width, being 300 feet in width on each side of the center line of the claim.

This claim is located within the SE Quarter of Section 20, Township 22 North, Range 51 East Mount Diablo Base and Meridian, unknown Mining District, Eureka County, Nevada. The location monument of this claim is situated with reference to some natural object or permanent monument as follows: Corner No. 1 of this claim is located approximately 300 feet S 28° W from the located SE corner of Section 17, T22N, R51 E, MDM.

The corners of this claim are marked by 4" x 4" posts or pipe with metal tags inscribed with the appropriate corner number as shown on the following sketch and the accompanying claim map.

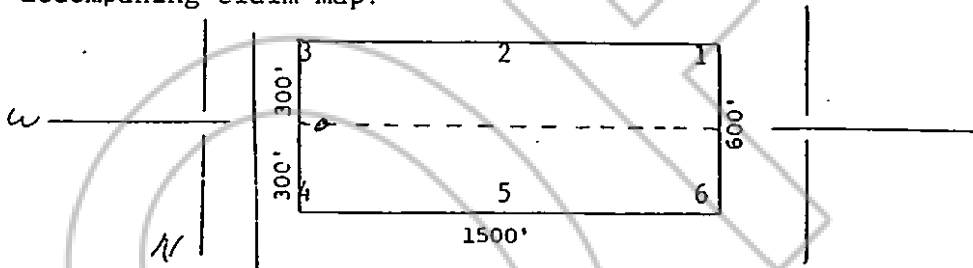

The location work consisted of making the maps provided in NRS 517.040.

Dated and posted on the ground this 22 day of July, 1980.

Witnesses:

Locator:

AMERICAN SELCO INC.

By

Jim Rice
 Agent for
 AMERICAN SELCO INC.

STATE OF NEVADA)

COUNTY OF) ss.

I hereby certify that the within instrument was filed and recorded at the request of : _____
 FILE NO: _____

Witness my hand and official seal the day and year aforesaid. _____

County Recorder

By

Deputy Recorder

RECORDED AT REQUEST OF
 American Selco Inc.
 BOOK 88 PAGE 89

80 OCT 15 A 10 08

OFFICIAL RECORDS
 EUREKA COUNTY (NEV.)
 WILLIS A. DEPAUL RECORDER
 FILE NO 22067
 REC 3.00

Page

BOOK 88 PAGE 89

STATE OF NEVADA
 CERTIFICATE OF MINING LOCATION
LODE CLAIM ON PUBLIC DOMAIN

NOTICE IS HEREBY GIVEN that Afgan No. 34 lode mining claim has been located by American Selco, a New York corporation, whose address 90 West Grove Street, Suite 100, Reno, Nevada 89509. This claim is a relocation of the Afgan No. 34 lode mining claim, the certificate of location of which is of record in the office of the recorder of Eureka County, Nevada in Book 81 Page 462, in accordance with NRS 517.080. The general course of this claim is East/West. This claim is 1500 feet in length along the course of the claim, being 1490 feet from the point of discovery in an East direction to the East end line of this claim, and 10 feet in a West direction to the West end line of the claim. This claim is 600 feet in width, being 300 feet in width on each side of the center line of the claim.

This claim is located within the SE Quarter of Section 20, Township 22 North, Range 51 East Mount Diablo Base and Meridian, unknown Mining District, Eureka County, Nevada. The location monument of this claim is situated with reference to some natural object or permanent monument as follows: Corner No. 1 of this claim is located approximately 3500 feet S 28° W from the located SE corner of Section 17, T22N, R51 E, MDM.

The corners of this claim are marked by 4" x 4" posts or pipe with metal tags inscribed with the appropriate corner number as shown on the following sketch and the accompanying claim map.

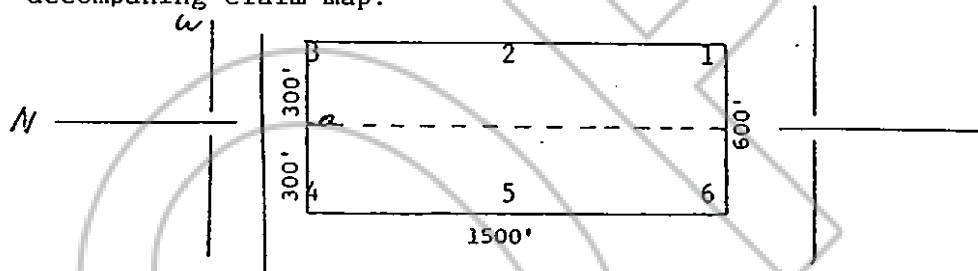

The location work consisted of making the maps provided in NRS 517.040.

Dated and posted on the ground this 22 day of July, 1980.

Witnesses:

Locator:

AMERICAN SELCO INC.

By

Jim Rice
 Agent for
 AMERICAN SELCO INC.

STATE OF NEVADA)
) ss.
 COUNTY OF _____)

I hereby certify that the within instrument was filed and recorded at the request of: _____
 FILE NO. _____

Witness my hand and official seal the day and year aforesaid.

 County Recorder

By _____
 Deputy Recorder

BOOK 88 PAGE 90

RECORDED AT REQUEST OF
 American Selco, Inc.
 BOOK 88 PAGE 90

80 OCT 15 A 10:25

OFFICIAL RECORDS
 EUREKA COUNTY, NEVADA
 WILLIS A. DEARDEN, REC'D
 FILE NO. 77068
 FEE \$ 3.00

Page _____

The corners of this claim are marked by 4" x 4" posts or pipe with metal tags inscribed with the appropriate corner number as shown on the following sketch and the accompanying claim map.

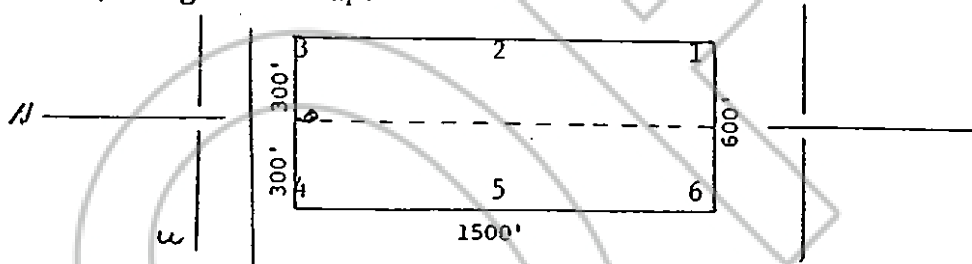

Dated and posted on the ground this 22 day of July, 1980.

Witnesses:

Locator:

AMERICAN SELCO INC

By [Signature]
Agent for
AMERICAN SELCO INC.

[illegible]

I hereby certify that the within instrument was filed and recorded at the request of :

Witness my hand and
official seal the day
and year aforesaid.

County Recorder

By Deputy Recorder

RECORDED AT REQUEST OF
American Sales, Inc.
BOOK 88 PAGE 91

FILE NO.
80 OCT 15 AM 10 26
Baker

OFFICIAL RECORDS
COREKA COUNTY INVIDIA
WILLIS A. DEPAOLI RECORDER
FBI NO. 77069
FEE \$3.00

77070

LODE CLAIM ON PUBLIC DOMAIN

NOTICE IS HEREBY GIVEN that Afgan No. 36 lode mining claim has been located by American Selco, a New York corporation, whose address 90 West Grove Street, Suite 100, Reno, Nevada 89509. This claim is a relocation of the Afgan No. 36 lode mining claim, the certificate of location of which is of record in the office of the recorder of Eureka County, Nevada in Book 81 Page 464, in accordance with NRS 517.080. The general course of this claim is East/West. This claim is 1500 feet in length along the course of the claim, being 1490 feet from the point of discovery in an East direction to the East end line of this claim, and 10 feet in a West direction to the West end line of the claim. This claim is 600 feet in width, being 300 feet in width on each side of the center line of the claim.

This claim is located within the SE Quarter of Section 20, Township 22 North, Range 51 East Mount Diablo Base and Meridian, unknown Mining District, Eureka County, Nevada. The location monument of this claim is situated with reference to some natural object or permanent monument as follows: Corner No. 1 of this claim is located approximately 4550 feet S 21° W from the located SE corner of Section 17, T22N, R51 E, MDM.

The corners of this claim are marked by 4" x 4" posts or pipe with metal tags inscribed with the appropriate corner number as shown on the following sketch and the accompanying claim map.

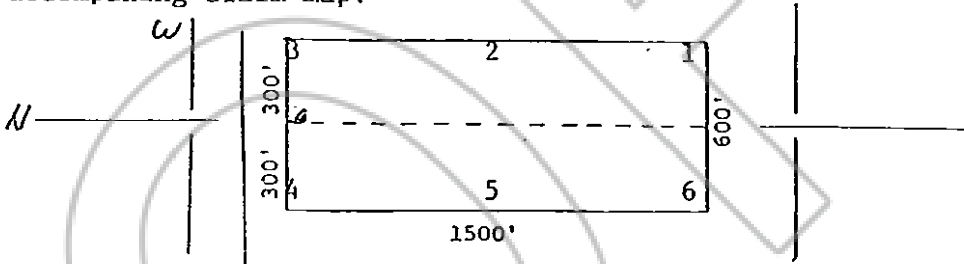

The location work consisted of making the maps provided in NRS 517.040.

Dated and posted on the ground this 22 day of July, 1980.

Witnesses:

Locator:

AMERICAN SELCO INC.

By

Agent for
AMERICAN SELCO INC.

STATE OF NEVADA

) ss.

COUNTY OF

I hereby certify that the within instrument was filed and recorded at the request of :

Witness my hand and official seal the day and year aforesaid.

County Recorder

By

Deputy Recorder

RECORDED AT REQUEST OF
American Selco Inc.
BOOK 88 PAGE 92

80 OCT 15 AM 10:25

OFFICIAL RECORDS
EUREKA COUNTY, NEVADA
WILLIS A. DEPAOLI, RECORDER
FILE NO. 77070
FEE \$3.00

Page

BOOK 88 PAGE 92

STATE OF NEVADA
CERTIFICATE OF MINING LOCATION
LODE CLAIM ON PUBLIC DOMAIN

NOTICE IS HEREBY GIVEN that Afgan No. 37 lode mining claim has been located by American Selco, a New York corporation, whose address 90 West Grove Street, Suite 100, Reno, Nevada 89509. This claim is a relocation of the Afgan No. 37 lode mining claim, the certificate of location of which is of record in the office of the recorder of Eureka County, Nevada in Book 81 Page 485, in accordance with NRS 517.080. The general course of this claim is East/West. This claim is 1500 feet in length along the course of the claim, being 1490 feet from the point of discovery in an East direction to the East end line of this claim, and 10 feet in a West direction to the West end line of the claim. This claim is 600 feet in width, being 300 feet in width on each side of the center line of the claim.

This claim is located within the SE Quarter of Section 20, Township 22 North, Range 51 East Mount Diablo Base and Meridian, unknown Mining District, Eureka County, Nevada. The location monument of this claim is situated with reference to some natural object or permanent monument as follows: Corner No. 1 of this claim is located approximately 5700 feet S 17° W from the located SE corner of Section 17, T22N, R51 E, MDM.

The corners of this claim are marked by 4" x 4" posts or pipe with metal tags inscribed with the appropriate corner number as shown on the following sketch and the accompanying claim map.

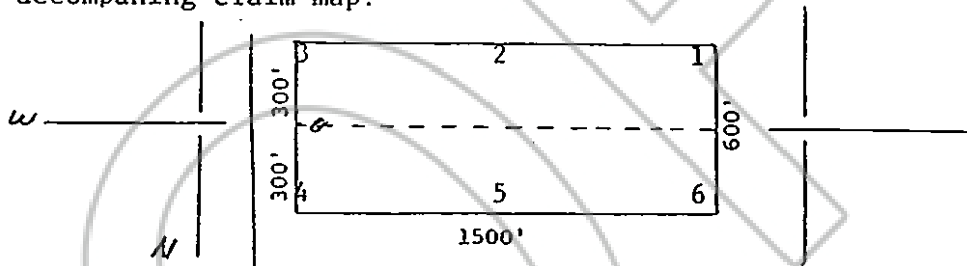

The location work consisted of making the maps provided in NRS 517.040.

Dated and posted on the ground this 22 day of July, 1980.

Witnesses:

Locator:

AMERICAN SELCO INC.

By

Jim Rie
Agent for
AMERICAN SELCO INC.

STATE OF NEVADA)
COUNTY OF _____) ss.

I hereby certify that the within instrument was filed and recorded at the request of : _____
FILE NO. _____

Witness my hand and official seal the day and year aforesaid.

on _____
at _____
Docket _____ Page _____

County Recorder

By

Deputy Recorder

RECORDED AT REQUEST OF
American Selco, Inc.
BOOK 88 PAGE 93

0 OCT 15 AIO: 29

OFFICIAL RECORDS
EUREKA COUNTY, NEVADA
JILLIS A. DEPAULI, RECORDER
FILE NO. 77071
FEE \$ 3.00

STATE OF NEVADA
CERTIFICATE OF MINING LOCATION
77072
LODE CLAIM ON PUBLIC DOMAIN

NOTICE IS HEREBY GIVEN that Afgan No. 38 lode mining claim has been located by American Selco, a New York corporation, whose address 90 West Grove Street, Suite 100, Reno, Nevada 89509. This claim is a relocation of the Afgan No. 38 lode mining claim, the certificate of location of which is of record in the office of the recorder of Eureka County, Nevada in Book 81 Page 486, in accordance with NRS 517.080. The general course of this claim is East/West. This claim is 1500 feet in length along the course of the claim, being 1490 feet from the point of discovery in an East direction to the East end line of this claim, and 10 feet in a West direction to the West end line of the claim. This claim is 600 feet in width, being 300 feet in width on each side of the center line of the claim.

This claim is located within the SE Quarter of Section 20, Township 22 North, Range 51 East Mount Diablo Base and Meridian, unknown Mining District, Eureka County, Nevada. The location monument of this claim is situated with reference to some natural object or permanent monument as follows: Corner No. 1 of this claim is located approximately 5700 feet S 17° W from the located SE corner of Section 17, T22N, R51 E, MDM.

The corners of this claim are marked by 4" x 4" posts or pipe with metal tags inscribed with the appropriate corner number as shown on the following sketch and the accompanying claim map.

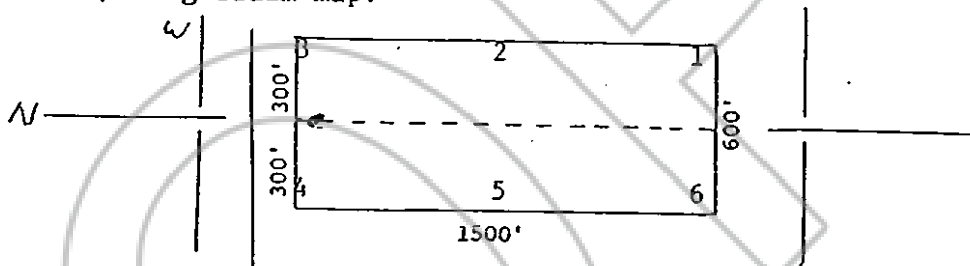

The location work consisted of making the maps provided in NRS 517.040.

Dated and posted on the ground this 22 day of July, 1980.

Witnesses:

Locator:

AMERICAN SELCO INC.

By Jim Rice
Agent for
AMERICAN SELCO INC.

STATE OF NEVADA)
COUNTY OF _____) ss.

I hereby certify that the within instrument was filed and recorded at the request of : _____

FILE NO. _____

on _____

at _____

Book _____ Page _____

Witness my hand and official seal the day and year aforesaid.

County Recorder

By _____
Deputy Recorder

BOOK 88 PAGE 94

RECORDED AT REQUEST OF
American Selco Inc.
BOOK 88 PAGE 94

000115 A10:28

OFFICIAL RECORDS
EUREKA COUNTY, NEVADA
WILLIS A. DEPAUL-RECORDER
FILE NO. 77072
FEE \$ 3.00

CERTIFICATE OF MINING LOCATION

LODE CLAIM ON PUBLIC DOMAIN

NOTICE IS HEREBY GIVEN that Afgan No. 39 lode mining claim has been located by American Selco, a New York corporation, whose address 90 West Grove Street, Suite 100, Reno, Nevada 89509. This claim is a relocation of the Afgan No. 39 lode mining claim, the certificate of location of which is of record in the office of the recorder of Eureka County, Nevada in Book 81 Page 487, in accordance with NRS 517.080. The general course of this claim is East/West. This claim is 1500 feet in length along the course of the claim, being 1490 feet from the point of discovery in an East direction to the East end line of this claim, and 10 feet in a West direction to the West end line of the claim. This claim is 600 feet in width, being 300 feet in width on each side of the center line of the claim.

This claim is located within the SE Quarter of Section 20, Township 22 North, Range 51 East Mount Diablo Base and Meridian, unknown Mining District, Eureka County, Nevada. The location monument of this claim is situated with reference to some natural object or permanent monument as follows: Corner No. 1 of this claim is located approximately 7050 feet S 14° W from the located SE corner of Section 17, T22N, R51 E, MDM.

The corners of this claim are marked by 4" x 4" posts or pipe with metal tags inscribed with the appropriate corner number as shown on the following sketch and the accompanying claim map.

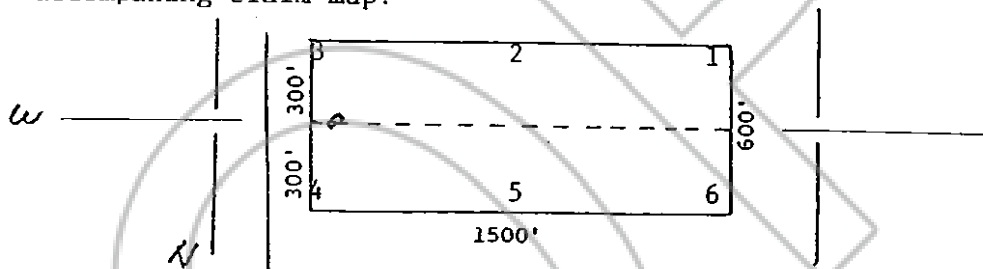

The location work consisted of making the maps provided in NRS 517.040.

Dated and posted on the ground this 22 day of July, 1980.

Witnesses:

Locator:

AMERICAN SELCO INC.

By

Jim Rine
Agent for
AMERICAN SELCO INC.

STATE OF NEVADA

ss.

COUNTY OF _____

I hereby certify that the within instrument was filed and recorded at the request of: _____
FILE NO. _____

Witness my hand and official seal the day and year aforesaid.

County Recorder

By

Deputy Recorder

RECORDED AT REQUEST OF
American Selco Inc.
BOOK 88 PAGE 95

80 OCT 15 A 10
OFFICIAL RECORDS
EUREKA COUNTY, NEVADA
WILLIS A. DEPAULIS, RECORDER
FILE NO. 220000
FEE \$ 3.00

BOOK 88 PAGE 95