

NOTICE IS HEREBY GIVEN that the Afgan No. 50 lode mining claim has been located by AMERICAN SELCO INC. a New York corporation, whose address is 99 West Grove Street, Suite 100, Reno, Nevada 89509. The general course of this claim is East/West. This claim is 1500 feet in length along the course of the claim, being 1490 feet from the point of discovery in a West direction to the West end line of this claim, and 10 feet in a East direction to the East end line of the claim. This claim is 600 feet in width, being 300 feet in width on each side of the center line of the claim.

This claim is located within the NW Quarter of Section 17, Township 22 North, Range 51 East, Mount Diablo Base and Meridian, unknown Mining District, Eureka County, Nevada. The location monument of this claim is situated with reference to some natural object or permanent monument as follows: corner no. 1 of this claim is located approximately 2340 feet N40 W of Claim Location Marker AF 2

Claim Location Marker AF2, a 3" x 6' steel pipe, is located approximately 9,500' S3°E of peak 7,137', 3,050' S19°W of peak 7,091', 6,200' S51°30'W of peak 6,855', Sec. 17, T22N, R51E, MDM

The corners of this claim are marked by 4"x4" posts or 4" trees with metal tags inscribed with the appropriate corner number as shown on the following sketch and the accompanying claim map.

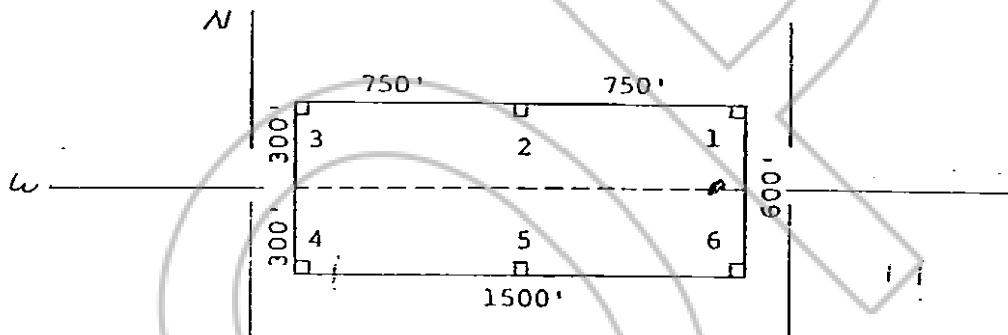

The location work consisted of making the maps as provided in NRS 517.040.

Dated and posted on the ground this 23rd day of July.

Witnesses:

RECORDED AT REQUEST OF
American Selco Inc.
BOOK 88 PAGE 106

Locator:

AMERICAN SELCO INC.

80 OCT 15 AIO: 34

By

Agent for

American Selco Inc.

STATE OF NEVADA

OFFICIAL RECORDS
EUREKA COUNTY, NEVADA
WILLIS A. DEPAUL, RECORDER
FILE NO. 77085
FEE \$ 3.00

COUNTY OF _____

I hereby certify that the within instrument was filed and recorded at the request of: _____

FILE NO. _____

on _____

at _____

Docket _____ Page _____

Witness my hand and official seal the day and year aforesaid.

County Recorder

By

Deputy Recorder