

77252

NOTICE IS HEREBY GIVEN that the St. Pat No. 46
lode mining claim has been located by AMERICAN SELCO INC.
a New York corporation, whose address is 90 West Grove Street,
Suite 100, Reno, Nevada 89509. The general course of this claim
is North/South. This claim is 1500 feet in length
along the course of the claim, being 1480 feet from the point
of discovery in a North direction to the North end
line of this claim, and 10 feet in a South
direction to the South end line of the claim. This claim is
600 feet in width, being 300 feet in width on each side of the
center line of the claim.

This claim is located within the NE Quarter
of Section 21, Township 18 North, Range 52
East, Mount Diablo Base and Meridian, 1 Eureka Mining District,
Eureka County, Nevada. The location monument of this claim is
situated with reference to some natural object or permanent monument
as follows: Corner No. 1 of this claim is located approximately 2200 feet N
48' W of the located SE corner of section 36 T18N, R52E MDM.

The corners of this claim are marked by 4"x4" posts or 4" trees with metal tags inscribed with the appropriate corner number as shown on the following sketch and the accompanying claim map.

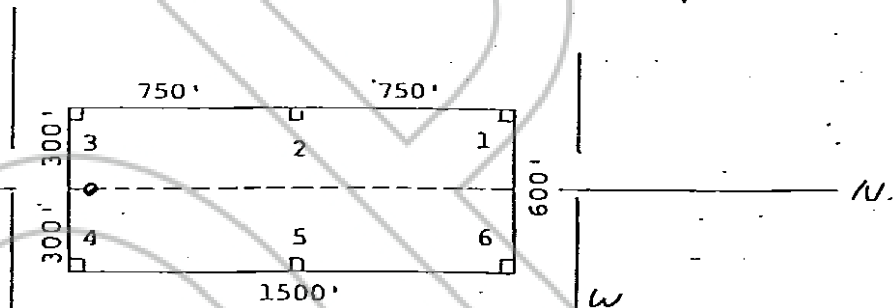

The location work consisted of making the maps as provided in NRS 517.040.

Dated and posted on the ground this 1 day of August July 19'80

Witnesses: **RECORDED AT REQUEST OF**
AMERICAN SELCO INC Locator:
BOOK 88 PAGE 335

AMERICAN SELCO INC.

By, J. R. [Signature]
Agent for
American Selco Inc.

OFFICIAL RECORDS
EUREKA COUNTY, NEVADA
WILLIS A. DEPAOLI-RECORDER
FILE NO. 77252
- FEE \$ 3.00

STATE OF NEVADA)
COUNTY OF) ss.

I hereby certify that the within instrument was filed and recorded at the request of:

FILE NO. _____
on _____
at _____
Docket _____ Page _____

Witness my hand and official
seal the day and year aforesaid

County Recorder

By Deputy Recorder

BOOK 88 PAGE 325