

77279

NOTICE IS HEREBY GIVEN that the St. Pat No. 73  
lode mining claim has been located by AMERICAN SELCO INC.  
a New York corporation, whose address is 99 West Grove Street,  
Suite 100, Reno, Nevada 89509. The general course of this claim  
is North/South. This claim is 1500 feet in length  
along the course of the claim, being 10 feet from the point  
of discovery in a North direction to the North end  
line of this claim, and 1490 feet in a South  
direction to the South end line of the claim. This claim is  
600 feet in width, being 300 feet in width on each side of the  
center line of the claim.

This claim is located within the SE Quarter  
of Section 22, Township 18 North, Range 52  
East, Mount Diablo Base and Meridian, 1 Eureka Mining District  
Eureka County, Nevada. The location monument of this claim is  
situated with reference to some natural object or permanent monument  
as follows: Corner No. 1 of this claim is located approximately 16800 feet N  
48 °W of the located SE corner of section 36 T18N, R52E MDM.

The corners of this claim are marked by 4"x4" posts or 4" trees  
with metal tags inscribed with the appropriate corner number as  
shown on the following sketch and the accompanying claim map.

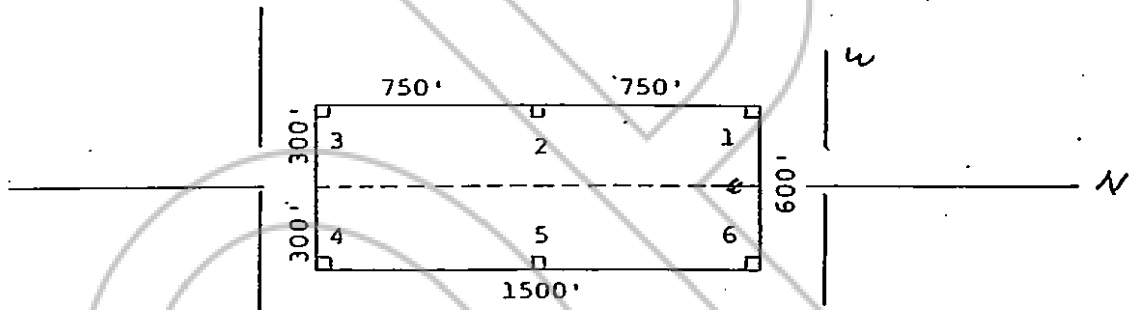

The location work consisted of making the maps as provided in  
NRS 517.040.

Dated and posted on the ground this 31 day of July,  
1980

Witnesses: RECORDED AT REQUEST OF  
AMERICAN SELCO INC. Locator:  
BOOK 88 PAGE 362

AMERICAN SELCO INC.

80 OCT 27 11:31

By Jim Rice  
Agent for  
American Selco Inc.

OFFICIAL RECORDS  
EUREKA COUNTY, NEVADA  
WILLIS A. DEPAOLI-RECORDER  
FILE NO. 77279  
FEES 3.00

STATE OF NEVADA

COUNTY OF \_\_\_\_\_ ) ss.  
\_\_\_\_\_ )

I hereby certify that the within  
instrument was filed and recorded at  
the request of:

FILE NO. \_\_\_\_\_  
on \_\_\_\_\_  
at \_\_\_\_\_  
Docket \_\_\_\_\_ Page \_\_\_\_\_

Witness my hand and official  
seal the day and year aforesaid

County Recorder

By \_\_\_\_\_  
Deputy Recorder  
BOOK 88 PAGE 362