

NOTICE IS HEREBY GIVEN that the St. Pat No. 85  
 lode mining claim has been located by AMERICAN SELCO INC.  
 a New York corporation, whose address is 99 West Grove Street,  
 Suite 100, Reno, Nevada 89509. The general course of this claim  
 is North/South. This claim is 1500 feet in length  
 along the course of the claim, being 10 feet from the point  
 of discovery in a North direction to the North end  
 line of this claim, and 1490 feet in a South  
 direction to the South end line of the claim. This claim is  
 600 feet in width, being 300 feet in width on each side of the  
 center line of the claim.

This claim is located within the SE Quarter  
 of Section 28, Township 18 North, Range 52  
 East, Mount Diablo Base and Meridian, 1 Eureka Mining District,  
 Eureka County, Nevada. The location monument of this claim is  
 situated with reference to some natural object or permanent monument  
 as follows: Corner No. 1 of this claim is located approximately 1900 feet N  
60 W of the located SE corner of section 36 T18N, R52E MDM.

The corners of this claim are marked by 4"x4" posts or 4" trees  
 with metal tags inscribed with the appropriate corner number as  
 shown on the following sketch and the accompanying claim map.

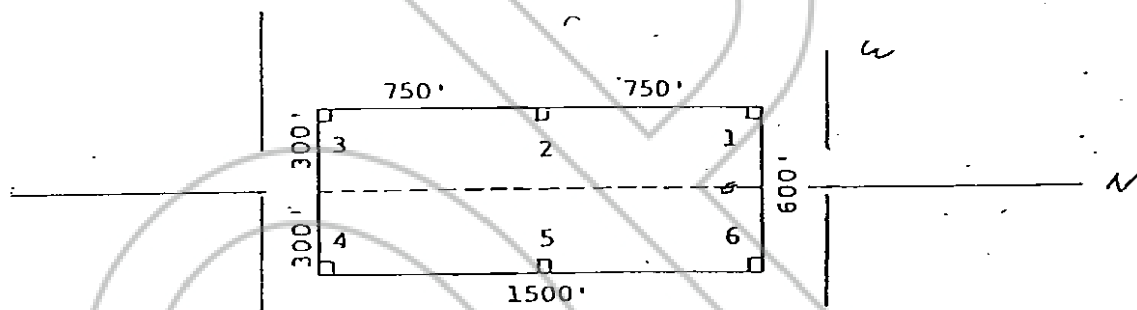

The location work consisted of making the maps as provided in  
 NRS 517.040.

Dated and posted on the ground this 31 day of July,  
 1980

Witnesses:

RECORDED AT REQUEST OF  
 AMERICAN SELCO INC. Locator:  
 BOOK 77 PAGE 374

AMERICAN SELCO INC.

80 OCT 27 P 1: 32

By Jim Rice  
 Agent for  
 American Selco Inc.

OFFICE OF RECORDS  
 EUREKA COUNTY, NEVADA  
 WILLIS A. DEPAOLI - RECORDER  
 FILE NO. 77291  
 REC. 3-00

STATE OF NEVADA

COUNTY OF

ss.

I hereby certify that the within  
 instrument was filed and recorded at  
 the request of:

FILE NO.

on

at

Docket

Page

Witness my hand and official  
 seal the day and year aforesaid

County Recorder

By

Deputy Recorder

BOOK 88 PAGE 374