

NOTICE IS HEREBY GIVEN that the St. Pat No. 167
 lode mining claim has been located by AMERICAN SELCO INC.
 a New York corporation, whose address is 90 West Grove Street,
 Suite 100, Reno, Nevada 89509. The general course of this claim
 is North/South. This claim is 1500 feet in length
 along the course of the claim, being 10 feet from the point
 of discovery in a North direction to the North end
 line of this claim, and 1490 feet in a South
 direction to the South end line of the claim. This claim is
 600 feet in width, being 300 feet in width on each side of the
 center line of the claim.

This claim is located within the SW Quarter
 of Section 3, Township 17 North, Range 52
 East, Mount Diablo Base and Meridian, Eureka Mining District,
 Eureka County, Nevada. The location monument of this claim is
 situated with reference to some natural object or permanent monument
 as follows: Corner No. 1 of this claim is located approximately 10000 feet S
76 W of the located SE corner of section 36 T18N, R52E MM.

The corners of this claim are marked by 4"x4" posts or 4" trees
 with metal tags inscribed with the appropriate corner number as
 shown on the following sketch and the accompanying claim-map.

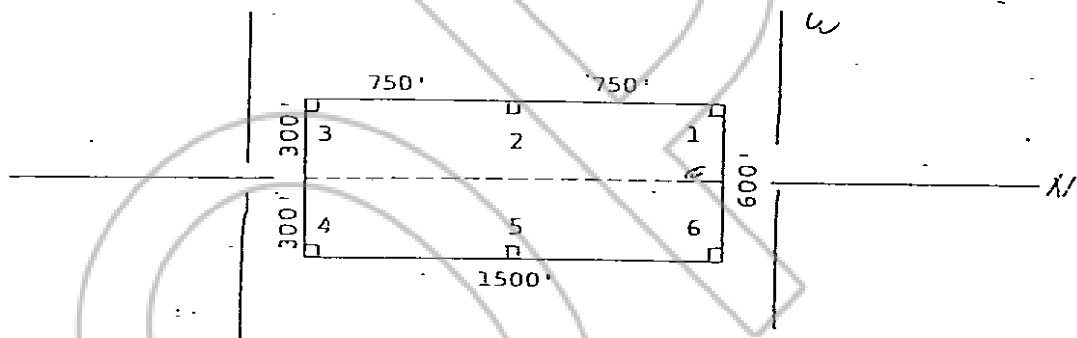

The location work consisted of making the maps as provided in
 NRS 517.040.

Dated and posted on the ground this 13 day of August
 1980 July

Witnesses:

RECORDED AT REQUEST OF
AMERICAN SELCO INC
 BOOK 88 PAGE 456

Locator:

AMERICAN SELCO INC.

80 OCT 27 P 1:40

By

Jan Rine
 Agent for
 American Selco Inc.

OFFICIAL RECORDS
 EUREKA COUNTY, NEVADA
 WILLIS A. DEPAOLI - RECORDER
 FILE NO. 77373
 FEE \$ 3.00

STATE OF NEVADA)

COUNTY OF)

) ss.

I hereby certify that the within
 instrument was filed and recorded at
 the request of: _____

FILE NO. _____

on _____
 at _____

Docket _____ Page _____

Witness my hand and official
 seal the day and year aforesaid

County Recorder

By _____
 Deputy Recorder

BOOK 88 PAGE 456