

NOTICE IS HEREBY GIVEN that the St. Pat No. 173 lode mining claim has been located by AMERICAN SELCO INC. a New York corporation, whose address is 99 West Grove Street, Suite 100, Reno, Nevada 89509. The general course of this claim is North/South. This claim is 1500 feet in length along the course of the claim, being 10 feet from the point of discovery in a North direction to the North end line of this claim, and 1490 feet in a South direction to the South end line of the claim. This claim is 600 feet in width, being 300 feet in width on each side of the center line of the claim.

This claim is located within the SE Quarter of Section 3, Township 17 North, Range 52 East, Mount Diablo Base and Meridian, Eureka Mining District, Eureka County, Nevada. The location monument of this claim is situated with reference to some natural object or permanent monument as follows: Corner No. 1 of this claim is located approximately 6200 feet S 68 W of the located SE corner of section 36 T18N, R52E MEM.

The corners of this claim are marked by 4"x4" posts or 4" trees with metal tags inscribed with the appropriate corner number as shown on the following sketch and the accompanying claim map.

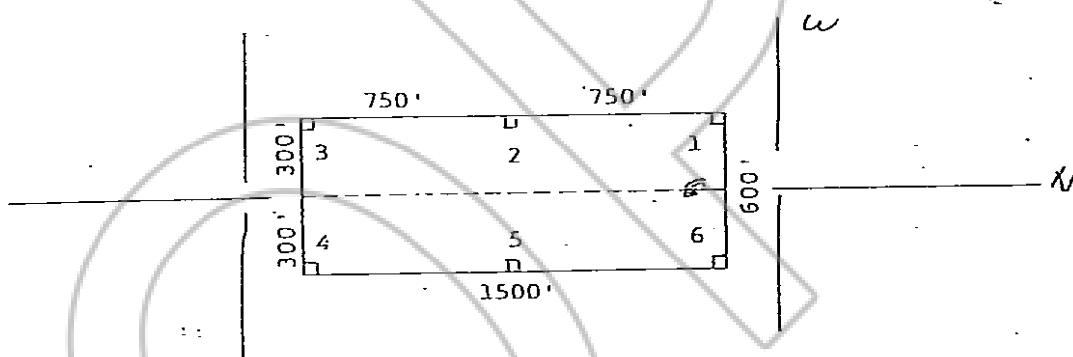

The location work consisted of making the maps as provided in NRS 517.040.

Dated and posted on the ground this 13 day of August ~~July~~, 1980

Witnesses: RECORDED AT REQUEST OF AMERICAN SELCO INC Locator: AMERICAN SELCO INC.
BOOK 88 PAGE 462

80 OCT 27 P 1:41

OFFICIAL RECORDS
 EUREKA COUNTY, NEVADA
 WILLIS A. DEFRAS - RECORDER
 FILE NO. 77379
 FEES 3.00

STATE OF NEVADA

COUNTY OF _____

ss.

By Jim Rice
 Agent for
 American Selco Inc.

I hereby certify that the within instrument was filed and recorded at the request of: _____

FILE NO. _____
 on _____
 at _____
 Docket _____ Page _____

Witness my hand and official seal the day and year aforesaid.

County Recorder

By _____
 Deputy Recorder

BOOK 88 PAGE 462