

NOTICE IS HEREBY GIVEN that the St. Pat No. 223 loose mining claim has been located by AMERICAN SELCO INC., a New York corporation, whose address is 90 West Grove Street, Suite 100, Reno, Nevada 89509. The general course of this claim is North/South. This claim is 1500 feet in length along the course of the claim, being 1490 feet from the point of discovery in a North direction to the North end line of this claim, and 10 feet in a South direction to the South end line of the claim. This claim is 600 feet in width, being 300 feet in width on each side of the center line of the claim.

This claim is located within the SE Quarter of Section 9, Township 17 North, Range 52 East, Mount Diablo Base and Meridian, Eureka Mining District, Eureka County, Nevada. The location monument of this claim is situated with reference to some natural object or permanent monument as follows: Corner No. 1 of this claim is located approximately 15300 feet S 53 W of the located SE corner of section 36 T18N, R52E MDM.

The corners of this claim are marked by 4"x4" posts or 4" trees with metal tags inscribed with the appropriate corner number as shown on the following sketch and the accompanying claim map.

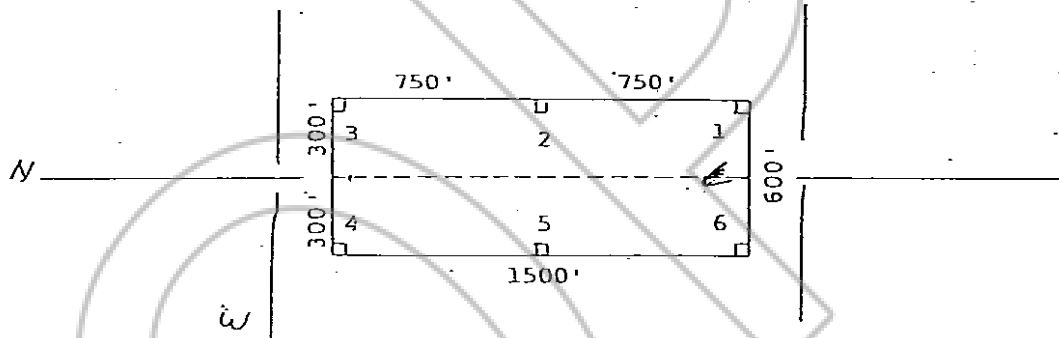

The location work consisted of making the maps as provided in NRS 517.040.

Dated and posted on the ground this 19 day of August, 1980 ~~July~~

Witnesses: RECORDED AT REQUEST OF AMERICAN SELCO INC. 143 Locator:  
BOOK 88 PAGE 507

AMERICAN SELCO INC.

80 OCT 27 P 1:46

By Jim Rice  
Agent for  
American Selco Inc.

OFFICIAL RECORDS  
EUREKA COUNTY, NEVADA  
WILLIS A. DEPAOLI - RECORDER  
FILE NO. 77424  
FEE \$ 3.00

STATE OF NEVADA )  
COUNTY OF ) ss.

I hereby certify that the within instrument was filed and recorded at the request of:

FILE NO. \_\_\_\_\_  
on \_\_\_\_\_  
at \_\_\_\_\_  
Docket \_\_\_\_\_ Page \_\_\_\_\_

Witness my hand and official seal the day and year aforesaid

County Recorder

By \_\_\_\_\_  
Deputy Recorder

BOOK 88 PAGE 507