

CERTIFICATE OF MINING LOCATION
LODE CLAIM ON PUBLIC DOMAIN
 77578

NOTICE IS HEREBY GIVEN that the St. Pat No. 378 lode mining claim has been located by AMERICAN SELCO INC. a New York corporation, whose address is 90 West Grove Street, Suite 100, Reno, Nevada 89509. The general course of this claim is North/South. This claim is 1500 feet in length along the course of the claim, being 1480 feet from the point of discovery in a North direction to the North end line of this claim, and 20 feet in a South direction to the South end line of the claim. This claim is 600 feet in width, being 300 feet in width on each side of the center line of the claim.

This claim is located within the NE Quarter of Section 35, Township 18 North, Range 52 East, Mount Diablo Base and Meridian, 1 Eureka Mining District, Eureka County, Nevada. The location monument of this claim is situated with reference to some natural object or permanent monument as follows: Corner No. 6 of this claim is located approximately 8,800 feet N 58 °W of the located SE corner of section 36 T18N, R52E 1MDM.

The corners of this claim are marked by 4"x4" posts or 4" trees with metal tags inscribed with the appropriate corner number as shown on the following sketch and the accompanying claim map.

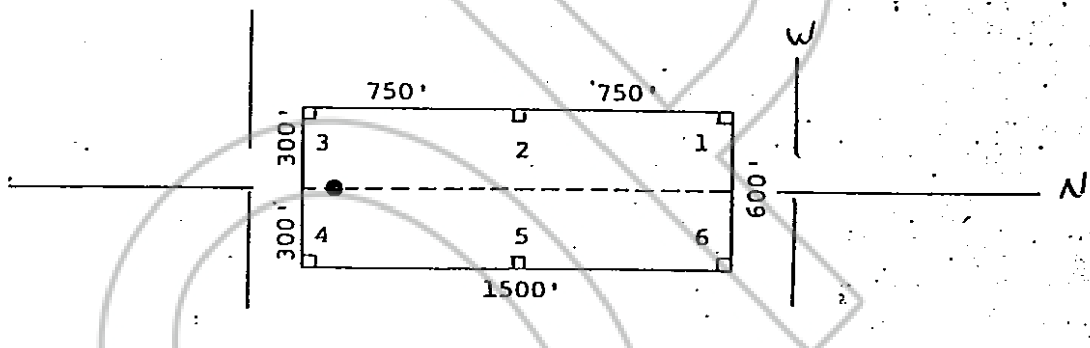

The location work consisted of making the maps as provided in NRS 517.040.

Dated and posted on the ground this 8 day of October 1980 July

Witnesses: RECORDED AT REQUEST OF AMERICAN SELCO INC. Locator:
 BOOK 29 PAGE 61

AMERICAN SELCO INC.
 By Jan Rice
 Agent for
 American Selco Inc.

80 OCT 27 P 1: 50

OFFICIAL RECORDS
 EUREKA COUNTY, NEVADA
 WILLIS A. DEPAUL RECORDER
 FILE NO. 77578
 FEES 3.00

STATE OF NEVADA)
) ss
 COUNTY OF OF)

I hereby certify that the within instrument was filed and recorded at the request of:
 FILE NO. _____
 on _____
 at _____
 Docket _____ Page _____

Witness my hand and official seal the day and year aforesaid.

 County Recorder
 By _____
 Deputy Recorder
 BOOK 29 PAGE 61