

NOTICE IS HEREBY GIVEN that the St. Pat No. 391 lode mining claim has been located by AMERICAN SELCO INC. a New York corporation, whose address is 90 West Grove Street, Suite 100, Reno, Nevada 89509. The general course of this claim is North/South. This claim is 1500 feet in length along the course of the claim, being 1480 feet from the point of discovery in a North direction to the North end line of this claim, and 20 feet in a South direction to the South end line of the claim. This claim is 600 feet in width, being 300 feet in width on each side of the center line of the claim.

This claim is located within the SE? SW Quarter of Section 18, Township 17 North, Range 52 East, Mount Diablo Base and Meridian, Eureka Mining District, Eureka County, Nevada. The location monument of this claim is situated with reference to some natural object or permanent monument as follows: Corner No. 1 of this claim is located approximately 30,200 feet S 69° W of the located SE corner of section 36 T18N, R52E MM.

The corners of this claim are marked by 4"x4" posts or 4" trees with metal tags inscribed with the appropriate corner number as shown on the following sketch and the accompanying claim map.

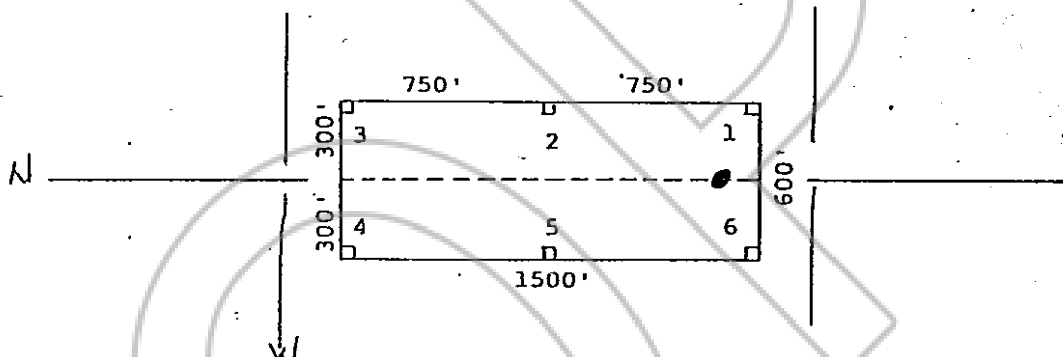

The location work consisted of making the maps as provided in NRS 517.040.

Dated and posted on the ground this 22 day of October 1980 July

Witnesses: RECORDED AT REQUEST OF
AMERICAN SELCO INC
BOOK 89 PAGE 74 Locator:

AMERICAN SELCO INC.

By Jim Rine
Agent for
American Selco Inc.

80 OCT 27 P2:01

OFFICIAL RECORDS
EUREKA COUNTY, NEVADA
WILLIS A. DEPAOLI - RECORDER
FILE NO. 77591
FEE \$ 3.00

STATE OF NEVADA)

COUNTY OF _____) ss.

I hereby certify that the within instrument was filed and recorded at the request of: Witness my hand and official seal the day and year aforesaid.

FILE NO. _____

on _____

at _____

Docket. _____

Page _____

County Recorder

By _____

Deputy Recorder

BOOK 89 PAGE 74