

NOTICE IS HEREBY GIVEN that the St. Pat No. 396 lode mining claim has been located by AMERICAN SELCO INC. a New York corporation, whose address is 90 West Grove Street, Suite 100, Reno, Nevada 89509. The general course of this claim is North/South. This claim is 1500 feet in length along the course of the claim, being 20 feet from the point of discovery in a North direction to the North end line of this claim, and 1480 feet in a South direction to the South end line of the claim. This claim is 600 feet in width, being 300 feet in width on each side of the center line of the claim.

This claim is located within the SW Quarter of Section 7, Township 17 North, Range 52 East, Mount Diablo Base and Meridian, Eureka Mining District, Eureka County, Nevada. The location monument of this claim is situated with reference to some natural object or permanent monument as follows: Corner No. 1 of this claim is located approximately 29,000 feet S 69° W of the located SE corner of section 36 T18N, R52E MDM.

The corners of this claim are marked by 4"x4" posts or 4" trees with metal tags inscribed with the appropriate corner number as shown on the following sketch and the accompanying claim map.

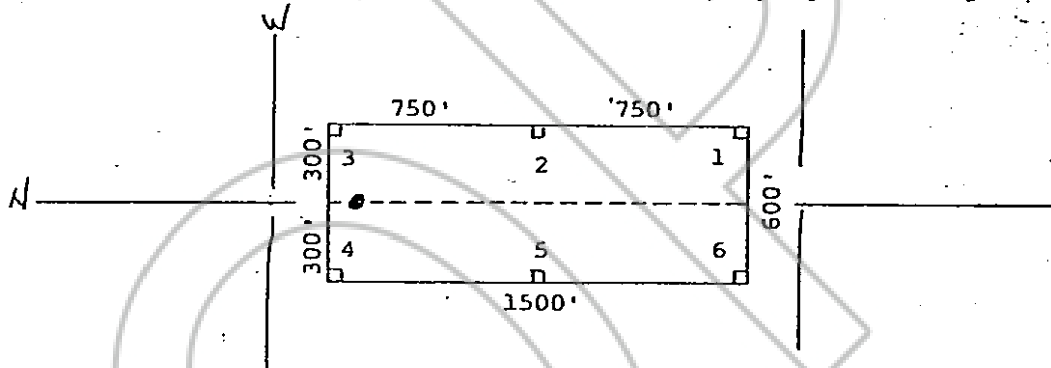

The location work consisted of making the maps as provided in NRS 517.040.

Dated and posted on the ground this 22 day of October 19 80

Witnesses: RECORDED AT REQUEST OF
AMERICAN SELCO INC. Locator:
BOOK 89 PAGE 79

AMERICAN SELCO INC.

60 OCT 27 P 2: 01

By Jim Rine
 Agent for
 American Selco Inc.

OFFICIAL RECORDS
 ELIKA COUNTY, NEVADA
 WILLIS A. DEACON, RECORDER
 FILE NO. 77596
 FEE \$ 3.00

STATE OF NEVADA

COUNTY OF _____) ss.

I hereby certify that the within instrument was filed and recorded at the request of: _____ Witness my hand and official seal the day and year aforesaid.

FILE NO. _____
 on _____
 at _____
 Docket _____ Page _____

County Recorder

By _____
 Deputy Recorder

BOOK 89 PAGE 79