

CERTIFICATE OF MINING LOCATION
LODE CLAIM ON PUBLIC DOMAIN

77601

NOTICE IS HEREBY GIVEN that the St. Pat No. 461
lode mining claim has been located by AMERICAN SELCO INC.
a New York corporation, whose address is 90 West Grove Street,
Suite 100, Reno, Nevada 89509. The general course of this claim
is North/South. This claim is 1500 feet in length
along the course of the claim, being 1480 feet from the point
of discovery in a North direction to the North end
line of this claim, and 20 feet in a South
direction to the South end line of the claim. This claim is
600 feet in width, being 300 feet in width on each side of the
center line of the claim.

This claim is located within the NW & SW Quarter
of Section 36, Township 18 North, Range 52
East, Mount Diablo Base and Meridian, Eureka Mining District,
Eureka County, Nevada. The location monument of this claim is
situated with reference to some natural object or permanent monument
as follows: Corner No. 6 of this claim is located approximately 5,300 feet N
73 °W of the located SE corner of section 36 T18N, R52E MDM.

The corners of this claim are marked by 4"x4" posts or 4" trees
with metal tags inscribed with the appropriate corner number as
shown on the following sketch and the accompanying claim map.

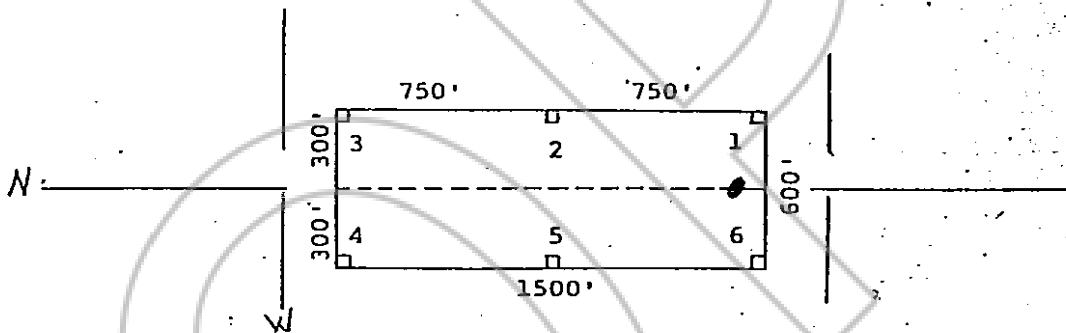

The location work consisted of making the maps as provided in
NRS 517.040.

Dated and posted on the ground this 26 day of September
1980 July

Witnesses: RECORDED AT REQUEST OF
AMERICAN SELCO INC. Locator:
BOOK 29 PAGE 84

AMERICAN SELCO INC.

80 OCT 27 P 2: 02

By Jim Rice
Agent for
American Selco Inc.

OFFICIAL RECORDS
EUREKA COUNTY, NEVADA
WILLIS A. DEPAOLI, RECORDER
FILE NO. 77601
FEE \$ 3.00

STATE OF NEVADA)
COUNTY OF _____) ss.

I hereby certify that the within
instrument was filed and recorded at
the request of: _____
FILE NO. _____
on _____
at _____
Docket _____ Page _____

Witness my hand and official
seal the day and year aforesaid.

County Recorder

By _____
Deputy Recorder

BOOK 29 PAGE 84