

NOTICE IS HEREBY GIVEN that the X No. 9
lode mining claim has been located by AMSELCO MINERALS INC.,
a Delaware corporation, whose address is 90 West Grove Street,
Suite 100, Reno, Nevada 89509. The general course of this claim
is North/South. This claim is 1500 feet in length
along the course of the claim, being 1490 feet from the point
of discovery in a North direction to the North end
line of this claim, and 10 feet in a South
direction to the South end line of the claim. This claim is
600 feet in width, being 300 feet in width on each side of the
center line of the claim.

This claim is located within the S.W. Quarter
of Section 15, Township 18 North, Range 52
East, Mount Diablo Base and Meridian, unknown Mining District,
Eureka County, Nevada. The location monument of this claim is
situated with reference to some natural object or permanent monument
as follows: Corner no. 1 of this claim is located approximately
22,250 feet N 42°W of the located SE corner of Section
36, T18N, R52E, MDM

The corners of this claim are marked by 4"x4" posts or 4" trees
with metal tags inscribed with the appropriate corner number as
shown on the following sketch and the accompanying claim map.

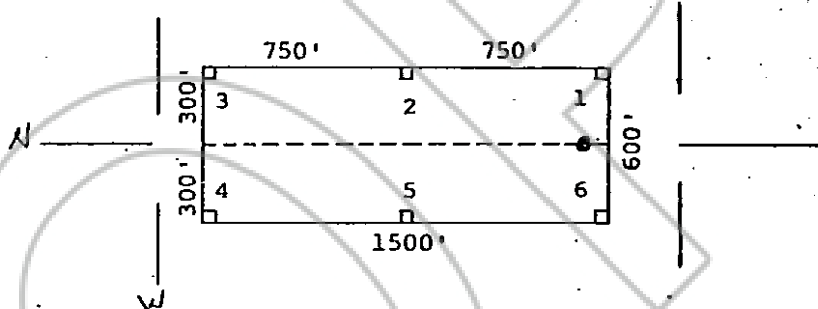

The location work consisted of making the maps as provided in
NRS 517.040.

Dated and posted on the ground this 18 day of August,
1980.

Witnesses: RECORDED AT REQUEST OF
William T. Rice
BOOK 89 PAGE 168

Locator:
AMSELCO MINERALS INC.

80 NOV 4 11:45

By [Signature]
Agent for
Amselco Minerals Inc.

OFFICIAL RECORDS
EUREKA COUNTY, NEVADA
WILLIS A. DEPAOLI, RECORDER
STATE OF NEVADA FILE NO. 77680
FEES 3.00) ss.
COUNTY OF _____)

I hereby certify that the within
instrument was filed and recorded at
the request of:

FILE NO. _____
on _____
at _____
Docket _____ Page _____

Witness my hand and official
seal the day and year aforesaid.

County Recorder

By _____
Deputy Recorder

BOOK 89 PAGE 168