

NOTICE IS HEREBY GIVEN that the X No. 10 lode mining claim has been located by AMSELCO MINERALS INC., a Delaware corporation, whose address is 90 West Grove Street, Suite 100, Reno, Nevada 89509. The general course of this claim is North/South. This claim is 1500 feet in length along the course of the claim, being 10 feet from the point of discovery in a North direction to the North end line of this claim, and 1440 feet in a South direction to the South end line of the claim. This claim is 600 feet in width, being 300 feet in width on each side of the center line of the claim.

This claim is located within the S.W. & N.W Quarter of Section 15 & 22, Township 18 North, Range 52 East, Mount Diablo Base and Meridian, unknown Mining District, Eureka County, Nevada. The location monument of this claim is situated with reference to some natural object or permanent monument as follows: Corner no. 1 of this claim is located approximately 2250 feet N 42° W of the located SE corner of Section 36; T18N, R52E, MDM

The corners of this claim are marked by 4"x4" posts or 4" trees with metal tags inscribed with the appropriate corner number as shown on the following sketch and the accompanying claim map.

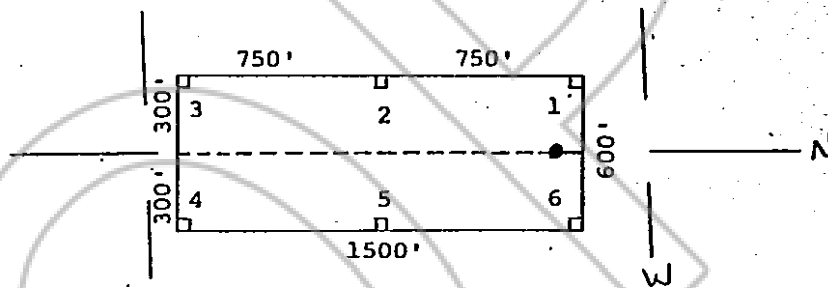

The location work consisted of making the maps as provided in NRS 517.040.

Dated and posted on the ground this 18 day of August, 1980.

Witnesses: RECORDED AT REQUEST OF
William T. Rice
BOOK 89 PAGE 169

Locator: AMSELCO MINERALS INC.
By [Signature]
Agent for
Amselco Minerals Inc.

80 NOV 4 All: 45

OFFICIAL RECORDS
EUREKA COUNTY, NEVADA
WILLIS A. DePAOLI - RECORDER
STATE OF NEVADA FILE NO. 77681
FEE \$ 3.00) ss.
COUNTY OF _____)

I hereby certify that the within instrument was filed and recorded at the request of: _____
FILE NO. _____
on _____
at _____
Docket _____ Page _____

Witness my hand and official seal the day and year aforesaid.

County Recorder
By _____
Deputy Recorder