

NOTICE IS HEREBY GIVEN that the X No. //  
lode mining claim has been located by AMSELCO MINERALS INC.,  
a Delaware corporation, whose address is 90 West Grove Street,  
Suite 100, Reno, Nevada 89509. The general course of this claim  
is North/South. This claim is 1500 feet in length  
along the course of the claim, being 1490 feet from the point  
of discovery in a North direction to the North end  
line of this claim, and 10 feet in a South  
direction to the South end line of the claim. This claim is  
600 feet in width, being 300 feet in width on each side of the  
center line of the claim.

This claim is located within the S.W Quarter  
of Section 15, Township 18 North, Range 52  
East, Mount Diablo Base and Meridian, unknown Mining District,  
Eureka County, Nevada. The location monument of this claim is  
situated with reference to some natural object or permanent monument  
as follows: Corner no. 1 of this claim is located approximately  
2250 feet N 42° W of the located SE corner of Section  
36, T18N, R52E, MDM

The corners of this claim are marked by 4"x4" posts or 4" trees  
with metal tags inscribed with the appropriate corner number as  
shown on the following sketch and the accompanying claim map.

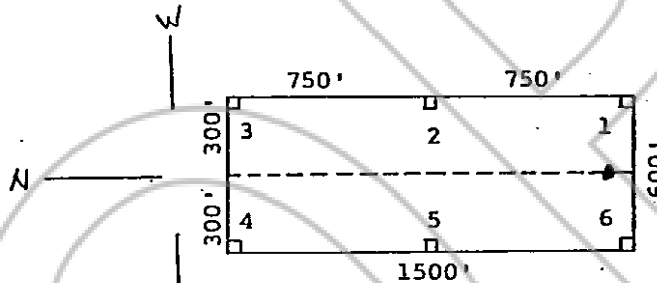

The location work consisted of making the maps as provided in  
NRS 517.040.

Dated and posted on the ground this 18 day of August,  
1980.

Witnesses:

RECORDED AT REQUEST OF  
William T. Rye  
BOOK 89 PAGE 170

Locator:

AMSELCO MINERALS INC.

80 NOV 4 11:45

By

[Signature]  
Agent for  
Amselco Minerals Inc.

STATE OF NEVADA

OFFICIAL RECORDS  
EUREKA COUNTY, NEVADA  
WILLIS A. DEPAOLI, RECORDER  
FILE NO. 77682  
FEE \$ 3.00 ps.

COUNTY OF \_\_\_\_\_ )

I hereby certify that the within  
instrument was filed and recorded at  
the request of: \_\_\_\_\_

FILE NO. \_\_\_\_\_  
on \_\_\_\_\_  
at \_\_\_\_\_  
Docket \_\_\_\_\_ Page \_\_\_\_\_

Witness my hand and official  
seal the day and year aforesaid.

County Recorder

By \_\_\_\_\_  
Deputy Recorder

BOOK 89 PAGE 170