

NOTICE IS HEREBY GIVEN that the Lake No. 49 lode mining claim has been located by AMERICAN SELCO INC. a New York corporation, whose address is 90 West Grove Street, Suite 100, Reno, Nevada 89509. The general course of this claim is North/South. This claim is 1500 feet in length along the course of the claim, being 1480 feet from the point of discovery in a North direction to the North end line of this claim, and 20 feet in a South direction to the South end line of the claim. This claim is 600 feet in width, being 300 feet in width on each side of the center line of the claim.

This claim is located within the SW Quarter of Section 34, Township 19 North, Range 52 East, Mount Diablo Base and Meridian, unknown Mining District, Eureka County, Nevada. The location monument of this claim is situated with reference to some natural object or permanent monument as follows: The number 6 corner of this claim is located 6300 feet N14 1/2° E from claim location marker LA-1.

The claim location marker LA-1, a 3" x 6' steel pipe, is located approximately 18,000' S20° E of peak 8503', 17,250' N79° W of peak 7,709', at Temple Peak.

The corners of this claim are marked by 4"x4" posts or 4" trees with metal tags inscribed with the appropriate corner number as shown on the following sketch and the accompanying claim map.

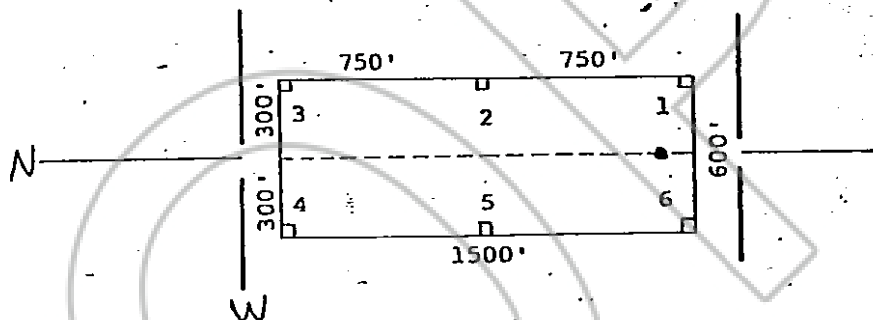

The location work consisted of making the maps as provided in NRS 517.040.

Dated and posted on the ground this 27 day of August, 1980.

Witnesses:

Locator:

RECORDED AT REQUEST OF  
AMERICAN SELCO INC.

AMERICAN SELCO INC.

BOOK 89 PAGE 372

80 NOV 21 AID: 20

By

Agent for

American Selco Inc.

OFFICIAL RECORDS  
EUREKA COUNTY, NEVADA  
STATE OF NEVADA  
FILE NO. 77869  
COUNTY OF ES ) ss.  
FEE \$ 3.00 )

I hereby certify that the within instrument was filed and recorded at the request of:

FILE NO. \_\_\_\_\_

on \_\_\_\_\_

at \_\_\_\_\_

Docket \_\_\_\_\_

Page \_\_\_\_\_

BOOK 89 PAGE 372

Witness my hand and official seal the day and year aforesaid.

County Recorder

By

Deputy Recorder