

STATE OF NEVADA
77997 CERTIFICATE OF MINING LOCATION
 LODE CLAIM ON PUBLIC DOMAIN

NOTICE IS HEREBY GIVEN that the Red No. 1 lode mining claim has been located by AMERICAN SELCO INC. a New York corporation, whose address is 90 West Grove Street, Suite 100, Reno, Nevada 89509. The general course of this claim is East/West. This claim is 1500 feet in length along the course of the claim, being 10 feet from the point of discovery in a East direction to the East end line of this claim, and 1490 feet in a West direction to the West end line of the claim. This claim is 600 feet in width, being 300 feet in width on each side of the center line of the claim.

This claim is located within the NW Quarter of Section 22, Township 23 North, Range 49 East, Mount Diablo Base and Meridian, unknown Mining District, White Pine County, Nevada. The location monument of this claim is situated with reference to some natural object or permanent monument as follows: The number one corner of this claim is located approximately 6150 feet N 53° 50' W from the located SE SE corner of Section 22, T23N, R49E, MDM

The corners of this claim are marked by 4"x4" posts or 4" trees with metal tags inscribed with the appropriate corner number as shown on the following sketch and the accompanying claim map.

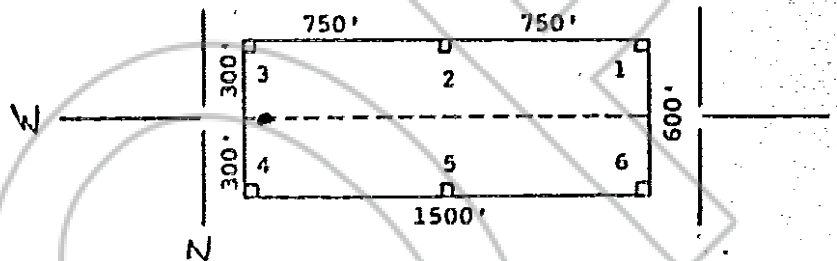

The location work consisted of making the maps as provided in NRS 317.040.

Dated and posted on the ground this 8 day of October, 1980

Witnesses:

RECORDED AT REQUEST OF
AMERICAN SELCO INC
 BOOK 89 PAGE 501

Locator:
AMERICAN SELCO INC.

80 DEC 1 4 8: 37

By [Signature]
 Agent for
 American Selco Inc.

STATE OF NEVADA
 COUNTY OF _____

RECORDED AT REQUEST OF
 WILLIS A. DEERMAN, RECORDER
 FILE # 3:88

I hereby certify that the within instrument was filed and recorded at the request of: _____
 FILE NO. _____
 on _____
 at _____
 Docket _____ Page _____

Witness my hand and official seal the day and year aforesaid.

County Recorder

By _____
 Deputy Recorder

BOOK 89 PAGE 501

77998

STATE OF NEVADA
CERTIFICATE OF MINING LOCATION
LODE CLAIM ON PUBLIC DOMAIN

NOTICE IS HEREBY GIVEN that the Red No. 2 lode mining claim has been located by AMERICAN SELCO INC., a New York corporation, whose address is 90 West Grove Street, Suite 100, Reno, Nevada 89509. The general course of this claim is East/West. This claim is 1500 feet in length along the course of the claim, being 10 feet from the point of discovery in a East direction to the East end line of this claim, and 1490 feet in a West direction to the West end line of the claim. This claim is 600 feet in width, being 300 feet in width on each side of the center line of the claim.

This claim is located within the NW/NE Quarter of Section 22/21, Township 23 North, Range 49 East, Mount Diablo Base and Meridian, unknown Mining District, White Pine County, Nevada. The location monument of this claim is situated with reference to some natural object or permanent monument as follows: The number one corner of this claim is located approximately 6.150 feet N53°50'W from the located SE SE corner of Section 22, T23N, R49E, MDM

The corners of this claim are marked by 4"x4" posts or 4" trees with metal tags inscribed with the appropriate corner number as shown on the following sketch and the accompanying claim map.

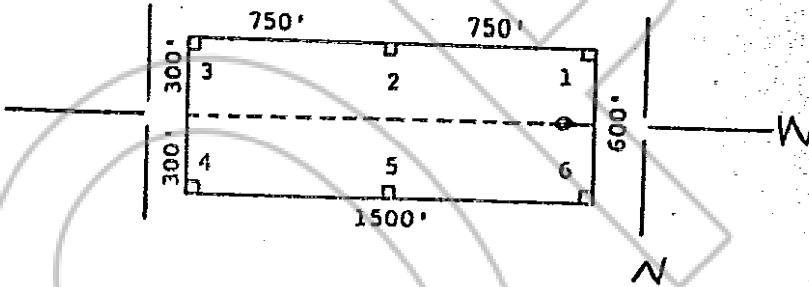

The location work consisted of making the maps as provided in NRS 517.040.

Dated and posted on the ground this 8 day of October, 1980.

Witnesses:

RECORDED AT REQUEST OF
AMERICAN SELCO INC.
BOOK 89 PAGE 502

Locator:

AMERICAN SELCO INC.

80 DEC 1 4 8: 37

By [Signature]
Agent for
American Selco Inc.

STATE OF NEVADA

COUNTY OF _____

OFFICIAL RECORDS
EUREKA COUNTY, NEVADA
WILLIS A. DI PAOLI - RECORDER
FILE NO. 77998
FFE # 349

I hereby certify that the within instrument was filed and recorded at the request of:

FILE NO. _____
on _____
at _____
Docket _____ Page _____

Witness my hand and official seal the day and year aforesaid.

County Recorder

By _____
Deputy Recorder

BOOK 89 PAGE 502

NOTICE IS HEREBY GIVEN that the Red No. 3 lode mining claim has been located by AMERICAN SELCO INC. a New York corporation, whose address is 90 West Grove Street, Suite 100, Reno, Nevada 89509. The general course of this claim is East/West. This claim is 1500 feet in length along the course of the claim, being 10 feet from the point of discovery in a East direction to the East end line of this claim, and 1490 feet in a West direction to the West end line of the claim. This claim is 600 feet in width, being 300 feet in width on each side of the center line of the claim.

This claim is located within the NW Quarter of Section 22, Township 23 North, Range 49 East, Mount Diablo Base and Meridian, unknown Mining District, White Pine County, Nevada. The location monument of this claim is situated with reference to some natural object or permanent monument as follows: The number one corner of this claim is located approximately 6,150 feet N53°50'W from the located SE SE corner of Section 22, T23N, R49E, MDM

The corners of this claim are marked by 4"x4" posts or 4" trees with metal tags inscribed with the appropriate corner number as shown on the following sketch and the accompanying claim map.

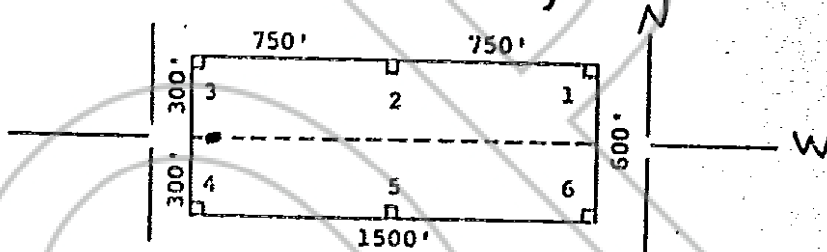

The location work consisted of making the maps as provided in NRS 517.040.

Dated and posted on the ground this 8 day of October, 1980

Witnesses:
RECORDED AT REQUEST OF
AMERICAN SELCO INC
BOOK 89 PAGE 503

Locator:
AMERICAN SELCO INC.

80 DEC 1 AM: 37

By [Signature]
Agent for
American Selco Inc.

OFFICIAL RECORDS
BUREAU COUNTY CLERK
WILLIS A. DEPAUL RECORDER
STATE OF NEVADA
FILE NO. 77999
COUNTY OF _____
FEE \$ 3.00

I hereby certify that the within instrument was filed and recorded at the request of: _____
FILE NO. _____
on _____
at _____
Docket _____ page _____

Witness my hand and official seal the day and year aforesaid.

County Recorder

By _____
Deputy Recorder

BOOK 89 PAGE 503

78000

STATE OF NEVADA
CERTIFICATE OF MINING LOCATION
LODE CLAIM ON PUBLIC DOMAIN

NOTICE IS HEREBY GIVEN that the Red No. 4 lode mining claim has been located by AMERICAN SELCO INC. a New York corporation, whose address is 90 West Grove Street, Suite 100, Reno, Nevada 89509. The general course of this claim is East/West. This claim is 1500 feet in length along the course of the claim, being 10 feet from the point of discovery in a East direction to the East end line of this claim, and 1490 feet in a West direction to the West end line of the claim. This claim is 600 feet in width, being 300 feet in width on each side of the center line of the claim.

This claim is located within the NW/NE Quarter of Section 22/21, Township 23 North, Range 49 East, Mount Diablo Base and Meridian, unknown Mining District, White Pine County, Nevada. The location monument of this claim is situated with reference to some natural object or permanent monument as follows: The number one corner of this claim is located approximately 6,150 feet N 53° 50' W from the located SE SE corner of Section 22, T23N, R49E, MDM

The corners of this claim are marked by 4"x4" posts or 4" trees with metal tags inscribed with the appropriate corner number as shown on the following sketch and the accompanying claim map.

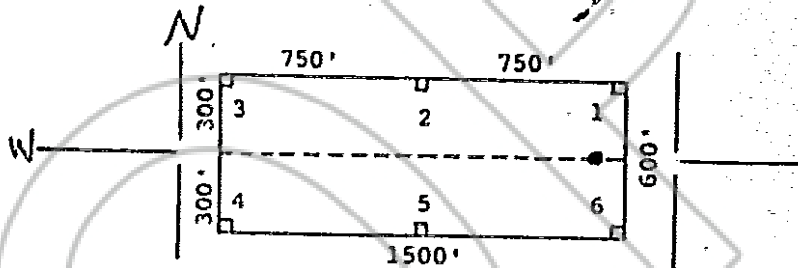

The location work consisted of making the maps as provided in NRS 517.040.

Dated and posted on the ground this 8 day of October, 1980

Witnesses: RECORDED AT REQUEST OF AMERICAN SELCO INC. BOOK 89 PAGE 504

Locator: AMERICAN SELCO INC.

80 DEC 1 A 8: 37

By [Signature]
Agent for
American Selco Inc.

STATE OF NEVADA
COUNTY OF _____
OFFICIAL RECORDS
EUREKA COUNTY, NEVADA
WILLIS A. DEPAOLI, RECORDER
FILE NO. 78000
FEE \$3.00

I hereby certify that the within instrument was filed and recorded at the request of: _____
FILE NO. _____
on _____
at _____
Docket _____ page _____

Witness my hand and official seal the day and year aforesaid.

County Recorder

By _____
Deputy Recorder

BOOK 89 PAGE 504

78001

STATE OF NEVADA
CERTIFICATE OF MINING LOCATION
LODE CLAIM ON PUBLIC DOMAIN

NOTICE IS HEREBY GIVEN that the Red No. 5 lode mining claim has been located by AMERICAN SELCO INC. a New York corporation, whose address is 90 West Grove Street, Suite 100, Reno, Nevada 89509. The general course of this claim is East/West. This claim is 1500 feet in length along the course of the claim, being 10 feet from the point of discovery in a East direction to the East end line of this claim, and 1490 feet in a West direction to the West end line of the claim. This claim is 600 feet in width, being 300 feet in width on each side of the center line of the claim.

This claim is located within the NW & SW Quarter of Section 22, Township 23 North, Range 49 East, Mount Diablo Base and Meridian, unknown Mining District, White Pine County, Nevada. The location monument of this claim is situated with reference to some natural object or permanent monument as follows: The number one corner of this claim is located approximately 5,500 feet N 64° 30' W from the located SE SE corner of Section 22, T23N, R49E, MDM

The corners of this claim are marked by 4"x4" posts or 4" trees with metal tags inscribed with the appropriate corner number as shown on the following sketch and the accompanying claim map.

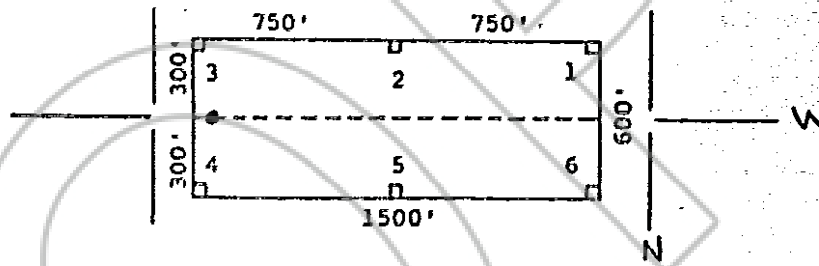

The location work consisted of making the maps as provided in NRS 517.040.

Dated and posted on the ground this 8 day of October, 1980

Witnesses:

Locator:

RECORDED AT REQUEST OF
AMERICAN SELCO INC.
BOOK 89 PAGE 505

AMERICAN SELCO INC.

NOV 1 1980

By [Signature]
Agent for
American Selco Inc.

STATE OF NEVADA
EUREKA COUNTY, NEVADA
WILLIS A. BEARD, RECORDER
FILE NO. 78001
FEE \$3.00

COUNTY OF _____

I hereby certify that the within instrument was filed and recorded at the request of:

Witness my hand and official seal the day and year aforesaid.

FILE NO. _____
on _____
at _____
Docket _____ Page _____

County Recorder

By _____
Deputy Recorder

BOOK 89 PAGE 505

STATE OF NEVADA
CERTIFICATE OF MINING LOCATION
LODE CLAIM ON PUBLIC DOMAIN

NOTICE IS HEREBY GIVEN that the Red No. 6 lode mining claim has been located by AMERICAN SELCO INC. a New York corporation, whose address is 90 West Grove Street, Suite 100, Reno, Nevada 89509. The general course of this claim is East/West. This claim is 1500 feet in length along the course of the claim, being 10 feet from the point of discovery in a East direction to the East end line of this claim, and 1490 feet in a West direction to the West end line of the claim. This claim is 600 feet in width, being 300 feet in width on each side of the center line of the claim.

This claim is located within the NW 1/4 SW 1/4 NE 1/4 SE Quarter of Section 22/21, Township 23 North, Range 49 East, Mount Diablo Base and Meridian, unknown Mining District, White Pine County, Nevada. The location monument of this claim is situated with reference to some natural object or permanent monument as follows: The number one corner of this claim is located approximately 5,500 feet N 1/2 30' W from the located SE SE corner of Section 22, T23N, R49E, MDM

The corners of this claim are marked by 4"x4" posts or 4" trees with metal tags inscribed with the appropriate corner number as shown on the following sketch and the accompanying claim-map.

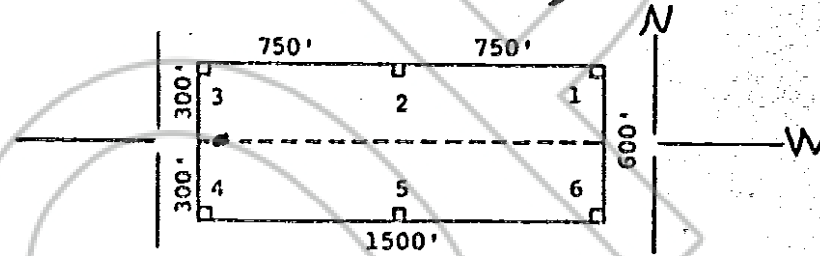

The location work consisted of making the maps as provided in NRS 517.040.

Dated and posted on the ground this 8 day of October, 1980

Witnesses:

RECORDED AT REQUEST OF
AMERICAN SELCO INC
BOOK 89 PAGE 506

Locator:

AMERICAN SELCO INC.

NOV DEC 1 8:37

By [Signature]
Agent for
American Selco Inc.

STATE OF NEVADA

CENTRAL RECORDS
EUREKA COUNTY, NEVADA
WILLIS A. DEPAOLI - RECORDER
FILE NO. 78002
FEE \$ 3.00

COUNTY OF _____

I hereby certify that the within instrument was filed and recorded at the request of:

FILE NO. _____
on _____
at _____
Docket _____ Page _____

Witness my hand and official seal the day and year aforesaid.

County Recorder

By _____
Deputy Recorder

STATE OF NEVADA
 78003 CERTIFICATE OF MINING LOCATION
 LODE CLAIM ON PUBLIC DOMAIN

NOTICE IS HEREBY GIVEN that the Red No. 7 lode mining claim has been located by AMERICAN SELCO INC. a New York corporation, whose address is 90 West Grove Street, Suite 100, Reno, Nevada 89509. The general course of this claim is East/West. This claim is 1500 feet in length along the course of the claim, being 10 feet from the point of discovery in a East direction to the East end line of this claim, and 1490 feet in a West direction to the West end line of the claim. This claim is 600 feet in width, being 300 feet in width on each side of the center line of the claim.

This claim is located within the SW Quarter of Section 22, Township 23 North, Range 49 East, Mount Diablo Base and Meridian, unknown Mining District, White Pine County, Nevada. The location monument of this claim is situated with reference to some natural object or permanent monument as follows: The number one corner of this claim is located approximately 5,500 feet N 64° 30' W from the located SE SE corner of Section 22, T23N, R49E, MDM

The corners of this claim are marked by 4"x4" posts or 4" trees with metal tags inscribed with the appropriate corner number as shown on the following sketch and the accompanying claim-map.

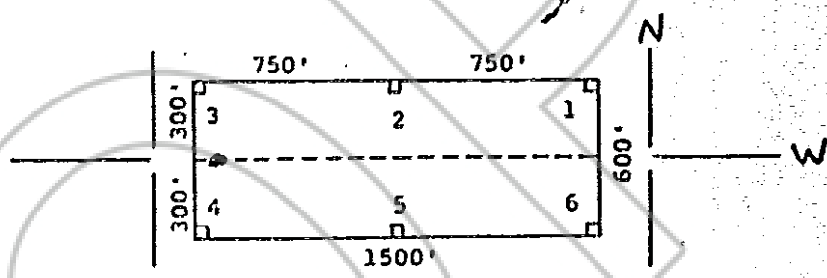

The location work consisted of making the maps as provided in NRS 517.040.

Dated and posted on the ground this 8 day of October, 1980

Witnesses: RECORDED AT REQUEST OF AMERICAN SELCO INC. Locator: AMERICAN SELCO INC.
BOOK 89 PAGE 507
 By [Signature] Agent for American Selco Inc.
 80 DEC 7 4 8: 38

STATE OF NEVADA
 COUNTY OF _____
 OFFICIAL RECORDS
 EUGENE COUNTY, NEVADA
 WILFRED A. BISHOP - RECORDER
 FILE NO. 78003
 FEE \$3.00

I hereby certify that the within instrument was filed and recorded at the request of: _____
 FILE NO. _____
 on _____
 at _____
 Docket _____ Page _____

Witness my hand and official seal the day and year aforesaid.

 County Recorder
 By _____
 Deputy Recorder

BOOK 89 PAGE 507

**78004 STATE OF NEVADA
CERTIFICATE OF MINING LOCATION
LODE CLAIM ON PUBLIC DOMAIN**

NOTICE IS HEREBY GIVEN that the Red No. 8 lode mining claim has been located by AMERICAN SELCO INC. a New York corporation, whose address is 90 West Grove Street, Suite 100, Reno, Nevada 89509. The general course of this claim is East/West. This claim is 1500 feet in length along the course of the claim, being 10 feet from the point of discovery in a East direction to the East end line of this claim, and 1490 feet in a West direction to the West end line of the claim. This claim is 600 feet in width, being 300 feet in width on each side of the center line of the claim.

This claim is located within the SW/SE Quarter of Section 22/21, Township 23 North, Range 49 East, Mount Diablo Base and Meridian, unknown Mining District, White Pine County, Nevada. The location monument of this claim is situated with reference to some natural object or permanent monument as follows: The number one corner of this claim is located approximately 5,500 feet N64°30'W from the located SE SE corner of Section 22, T23N, R49E, MDM

The corners of this claim are marked by 4"x4" posts or 4" trees with metal tags inscribed with the appropriate corner number as shown on the following sketch and the accompanying claim map.

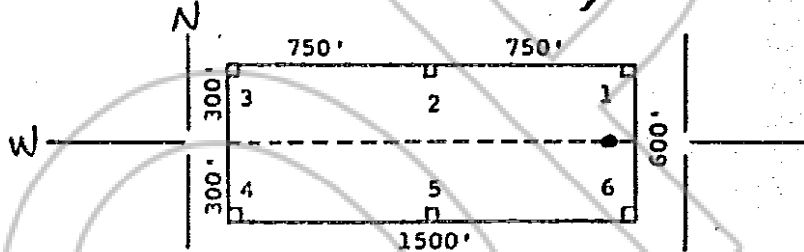

The location work consisted of making the maps as provided in NRS 517.040.

Dated and posted on the ground this 8 day of October, 1980.

Witnesses:

RECORDED AT REQUEST OF
AMERICAN SELCO INC.
BOOK 89 PAGE 508

Locator:

AMERICAN SELCO INC.

CO REC I A8:38

By [Signature]
Agent for
American Selco Inc.

STATE OF NEVADA

COUNTY OF _____

OFFICIAL RECORDS
EUREKA COUNTY, NEVADA
HILLIS A. GERRARD - RECORDER
FILE NO. 78004
FEE \$ 3.00

I hereby certify that the within instrument was filed and recorded at the request of:

FILE NO. _____
on _____
at _____
Docket _____ Page _____

Witness my hand and official seal the day and year aforesaid.

County Recorder

By _____
Deputy Recorder

BOOK 89 PAGE 508

STATE OF NEVADA
CERTIFICATE OF MINING LOCATION
LODE CLAIM ON PUBLIC DOMAIN

NOTICE IS HEREBY GIVEN that the Red No. 7 lode mining claim has been located by AMERICAN SELCO INC., a New York corporation, whose address is 90 West Grove Street, Suite 100, Reno, Nevada 89509. The general course of this claim is East/West. This claim is 1500 feet in length along the course of the claim, being 10 feet from the point of discovery in a East direction to the East end line of this claim, and 1490 feet in a West direction to the West end line of the claim. This claim is 600 feet in width, being 300 feet in width on each side of the center line of the claim.

This claim is located within the SW Quarter of Section 22, Township 23 North, Range 49 East, Mount Diablo Base and Meridian, unknown Mining District, White Pine County, Nevada. The location monument of this claim is situated with reference to some natural object or permanent monument as follows: The number one corner of this claim is located approximately 5,075 feet N 76° W from the located SE SE corner of Section 22, T23N, R49E, MDM

The corners of this claim are marked by 4"x4" posts or 4" trees with metal tags inscribed with the appropriate corner number as shown on the following sketch and the accompanying claim map.

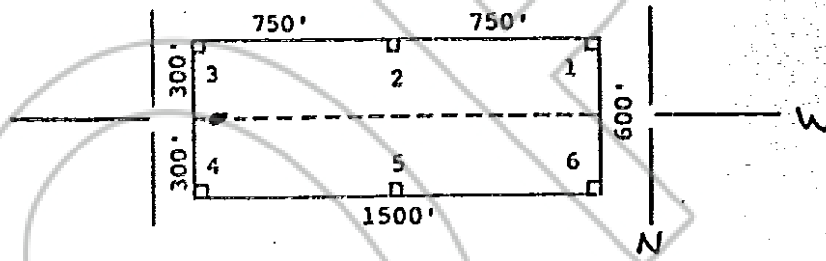

The location work consisted of making the maps as provided in NRS 517.040.

Dated and posted on the ground this 8 day of October, 1980

Witnesses:

Locator:

RECORDED AT REQUEST OF
AMERICAN SELCO INC.
BOOK 89 PAGE 509

AMERICAN SELCO INC.

80 DEC 1 AM: 38

By [Signature]
Agent for
American Selco Inc.

OFFICIAL RECORDS
EUREKA COUNTY, NEVADA
CLERK & DEPUTY CLERK
STATE OF NEVADA
78005
COUNTY OF [Blank]
(Fee \$ 3.00)

I hereby certify that the within instrument was filed and recorded at the request of: _____
FILE NO. _____
on _____
at _____
Docket _____ Page _____

Witness my hand and official seal the day and year aforesaid.

County Recorder

By _____
Deputy Recorder

BOOK 89 PAGE 509

STATE OF NEVADA
CERTIFICATE OF MINING LOCATION
LODE CLAIM ON PUBLIC DOMAIN

NOTICE IS HEREBY GIVEN that the Red No. 10 lode mining claim has been located by AMERICAN SELCO INC. a New York corporation, whose address is 90 West Grove Street, Suite 100, Reno, Nevada 89509. The general course of this claim is East/West. This claim is 1500 feet in length along the course of the claim, being 10 feet from the point of discovery in a East direction to the East end line of this claim, and 1490 feet in a West direction to the West end line of the claim. This claim is 600 feet in width, being 300 feet in width on each side of the center line of the claim.

This claim is located within the SW/SE Quarter of Section 22/21, Township 23 North, Range 49 East, Mount Diablo Base and Meridian, unknown Mining District, White Pine County, Nevada. The location monument of this claim is situated with reference to some natural object or permanent monument as follows: The number one corner of this claim is located approximately 5,075 feet N 76° W from the located SE SE corner of Section 22, T23N, R49E, MDM

The corners of this claim are marked by 4"x4" posts or 4" trees with metal tags inscribed with the appropriate corner number as shown on the following sketch and the accompanying claim map.

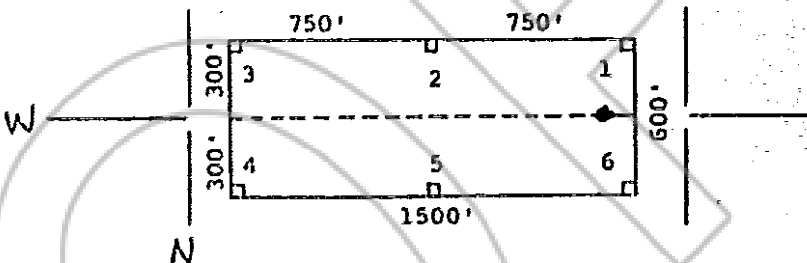

The location work consisted of making the maps as provided in NRS 517.040.

Dated and posted on the ground this 8 day of October, 1980

Witnesses: RECORDED AT REQUEST OF AMERICAN SELCO INC. BOOK 89 PAGE 519.

Locator: AMERICAN SELCO INC.

80 DEC 1 10:30

By [Signature]
Agent for
American Selco Inc.

OFFICIAL RECORDS
EUREKA COUNTY, NEVADA
WILLIS A. DEPAULIS, RECORDER
STATE OF NEVADA FILE NO. 78006
FEE \$ 3.00
COUNTY OF _____

I hereby certify that the within instrument was filed and recorded at the request of: _____
on _____
at _____
Docket _____ Page _____

Witness my hand and official seal the day and year aforesaid.
County Recorder _____
By _____
Deputy Recorder

BOOK 89 PAGE 510

78007

STATE OF NEVADA
CERTIFICATE OF MINING LOCATION
LODE CLAIM ON PUBLIC DOMAIN

NOTICE IS HEREBY GIVEN that the Red No. 11 lode mining claim has been located by AMERICAN SELCO INC. a New York corporation, whose address is 90 West Grove Street, Suite 100, Reno, Nevada 89509. The general course of this claim is East/West. This claim is 1500 feet in length along the course of the claim, being 10 feet from the point of discovery in a East direction to the East end line of this claim, and 1490 feet in a West direction to the West end line of the claim. This claim is 600 feet in width, being 300 feet in width on each side of the center line of the claim.

This claim is located within the SW/SE Quarter of Section 22/21, Township 23 North, Range 49 East, Mount Diablo Base and Meridian, unknown Mining District, White Pine County, Nevada. The location monument of this claim is situated with reference to some natural object or permanent monument as follows: The number one corner of this claim is located approximately 5,075 feet N176°W from the located SE SE corner of Section 22, T23N, R49E, MDM

The corners of this claim are marked by 4"x4" posts or 4" trees with metal tags inscribed with the appropriate corner number as shown on the following sketch and the accompanying claim map.

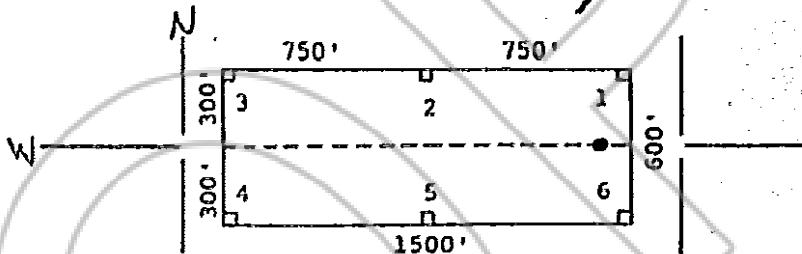

The location work consisted of making the maps as provided in NRS 517.040.

Dated and posted on the ground this 10 day of October, 1980.

Witnesses:

RECORDED AT REQUEST OF
AMERICAN SELCO INC.
BOOK 89 PAGE 511

Locator:

AMERICAN SELCO INC.

80 DEC 1 A 8: 38

By [Signature]
Agent for
American Selco Inc.

STATE OF NEVADA

OFFICIAL RECORDS
EUREKA COUNTY, NEVADA
WILLIS A. DEPAOLI, RECORDER
FILE NO. 78007
FEE \$ 3.00

COUNTY OF _____

I hereby certify that the within instrument was filed and recorded at the request of: _____

FILE NO. _____

on _____

at _____

Docket _____ Page _____

Witness my hand and official seal the day and year aforesaid.

County Recorder _____

By _____

Deputy Recorder

BOOK 89 PAGE 511

NOTICE IS HEREBY GIVEN that the Red No. 12 lode mining claim has been located by AMERICAN SELCO INC. a New York corporation, whose address is 90 West Grove Street, Suite 100, Reno, Nevada 89509. The general course of this claim is East/West. This claim is 1500 feet in length along the course of the claim, being 10 feet from the point of discovery in a East direction to the East end line of this claim, and 1490 feet in a West direction to the West end line of the claim. This claim is 600 feet in width, being 300 feet in width on each side of the center line of the claim.

This claim is located within the SW/SE Quarter of Section 22/21, Township 23 North, Range 49 East, Mount Diablo Base and Meridian, unknown Mining District, White Pine County, Nevada. The location monument of this claim is situated with reference to some natural object or permanent monument as follows: The number one corner of this claim is located approximately 4,250 feet due West from the located SE SE corner of Section 22, T23N, R49E, MDM

The corners of this claim are marked by 4"x4" posts or 4" trees with metal tags inscribed with the appropriate corner number as shown on the following sketch and the accompanying claim map.

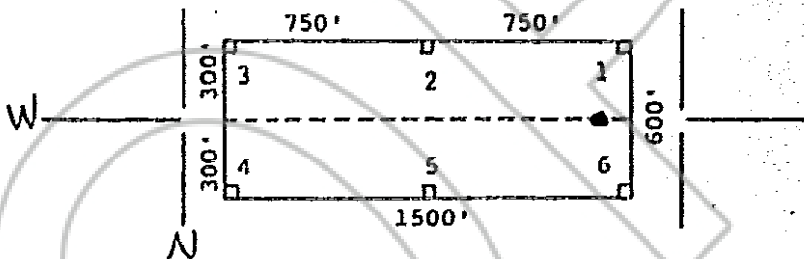

The location work consisted of making the maps as provided in NRS 517.040.

Dated and posted on the ground this 10 day of October, 1980.

Witnesses: AMERICAN SELCO INC
BOOK 89 PAGE 512

Locator: AMERICAN SELCO INC.

60 DEC 1 8:38

By [Signature]
Agent for
American Selco Inc.

OFFICIAL RECORDS
ELIENOR COUNTY, NEVADA
WILLIS A. DEPAOLI - RECORDER
78008
FEL 3.00

STATE OF NEVADA

COUNTY OF _____

I hereby certify that the within instrument was filed and recorded at the request of: _____

FILE NO. _____
on _____
at _____
Docket _____ Page _____

Witness my hand and official seal the day and year aforesaid.

County Recorder

By _____
Deputy Recorder

BOOK 89 PAGE 512

STATE OF NEVADA
CERTIFICATE OF MINING LOCATION
LODE CLAIM ON PUBLIC DOMAIN

NOTICE IS HEREBY GIVEN that the Red No. 13 lode mining claim has been located by AMERICAN SELCO INC. a New York corporation, whose address is 90 West Grove Street, Suite 100, Reno, Nevada 89509. The general course of this claim is East/West. This claim is 1500 feet in length along the course of the claim, being 10 feet from the point of discovery in a East direction to the East end line of this claim, and 1490 feet in a West direction to the West end line of the claim. This claim is 600 feet in width, being 300 feet in width on each side of the center line of the claim.

This claim is located within the NW Quarter of Section 27, Township 23 North, Range 49 East, Mount Diablo Base and Meridian, unknown Mining District, White Pine County, Nevada. The location monument of this claim is situated with reference to some natural object or permanent monument as follows: The number one corner of this claim is located approximately 4,950 feet due West from the located SE SE corner of Section 22, T23N, R49E, MDM

The corners of this claim are marked by 4"x4" posts or 4" trees with metal tags inscribed with the appropriate corner number as shown on the following sketch and the accompanying claim-map.

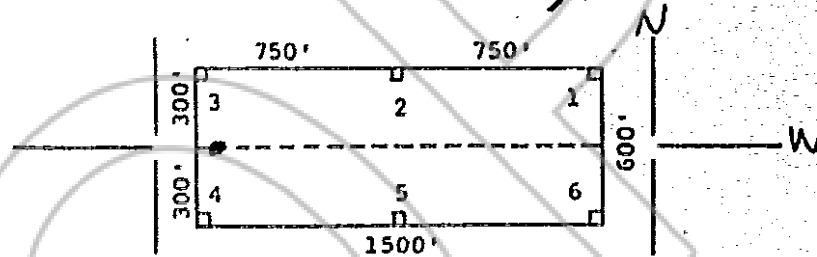

The location work consisted of making the maps as provided in NRS 517.040.

Dated and posted on the ground this 7 day of October, 1980

Witnesses: RECORDED AT REQUEST OF AMERICAN SELCO INC
BOOK 89 PAGE 512

Locator: AMERICAN SELCO INC.

80 DEC 1 4 8: 38

By [Signature]
Agent for
American Selco Inc.

OFFICIAL RECORDS
EDREKA COUNTY, NEVADA
WILLIS A. DEPTA, RECORDER
STATE OF NEVADA FILE NO. 78009
FEE \$ 3.00) ss.
COUNTY OF _____)

I hereby certify that the within instrument was filed and recorded at the request of: _____
FILE NO. _____
on _____
at _____
Docket _____ Page _____

Witness my hand and official seal the day and year aforesaid.

County Recorder
By _____
Deputy Recorder
BOOK 89 PAGE 513

STATE OF NEVADA
CERTIFICATE OF MINING LOCATION
LODE CLAIM ON PUBLIC DOMAIN

NOTICE IS HEREBY GIVEN that the Red No. 14 lode mining claim has been located by AMERICAN SELCO INC. a New York corporation, whose address is 90 West Grove Street, Suite 100, Reno, Nevada 89509. The general course of this claim is East/West. This claim is 1500 feet in length along the course of the claim, being 10 feet from the point of discovery in a East direction to the East end line of this claim, and 1490 feet in a West direction to the West end line of the claim. This claim is 600 feet in width, being 300 feet in width on each side of the center line of the claim.

This claim is located within the NW/NE Quarter of Section 27/28, Township 23 North, Range 49 East, Mount Diablo Base and Meridian, unknown Mining District, White Pine County, Nevada. The location monument of this claim is situated with reference to some natural object or permanent monument as follows: The number one corner of this claim is located approximately 4,250 feet due West from the located SE SE corner of Section 22, T23N, R49E, MDM

The corners of this claim are marked by 4"x4" posts or 4" trees with metal tags inscribed with the appropriate corner number as shown on the following sketch and the accompanying claim map.

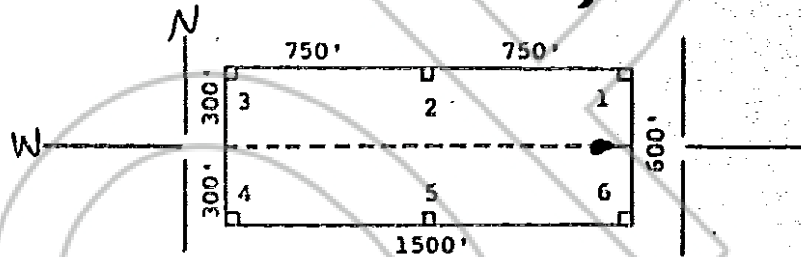

The location work consisted of making the maps as provided in NRS 517.040.

Dated and posted on the ground this 8 day of October, 1980.

Witnesses: RECORDED AT REQUEST OF AMERICAN SELCO INC
BOOK 89 PAGE 514

Locator: AMERICAN SELCO INC.

80 DEC 1 8 38

By [Signature]
Agent for
American Selco Inc.

OFFICIAL RECORDS
EUREKA COUNTY, NEVADA
WILLIS A. DUFFOLI - RECORDER
STATE OF NEVADA FILE NO. 78010
FEE \$ 3.00
COUNTY OF _____

I hereby certify that the within instrument was filed and recorded at the request of: _____
FILE NO. _____
on _____
at _____
Docket _____ Page _____

Witness my hand and official seal the day and year aforesaid.

County Recorder
By _____
Deputy Recorder

BOOK 89 PAGE 514

78011 STATE OF NEVADA
CERTIFICATE OF MINING LOCATION
LODE CLAIM ON PUBLIC DOMAIN

NOTICE IS HEREBY GIVEN that the Red No. 15
lode mining claim has been located by AMERICAN SELCO INC.
a New York corporation, whose address is 90 West Grove Street,
Suite 100, Reno, Nevada 89509. The general course of this claim
is East/West. This claim is 1500 feet in length
along the course of the claim, being 10 feet from the point
of discovery in a East direction to the East end
line of this claim, and 1490 feet in a West
direction to the West end line of the claim. This claim is
600 feet in width, being 300 feet in width on each side of the
center line of the claim.

This claim is located within the NW Quarter
of Section 27, Township 23 North, Range 49
East, Mount Diablo Base and Meridian, unknown Mining District,
White Pine County, Nevada. The location monument of this claim is
situated with reference to some natural object or permanent monument
as follows: The number one corner of this claim is located
approximately 5.100 feet S 76° W from the located SE
SE corner of Section 22, T23N, R49E, MDM

The corners of this claim are marked by 4"x4" posts or 4" trees
with metal tags inscribed with the appropriate corner number as
shown on the following sketch and the accompanying claim map.

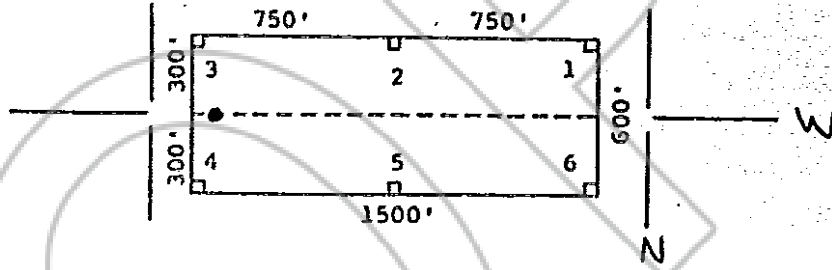

The location work consisted of making the maps as provided in
NRS 517.040.

Dated and posted on the ground this 7 day of October,
1980

Witnesses: RECORDED AT REQUEST OF
AMERICAN SELCO INC
BOOK 89 PAGE 515

Locator:
AMERICAN SELCO INC.

80 DEC 1 8:38

By [Signature]
Agent for
American Selco Inc.

OFFICIAL RECORDS
EUREKA COUNTY, NEVADA
WILLIS A. DUFFY, RECORDER
FILE NO. 78011
FEE \$ 3.00

STATE OF NEVADA
COUNTY OF _____

I hereby certify that the within
instrument was filed and recorded at
the request of: _____

FILE NO. _____
on _____
at _____
Docket _____ Page _____

Witness my hand and official
seal the day and year aforesaid.

County Recorder

By _____
Deputy Recorder

BOOK 89 PAGE 515

STATE OF NEVADA
CERTIFICATE OF MINING LOCATION
LODE CLAIM ON PUBLIC DOMAIN

NOTICE IS HEREBY GIVEN that the Red No. 16 lode mining claim has been located by AMERICAN SELCO INC. a New York corporation, whose address is 90 West Grove Street, Suite 100, Reno, Nevada 89509. The general course of this claim is East/West. This claim is 1500 feet in length along the course of the claim, being 10 feet from the point of discovery in a East direction to the East end line of this claim, and 1490 feet in a West direction to the West end line of the claim. This claim is 600 feet in width, being 300 feet in width on each side of the center line of the claim.

This claim is located within the NW/NE Quarter of Section 27/28, Township 23 North, Range 49 East, Mount Diablo Base and Meridian, unknown Mining District, White Pine County, Nevada. The location monument of this claim is situated with reference to some natural object or permanent monument as follows: The number one corner of this claim is located approximately feet from the located SE SE corner of Section 22, T23N, R49E, MDM

The corners of this claim are marked by 4"x4" posts or 4" trees with metal tags inscribed with the appropriate corner number as shown on the following sketch and the accompanying claim-map.

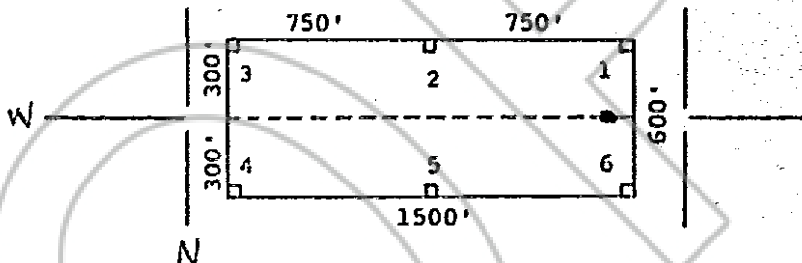

The location work consisted of making the maps as provided in NRS 517.040.

Dated and posted on the ground this 8 day of October, 1980

Witnesses: RECORDED AT REQUEST OF AMERICAN SELCO INC
BOOK 89 PAGE 516

Locator: AMERICAN SELCO INC.

80 DEC 1 8 38

By [Signature]
Agent for American Selco Inc.

OFFICIAL RECORDS
EUREKA COUNTY, NEVADA
WILLIS A. DEPAOLI - RECORDER
FILE NO. 78012
FEE \$ 3.00 1ss.

STATE OF NEVADA
COUNTY OF _____

I hereby certify that the within instrument was filed and recorded at the request of: _____
FILE NO. _____
on _____
at _____
Docket _____ Page _____

Witness my hand and official seal the day and year aforesaid.

County Recorder

By _____
Deputy Recorder

BOOK 89 PAGE 516

STATE OF NEVADA
CERTIFICATE OF MINING LOCATION
LODE CLAIM ON PUBLIC DOMAIN

NOTICE IS HEREBY GIVEN that the Red No. 17 lode mining claim has been located by AMERICAN SELCO INC., a New York corporation, whose address is 90 West Grove Street, Suite 100, Reno, Nevada 89509. The general course of this claim is East/West. This claim is 1500 feet in length along the course of the claim, being 10 feet from the point of discovery in a East direction to the East end line of this claim, and 1490 feet in a West direction to the West end line of the claim. This claim is 600 feet in width, being 300 feet in width on each side of the center line of the claim.

This claim is located within the NW Quarter of Section 27, Township 23 North, Range 49 East, Mount Diablo Base and Meridian, unknown Mining District, White Pine County, Nevada. The location monument of this claim is situated with reference to some natural object or permanent monument as follows: The number one corner of this claim is located approximately 5,100 feet S 76° W from the located SE SE corner of Section 22, T23N, R49E, MDM

The corners of this claim are marked by 4"x4" posts or 4" trees with metal tags inscribed with the appropriate corner number as shown on the following sketch and the accompanying claim map.

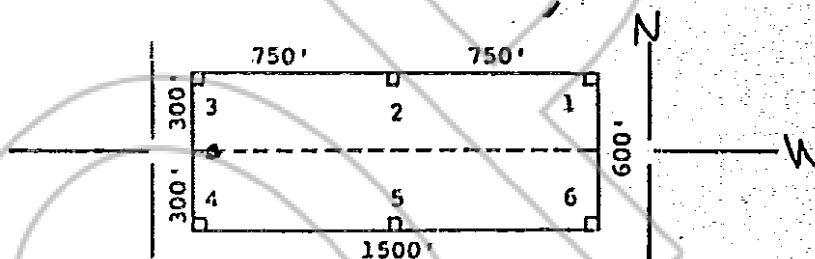

The location work consisted of making the maps as provided in NRS 517.040.

Dated and posted on the ground this 7 day of October, 1980

Witnesses: RECORDED AT REQUEST OF AMERICAN SELCO INC. BOOK 89 PAGE 517

Locator: AMERICAN SELCO INC.
By [Signature]
Agent for American Selco Inc.

80 DEC 1 10:30

OFFICIAL RECORDS
WHITE PINE COUNTY, NEVADA
WILLIS A. DEPAULI-RECORDER
STATE OF NEVADA FILE NO. 78013
COUNTY OF White Pine FEE \$ 3.00

I hereby certify that the within instrument was filed and recorded at the request of: _____
FILE NO. _____
on _____
at _____
Docket _____ Page _____

Witness my hand and official seal the day and year aforesaid.

County Recorder
By _____
Deputy Recorder
BOOK 89 PAGE 517

STATE OF NEVADA
CERTIFICATE OF MINING LOCATION
LODE CLAIM ON PUBLIC DOMAIN

NOTICE IS HEREBY GIVEN that the Red No. 18 lode mining claim has been located by AMERICAN SELCO INC., a New York corporation, whose address is 90 West Grove Street, Suite 100, Reno, Nevada 89509. The general course of this claim is East/West. This claim is 1500 feet in length along the course of the claim, being 10 feet from the point of discovery in a East direction to the East end line of this claim, and 1490 feet in a West direction to the West end line of the claim. This claim is 600 feet in width, being 300 feet in width on each side of the center line of the claim.

This claim is located within the NW/NE Quarter of Section 27/28, Township 23 North, Range 49 East, Mount Diablo Base and Meridian, unknown Mining District, White Pine County, Nevada. The location monument of this claim is situated with reference to some natural object or permanent monument as follows: The number one corner of this claim is located approximately 5100 feet S76°W from the located SE SE corner of Section 22, T23N, R49E, MDN

The corners of this claim are marked by 4"x4" posts or 4" trees with metal tags inscribed with the appropriate corner number as shown on the following sketch and the accompanying claim map.

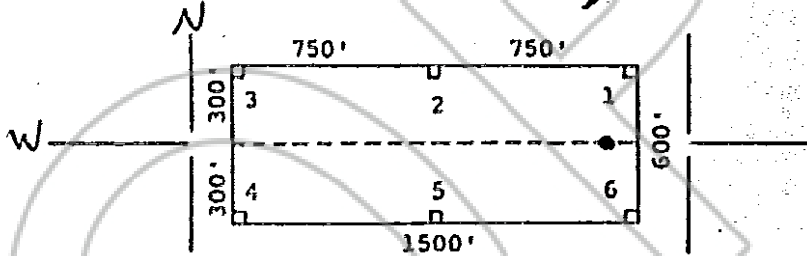

The location work consisted of making the maps as provided in NRS 517.040.

Dated and posted on the ground this 8 day of October, 1980

Witnesses: RECORDED AT REQUEST OF AMERICAN SELCO INC.
BOOK 89 PAGE 518

Locator: AMERICAN SELCO INC.
By [Signature]
Agent for
American Selco Inc.

80 DEC 1 A 8: 38

OFFICIAL RECORDS
EUREKA COUNTY, NEVADA
WILLIS A. DEPAOLI, RECORDER
STATE OF NEVADA FILE NO. 78014
COUNTY OF [Blank] FEE \$ 3.00

I hereby certify that the within instrument was filed and recorded at the request of: _____
FILE NO. _____
on _____
at _____
Docket _____ Page _____

Witness my hand and official seal the day and year aforesaid.

County Recorder
By _____
Deputy Recorder

BOOK 89 PAGE 518

STATE OF NEVADA
 78015 CERTIFICATE OF MINING LOCATION
 LODE CLAIM ON PUBLIC DOMAIN

NOTICE IS HEREBY GIVEN that the Red No. 19 lode mining claim has been located by AMERICAN SELCO INC. a New York corporation, whose address is 90 West Grove Street, Suite 100, Reno, Nevada 89509. The general course of this claim is East/West. This claim is 1500 feet in length along the course of the claim, being 10 feet from the point of discovery in a East direction to the East end line of this claim, and 1490 feet in a West direction to the West end line of the claim. This claim is 600 feet in width, being 300 feet in width on each side of the center line of the claim.

This claim is located within the NW Quarter of Section 27, Township 23 North, Range 49 East, Mount Diablo Base and Meridian, unknown Mining District, White Pine County, Nevada. The location monument of this claim is situated with reference to some natural object or permanent monument as follows: The number one corner of this claim is located approximately 525 feet S 63° 50' W from the located SE SE corner of Section 22, T23N, R49E, MDM

The corners of this claim are marked by 4"x4" posts or 4" trees with metal tags inscribed with the appropriate corner number as shown on the following sketch and the accompanying claim map.

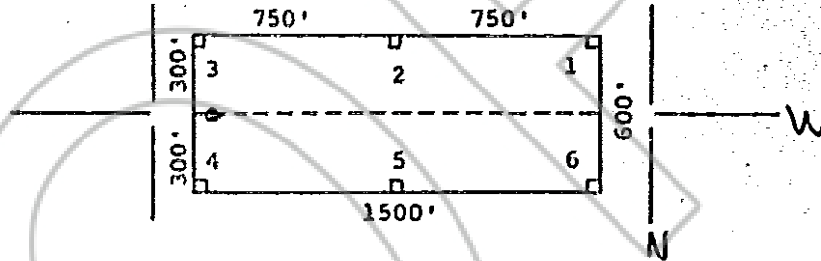

The location work consisted of making the maps as provided in NRS 517.040.

Dated and posted on the ground this 7 day of October, 1980

Witnesses:
RECORDED AT REQUEST OF
AMERICAN SELCO INC.
BOOK 89 PAGE 519

Locator:
AMERICAN SELCO INC.
 By [Signature]
 Agent for
 American Selco Inc.

80 DEC 1 A 8: 38

OFFICIAL RECORDS
 EGRENA COUNTY, NEVADA
 STATE OF NEVADA, DEPUTY COUNTY RECORDER
 FILE NO. 78015
 COUNTY OF [] FEE \$ 2.00

I hereby certify that the within instrument was filed and recorded at the request of: _____
 FILE NO. _____
 on _____
 at _____
 Docket _____ Page _____

Witness my hand and official seal the day and year aforesaid.

 County Recorder
 By _____
 Deputy Recorder

BOOK 89 PAGE 519

STATE OF NEVADA
78016 CERTIFICATE OF MINING LOCATION
LODE CLAIM ON PUBLIC DOMAIN

NOTICE IS HEREBY GIVEN that the Red No. 20 lode mining claim has been located by AMERICAN SELCO INC. a New York corporation, whose address is 90 West Grove Street, Suite 100, Reno, Nevada 89509. The general course of this claim is East/West. This claim is 1500 feet in length along the course of the claim, being 10 feet from the point of discovery in a East direction to the East end line of this claim, and 1490 feet in a West direction to the West end line of the claim. This claim is 600 feet in width, being 300 feet in width on each side of the center line of the claim.

This claim is located within the NW Quarter of Section 27, Township 23 North, Range 49 East, Mount Diablo Base and Meridian, unknown Mining District, White Pine County, Nevada. The location monument of this claim is situated with reference to some natural object or permanent monument as follows: The number one corner of this claim is located approximately 552.5 feet S63°50'W from the located SE SE corner of Section 22, T23N, R49E, MDM

The corners of this claim are marked by 4"x4" posts or 4" trees with metal tags inscribed with the appropriate corner number as shown on the following sketch and the accompanying claim-map.

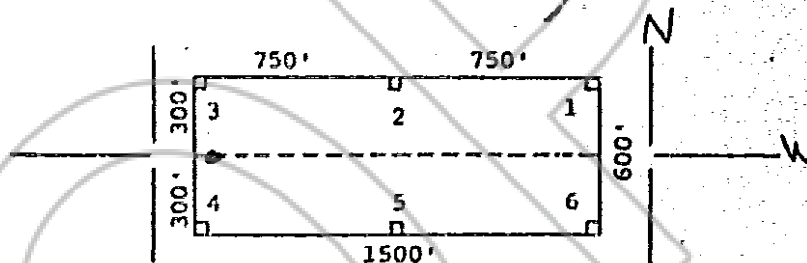

The location work consisted of making the maps as provided in NRS 517.040.

Dated and posted on the ground this 7 day of October, 1980

Witnesses:

RECORDED AT REQUEST OF
AMERICAN SELCO INC
BOOK 87 PAGE 380

Locator:

AMERICAN SELCO INC.

80 DEC 1 A 8: 38

By [Signature]
Agent for
American Selco Inc.

STATE OF NEVADA

OFFICIAL RECORDS
EUREKA COUNTY, NEVADA
WILLIS A. DEPAULI-RECORDER
FILE NO. 78016
FEE \$ 3.00 SS.

COUNTY OF _____)

I hereby certify that the within instrument was filed and recorded at the request of: _____

FILE NO. _____
on _____
at _____
Docket _____ Page _____

Witness my hand and official seal the day and year aforesaid.

County Recorder

By _____
Deputy Recorder

BOOK 89 PAGE 520

STATE OF NEVADA
CERTIFICATE OF MINING LOCATION
LODE CLAIM ON PUBLIC DOMAIN

NOTICE IS HEREBY GIVEN that the Red No. 21 lode mining claim has been located by AMERICAN SELCO INC., a New York corporation, whose address is 90 West Grove Street, Suite 100, Reno, Nevada 89509. The general course of this claim is East/West. This claim is 1500 feet in length along the course of the claim, being 1490 feet from the point of discovery in a East direction to the East end line of this claim, and 10 feet in a West direction to the West end line of the claim. This claim is 600 feet in width, being 300 feet in width on each side of the center line of the claim.

This claim is located within the SWSE Quarter of Section 27, Township 23 North, Range 49 East, Mount Diablo Base and Meridian, unknown Mining District, White Pine County, Nevada. The location monument of this claim is situated with reference to some natural object or permanent monument as follows: The number one corner of this claim is located approximately 4,100 feet S27°40'W from the located SE SE corner of Section 22, T23N, R49E, MDM

The corners of this claim are marked by 4"x4" posts or 4" trees with metal tags inscribed with the appropriate corner number as shown on the following sketch and the accompanying claim-map.

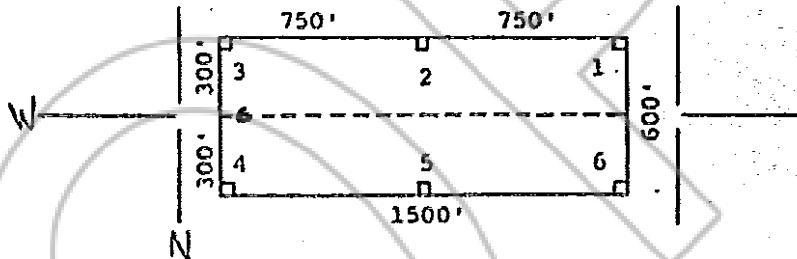

The location work consisted of making the maps as provided in NRS 517.040.

Dated and posted on the ground this 7 day of October, 1960.

Witnesses: AMERICAN SELCO INC

Locator: AMERICAN SELCO INC.
BY [Signature]
Agent for
American Selco Inc.

RECORDED AT REQUEST OF
BOOK 89 PAGE 521

80 DEC 1 10 48:30

OFFICIAL RECORDS
ESSEX COUNTY, NEVADA
WILLIS A. DEPTOLI, RECORDER
FILE NO. 78017
FEE \$ 3.00

STATE OF NEVADA
COUNTY OF _____) ss.

I hereby certify that the within instrument was filed and recorded at the request of: _____
on _____
at _____
Docket _____ Page _____

Witness my hand and official seal the day and year aforesaid.
County Recorder _____
By _____
Deputy Recorder
BOOK 89 PAGE 521

NOTICE IS HEREBY GIVEN that the Red No. 22 lode mining claim has been located by AMERICAN SELCO INC. a New York corporation, whose address is 90 West Grove Street, Suite 100, Reno, Nevada 89509. The general course of this claim is East/West. This claim is 1500 feet in length along the course of the claim, being 10 feet from the point of discovery in a East direction to the East end line of this claim, and 1490 feet in a West direction to the West end line of the claim. This claim is 600 feet in width, being 300 feet in width on each side of the center line of the claim.

This claim is located within the SW Quarter of Section 27, Township 23 North, Range 49 East, Mount Diablo Base and Meridian, unknown Mining District, White Pine County, Nevada. The location monument of this claim is situated with reference to some natural object or permanent monument as follows: The number one corner of this claim is located approximately 6150 feet S53°40'W from the located SE SE corner of Section 22, T23N, R49E, MDM

The corners of this claim are marked by 4"x4" posts or 4" trees with metal tags inscribed with the appropriate corner number as shown on the following sketch and the accompanying claim map.

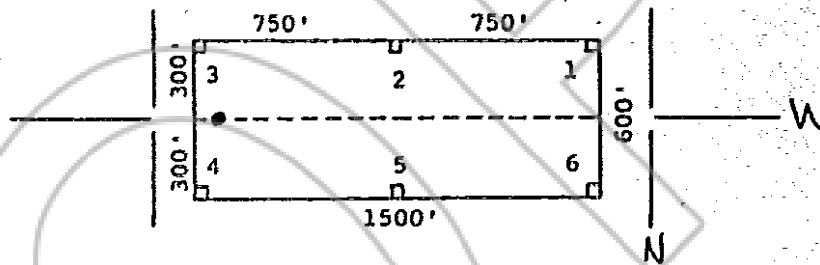

The location work consisted of making the maps as provided in NRS 517.040.

Dated and posted on the ground this 7 day of October, 1980.

Witnesses RECORDED AT REQUEST OF
AMERICAN SELCO INC.
BOOK 89 PAGE 522

Locator:

AMERICAN SELCO INC.

80 DEC 1 A8:38

By [Signature]
Agent for
American Selco Inc.

OFFICIAL RECORDS
EUREKA COUNTY, NEVADA
WILLIS A. DEPAOLI - RECORDER
STATE OF NEVADA)
FILE NO. 78018)
FEE \$ 3.00) ss.
COUNTY OF _____)

I hereby certify that the within instrument was filed and recorded at the request of: _____
FILE NO. _____
on _____
at _____
Docket _____ Page _____

Witness my hand and official seal the day and year aforesaid.

County Recorder

By _____
Deputy Recorder

BOOK 89 PAGE 522

STATE OF NEVADA
CERTIFICATE OF MINING LOCATION
LODE CLAIM ON PUBLIC DOMAIN

NOTICE IS HEREBY GIVEN that the Red No. 23 lode mining claim has been located by AMERICAN SELCO INC. a New York corporation, whose address is 90 West Grove Street, Suite 100, Reno, Nevada 89509. The general course of this claim is East/West. This claim is 1500 feet in length along the course of the claim, being 1490 feet from the point of discovery in a East direction to the East end line of this claim, and 10 feet in a West direction to the West end line of the claim. This claim is 600 feet in width, being 300 feet in width on each side of the center line of the claim.

This claim is located within the SW 1/4 SE Quarter of Section 27, Township 23 North, Range 49 East, Mount Diablo Base and Meridian, unknown Mining District, White Pine County, Nevada. The location monument of this claim is situated with reference to some natural object or permanent monument as follows: The number one corner of this claim is located approximately 4,100 feet S 27° 46' W from the located SE SE corner of Section 22, T23N, R49E, MDM

The corners of this claim are marked by 4"x4" posts or 4" trees with metal tags inscribed with the appropriate corner number as shown on the following sketch and the accompanying claim map.

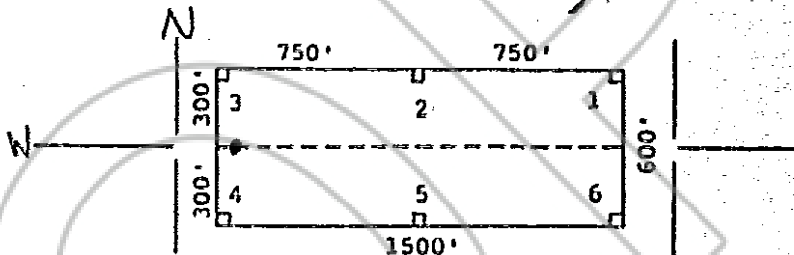

The location work consisted of making the maps as provided in NRS 517.040.

Dated and posted on the ground this 7 day of October, 1980

Witnesses: RECORDED AT REQUEST OF AMERICAN SELCO INC. BOOK 89 PAGE 523

Locator: AMERICAN SELCO INC.

80 DEC 1 8:38

By [Signature]
Agent for
American Selco Inc.

OFFICIAL RECORDS
EUREKA COUNTY, NEVADA
WILLIS A. DENALI, RECORDER
STATE OF NEVADA FILE NO. 78019
FEE \$ 2.00
COUNTY OF _____

I hereby certify that the within instrument was filed and recorded at the request of:
FILE NO. _____
on _____
at _____
Docket _____ Page _____

Witness my hand and official seal the day and year aforesaid.

County Recorder
By _____
Deputy Recorder
BOOK 89 PAGE 523

STATE OF NEVADA
CERTIFICATE OF MINING LOCATION
LODE CLAIM ON PUBLIC DOMAIN

NOTICE IS HEREBY GIVEN that the Red No. 24 lode mining claim has been located by AMERICAN SELCO INC. a New York corporation, whose address is 90 West Grove Street, Suite 100, Reno, Nevada 89509. The general course of this claim is East/West. This claim is 1500 feet in length along the course of the claim, being 10 feet from the point of discovery in a East direction to the East end line of this claim, and 1490 feet in a West direction to the West end line of the claim. This claim is 600 feet in width, being 300 feet in width on each side of the center line of the claim.

This claim is located within the SW Quarter of Section 27, Township 23 North, Range 49 East, Mount Diablo Base and Meridian, unknown Mining District, White Pine County, Nevada. The location monument of this claim is situated with reference to some natural object or permanent monument as follows: The number one corner of this claim is located approximately 6150 feet S 53° 40' W from the located SE SE corner of Section 22, T23N, R49E, MDM

The corners of this claim are marked by 4"x4" posts or 4" trees with metal tags inscribed with the appropriate corner number as shown on the following sketch and the accompanying claim map.

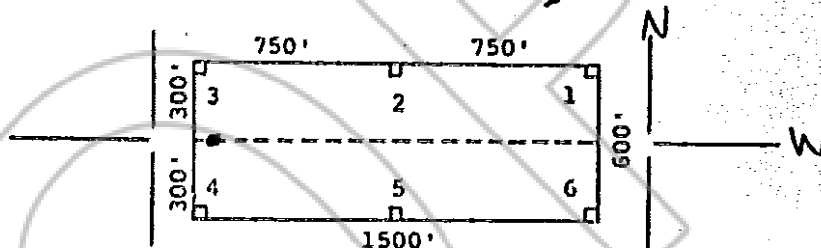

The location work consisted of making the maps as provided in NRS 517.040.

Dated and posted on the ground this 7 day of October 1980

Witnesses: RECORDED AT REQUEST OF Locator:

AMERICAN SELCO INC.
BOOK 89 PAGE 524

AMERICAN SELCO INC.

80 DEC 7 8:38

By [Signature]
Agent for
American Selco Inc.

OFFICIAL RECORDS
EUREKA COUNTY, NEVADA
WILLIS A. CIPOLLA - RECORDER
FILE NO. 78020
FEE \$ 3.00

STATE OF NEVADA

COUNTY OF _____

I hereby certify that the within instrument was filed and recorded at the request of: _____

FILE NO. _____
on _____
at _____
Docket _____ page _____

Witness my hand and official seal the day and year aforesaid.

County Recorder

By _____
Deputy Recorder

BOOK 89 PAGE 524

STATE OF NEVADA
CERTIFICATE OF MINING LOCATION
LODE CLAIM ON PUBLIC DOMAIN

NOTICE IS HEREBY GIVEN that the Red No. 25 lode mining claim has been located by AMERICAN SELCO INC. a New York corporation, whose address is 90 West Grove Street, Suite 100, Reno, Nevada 89509. The general course of this claim is East/West. This claim is 1500 feet in length along the course of the claim, being 1490 feet from the point of discovery in a East direction to the East end line of this claim, and 10 feet in a West direction to the West end line of the claim. This claim is 600 feet in width, being 300 feet in width on each side of the center line of the claim.

This claim is located within the SW & SE Quarter of Section 27, Township 23 North, Range 49 East, Mount Diablo Base and Meridian, unknown Mining District, White Pine County, Nevada. The location monument of this claim is situated with reference to some natural object or permanent monument as follows: The number one corner of this claim is located approximately 5175 feet S 21° 40' W from the located SE SE corner of Section 22, T23N, R49E, MDM

The corners of this claim are marked by 4"x4" posts or 4" trees with metal tags inscribed with the appropriate corner number as shown on the following sketch and the accompanying claim-map.

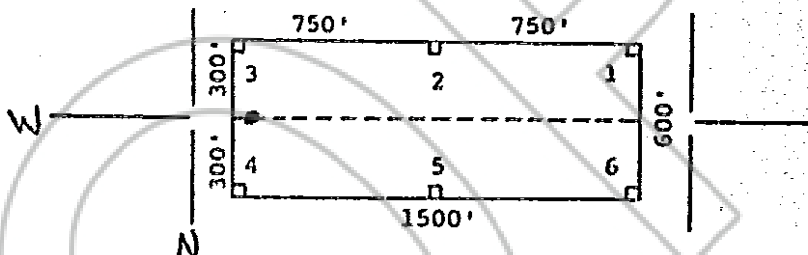

The location work consisted of making the maps as provided in NRS 517.040.

Dated and posted on the ground this 7 day of October, 1980.

Witnesses: RECORDED AT REQUEST OF AMERICAN SELCO INC. BOOK 89 PAGE 525

Locator: AMERICAN SELCO INC.

80 DEC 1 8:38

By [Signature]
Agent for
American Selco Inc.

OFFICIAL RECORDS
EUREKA COUNTY, NEVADA
WILLIS A. GIAPOLI, RECORDER
STATE OF NEVADA FILE NO. 78021
FEE \$ 3.00
COUNTY OF _____

I hereby certify that the within instrument was filed and recorded at the request of:
FILE NO. _____
on _____
at _____
Docket _____ Page _____

Witness my hand and official seal the day and year aforesaid.

County Recorder
By _____
Deputy Recorder
BOOK 89 PAGE 525

STATE OF NEVADA
CERTIFICATE OF MINING LOCATION
LODE CLAIM ON PUBLIC DOMAIN

NOTICE IS HEREBY GIVEN that the Red No. 26 lode mining claim has been located by AMERICAN SELCO INC. a New York corporation, whose address is 90 West Grove Street, Suite 100, Reno, Nevada 89509. The general course of this claim is East/West. This claim is 1500 feet in length along the course of the claim, being 10 feet from the point of discovery in a East direction to the East end line of this claim, and 1490 feet in a West direction to the West end line of the claim. This claim is 600 feet in width, being 300 feet in width on each side of the center line of the claim.

This claim is located within the SW Quarter of Section 27, Township 23 North, Range 49 East, Mount Diablo Base and Meridian, unknown Mining District, White Pine County, Nevada. The location monument of this claim is situated with reference to some natural object or permanent monument as follows: The number one corner of this claim is located approximately 6900 feet S45°50'W from the located SE SE corner of Section 22, T23N, R49E, MDM

The corners of this claim are marked by 4"x4" posts or 4" trees with metal tags inscribed with the appropriate corner number as shown on the following sketch and the accompanying claim map.

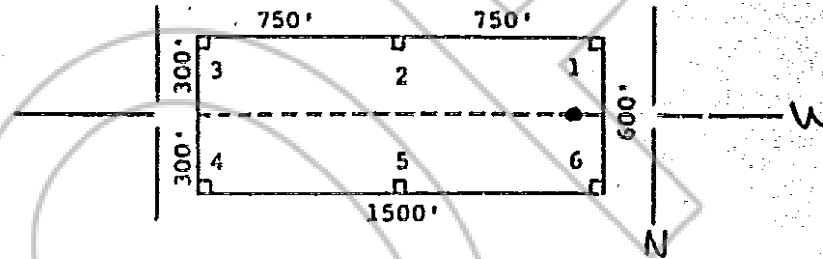

The location work consisted of making the maps as provided in NRS 517.040.

Dated and posted on the ground this 7 day of October, 1980

Witnesses:

RECORDED AT REQUEST OF
AMERICAN SELCO INC.
BOOK 89 PAGE 526

Locator:

AMERICAN SELCO INC.

80 DEC 1 8:38

By [Signature]
Agent for
American Selco Inc.

OFFICIAL RECORDS
EUREKA COUNTY, NEVADA
WILLIS A. DEPAOLI - RECORDER
STATE OF NEVADA FILE NO. 78022
COUNTY OF _____ FEE \$ 3.00

I hereby certify that the within instrument was filed and recorded at the request of: _____
FILE NO. _____
on _____
at _____
Docket _____ Page _____

Witness my hand and official seal the day and year aforesaid.

County Recorder
By _____
Deputy Recorder

STATE OF NEVADA
CERTIFICATE OF MINING LOCATION
LODE CLAIM ON PUBLIC DOMAIN

NOTICE IS HEREBY GIVEN that the Red No. 27 lode mining claim has been located by AMERICAN SELCO INC. a New York corporation, whose address is 90 West Grove Street, Suite 100, Reno, Nevada 89509. The general course of this claim is East/West. This claim is 1500 feet in length along the course of the claim, being 1490 feet from the point of discovery in a East direction to the East end line of this claim, and 10 feet in a West direction to the West end line of the claim. This claim is 600 feet in width, being 300 feet in width on each side of the center line of the claim.

This claim is located within the SW/SE/NW/NE Quarter of Section 27/34, Township 23 North, Range 49 East, Mount Diablo Base and Meridian, unknown Mining District, White Pine County, Nevada. The location monument of this claim is situated with reference to some natural object or permanent monument as follows: The number one corner of this claim is located approximately 517.5 feet S 71° 40' W from the located SE SE corner of Section 22, T23N, R49E, MDM

The corners of this claim are marked by 4"x4" posts or 4" trees with metal tags inscribed with the appropriate corner number as shown on the following sketch and the accompanying claim map.

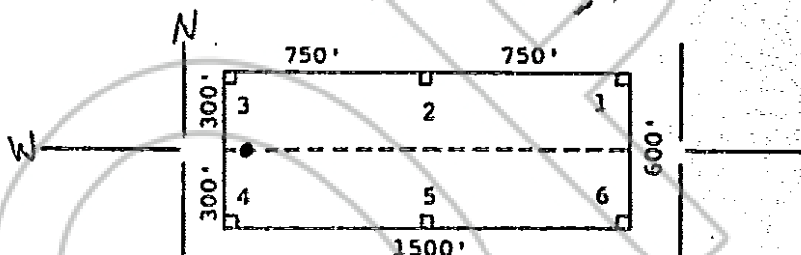

The location work consisted of making the maps as provided in NRS 517.040.

Dated and posted on the ground this 7 day of October, 1980

Witnesses:

RECORDED AT REQUEST OF
AMERICAN SELCO INC.
BOOK 89 PAGE 527

Locator:

AMERICAN SELCO INC.

80 DEC 1 10 39

By

Agent for
American Selco Inc.

STATE OF NEVADA

COUNTY OF _____

OFFICIAL RECORDS
EUREKA COUNTY, NEVADA
WILLIS A. DEPAULI, RECORDER
FILE NO. 78023
FEE \$ 3.00

I hereby certify that the within instrument was filed and recorded at the request of:

FILE NO. _____
on _____
at _____
Docket _____ Page _____

Witness my hand and official seal the day and year aforesaid.

County Recorder

By

Deputy Recorder

BOOK 89 PAGE 527

NOTICE IS HEREBY GIVEN that the Red No. 28 lode mining claim has been located by AMERICAN SELCO INC. a New York corporation, whose address is 90 West Grove Street, Suite 100, Reno, Nevada 89509. The general course of this claim is East/West. This claim is 1500 feet in length along the course of the claim, being 10 feet from the point of discovery in a East direction to the East end line of this claim, and 1490 feet in a West direction to the West end line of the claim. This claim is 600 feet in width, being 300 feet in width on each side of the center line of the claim.

This claim is located within the SW / NW Quarter of Section 27, 34, Township 23 North, Range 49 East, Mount Diablo Base and Meridian, unknown Mining District, White Pine County, Nevada. The location monument of this claim is situated with reference to some natural object or permanent monument as follows: The number one corner of this claim is located approximately 1,900 feet S45°50'W from the located SE SE corner of Section 22, T23N, R49E, MDM

The corners of this claim are marked by 4"x4" posts or 4" trees with metal tags inscribed with the appropriate corner number as shown on the following sketch and the accompanying claim map.

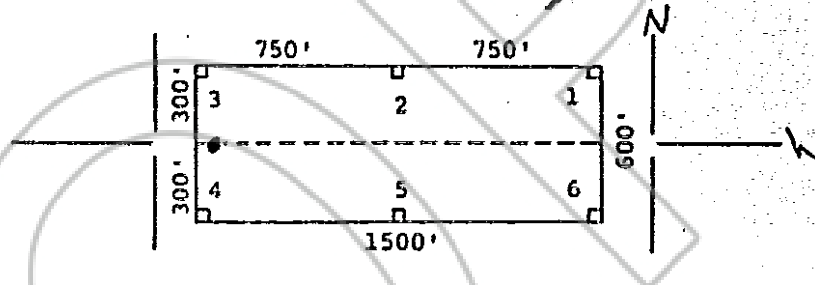

The location work consisted of making the maps as provided in NRS 517.040.

Dated and posted on the ground this 7 day of October, 1980

Witnesses: RECORDED AT REQUEST OF AMERICAN SELCO INC
BOOK 89 PAGE 528

Locator: AMERICAN SELCO INC.

CODEC 1 A8139

By [Signature]
Agent for
American Selco Inc.

OFFICIAL RECORDS
CLERK OF COUNTY, NEVADA
WILLIS A. DEPAOLI - RECORDER
STATE OF NEVADA FILE NO. 78024
FEE \$ 3.00) ss.
COUNTY OF _____)

I hereby certify that the within instrument was filed and recorded at the request of: _____
FILE NO. _____
on _____
at _____
Docket _____ Page _____

Witness my hand and official seal the day and year aforesaid.

County Recorder
By _____
Deputy Recorder
BOOK 89 PAGE 528

STATE OF NEVADA
CERTIFICATE OF MINING LOCATION
LODE CLAIM ON PUBLIC DOMAIN

NOTICE IS HEREBY GIVEN that the Red No. 29 lode mining claim has been located by AMERICAN SELCO INC. a New York corporation, whose address is 90 West Grove Street, Suite 100, Reno, Nevada 89509. The general course of this claim is East/West. This claim is 1500 feet in length along the course of the claim, being 1490 feet from the point of discovery in a East direction to the East end line of this claim, and 10 feet in a West direction to the West end line of the claim. This claim is 600 feet in width, being 300 feet in width on each side of the center line of the claim.

This claim is located within the all Quarter of Section 22, Township 23 North, Range 49 East, Mount Diablo Base and Meridian, unknown Mining District, White Pine County, Nevada. The location monument of this claim is situated with reference to some natural object or permanent monument as follows: The number one corner of this claim is located approximately 307.5' feet N 38° 15' W from the located SE SE corner of Section 22, T23N, R49E, MDM

The corners of this claim are marked by 4"x4" posts or 4" trees with metal tags inscribed with the appropriate corner number as shown on the following sketch and the accompanying claim map.

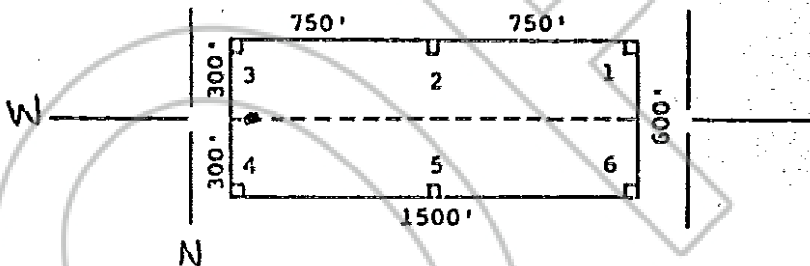

The location work consisted of making the maps as provided in NRS 517.040.

Dated and posted on the ground this 13 day of October, 1980.

Witnesses: RECORDED AT REQUEST OF AMERICAN SELCO INC. BOOK 89 PAGE 529

Locator: AMERICAN SELCO INC.

80 DEC 1 8:39

By [Signature]
Agent for
American Selco Inc.

OFFICIAL RECORDS
SURENA COUNTY, NEVADA
WILLIS A. DUFFALO, RECORDER
STATE OF NEVADA
FILE NO. 78025
FEE 3.00
COUNTY OF _____

I hereby certify that the within instrument was filed and recorded at the request of: _____
FILE NO. _____
on _____
at _____
Docket _____ Page _____

Witness my hand and official seal the day and year aforesaid.

County Recorder
By _____
Deputy Recorder

STATE OF NEVADA
CERTIFICATE OF MINING LOCATION
LODE CLAIM ON PUBLIC DOMAIN

NOTICE IS HEREBY GIVEN that the Red No. 30 lode mining claim has been located by AMERICAN SELCO INC. a New York corporation, whose address is 90 West Grove Street, Suite 100, Reno, Nevada 89509. The general course of this claim is East/West. This claim is 1500 feet in length along the course of the claim, being 1490 feet from the point of discovery in a East direction to the East end line of this claim, and 10 feet in a West direction to the West end line of the claim. This claim is 600 feet in width, being 300 feet in width on each side of the center line of the claim.

This claim is located within the SW & SE Quarter of Section 22, Township 23 North, Range 49 East, Mount Diablo Base and Meridian, unknown Mining District, White Pine County, Nevada. The location monument of this claim is situated with reference to some natural object or permanent monument as follows: The number one corner of this claim is located approximately 3075 feet N 38° 15' W from the located SE SE corner of Section 22, T23N, R49E, MDN

The corners of this claim are marked by 4"x4" posts or 4" trees with metal tags inscribed with the appropriate corner number as shown on the following sketch and the accompanying claim map.

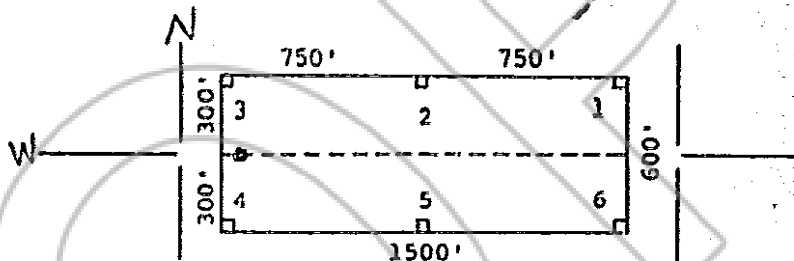

The location work consisted of making the maps as provided in NRS 517.040.

Dated and posted on the ground this 13 day of October, 1980.

Witnesses: RECORDED AT REQUEST OF AMERICAN SELCO INC. BOOK 89 PAGE 530

Locator: AMERICAN SELCO INC.
By [Signature]
Agent for American Selco Inc.

80 DEC 1 8:39

OFFICIAL RECORDS
CLERK OF COUNTY, NEVADA
WILLIS A. DEPAULIS, RECORDER
FILE NO. 78026
FEE \$ 3.00

STATE OF NEVADA)
COUNTY OF _____) ss.

I hereby certify that the within instrument was filed and recorded at the request of: _____
FILE NO. _____
on _____
at _____
Docket _____ Page _____

Witness my hand and official seal the day and year aforesaid.

County Recorder
By _____
Deputy Recorder

78027

STATE OF NEVADA
CERTIFICATE OF MINING LOCATION
LODE CLAIM ON PUBLIC DOMAIN

NOTICE IS HEREBY GIVEN that the Red No. 31 lode mining claim has been located by AMERICAN SELCO INC., a New York corporation, whose address is 90 West Grove Street, Suite 100, Reno, Nevada 89509. The general course of this claim is East/West. This claim is 1500 feet in length along the course of the claim, being 1490 feet from the point of discovery in a East direction to the East end line of this claim, and 10 feet in a West direction to the West end line of the claim. This claim is 600 feet in width, being 300 feet in width on each side of the center line of the claim.

This claim is located within the SW & SE Quarter of Section 22, Township 23 North, Range 49 East, Mount Diablo Base and Meridian, unknown Mining District, White Pine County, Nevada. The location monument of this claim is situated with reference to some natural object or permanent monument as follows: The number one corner of this claim is located approximately 2250 feet N57°35'W from the located SE SE corner of Section 22, T23N, R49E, MDN

The corners of this claim are marked by 4"x4" posts or 4" trees with metal tags inscribed with the appropriate corner number as shown on the following sketch and the accompanying claim map.

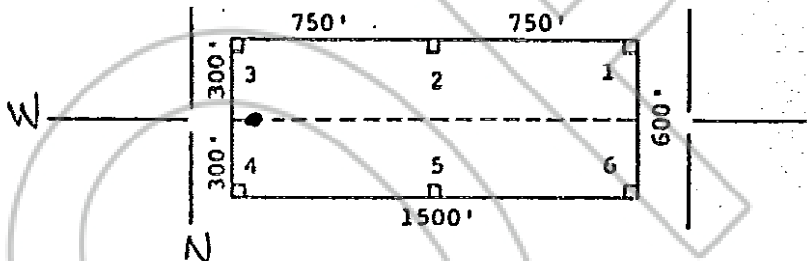

The location work consisted of making the maps as provided in NRS 517.040.

Dated and posted on the ground this 13 day of October, 1980.

Witnesses:

RECORDED AT REQUEST OF
AMERICAN SELCO INC.
BOOK 89 PAGE 531

Locator:

AMERICAN SELCO INC.

80 DEC 1 18:39

By [Signature]
Agent for
American Selco Inc.

STATE OF NEVADA
COUNTY OF _____

OFFICIAL RECORDS
WHITE PINE COUNTY, NEVADA
WILLIS A. DONALD, RECORDER
FILE NO. 78027
FEE \$ 3.00

I hereby certify that the within instrument was filed and recorded at the request of: _____
FILE NO. _____
on _____
at _____
Docket _____ page _____

Witness my hand and official seal the day and year aforesaid.

County Recorder

By _____
Deputy Recorder

BOOK 89 PAGE 531

STATE OF NEVADA
CERTIFICATE OF MINING LOCATION
LODE CLAIM ON PUBLIC DOMAIN

NOTICE IS HEREBY GIVEN that the Red No. 32 lode mining claim has been located by AMERICAN SELCO INC. a New York corporation, whose address is 90 West Grove Street, Suite 100, Reno, Nevada 89509. The general course of this claim is East/West. This claim is 1500 feet in length along the course of the claim, being 1490 feet from the point of discovery in a East direction to the East end line of this claim, and 10 feet in a West direction to the West end line of the claim. This claim is 600 feet in width, being 300 feet in width on each side of the center line of the claim.

This claim is located within the SE/SW Quarter of Section 22/23, Township 23 North, Range 49 East, Mount Diablo Base and Meridian, unknown Mining District, White Pine County, Nevada. The location monument of this claim is situated with reference to some natural object or permanent monument as follows: The number one corner of this claim is located approximately 1,450 feet N142°40'E from the located SE SE corner of Section 22, T23N, R49E, MDM

The corners of this claim are marked by 4"x4" posts or 4" trees with metal tags inscribed with the appropriate corner number as shown on the following sketch and the accompanying claim map.

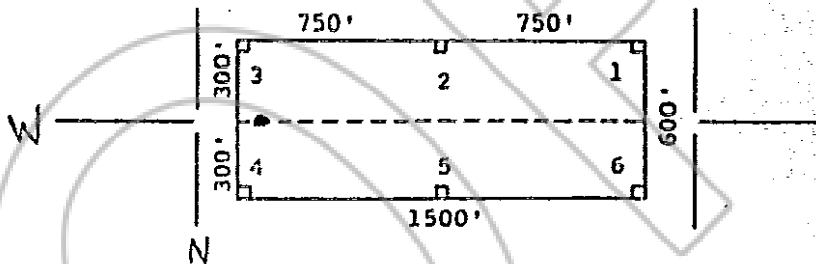

The location work consisted of making the maps as provided in NRS 517.040.

Dated and posted on the ground this 10 day of October, 1980

Witnesses: RECORDED AT REQUEST OF
AMERICAN SELCO INC
BOOK 89 PAGE 532

Locator:
AMERICAN SELCO INC.

80 DEC 1 8:39

By [Signature]
Agent for
American Selco Inc.

OFFICIAL RECORDS
EUREKA COUNTY, NEVADA
WILLIS A. DEPAUL RECORDER
STATE OF NEVADA FILE NO. 78028
FEE \$ 3.00 TSS.
COUNTY OF _____

I hereby certify that the within instrument was filed and recorded at the request of: _____
FILE NO. _____
on _____
at _____
Docket _____ Page _____

Witness my hand and official seal the day and year aforesaid.

County Recorder
By _____
Deputy Recorder
BOOK 89 PAGE 532

STATE OF NEVADA
CERTIFICATE OF MINING LOCATION
LODE CLAIM ON PUBLIC DOMAIN

NOTICE IS HEREBY GIVEN that the Red No. 33 lode mining claim has been located by AMERICAN SELCO INC. a New York corporation, whose address is 90 West Grove Street, Suite 100, Reno, Nevada 89509. The general course of this claim is East/West. This claim is 1500 feet in length along the course of the claim, being 1490 feet from the point of discovery in a East direction to the East end line of this claim, and 10 feet in a West direction to the West end line of the claim. This claim is 600 feet in width, being 300 feet in width on each side of the center line of the claim.

This claim is located within the SE/ SW Quarter of Section 22/23, Township 23 North, Range 49 East, Mount Diablo Base and Meridian, unknown Mining District, White Pine County, Nevada. The location monument of this claim is situated with reference to some natural object or permanent monument as follows: The number one corner of this claim is located approximately 1,650 feet N42°40'E from the located SE SE corner of Section 22, T23N, R49E, MDM

The corners of this claim are marked by 4"x4" posts or 4" trees with metal tags inscribed with the appropriate corner number as shown on the following sketch and the accompanying claim map.

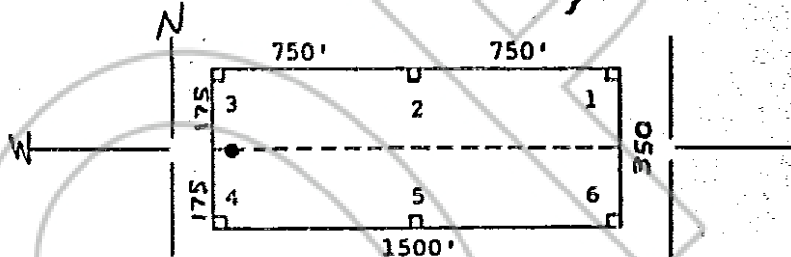

The location work consisted of making the maps as provided in NRS 517.040.

Dated and posted on the ground this 10 day of October, 1980

Witnesses: RECORDED AT REQUEST OF AMERICAN SELCO INC
BOOK 89 PAGE 533

Locator: AMERICAN SELCO INC.

80 DEC 1 11:38

By [Signature]
Agent for
American Selco Inc.

OFFICIAL RECORDS
EUREKA COUNTY, NEVADA
WILLIS A. DEPAOLI - RECORDER
FILE NO. 78029
STATE OF NEVADA)
COUNTY OF _____) ss.

I hereby certify that the within instrument was filed and recorded at the request of: _____
FILE NO. _____
on _____
at _____
Docket _____ Page _____

Witness my hand and official seal the day and year aforesaid.
County Recorder _____
By _____
Deputy Recorder

STATE OF NEVADA
CERTIFICATE OF MINING LOCATION
LODE CLAIM ON PUBLIC DOMAIN

NOTICE IS HEREBY GIVEN that the Red No. 34 lode mining claim has been located by AMERICAN SELCO INC., a New York corporation, whose address is 90 West Grove Street, Suite 100, Reno, Nevada 89509. The general course of this claim is East/West. This claim is 1500 feet in length along the course of the claim, being 1490 feet from the point of discovery in a East direction to the East end line of this claim, and 10 feet in a West direction to the West end line of the claim. This claim is 600 feet in width, being 300 feet in width on each side of the center line of the claim.

This claim is located within the SE/SW Quarter of Section 22/23, Township 23 North, Range 49 East, Mount Diablo Base and Meridian, unknown Mining District, White Pine County, Nevada. The location monument of this claim is situated with reference to some natural object or permanent monument as follows: The number one corner of this claim is located approximately 1,125 feet due East from the located SE SE corner of Section 22, T23N, R49E, MDM

The corners of this claim are marked by 4"x4" posts or 4" trees with metal tags inscribed with the appropriate corner number as shown on the following sketch and the accompanying claim map.

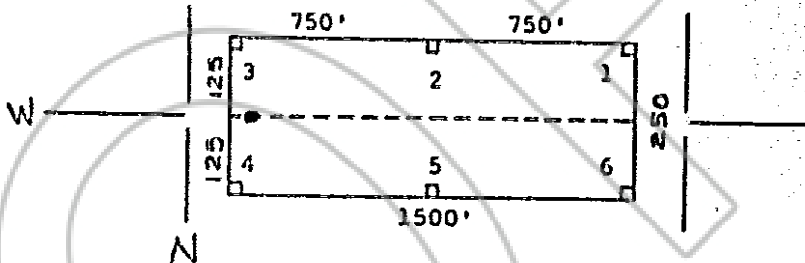

The location work consisted of making the maps as provided in NRS 517.040.

Dated and posted on the ground this 10 day of October, 1980

Witnesses: RECORDED AT REQUEST OF AMERICAN SELCO INC Locator:

BOOK 81 PAGE 534

AMERICAN SELCO INC.

00 DEC 1 1980

By [Signature]
Agent for
American Selco Inc.

OFFICIAL RECORDS
ESNERA COUNTY, NEVADA
WILLIS A. DEPAOLI - RECORDER
FILE NO. 78030
FEE \$ 7.00

STATE OF NEVADA
COUNTY OF _____) ss.

I hereby certify that the within instrument was filed and recorded at the request of: _____
FILE NO. _____
on _____
at _____
Docket _____ page _____

Witness my hand and official seal the day and year aforesaid.

County Recorder
By _____
Deputy Recorder

STATE OF NEVADA
CERTIFICATE OF MINING LOCATION
LODE CLAIM ON PUBLIC DOMAIN

NOTICE IS HEREBY GIVEN that the Red No. 35 lode mining claim has been located by AMERICAN SELCO INC. a New York corporation, whose address is 90 West Grove Street, Suite 100, Reno, Nevada 89509. The general course of this claim is East/West. This claim is 1500 feet in length along the course of the claim, being 1490 feet from the point of discovery in a East direction to the East end line of this claim, and 10 feet in a West direction to the West end line of the claim. This claim is 600 feet in width, being 300 feet in width on each side of the center line of the claim.

This claim is located within the NE/NW Quarter of Section 27/26, Township 23 North, Range 49 East, Mount Diablo Base and Meridian, unknown Mining District, White Pine County, Nevada. The location monument of this claim is situated with reference to some natural object or permanent monument as follows: The number one corner of this claim is located approximately 1,125 feet due East from the located SE SE corner of Section 22, T23N, R49E, MDM

The corners of this claim are marked by 4"x4" posts or 4" trees with metal tags inscribed with the appropriate corner number as shown on the following sketch and the accompanying claim map.

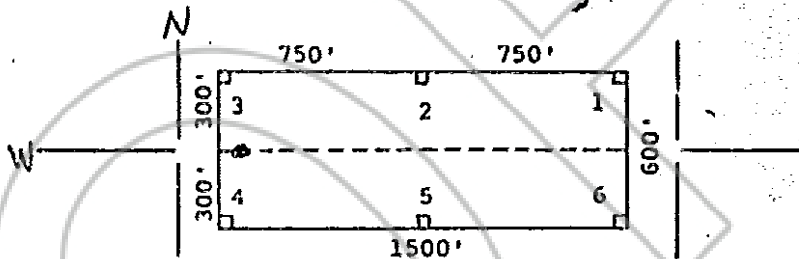

The location work consisted of making the maps as provided in NRS 517.040.

Dated and posted on the ground this 10 day of October, 1980.

Witnesses: RECORDED AT REQUEST OF AMERICAN SELCO INC.
BOOK 89, PAGE 535

Locator: AMERICAN SELCO INC.

80 DEC 7 8:39

By [Signature]
Agent for
American Selco Inc.

OFFICIAL RECORDS
FOURKA COUNTY, NEVADA
WILLIS A. DEVLIN - RECORDER
STATE OF NEVADA FILE NO. 78031
COUNTY OF FEE \$ 3.00

I hereby certify that the within instrument was filed and recorded at the request of: _____
FILE NO. _____
on _____
at _____
Docket _____ Page _____

Witness my hand and official seal the day and year aforesaid.

County Recorder
By _____
Deputy Recorder

STATE OF NEVADA
CERTIFICATE OF MINING LOCATION
LODE CLAIM ON PUBLIC DOMAIN

NOTICE IS HEREBY GIVEN that the Red No. 36 lode mining claim has been located by AMERICAN SELCO INC., a New York corporation, whose address is 90 West Grove Street, Suite 100, Reno, Nevada 89509. The general course of this claim is East/West. This claim is 1500 feet in length along the course of the claim, being 1490 feet from the point of discovery in a East direction to the East end line of this claim, and 10 feet in a West direction to the West end line of the claim. This claim is 600 feet in width, being 300 feet in width on each side of the center line of the claim.

This claim is located within the NE/NW Quarter of Section 27/26, Township 23 North, Range 49 East, Mount Diablo Base and Meridian, unknown Mining District, White Pine County, Nevada. The location monument of this claim is situated with reference to some natural object or permanent monument as follows: The number one corner of this claim is located approximately 1,675 feet S43°E from the located SE SE corner of Section 22, T23N, R49E, MDM

The corners of this claim are marked by 4"x4" posts or 4" trees with metal tags inscribed with the appropriate corner number as shown on the following sketch and the accompanying claim map.

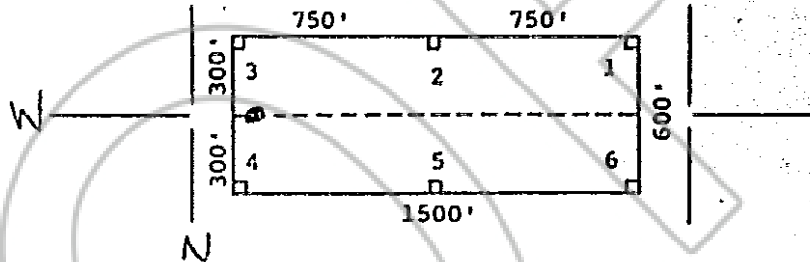

The location work consisted of making the maps as provided in NRS 517.040.

Dated and posted on the ground this 10 day of October, 1980

Witnesses:

RECORDED AT REQUEST OF
AMERICAN SELCO INC
BOOK 89 PAGE 536

Locator:

AMERICAN SELCO INC.

80 DEC 1 10 39

By [Signature]
Agent for
American Selco Inc.

OFFICIAL RECORDS
ELREKA COUNTY, NEVADA
WILLIS A. DEPAULY, RECORDER
FILE NO. 80312
FEE \$ 3.00

STATE OF NEVADA

COUNTY OF _____

I hereby certify that the within instrument was filed and recorded at the request of: _____

FILE NO. _____
on _____
at _____
Docket _____ Page _____

Witness my hand and official seal the day and year aforesaid.

County Recorder

By _____
Deputy Recorder

BOOK 89 PAGE 536

STATE OF NEVADA
78033 CERTIFICATE OF MINING LOCATION
 LODE CLAIM ON PUBLIC DOMAIN

NOTICE IS HEREBY GIVEN that the Red No. 37 lode mining claim has been located by AMERICAN SELCO INC. a New York corporation, whose address is 90 West Grove Street, Suite 100, Reno, Nevada 89509. The general course of this claim is East/West. This claim is 1500 feet in length along the course of the claim, being 1490 feet from the point of discovery in a East direction to the East end line of this claim, and 10 feet in a West direction to the West end line of the claim. This claim is 600 feet in width, being 300 feet in width on each side of the center line of the claim.

This claim is located within the NE/NW Quarter of Section 27/26, Township 23 North, Range 49 East, Mount Diablo Base and Meridian, unknown Mining District, White Pine County, Nevada. The location monument of this claim is situated with reference to some natural object or permanent monument as follows: The number one corner of this claim is located approximately 1,675 feet S43°E from the located SE SE corner of Section 22, T23N, R49E, MDM

The corners of this claim are marked by 4"x4" posts or 4" trees with metal tags inscribed with the appropriate corner number as shown on the following sketch and the accompanying claim map.

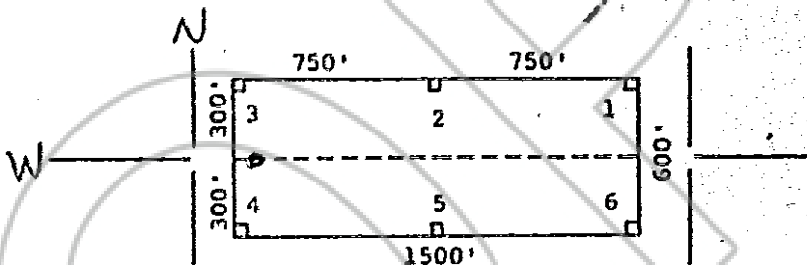

The location work consisted of making the maps as provided in NRS 517.040.

Dated and posted on the ground this 10 day of October, 1980

Witnesses: RECORDED AT REQUEST OF AMERICAN SELCO INC. BOOK 89 PAGE 537

Locator: AMERICAN SELCO INC.

80 DEC 1 8:39

By [Signature]
 Agent for
American Selco Inc.

STATE OF NEVADA
 COUNTY OF EUREKA
 OFFICIAL RECORDS
 EUREKA COUNTY, NEVADA
 WILLIS A. DEPAOLI, RECORDER
 FILE NO. 78033
 FEE \$ 2.00

I hereby certify that the within instrument was filed and recorded at the request of: _____
 FILE NO. _____
 on _____
 at _____
 Docket _____ Page _____

Witness my hand and official seal the day and year aforesaid.

County Recorder

By _____
 Deputy Recorder

BOOK 89 PAGE 537

STATE OF NEVADA
CERTIFICATE OF MINING LOCATION
LODE CLAIM ON PUBLIC DOMAIN

NOTICE IS HEREBY GIVEN that the Red No. 38 lode mining claim has been located by AMERICAN SELCO INC. a New York corporation, whose address is 90 West Grove Street, Suite 100, Reno, Nevada 89509. The general course of this claim is East/West. This claim is 1500 feet in length along the course of the claim, being 1490 feet from the point of discovery in a East direction to the East end line of this claim, and 10 feet in a West direction to the West end line of the claim. This claim is 600 feet in width, being 300 feet in width on each side of the center line of the claim.

This claim is located within the NE/NW Quarter of Section 27/26, Township 23 North, Range 49 East, Mount Diablo Base and Meridian, unknown Mining District, White Pine County, Nevada. The location monument of this claim is situated with reference to some natural object or permanent monument as follows: The number one corner of this claim is located approximately 2,450 feet S 74° 40' E from the located SE SE corner of Section 22, T23N, R49E, MDM

The corners of this claim are marked by 4"x4" posts or 4" trees with metal tags inscribed with the appropriate corner number as shown on the following sketch and the accompanying claim map.

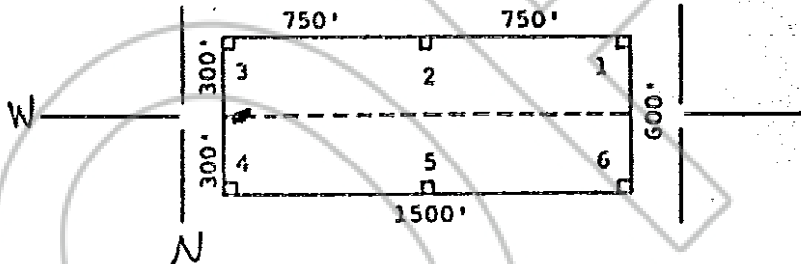

The location work consisted of making the maps as provided in NRS 517.040.

Dated and posted on the ground this 10 day of October, 1980

Witnesses:

ATTESTED AT REQUEST OF
AMERICAN SELCO INC.
CORP. 89-111-538

Locator:

AMERICAN SELCO INC.

60 DEC 1 1980 8:39

By [Signature]
Agent for
American Selco Inc.

STATE OF NEVADA
OFFICIAL RECORDS
WHITE PINE COUNTY, NEVADA
ALLIS A. DEPAOLI - RECORDER
78034
COUNTY OF WHITE PINE FILE # 3.00

I hereby certify that the within instrument was filed and recorded at the request of: _____
FILE NO. _____
on _____
at _____
Docket _____ Page _____

Witness my hand and official seal the day and year aforesaid.

County Recorder

By _____
Deputy Recorder

STATE OF NEVADA
CERTIFICATE OF MINING LOCATION
LODE CLAIM ON PUBLIC DOMAIN

NOTICE IS HEREBY GIVEN that the Red No. 39 lode mining claim has been located by AMERICAN SELCO INC. a New York corporation, whose address is 90 West Grove Street, Suite 100, Reno, Nevada 89509. The general course of this claim is East/West. This claim is 1500 feet in length along the course of the claim, being 10 feet from the point of discovery in a East direction to the East end line of this claim, and 1490 feet in a West direction to the West end line of the claim. This claim is 600 feet in width, being 300 feet in width on each side of the center line of the claim.

This claim is located within the NE & SE Quarter of Section 27, Township 23 North, Range 49 East, Mount Diablo Base and Meridian, unknown Mining District, White Pine County, Nevada. The location monument of this claim is situated with reference to some natural object or permanent monument as follows: The number one corner of this claim is located approximately 3075 feet S 32° 30' W from the located SE SE corner of Section 22, T23N, R49E, MDM

The corners of this claim are marked by 4"x4" posts or 4" trees with metal tags inscribed with the appropriate corner number as shown on the following sketch and the accompanying claim map.

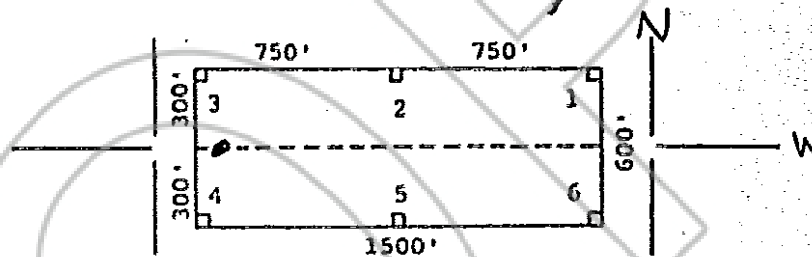

The location work consisted of making the maps as provided in NRS 517.040.

Dated and posted on the ground this 10 day of October, 1980:

Witnesses: RECORDED AT REQUEST OF AMERICAN SELCO INC.
BOOK 89 PAGE 539

Locator: AMERICAN SELCO INC.

80 DEC 1 8:39

By [Signature]
Agent for American Selco Inc.

OFFICIAL RECORDS
EGRENA COUNTY, NEVADA
WILLIS A. DI PAOLI - RECORDER
FILE NO. 78035
FEE \$ 3.00

STATE OF NEVADA
COUNTY OF _____

I hereby certify that the within instrument was filed and recorded at the request of: _____
FILE NO. _____
on _____
at _____
Docket _____ Page _____

Witness my hand and official seal the day and year aforesaid.

County Recorder

By _____
Deputy Recorder

BOOK 89 PAGE 539

STATE OF NEVADA
CERTIFICATE OF MINING LOCATION
LODE CLAIM ON PUBLIC DOMAIN

NOTICE IS HEREBY GIVEN that the Red No. 40 lode mining claim has been located by AMERICAN SELCO INC., a New York corporation, whose address is 90 West Grove Street, Suite 100, Reno, Nevada 89509. The general course of this claim is East/West. This claim is 1500 feet in length along the course of the claim, being 1490 feet from the point of discovery in a East direction to the East end line of this claim, and 10 feet in a West direction to the West end line of the claim. This claim is 600 feet in width, being 300 feet in width on each side of the center line of the claim.

This claim is located within the NE 1/4 SE 1/4 SW 1/4 quarter of Section 27/26, Township 23 North, Range 49 East, Mount Diablo Base and Meridian, unknown Mining District, White Pine County, Nevada. The location monument of this claim is situated with reference to some natural object or permanent monument as follows: The number one corner of this claim is located approximately 2650 feet S 24° 40' E from the located SE SE corner of Section 22, T23N, R49E, MDM

The corners of this claim are marked by 4"x4" posts or 4" trees with metal tags inscribed with the appropriate corner number as shown on the following sketch and the accompanying claim map.

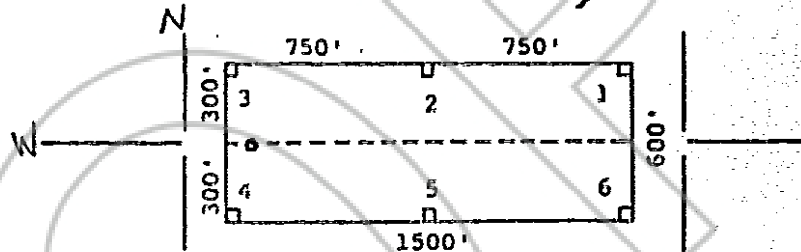

The location work consisted of making the maps as provided in NRS 517.040.

Dated and posted on the ground this 10 day of October, 1980

Witnesses: RECORDED AT REQUEST OF AMERICAN SELCO INC. BOOK 89 PAGE 540

Locator: AMERICAN SELCO INC.

80 DEC 1 8:39

By [Signature]
Agent for
American Selco Inc.

OFFICIAL RECORDS
EUREKA COUNTY, NEVADA
WILLIS A. DEPAOLI-RECORDER
STATE OF NEVADA FILE NO. 78036
COUNTY OF _____ FEE \$ 3.00

I hereby certify that the within instrument was filed and recorded at the request of: _____
FILE NO. _____
on _____
at _____
Docket _____ page _____

Witness my hand and official seal the day and year aforesaid.

County Recorder
By _____
Deputy Recorder
BOOK 89 PAGE 540

STATE OF NEVADA
CERTIFICATE OF MINING LOCATION
LODE CLAIM ON PUBLIC DOMAIN

NOTICE IS HEREBY GIVEN that the Red No. 41 lode mining claim has been located by AMERICAN SELCO INC., a New York corporation, whose address is 90 West Grove Street, Suite 100, Reno, Nevada 89509. The general course of this claim is East/West. This claim is 1500 feet in length along the course of the claim, being 10 feet from the point of discovery in a East direction to the East end line of this claim, and 1490 feet in a West direction to the West end line of the claim. This claim is 600 feet in width, being 300 feet in width on each side of the center line of the claim.

This claim is located within the SE Quarter of Section 27, Township 23 North, Range 49 East, Mount Diablo Base and Meridian, unknown Mining District, White Pine County, Nevada. The location monument of this claim is situated with reference to some natural object or permanent monument as follows: The number one corner of this claim is located approximately 4,100 feet S 27°40'W from the located SE SE corner of Section 22, T23N, R49E, MDM

The corners of this claim are marked by 4"x4" posts or 4" trees with metal tags inscribed with the appropriate corner number as shown on the following sketch and the accompanying claim map.

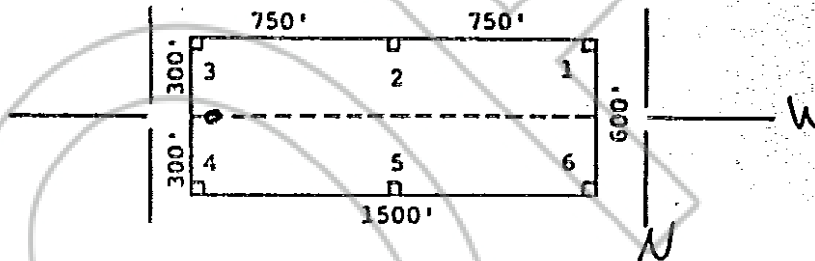

The location work consisted of making the maps as provided in NRS 517.040.

Dated and posted on the ground this 10 day of October, 1980

Witnesses:

RECORDED AT REQUEST OF
AMERICAN SELCO INC.
BOOK 89 PAGE 541

Locator:

AMERICAN SELCO INC.

RECORDED 11 18:39

By

[Signature]
Agent for
American Selco Inc.

OFFICIAL RECORDS
EGRETT COUNTY, NEVADA
WILLIS A. DEPAOLI - RECORDER
STATE OF NEVADA
FILE NO. 78037
COUNTY OF _____
FEE'S 3.00

I hereby certify that the within instrument was filed and recorded at the request of: _____
FILE NO. _____
on _____
at _____
Docket _____ Page _____

Witness my hand and official seal the day and year aforesaid.

County Recorder

By

Deputy Recorder

BOOK 89 PAGE 541

STATE OF NEVADA
CERTIFICATE OF MINING LOCATION
LODE CLAIM ON PUBLIC DOMAIN

NOTICE IS HEREBY GIVEN that the Red No. 42 lode mining claim has been located by AMERICAN SELCO INC a New York corporation, whose address is 90 West Grove Street, Suite 100, Reno, Nevada 89509. The general course of this claim is East/West. This claim is 1500 feet in length along the course of the claim, being 1490 feet from the point of discovery in a East direction to the East end line of this claim, and 10 feet in a West direction to the West end line of the claim. This claim is 600 feet in width, being 300 feet in width on each side of the center line of the claim.

This claim is located within the SE/SW Quarter of Section 27/26, Township 23 North, Range 49 East, Mount Diablo Base and Meridian, unknown Mining District, White Pine County, Nevada. The location monument of this claim is situated with reference to some natural object or permanent monument as follows: The number one corner of this claim is located approximately 3,775 feet S17°15'E from the located SE SE corner of Section 22, T23N, R49E, MDM

The corners of this claim are marked by 4"x4" posts or 4" trees with metal tags inscribed with the appropriate corner number as shown on the following sketch and the accompanying claim map.

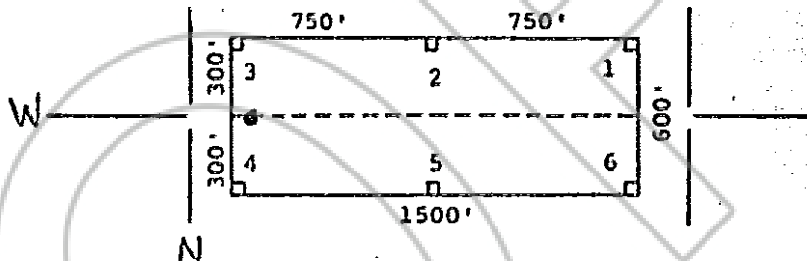

The location work consisted of making the maps as provided in NRS 517.040.

Dated and posted on the ground this 10 day of October, 1980

Witnesses:

RECORDED AT REQUEST OF
AMERICAN SELCO INC
BOOK 89 PAGE 542

Locator:

AMERICAN SELCO INC.

NOV 11 1980 8:38

By [Signature]
Agent for
American Selco Inc.

STATE OF NEVADA OFFICIAL RECORDS
ELIEN A COUNTY, NEVADA
WILLIS A. GUYER, RECORDER
FILE NO. 78038
FEE \$ 3.00
COUNTY OF _____)

I hereby certify that the within instrument was filed and recorded at the request of:
FILE NO. _____
on _____
at _____
Docket _____ Page _____

Witness my hand and official seal the day and year aforesaid.

County Recorder
By _____
Deputy Recorder

STATE OF NEVADA
CERTIFICATE OF MINING LOCATION
LODE CLAIM ON PUBLIC DOMAIN

NOTICE IS HEREBY GIVEN that the Red No. 43 lode mining claim has been located by AMERICAN SELCO INC. a New York corporation, whose address is 90 West Grove Street, Suite 100, Reno, Nevada 89509. The general course of this claim is East/West. This claim is 1500 feet in length along the course of the claim, being 10 feet from the point of discovery in a East direction to the East end line of this claim, and 1490 feet in a West direction to the West end line of the claim. This claim is 600 feet in width, being 300 feet in width on each side of the center line of the claim.

This claim is located within the SE Quarter of Section 27, Township 23 North, Range 49 East, Mount Diablo Base and Meridian, unknown Mining District, White Pine County, Nevada. The location monument of this claim is situated with reference to some natural object or permanent monument as follows: The number one corner of this claim is located approximately 4,100 feet S 27° 40' W from the located SE SE corner of Section 22, T23N, R49E, MDM

The corners of this claim are marked by 4"x4" posts or 4" trees with metal tags inscribed with the appropriate corner number as shown on the following sketch and the accompanying claim map.

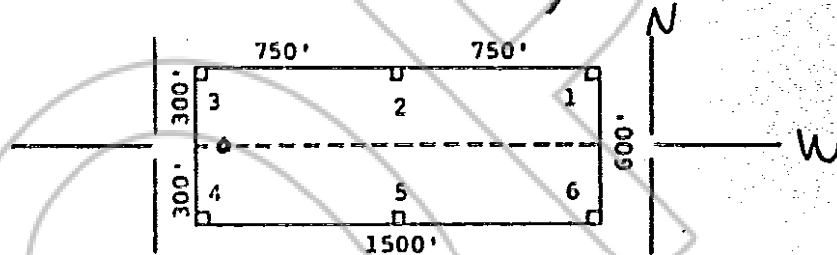

The location work consisted of making the maps as provided in NRS 517.040.

Dated and posted on the ground this 10 day of October, 1980:

Witnesses RECORDED AT REQUEST OF
AMERICAN SELCO INC.
BOOK 89 PAGE 543

Locator:
AMERICAN SELCO INC.
By [Signature]
Agent for
American Selco Inc.

80 DEC 1 10:39

OFFICIAL RECORDS
EUREKA COUNTY, NEVADA
WILLIS A. DELPADO, RECORDER
STATE OF NEVADA)
) FILE NO. 78039
) FEE \$ 2.00) ss.
COUNTY OF _____)

I hereby certify that the within instrument was filed and recorded at the request of: _____
FILE NO. _____
on _____
at _____
Docket _____ Page _____

Witness my hand and official seal the day and year aforesaid.

County Recorder
By _____
Deputy Recorder

STATE OF NEVADA
CERTIFICATE OF MINING LOCATION
LODE CLAIM ON PUBLIC DOMAIN

NOTICE IS HEREBY GIVEN that the Red No. 44 lode mining claim has been located by AMERICAN SELCO INC., a New York corporation, whose address is 90 West Grove Street, Suite 100, Reno, Nevada 89509. The general course of this claim is East/West. This claim is 1500 feet in length along the course of the claim, being 1490 feet from the point of discovery in a East direction to the East end line of this claim, and 10 feet in a West direction to the West end line of the claim. This claim is 600 feet in width, being 300 feet in width on each side of the center line of the claim.

This claim is located within the SE/SW Quarter of Section 27/26, Township 23 North, Range 49 East, Mount Diablo Base and Meridian, unknown Mining District, White Pine County, Nevada. The location monument of this claim is situated with reference to some natural object or permanent monument as follows: The number one corner of this claim is located approximately 3,775 feet S17°15'E from the located SE SE corner of Section 22, T23N, R49E, MDM

The corners of this claim are marked by 4"x4" posts or 4" trees with metal tags inscribed with the appropriate corner number as shown on the following sketch and the accompanying claim map.

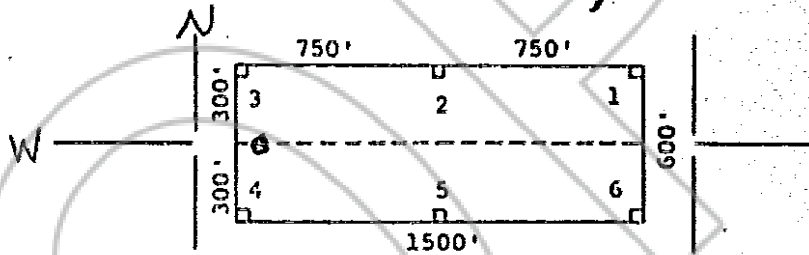

The location work consisted of making the maps as provided in NRS 517.040.

Dated and posted on the ground this 10 day of October, 1980.

Witnesses: RECORDED AT REQUEST OF AMERICAN SELCO INC. BOOK 89 PAGE 544

Locator: AMERICAN SELCO INC.
By [Signature]
Agent for American Selco Inc.

CODEC I AB 89

OFFICIAL RECORDS
EUREKA COUNTY, NEVADA
WILLIS A. DEPAOLI, RECORDER
STATE OF NEVADA FILE NO. 78040
COUNTY OF _____ FEES 3.00 1985.

I hereby certify that the within instrument was filed and recorded at the request of: _____
FILE NO. _____
on _____
at _____
Docket _____ Page _____

Witness my hand and official seal the day and year aforesaid.

County Recorder
By _____
Deputy Recorder

STATE OF NEVADA
CERTIFICATE OF MINING LOCATION
LODE CLAIM ON PUBLIC DOMAIN

NOTICE IS HEREBY GIVEN that the Red No. 45 lode mining claim has been located by AMERICAN SELCO INC., a New York corporation, whose address is 90 West Grove Street, Suite 100, Reno, Nevada 89509. The general course of this claim is East/West. This claim is 1500 feet in length along the course of the claim, being 10 feet from the point of discovery in a East direction to the East end line of this claim, and 1490 feet in a West direction to the West end line of the claim. This claim is 600 feet in width, being 300 feet in width on each side of the center line of the claim.

This claim is located within the SE Quarter of Section 27, Township 23 North, Range 49 East, Mount Diablo Base and Meridian, unknown Mining District, White Pine County, Nevada. The location monument of this claim is situated with reference to some natural object or permanent monument as follows: The number one corner of this claim is located approximately 5175 feet S 21°40' W from the located SE SE corner of Section 22, T23N, R49E, MDM

The corners of this claim are marked by 4"x4" posts or 4" trees with metal tags inscribed with the appropriate corner number as shown on the following sketch and the accompanying claim map.

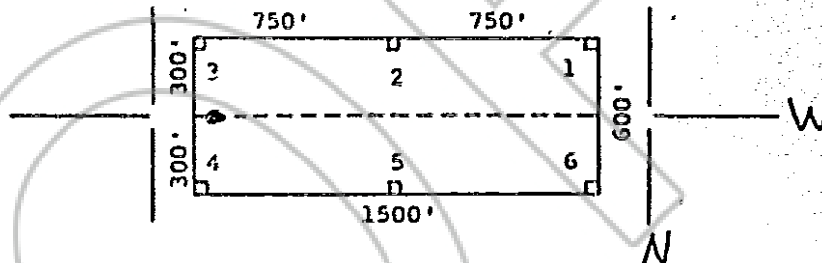

The location work consisted of making the maps as provided in NRS 517.040.

Dated and posted on the ground this 10 day of October, 1980

Witnesses: RECORDED AT REQUEST OF AMERICAN SELCO INC
BOOK 89 PAGE 543

Locator: AMERICAN SELCO INC.
By [Signature]
Agent for American Selco Inc.

80 DEC 1 8 30

OFFICIAL RECORDS
EDUCVA COUNTY, NEVADA
WILLIS A. DEPAOLI, RECORDER
FILE NO. 78041
FEE \$ 3.00

STATE OF NEVADA)
COUNTY OF _____) ss.

I hereby certify that the within instrument was filed and recorded at the request of: _____
FILE NO. _____
on _____
at _____
Docket _____ Page _____

Witness my hand and official seal the day and year aforesaid.

County Recorder
By _____
Deputy Recorder

STATE OF NEVADA
CERTIFICATE OF MINING LOCATION
LODE CLAIM ON PUBLIC DOMAIN

NOTICE IS HEREBY GIVEN that the Red No. 46 lode mining claim has been located by AMERICAN SELCO INC., a New York corporation, whose address is 90 West Grove Street, Suite 100, Reno, Nevada 89509. The general course of this claim is East/West. This claim is 1500 feet in length along the course of the claim, being 1490 feet from the point of discovery in a East direction to the East end line of this claim, and 10 feet in a West direction to the West end line of the claim. This claim is 600 feet in width, being 300 feet in width on each side of the center line of the claim.

This claim is located within the SE/SW Quarter of Section 27/26, Township 23 North, Range 49 East, Mount Diablo Base and Meridian, unknown Mining District, White Pine County, Nevada. The location monument of this claim is situated with reference to some natural object or permanent monument as follows: The number one corner of this claim is located approximately 4,950 feet S 13° E from the located SE SE corner of Section 22, T23N, R49E, MDM

The corners of this claim are marked by 4"x4" posts or 4" trees with metal tags inscribed with the appropriate corner number as shown on the following sketch and the accompanying claim map.

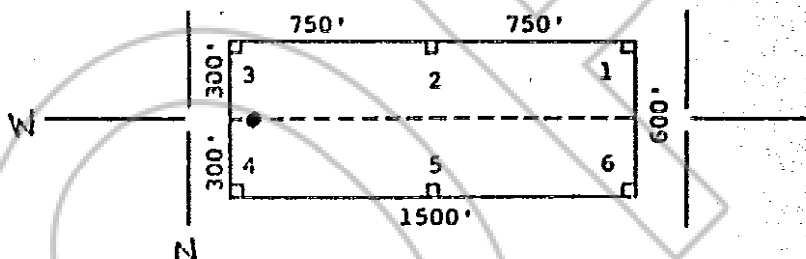

The location work consisted of making the maps as provided in NRS 517.040.

Dated and posted on the ground this 10 day of October, 1980

Witnesses: AMERICAN SELCO INC Locator:
BOOK 89 PAGE 546

AMERICAN SELCO INC.

NOV 1 1980 8:39

By [Signature]
Agent for
American Selco Inc.

OFFICIAL RECORDS
EUREKA COUNTY, NEVADA
WILLIS A. DEPAUL RECORDER
FILE NO. 78042

STATE OF NEVADA

FEE \$ 3.00

COUNTY OF _____) ss.

I hereby certify that the within instrument was filed and recorded at the request of: _____

FILE NO. _____
on _____
at _____
Docket _____ Page _____

Witness my hand and official seal the day and year aforesaid.

County Recorder

By _____
Deputy Recorder

STATE OF NEVADA
CERTIFICATE OF MINING LOCATION
LODE CLAIM ON PUBLIC DOMAIN

NOTICE IS HEREBY GIVEN that the Red No. 47 lode mining claim has been located by AMERICAN SELCO INC. a New York corporation, whose address is 90 West Grove Street, Suite 100, Reno, Nevada 89509. The general course of this claim is East/West. This claim is 1500 feet in length along the course of the claim, being 10 feet from the point of discovery in a East direction to the East end line of this claim, and 1490 feet in a West direction to the West end line of the claim. This claim is 600 feet in width, being 300 feet in width on each side of the center line of the claim.

This claim is located within the SE/NE Quarter of Section 27/34, Township 23 North, Range 49 East, Mount Diablo Base and Meridian, unknown Mining District, White Pine County, Nevada. The location monument of this claim is situated with reference to some natural object or permanent monument as follows: The number one corner of this claim is located approximately 5.175 feet S 21° 40' W from the located SE SE corner of Section 22, T23N, R49E, MDM

The corners of this claim are marked by 4"x4" posts or 4" trees with metal tags inscribed with the appropriate corner number as shown on the following sketch and the accompanying claim map.

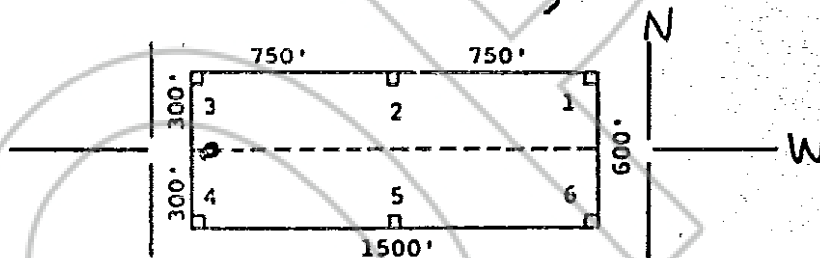

The location work consisted of making the maps as provided in NRS 517.040.

Dated and posted on the ground this 10 day of October, 1980

Witnesses: AMERICAN SELCO INC
BOOK 87 PAGE 547

Locator:

AMERICAN SELCO INC.

By [Signature]
Agent for
American Selco Inc.

80 DEC 1 8 38

OFFICIAL RECORDS
EUREKA COUNTY, NEVADA
WILLIS A. DEPOSEL, RECORDER
FILE NO. 78043
FEE \$ 3.00

STATE OF NEVADA)
COUNTY OF _____) ss.

I hereby certify that the within instrument was filed and recorded at the request of: _____
FILE NO. _____
on _____
at _____
Docket _____ Page _____

Witness my hand and official seal the day and year aforesaid.

County Recorder

By _____
Deputy Recorder

BOOK 89 PAGE 547

STATE OF NEVADA
CERTIFICATE OF MINING LOCATION
LODE CLAIM ON PUBLIC DOMAIN

NOTICE IS HEREBY GIVEN that the Red No. 48 lode mining claim has been located by AMERICAN SELCO INC., a New York corporation, whose address is 90 West Grove Street, Suite 100, Reno, Nevada 89509. The general course of this claim is East/West. This claim is 1500 feet in length along the course of the claim, being 1490 feet from the point of discovery in a East direction to the East end line of this claim, and 10 feet in a West direction to the West end line of the claim. This claim is 600 feet in width, being 300 feet in width on each side of the center line of the claim.

This claim is located within the SE/SW/NE/NW Quarter of Section 27/26/34/35 Township 23 North, Range 49 East, Mount Diablo Base and Meridian, unknown Mining District, White Pine County, Nevada. The location monument of this claim is situated with reference to some natural object or permanent monument as follows: The number one corner of this claim is located approximately 4,950 feet S13°E from the located SE SE corner of Section 22, T23N, R49E, MDM

The corners of this claim are marked by 4"x4" posts or 4" trees with metal tags inscribed with the appropriate corner number as shown on the following sketch and the accompanying claim map.

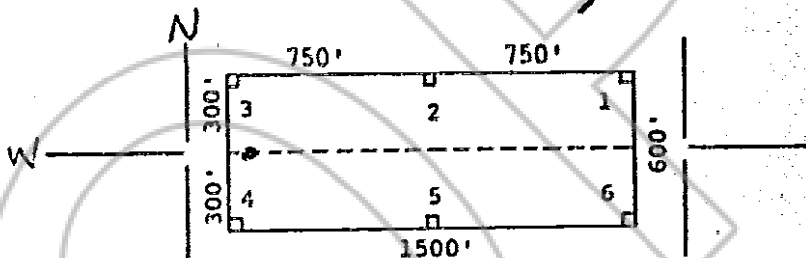

The location work consisted of making the maps as provided in NRS 517.040.

Dated and posted on the ground this 10 day of October, 1980

Witnesses:

RECORDED AT REQUEST OF
AMERICAN SELCO INC.
BOOK 89 PAGE 548

Locator:

AMERICAN SELCO INC.

NOV 11 1980 11:39

By [Signature]
Agent for
American Selco Inc.

STATE OF NEVADA

COUNTY OF _____

OFFICIAL RECORDS
LEWIS COUNTY, NEVADA
WILLIS A. DUNN, RECORDER
78044
FEE \$ 3.00

I hereby certify that the within instrument was filed and recorded at the request of: _____

FILE NO. _____
on _____
at _____
Docket _____ Page _____

Witness my hand and official seal the day and year aforesaid.

County Recorder

By _____
Deputy Recorder

BOOK 89 PAGE 548