

STATE OF NEVADA
CERTIFICATE OF MINING LOCATION
LODE CLAIM ON PUBLIC DOMAIN

NOTICE IS HEREBY GIVEN that the Red No. 7 lode mining claim has been located by AMERICAN SELCO INC., a New York corporation, whose address is 90 West Grove Street, Suite 100, Reno, Nevada 89509. The general course of this claim is East/West. This claim is 1500 feet in length along the course of the claim, being 10 feet from the point of discovery in a East direction to the East end line of this claim, and 1490 feet in a West direction to the West end line of the claim. This claim is 600 feet in width, being 300 feet in width on each side of the center line of the claim.

This claim is located within the SW Quarter of Section 22, Township 23 North, Range 49 East, Mount Diablo Base and Meridian, unknown Mining District, White Pine County, Nevada. The location monument of this claim is situated with reference to some natural object or permanent monument as follows: The number one corner of this claim is located approximately 5,075 feet N 76° W from the located SE SE corner of Section 22, T23N, R49E, MDM

The corners of this claim are marked by 4"x4" posts or 4" trees with metal tags inscribed with the appropriate corner number as shown on the following sketch and the accompanying claim map.

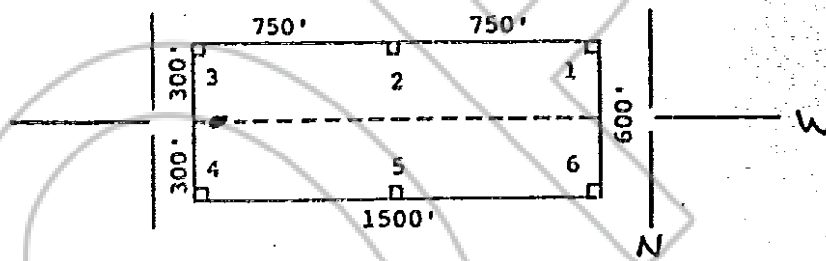

The location work consisted of making the maps as provided in NRS 517.040.

Dated and posted on the ground this 8 day of October, 1980

Witnesses: RECORDED AT REQUEST OF AMERICAN SELCO INC. BOOK 89 PAGE 509

Locator: AMERICAN SELCO INC.
By [Signature]
Agent for American Selco Inc.

80 DEC 1 AM: 38

OFFICIAL RECORDS
EUREKA COUNTY, NEVADA
CLERK & DEPUTY CLERK
STATE OF NEVADA 78005
COUNTY OF [Blank] (Fee \$ 3.00)

I hereby certify that the within instrument was filed and recorded at the request of: _____
FILE NO. _____
on _____
at _____
Docket _____ Page _____

Witness my hand and official seal the day and year aforesaid.
County Recorder _____
By _____
Deputy Recorder
BOOK 89 PAGE 509