

STATE OF NEVADA
CERTIFICATE OF MINING LOCATION
LODE CLAIM ON PUBLIC DOMAIN

NOTICE IS HEREBY GIVEN that the Red No. 47
lode mining claim has been located by AMERICAN SELCO INC.
a New York corporation, whose address is 90 West Grove Street,
Suite 100, Reno, Nevada 89509. The general course of this claim
is East/West. This claim is 1500 feet in length
along the course of the claim, being 10 feet from the point
of discovery in a East direction to the East end
line of this claim, and 1490 feet in a West
direction to the West end line of the claim. This claim is
600 feet in width, being 300 feet in width on each side of the
center line of the claim.

This claim is located within the SE/NE Quarter
of Section 27/34, Township 23 North, Range 49
East, Mount Diablo Base and Meridian, unknown Mining District,
White Pine County, Nevada. The location monument of this claim is
situated with reference to some natural object or permanent monument
as follows: The number one corner of this claim is located
approximately 5175 feet S 21° 40' W from the located SE
SE corner of Section 22, T23N, R49E, MDM

The corners of this claim are marked by 4"x4" posts or 4" trees
with metal tags inscribed with the appropriate corner number as
shown on the following sketch and the accompanying claim map.

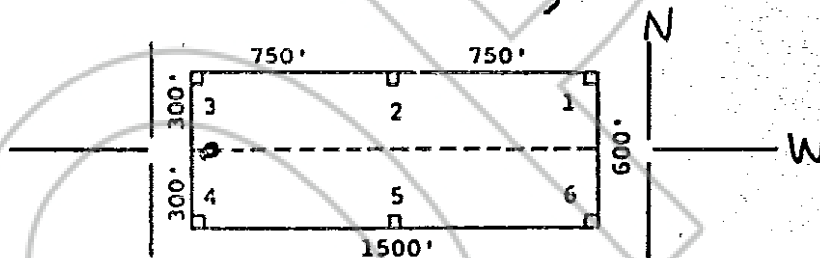

The location work consisted of making the maps as provided in
NRS 517.040.

Dated and posted on the ground this 10 day of October,
1980

Witnesses: AMERICAN SELCO INC
BOOK 87 PAGE 547

Locator:

AMERICAN SELCO INC.

By [Signature]
Agent for
American Selco Inc.

80 DEC 1 8 38

OFFICIAL RECORDS
EUREKA COUNTY, NEVADA
WILLIS A. DEPOSEL, RECORDER
FILE NO. 78043
FEE \$ 3.00

STATE OF NEVADA)
COUNTY OF _____) ss.

I hereby certify that the within
instrument was filed and recorded at
the request of: _____
FILE NO. _____
on _____
at _____
Docket _____ Page _____

Witness my hand and official
seal the day and year aforesaid.

County Recorder

By _____
Deputy Recorder

BOOK 89 PAGE 547