

STATE OF NEVADA  
CERTIFICATE OF MINING LOCATION  
LODE CLAIM ON PUBLIC DOMAIN

NOTICE IS HEREBY GIVEN that the Lake No. 123 lode mining claim has been located by AMERICAN SELCO INC. a New York corporation, whose address is 90 West Grove Street, Suite 100, Reno, Nevada 89509. The general course of this claim is North/South. This claim is 1500 feet in length along the course of the claim, being 1480 feet from the point of discovery in a North direction to the 'North' end line of this claim, and 20 feet in a South direction to the South end line of the claim. This claim is 600 feet in width, being 300 feet in width on each side of the center line of the claim.

This claim is located within the NE Quarter of Section 34, Township 19 North, Range 52 East, Mount Diablo Base and Meridian, unknown Mining District, Eureka County, Nevada. The location monument of this claim is situated with reference to some natural object or permanent monument as follows: The number one corner of this claim is located approx. 3,250 Ft. N21°30'W from claim location marker LA-2.

The claim location marker LA-2, a 3" x 6' steel pipe, is located approximately 18,400' N51°W from BM 7709; 14,000' N12°W from BM 7336; 21,000' N27½ E from Combs Peak VAMB 8631.

The corners of this claim are marked by 4"x4" posts or 4" trees with metal tags inscribed with the appropriate corner number as shown on the following sketch and the accompanying claim map.

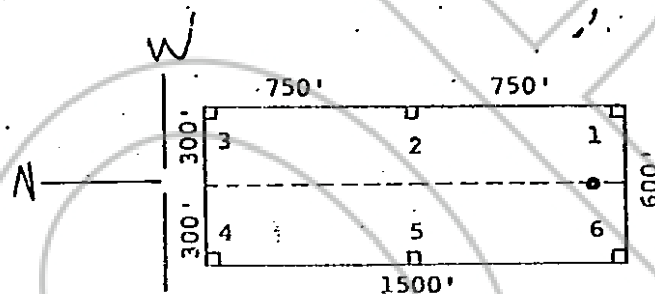

The location work consisted of making the maps as provided in NRS 517.040.

Dated and posted on the ground this 5 day of November, 1980.

Locator:

AMERICAN SELCO INC.

By Mike P.  
Agent for  
American Selco Inc.

RECORDED AT REQUEST OF  
**AMERICAN SELCO INC.**  
BOOK 90 PAGE 500  
81 JAN 23 AM 10:02  
81 JAN 23 AM 10:02  
OFFICIAL RECORDS  
CLERK OF COUNTY CLERK  
WILSON COUNTY CLERK  
CLERK OF COUNTY CLERK  
CLERK OF COUNTY CLERK  
CLERK OF COUNTY CLERK

STATE OF NEVADA

COUNTY OF ESSEX

I hereby certify that the within instrument was filed and recorded at the request of:

FILE NO. \_\_\_\_\_  
on \_\_\_\_\_  
at \_\_\_\_\_  
Docket \_\_\_\_\_ Page \_\_\_\_\_

Witness my hand and official seal the day and year aforesaid.

County Recorder

By WJOK 90 PAGE 500  
Deputy Recorder