

STATE OF NEVADA
CERTIFICATE OF MINING LOCATION
LODE CLAIM ON PUBLIC DOMAIN

78541

NOTICE IS HEREBY GIVEN that the Lake No. 209 lode mining claim has been located by AMERICAN SELCO INC. a New York corporation, whose address is 90 West Grove Street, Suite 100, Reno, Nevada 89509. The general course of this claim is North/South. This claim is 1500 feet in length along the course of the claim, being 20 feet from the point of discovery in a North direction to the North end line of this claim, and 1480 feet in a South direction to the South end line of the claim. This claim is 600 feet in width, being 300 feet in width on each side of the center line of the claim.

This claim is located within the NE Quarter of Section 2, Township 18 North, Range 52 East, Mount Diablo Base and Meridian, unknown Mining District, Eureka County, Nevada. The location monument of this claim is situated with reference to some natural object or permanent monument as follows: The number one corner of this claim is located approx. 3,600 Ft. due East from claim location marker LA-2.

The claim location marker LA-2, a 3" x 6" steel pipe, is located approximately 18,400 N51°W from BM 7709; 14,000' N12°W from BM 7336; 21,000' N27½°E from Combs Peak VAMB 8631.

The corners of this claim are marked by 4"x4" posts or 4" trees with metal tags inscribed with the appropriate corner number as shown on the following sketch and the accompanying claim map.

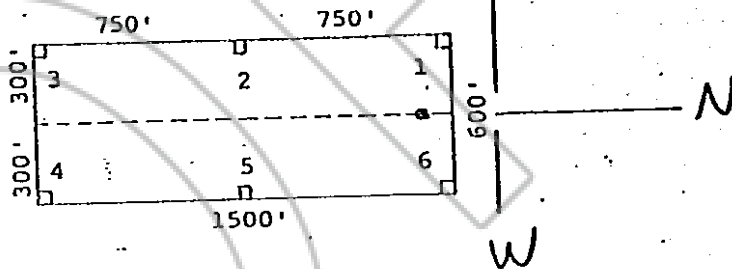

The location work consisted of making the maps as provided in NRS 517.040.

Dated and posted on the ground this 4 day of November, 1980.

Witnesses:

Locator:

AMERICAN SELCO INC.

By

Agent for

American Selco Inc.

RECORDED AT REQUEST OF
AMERICAN SELCO INC.
BOOK 90 PAGE 585

08

JAN 23

ALL: 08

STATE OF NEVADA

COUNTY OF

I hereby certify that the within instrument was filed and recorded at the request of: _____
FILE NO. _____
on _____
at _____
Docket _____ Page _____

Witness my hand and official seal the day and year aforesaid

County Recorder

By

BOOK 90 PAGE 585

Deputy Recorder