

STATE OF NEVADA  
CERTIFICATE OF MINING LOCATION  
LODE CLAIM ON PUBLIC DOMAIN

78594

NOTICE IS HEREBY GIVEN that the Lake No. 262 lode mining claim has been located by AMERICAN SELCO INC. a New York corporation, whose address is 90 West Grove Street, Suite 100, Reno, Nevada 89509. The general course of this claim is North/South. This claim is 1500 feet in length along the course of the claim, being \_\_\_\_\_ feet from the point of discovery in a North direction to the North end line of this claim, and \_\_\_\_\_ feet in a South direction to the South end line of the claim. This claim is 600 feet in width, being 300 feet in width on each side of the center line of the claim.

This claim is located within the NW Quarter of Section 12, Township 18 North, Range 52 East, Mount Diablo Base and Meridian, unknown Mining District, White Pine County, Nevada. The location monument of this claim is situated with reference to some natural object or permanent monument as follows: The number one corner of this claim is located approximately 1,525 feet N11°E from CLM-LA-3.

The claim location marker LA-3, a 3" x 6' steel pipe is located approximately 7,350' N69½°W of BM 7709; 6,800' N24°E of BM 7336; 10,100' S85½°E of Temple Peak.

The corners of this claim are marked by 4"x4" posts or 4" trees with metal tags inscribed with the appropriate corner number as shown on the following sketch and the accompanying claim map.

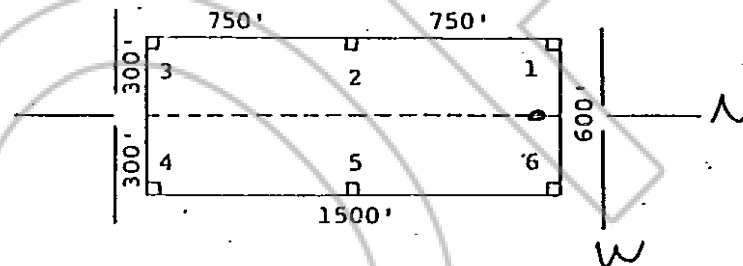

The location work consisted of making the maps as provided in NRS 517.040.

Dated and posted on the ground this 4 day of November 1980.

Witnesses:

Locator:

RECORDED AT REQUEST OF  
AMERICAN SELCO INC  
BOOK 91 PAGE 38

61 JAN 23 AM 11

OFFICIAL RECORDS  
TULSA COUNTY, OKLAHOMA  
WILLIS A. DUNN, CLERK  
FILE NO. 78594  
FEE \$3.00

AMERICAN SELCO INC.

By M. P. Pen  
Agent for  
American Selco Inc.

STATE OF NEVADA )  
COUNTY OF \_\_\_\_\_ ) ss.

I hereby certify that the within instrument was filed and recorded at the request of: \_\_\_\_\_

Witness my hand and official seal the day and year aforesaid.

FILE NO. \_\_\_\_\_  
on \_\_\_\_\_  
at \_\_\_\_\_  
Docket \_\_\_\_\_ Page \_\_\_\_\_

County Recorder  
By BOOK 91 PAGE 38  
Deputy Recorder