

STATE OF NEVADA  
 CERTIFICATE OF MINING LOCATION  
 LODE CLAIM ON PUBLIC DOMAIN

78600

NOTICE IS HEREBY GIVEN that the Lake No. 268 lode mining claim has been located by AMERICAN SELCO INC., a New York corporation, whose address is 90 West Grove Street, Suite 100, Reno, Nevada 89509. The general course of this claim is North/South. This claim is 1500 feet in length along the course of the claim, being 20 feet from the point of discovery in a North direction to the North end line of this claim, and 1480 feet in a South direction to the South end line of the claim. This claim is 600 feet in width, being 300 feet in width on each side of the center line of the claim.

This claim is located within the SE Quarter of Section 10, Township 18 North, Range 52 East, Mount Diablo Base and Meridian, unknown Mining District, Eureka County, Nevada. The location monument of this claim is situated with reference to some natural object or permanent monument as follows: The number one corner of this claim is located approximately 6,025 feet S 75° W from CLM-LA-3.

The claim location marker LA-3, a 3" x 6" steel pipe is located approximately 7,350' N 69½° W of BM 7709; 6,800' N 24° E of BM 7336; 10,100' S 85½° E of Temple Peak.

The corners of this claim are marked by 4"x4" posts or 4" trees with metal tags inscribed with the appropriate corner number as shown on the following sketch and the accompanying claim map.

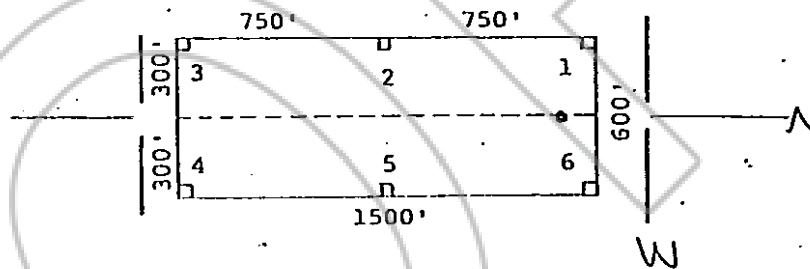

The location work consisted of making the maps as provided in NRS 517.040.

Dated and posted on the ground this 5 day of November, 1980.

RECORDED AT REQUEST OF  
**AMERICAN SELCO INC.**  
 BOOK 97 PAGE 44  
 81 JAN 23 AM 11:13  
 OFFICIAL RECORDS  
 COUNTY OF NEVADA  
 WILLIS A. DEPAUL RECORDER  
 FILE NO. 78600  
 T.F.S. REC.

Locator:  
AMERICAN SELCO INC.  
 By Mike Perry  
 Agent for  
 American Selco Inc.

STATE OF NEVADA )  
 ) ss.  
 COUNTY OF \_\_\_\_\_ )

I hereby certify that the within instrument was filed and recorded at the request of: \_\_\_\_\_  
 FILE NO. \_\_\_\_\_  
 on \_\_\_\_\_  
 at \_\_\_\_\_  
 Docket \_\_\_\_\_ Page \_\_\_\_\_

Witness my hand and official seal the day and year aforesaid.  
 \_\_\_\_\_  
 County Recorder  
 By BOOK 91 PAGE 44  
 Deputy Recorder