

NOTICE IS HEREBY GIVEN that the Lake No. 289 lode mining claim has been located by AMERICAN SELCO INC., a New York corporation, whose address is 90 West Grove Street, Suite 100, Reno, Nevada 89509. The general course of this claim is North/South. This claim is 1500 feet in length along the course of the claim, being 1480 feet from the point of discovery in a North direction to the North end line of this claim, and 20 feet in a South direction to the South end line of the claim. This claim is 600 feet in width, being 300 feet in width on each side of the center line of the claim.

This claim is located within the SW Quarter of Section 12, Township 18 North, Range 52 East, Mount Diablo Base and Meridian, unknown Mining District, Eureka County, Nevada. The location monument of this claim is situated with reference to some natural object or permanent monument as follows: The number one corner of this claim is located approximately 1,575 feet S 1 1/2° E from CLM-LA-3.

The claim location marker LA-3, a 3" x 6" steel pipe is located approximately 7,350' N69 1/2° W of BM 7709; 6,800' N24° E of BM 7336; 10,100' S 85 1/2° E of Temple Peak.

The corners of this claim are marked by 4"x4" posts or 4" trees with metal tags inscribed with the appropriate corner number as shown on the following sketch and the accompanying claim map.

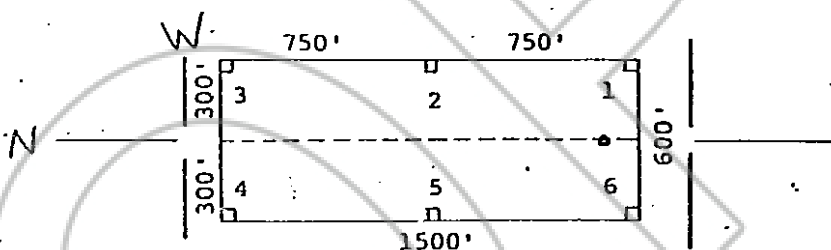

The location work consisted of making the maps as provided in NRS 517.040.

Dated and posted on the ground this 5 day of November 1980.

RECORDED AT REQUEST OF
 AMERICAN SELCO INC
 BOOK 91 PAGE 65

Witnesses:

OFFICIAL RECORDS
 EUREKA COUNTY, NEVADA
 WILLIS ALDERMAN, RECORDER
 FILED 1/23/80
 FEE IS \$3.00

STATE OF NEVADA)
) ss.
 COUNTY OF _____)

Locator:

AMERICAN SELCO INC.

By Mike Perry
 Agent for
 American Selco Inc.

I hereby certify that the within instrument was filed and recorded at the request of:

FILE NO. _____
 on _____
 at _____
 Docket _____ Page _____

Witness my hand and official seal the day and year aforesaid.

County Recorder
 By BOOK 91 PAGE 65
 Deputy Recorder