

NOTICE IS HEREBY GIVEN that the Lake No. 301 lode mining claim has been located by AMERICAN SELCO INC., a New York corporation, whose address is 90 West Grove Street, Suite 100, Reno, Nevada 89509. The general course of this claim is North/South. This claim is 1500 feet in length along the course of the claim, being 1480 feet from the point of discovery in a North direction to the North end line of this claim, and 20 feet in a South direction to the South end line of the claim. This claim is 600 feet in width, being 300 feet in width on each side of the center line of the claim.

This claim is located within the NE Quarter of Section 14, Township 18 North, Range 52 East, Mount Diablo Base and Meridian, unknown Mining District, Eureka County, Nevada. The location monument of this claim is situated with reference to some natural object or permanent monument as follows: The number one corner of this claim is located approximately 5,075 feet S 25° W from CLM-LA-3.

The claim location marker LA-3, a 3" x 6" steel pipe is located approximately 7,350' N 69½° W of BM 7709; 6,800' N 24° E of BM 7336; 10,100' S 85½° E of Temple Peak.

The corners of this claim are marked by 4"x4" posts or 4" trees with metal tags inscribed with the appropriate corner number as shown on the following sketch and the accompanying claim map.

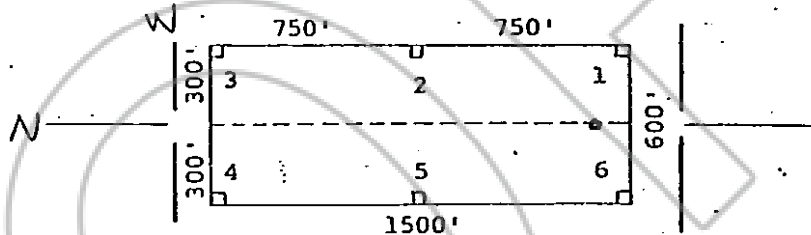

The location work consisted of making the maps as provided in NRS 517.040.

Dated and posted on the ground this 6 day of November, 1980.

Witnesses:

Locator:

AMERICAN SELCO INC.

By

Agent for

American Selco Inc.

RECORDED AT REQUEST OF
 AMERICAN SELCO INC.
 BOOK 91 PAGE 77

81 JAN 23 AM 1:13

OFFICIAL RECORDS
 EUREKA COUNTY, NEVADA
 WILLIS A. DUNN, RECORDER
 FILE # 78633
 FILE # 300

STATE OF NEVADA
 COUNTY OF

)
) ss.
)

I hereby certify that the within instrument was filed and recorded at the request of:

FILE NO. _____
 on _____
 at _____
 Docket _____ page _____

Witness my hand and official seal the day and year aforesaid.

County Recorder

By BOOK 91 PAGE 77
 Deputy Recorder